

PLAN	SURVEYED	DATE
NOTE BOOK NO.	PLANNED	
	FIELD CHECKED	
	BY	
	DATE	

PROFILE	SURVEYED	DATE
NOTE BOOK	PLANNED	
	FIELD CHECKED	
	BY	
	DATE	

BENCH MARK: BW249
SQUARE CUT ON N CONC BASE OF RR SIGNAL
MAST ARM BASE ON S ROW OF 71ST STREET
1/2 MILE WEST OF HARLEM AVENUE
ELEVATION=620.57

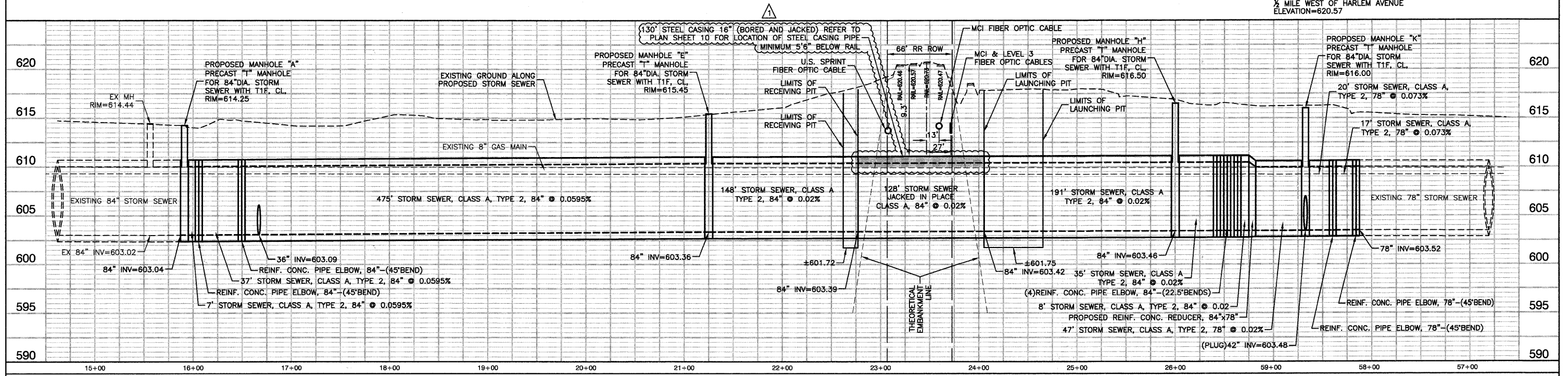

PROPOSED 78" & 84" STORM SEWER

FILE NAME = 0953-PLPR-01 - PR01	USER NAME =	DESIGNED - PKB	REVISED - 4-14-11 ADDENDUM
		CHECKED - PKB	REVISED -
	PLOT SCALE =	DRAWN - PS	REVISED -
	PLOT DATE = 12/23/10	CHECKED - AG	REVISED -

STATE OF ILLINOIS
DEPARTMENT OF TRANSPORTATION

71ST STREET	
STORM SEWER PROFILE - 84"	
SCALE: H 1"=50' V 1"=5'	SHEET NO. 50 OF 209 SHEETS
STA.	TO STA.

F.A.U. RTE.	SECTION	COUNTY	TOTAL SHEETS	SHEET NO.
1537	06-00050-00-GS	COOK	209	50
FED. ROAD DIST. NO. 1 ILLINOIS			FED. AID PROJECT CRE-9003(709)	
CONTRACT NO. 63556				

LAST SAVED BY: PETER PANOVIC ON 11/21/11
PLOTTED BY: PETER PANOVIC ON 4/15/11