

Traffic Control Plan Stage I

Refer to Standard 701606-06 for additional details, signing & devices.
Prior to installing Stage I Traffic Control the raised concrete median must be removed north of the bridge. See Bridge Approach Sheet for details.

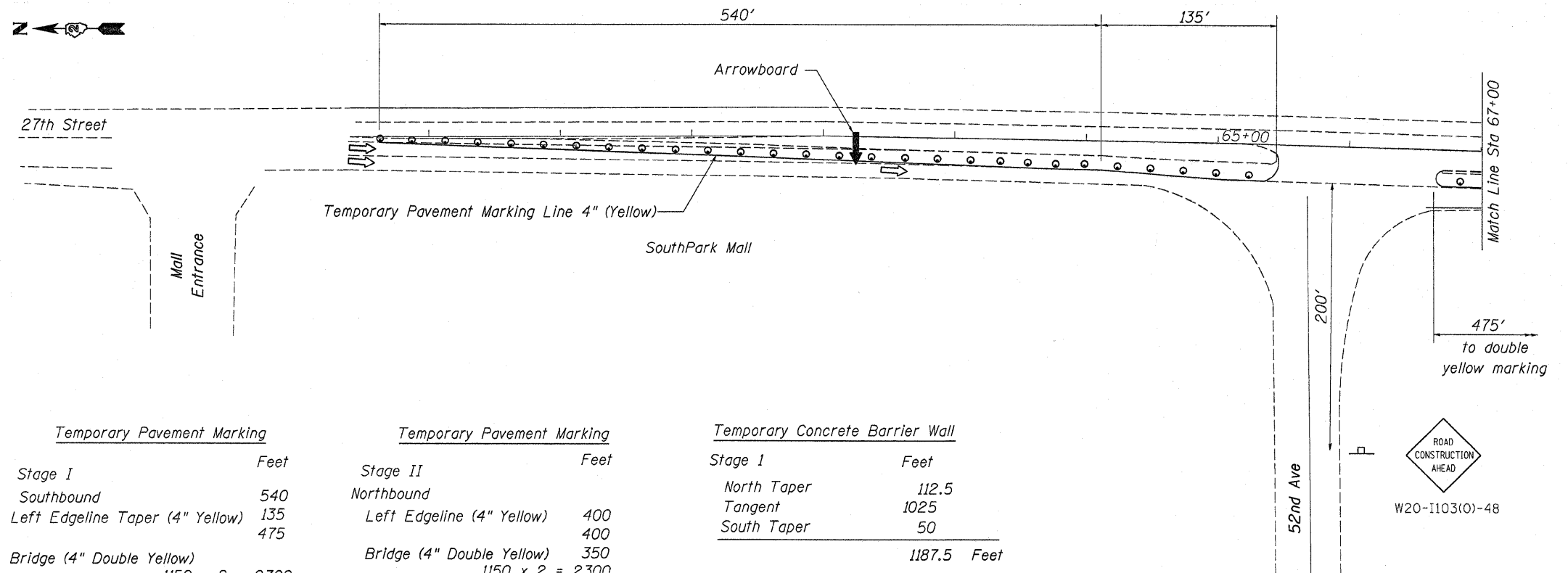

Pavement Marking Removal	
Stage I	Sq Ft
Double Yellow-North Taper	175
Double Yellow-South Taper	235
Double Yellow-North Taper	175
Double Yellow-South Taper	175
Total	760 Sq Ft

Temporary Pavement Marking	
Stage I	Feet
Southbound	540
Left Edgeline Taper (4" Yellow)	135
	475
Bridge (4" Double Yellow)	1150 x 2 = 2300
Left Edgeline (4" Yellow)	425
Right Edgeline (4" White)	1500
Northbound	
Right Edgeline (4" White)	
Taper	540
Tangent	320
Taper	350
Bridge	1150
Tangent	50
Taper (North end)	350
Left Edgeline (4" Yellow)	
South approach	515
North approach	250
Sub-Total	8900 Feet

Temporary Pavement Marking	
Stage II	Feet
Northbound	
Left Edgeline (4" Yellow)	400
	400
Bridge (4" Double Yellow)	350
	1150 x 2 = 2300
North approach	250
Right Edgeline (4" White)	1150
Southbound	
Right Edgeline (4" White)	
Taper	400
Tangent	400
Taper	300
Bridge	1150
Taper (South end)	250
Left Edgeline (4" Yellow)	
North approach	400
reverse curve	250
South approach	350
Sub-Total	8350 Feet

Temporary Concrete Barrier Wall	
Stage I	Feet
North Taper	112.5
Tangent	1025
South Taper	50
Total	1187.5 Feet

Relocate Temporary Concrete Barrier	
Stage II	Feet
North Taper	112.5
Tangent	1025
South Taper	50
Total	1187.5 Feet

Temporary Impact Attenuator, Non-Redirective, Test Level 3		
Stage I	1	Each
	1	Each
Relocate Temporary Impact Attenuator, Non-Redirective, Test Level 3		
Stage II	1	Each
	1	Each
Temporary Impact Attenuator, Severe Use Narrow, Test Level 3		
Stage I	1	Each
	1	Each
Relocate Temporary Impact Attenuator, Severe Use Narrow, Test Level 3		
Stage II	1	Each
	1	Each

Stage I	8900
Stage II	8350
Total	17,250 Feet