

F.A.I. RTE.	SECTION	COUNTY	TOTAL SHEETS	SHEET NO.
74	81-1HVB & 81-1HVB-1)M-2	ROCK ISLAND	19	1
FED. ROAD DIST. NO. -		ILLINOIS	CONTRACT NO. 64H09	

STATE OF ILLINOIS
DEPARTMENT OF TRANSPORTATION
DIVISION OF HIGHWAYS

PROPOSED
HIGHWAY PLANS

FAI ROUTE 74 (I-74)
SECTION (81-1HVB & 81-1HVB-1)M-2
ROCK ISLAND COUNTY
C-92-111-11

D-92-075-11

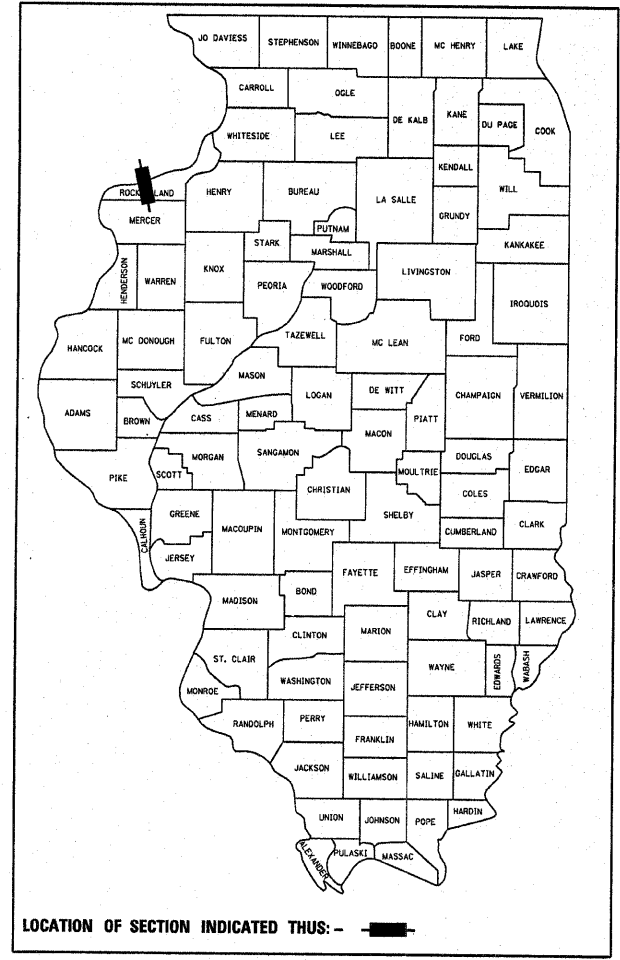

LOCATION OF SECTION INDICATED THUS: - [black rectangle] -

INDEX OF SHEETS

1. Cover Sheet
2. Summary of Quantities
3. General Notes
4. - 6. Existing Bridge Plans
7. - 11. Deck Plan
12. - 15. Existing Bridge Plans
16. Traffic Control Typical Weave
17. Typical Pavement Markings
18. Typical Pavement Markings
19. Painting Details

STANDARDS

- 701101-02 Off-Road Operations, Multilane, 4.5 m (15') to 600 mm (24") From Pavement Edge
- 701400-05 Approach to Lane Closure, Freeway/Expressway
- 701401-06 Lane Closure, Freeway/Expressway
- 701411-07 Lane Closure, Multilane, at Entrance or Exit Ramp, for Speeds > 45 MPH
- 701426-04 Lane Closure, Multilane, Intermittent or Moving Operation, for Speeds > 45 MPH
- 701901-01 Traffic Control Devices
- 720011-01 Metal Posts for Signs, Markers and Delineators
- 728001-01 Telescoping Steel Sign Support
- 729001-01 Applications of Types A and B Metal Posts (For Signs & Markers)

PROJECT LOCATION
STRUCTURES NO. 081-0142 & 0143

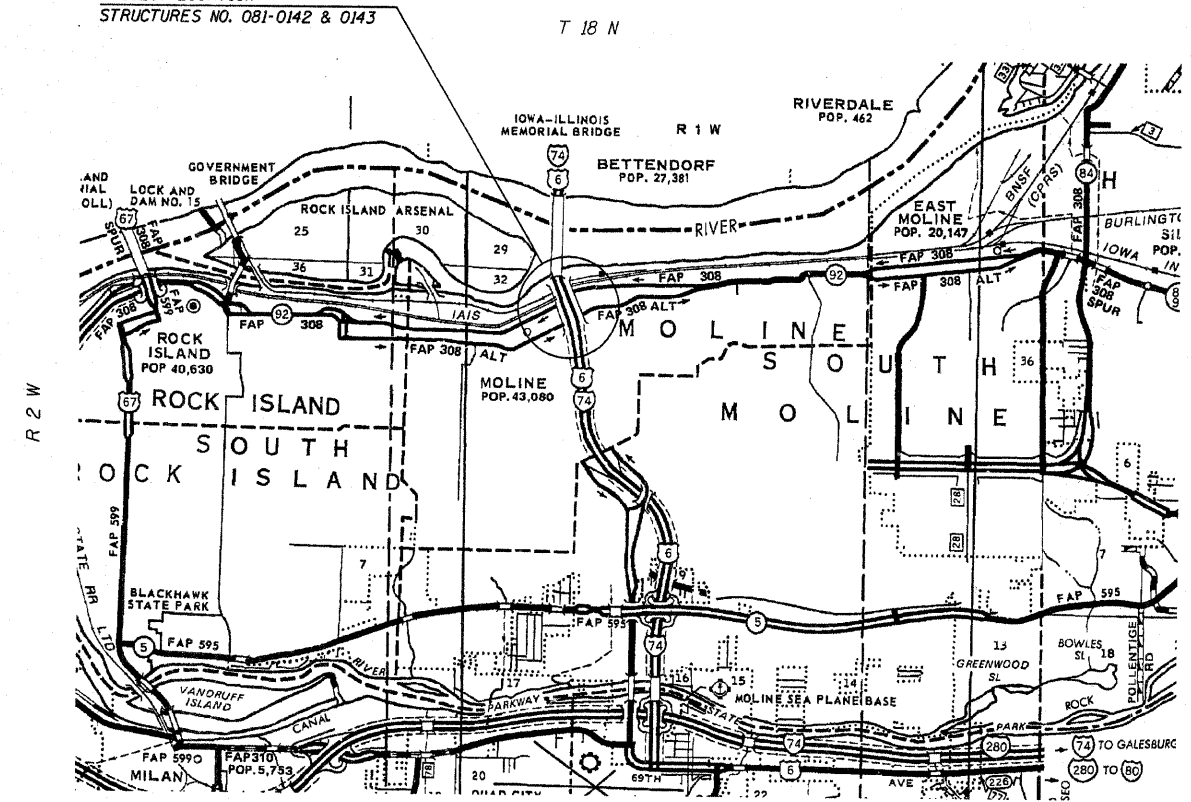

Moline Township Sections 32, 33

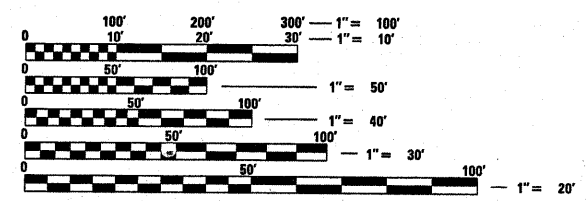

FULL SIZE PLANS HAVE BEEN PREPARED USING STANDARD ENGINEERING SCALES. REDUCED SIZED PLANS WILL NOT CONFORM TO STANDARD SCALES. IN MAKING MEASUREMENTS ON REDUCED PLANS, THE ABOVE SCALES MAY BE USED.

J.U.L.I.E.
JOINT UTILITY LOCATION INFORMATION FOR EXCAVATION
1-800-892-0123
OR 811

PROJECT ENGINEER MAHMOUD ETEMADI 815/284-5393

CONTRACT NO. 64H09

STATE OF ILLINOIS
DEPARTMENT OF TRANSPORTATION
DIVISION OF HIGHWAYS

SUBMITTED 2/21/2011

[Signature]
DEPUTY DIRECTOR OF HIGHWAYS, REGION ENGINEER

March 25 2011
Scott E. Stitt P.E.
Acting ENGINEER OF DESIGN AND ENVIRONMENT

March 25 2011
Christine M. Reagle
DIRECTOR OF HIGHWAYS, CHIEF ENGINEER

PRINTED BY THE AUTHORITY
OF THE STATE OF ILLINOIS

Summary of Quantities

URBAN
100% state
0014

paycode	description	units	quantity
40603370	HOT-MIX ASPHALT SURFACE COURSE, MIX "E", N90	TON	712
Z0004556	HOT-MIX ASPHALT SURFACE REMOVAL (DECK)	SQ YD	7974
67100100	MOBILIZATION	L SUM	1
70100420	TRAFFIC CONTROL AND PROTECTION, STANDARD 701411	EACH	4
70100800	TRAFFIC CONTROL AND PROTECTION, STANDARD 701401	L SUM	1
* 78001110	PAINT PAVEMENT MARKING - LINE 4"	FOOT	9000
Z0026346	NIGHTTIME WORK ZONE LIGHTING	L SUM	1
Z0016200	DECK SLAB REPAIR (PARTIAL)	SQ YD	30

**Specialty Items*

General Notes

All hot-mix asphalt surface that is removed shall be replaced during the same working day. No hot-mix asphalt surface shall be removed if it cannot be resurfaced in the same working day.

All Borrow/Waste/Use sites must be approved by the Department prior to removing any material from the project or initiating any earthmoving activities, including temporary stockpiling outside the limits of construction.

The final top 100 mm (four inches) of soil in any right-of-way area disturbed by the Contractor must be capable of supporting vegetation. The soil must be from the A horizon (zero to 2' deep) of soil profiles of local soils.

The Contractor shall seed all disturbed areas within the project limits. Seeding Class 4 or 2A shall be used, except in front of properties where the grass will be mowed, then use Seeding, Class 1. Class 2A shall be used on front slopes and ditch bottoms. Class 4 shall be used behind Type A gutter, on all backslopes and areas behind the backslope, and beyond the toe of front slope on fill sections without ditches. This work will be included in the contract unit price per square yard for HOT-MIX ASPHALT SURFACE REMOVAL (DECK).

Fertilizer shall be applied to all disturbed areas and incorporated into the seedbed prior to seeding or placement of sod at the rate specified in Sections 250 and 252 of the Standard Specifications. This work shall be included in the cost of HOT-MIX ASPHALT SURFACE REMOVAL (DECK).

Mulch Method II shall be applied over all seeded areas. This shall be included in the cost of the HOT-MIX ASPHALT SURFACE REMOVAL (DECK).

The following Mixture Requirements are applicable for this project:

Mixture Uses(s): Surface
 PG: SBS 70-22
 Design Air Voids 4.0% @ N90
 Mixture Composition IL 12.5 or 9.5
 (Gradation Mixture)
 Friction Aggregate E
 20 Year ESAL 13.0
 Mix Unit Weight 119 lbs/sy/in

Bituminous and Aggregate prime coat shall be placed in accordance with Section 406 of the Standard Specifications. The cost of the prime coats shall be included in the contract unit price per ton for HOT-MIX ASPHALT SURFACE COURSE, MIX "E", N90

These structures will retain the same number 081-0142, 081-0143, 081-0111, 081-0112, 081-0113, 081-0114.

Pavement Marking shall be done according to Standard 780001, except as follows:

1. All words, such as ONLY, shall be 2.4 m (8 feet) high.
2. All non-freeway arrows shall be the large size.
3. The distance between yellow no-passing lines shall be 200 mm (8"), not 180 mm (7") as shown in the detail of Typical Lane and Edge Lines.

The Contractor shall be responsible for protecting utility property during construction operations as outlined in Article 107.31 of the Standard Specifications. A minimum of 48 hours advance notice is required for non-emergency work. The JULIE number is 800-892-0123.

Following are the known utilities located within the project limits or immediately adjacent to the project construction limits which are not members of JULIE and should be notified individually by the contractor:

IDOT Mr. Kyle Lorenz 815/284-5469

Contractor must ensure that no damage is done to any of the existing joints during the HMA surface removal operations. Any damage to the joints is to be repaired to the satisfaction of the Engineer at the Contractor's expense.

FILE NAME =	USER NAME = linkdj	DESIGNED -	REVISED -	STATE OF ILLINOIS DEPARTMENT OF TRANSPORTATION	-----	F.A.I. RTE.	SECTION	COUNTY	TOTAL SHEETS	SHEET NO.
D:\BR\CADD plans\Rock Island County\081-0142 & 0143\2011 resurfacing\0810142&0143.dgn		DRAWN -	REVISED -			74	81-IHVB & 81-IHVB-11M-2	ROCK ISLAND	19	3
PLOT SCALE = 50.0000' / IN.		CHECKED -	REVISED -			CONTRACT NO. 64H09				
PLOT DATE = Fri Feb 04 07:55:09 2011		DATE -	REVISED -			FED. ROAD DIST. NO. ILLINOIS FED. AID PROJECT				
					SCALE: -----	SHEET NO. ___ OF ___ SHEETS		STA. ----- TO STA. -----		

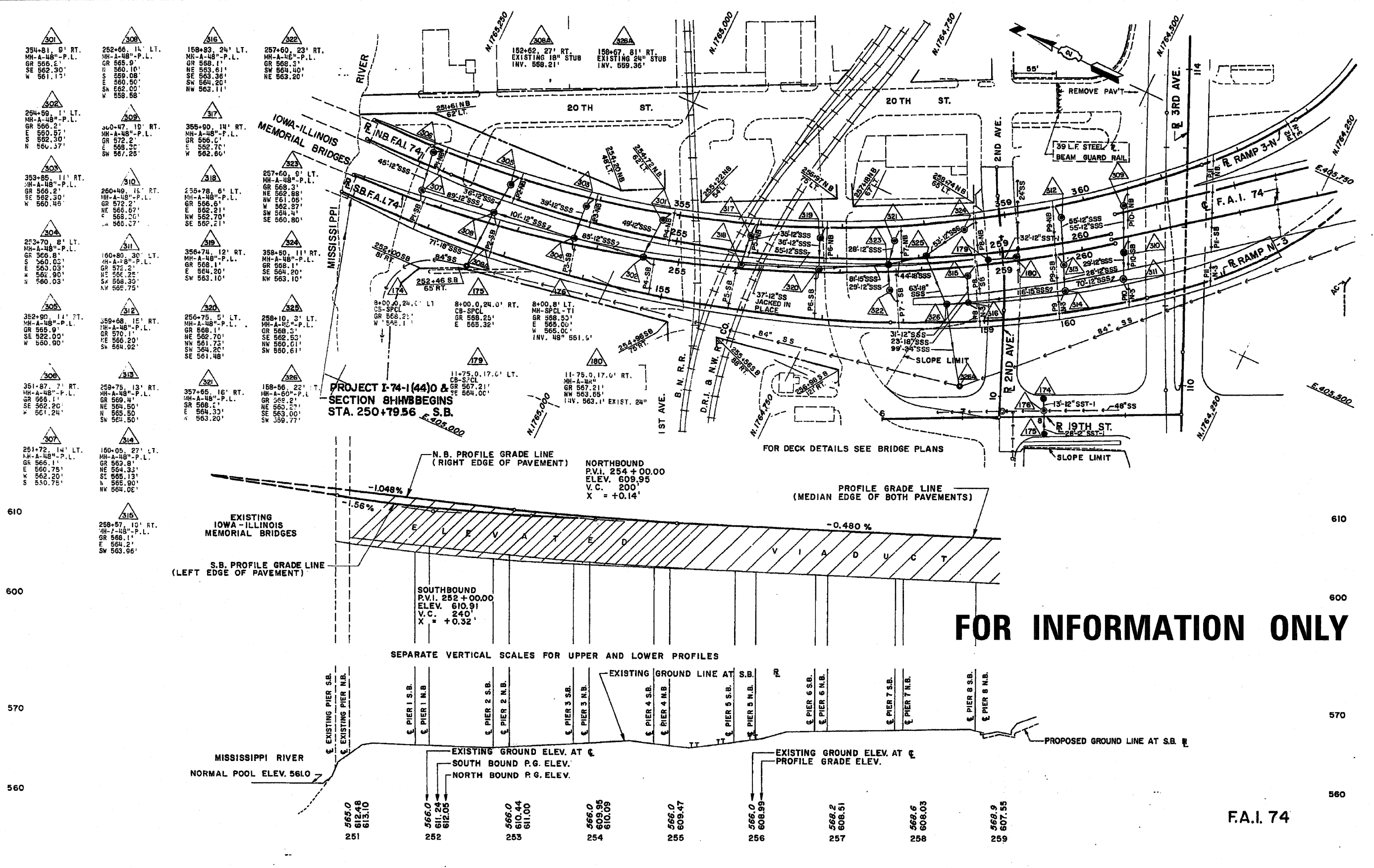

FOR INFORMATION ONLY

F.A.I. 74

FILE NAME =	USER NAME = linkdj	DESIGNED -	REVISED -	STATE OF ILLINOIS DEPARTMENT OF TRANSPORTATION	SCALE: _____ SHEET NO. ____ OF ____ SHEETS STA. _____ TO STA. _____	F.A.I. RTE.	SECTION	COUNTY	TOTAL SHEETS	SHEET NO.	
D:\BR\CADD\plans\Rock Island County\0810142 & 0143\2011.resur\Facing\0810142&0143.dgn	PLOT SCALE = 50.0000' / IN.	DRAWN -	REVISED -			74	81-IHWB & 81-IHWB-1JM-2	ROCK ISLAND	19	4	
PLOT DATE = Fri Feb 04 07:54:49 2011		CHECKED -	REVISED -			CONTRACT NO. 64H09					
		DATE -	REVISED -			FED. ROAD DIST. NO. [ILLINOIS] FED. AID PROJECT					

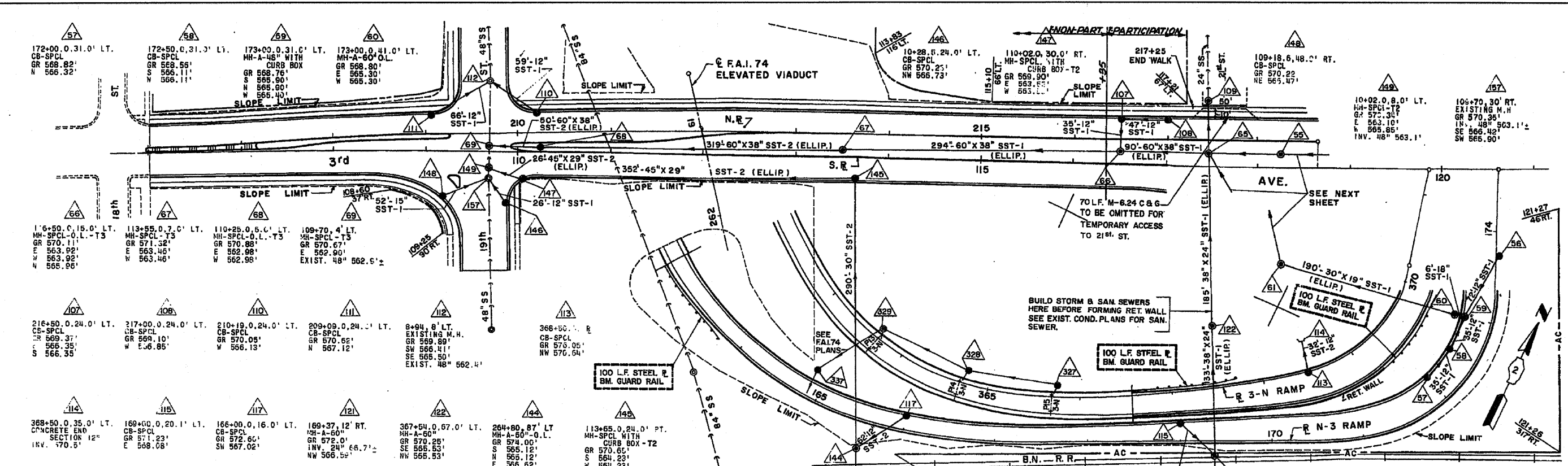

**PROPOSED IMPROVEMENT
3rd AVE STA. 106+00 TO STA. 117+00**

206	207	208	209	210	211	212	213	214	215	216	217																	
	572.28	572.04	571.78	571.54	571.28	571.04	570.78	570.66	570.57	570.55	570.59	570.70	570.85	571.15	571.44	571.56	571.60	571.58	571.49	571.24	570.99	570.74	570.49	570.24	569.99	569.74	569.64	569.60

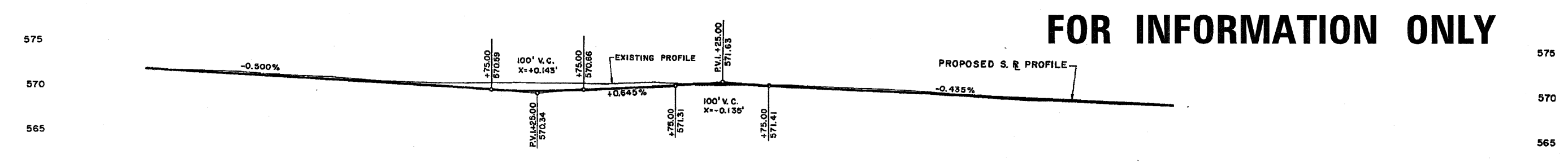
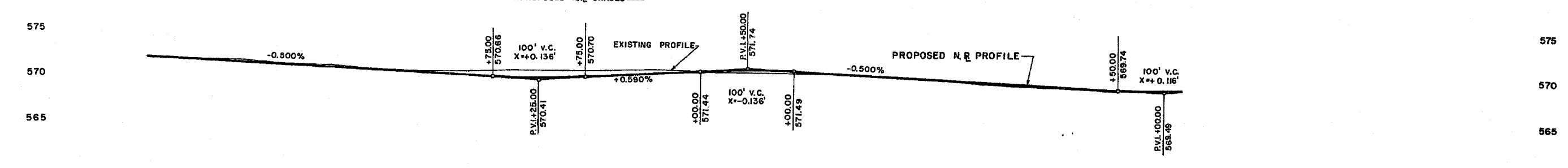

PROPOSED S.R. GRADES

106	572.22	107	571.96	571.72	108	571.46	571.22	109	570.96	570.72	570.59	570.50	570.48	570.54	570.66	570.82	571.15	571.31	571.44	571.50	571.49	571.41	571.30	571.09	570.87	570.65	570.43	570.22	570.00	569.78	569.56
-----	--------	-----	--------	--------	-----	--------	--------	-----	--------	--------	--------	--------	--------	--------	--------	--------	--------	--------	--------	--------	--------	--------	--------	--------	--------	--------	--------	--------	--------	--------	--------

FOR INFORMATION ONLY

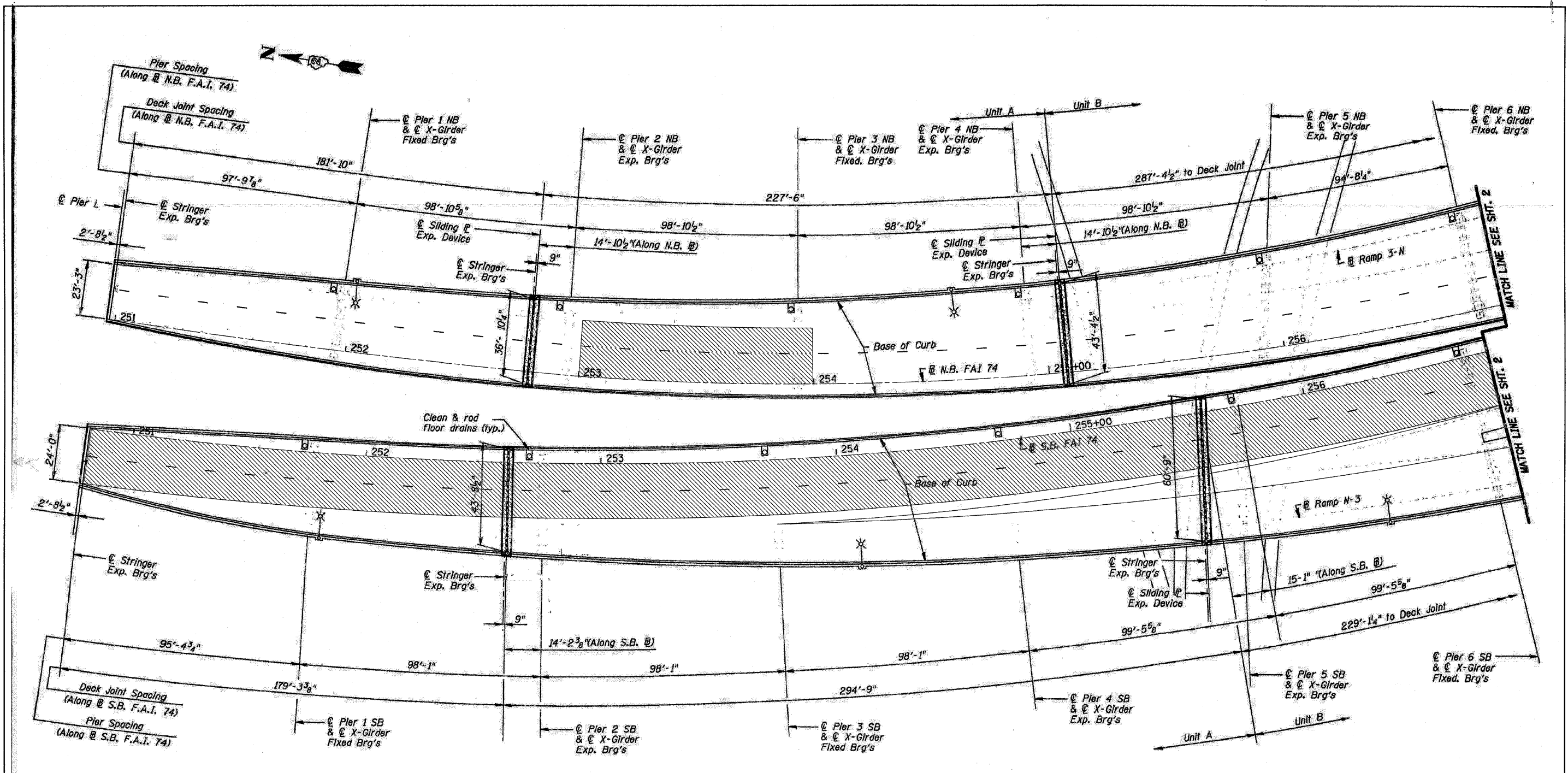

NOTE: The plan quantities for deck resurfacing and deck slab repair (partial) are estimated quantities. The areas shown on the deck plan are potential areas of deck resurfacing and deck slab repair (partial). The quantities are included as contingencies to be used as directed by the engineer during construction.

GENERAL PLAN, UNITS A & B

Note: Dimensions shown are taken from existing plans.

Legend



Limits of 1/2" Hot Mix Asphalt Surface Removal (Deck), and 1/2" Hot Mix Asphalt Surface Course, Mix "E", N90

Deck Survey Date: January 3, 2011

FILE NAME =	USER NAME = linkdj	DESIGNED -	REVISED -
D:\BR\CADD\plans\Rock Island County\0810142 & 0143\2011 resurfacing\0810142&0143.dgn		DRAWN -	REVISED -
		CHECKED -	REVISED -
		DATE -	REVISED -

PLOT SCALE = 5/8" = 1' IN.	DATE -	REVISED -
PLOT DATE = Fri Feb 04 07:54:10 2011		

STATE OF ILLINOIS
DEPARTMENT OF TRANSPORTATION

SCALE: _____ SHEET NO. ___ OF ___ SHEETS STA. _____ TO STA. _____

F.A.I. RTE.	SECTION	COUNTY	TOTAL SHEETS NO.
74	81-IHVB & 81-IHVB-1M-2	ROCK ISLAND	19 7
FED. ROAD DIST. NO. _____ ILLINOIS FED. AID PROJECT			CONTRACT NO. 64H09

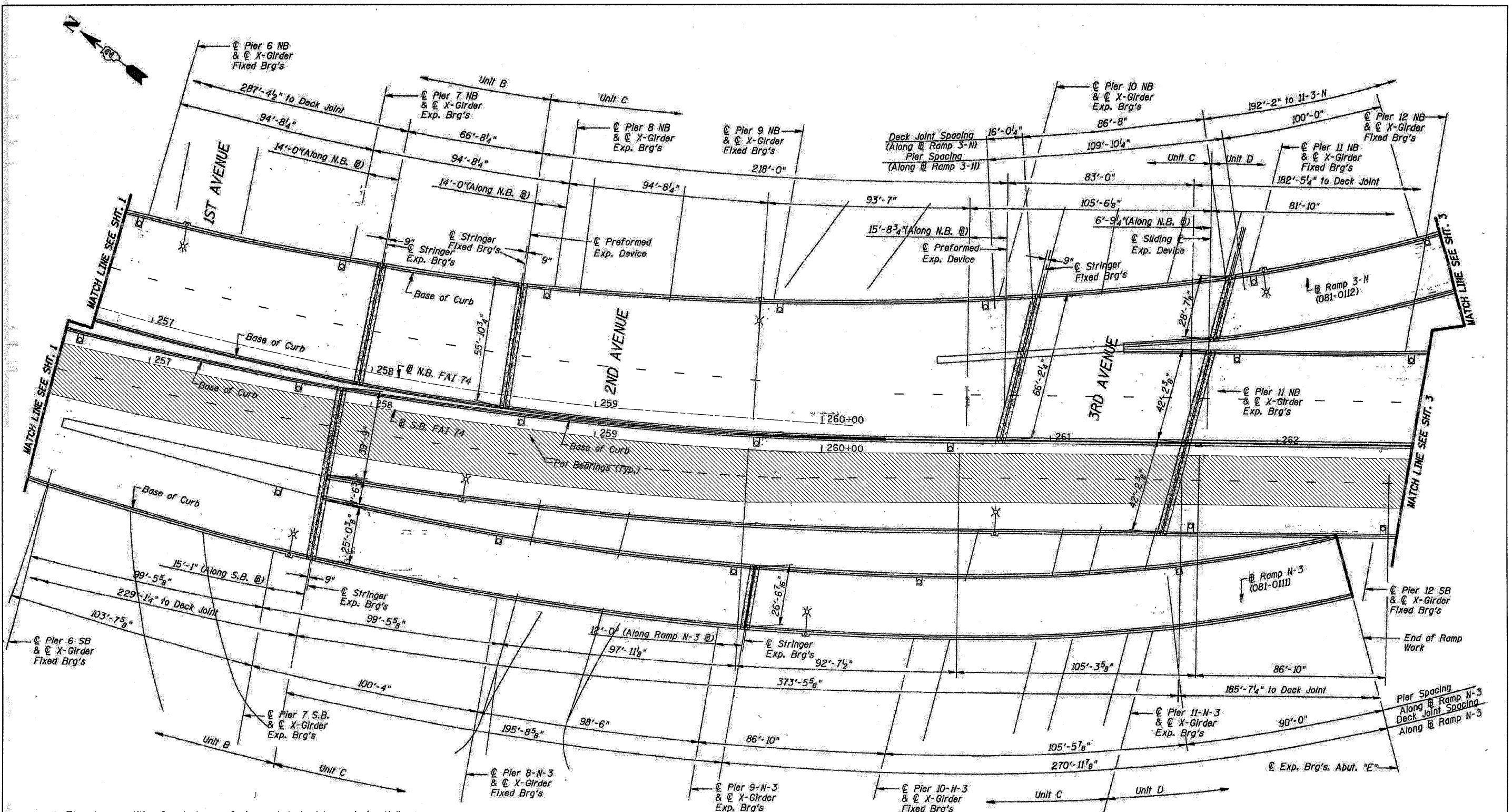

NOTE: The plan quantities for deck resurfacing and deck slab repair (partial) are estimated quantities. The areas shown on the deck plan are potential areas of deck resurfacing and deck slab repair (partial). The quantities are included as contingencies to be used as directed by the engineer during construction.

GENERAL PLAN, UNITS B, C & D

Note: Dimensions shown are taken from existing plans.

Legend

 Limits of 1/2" Hot Mix Asphalt Surface Removal (Deck), and 1/2" Hot Mix Asphalt Surface Course, Mix "E", N90

Deck Survey Date: January 3, 2011

FILE NAME =	USER NAME = linkd	DESIGNED -	REVISED -	STATE OF ILLINOIS DEPARTMENT OF TRANSPORTATION	SCALE: _____ SHEET NO. ____ OF ____ SHEETS STA. _____ TO STA. _____	F.A.I. RTE.	SECTION	COUNTY	TOTAL SHEETS	SHEET NO.
D:\NRCADD\plans\Rock Island County\0810142 & 0143\2011 resurfacing\0810142&0143.dgn	DRAWN -	REVISED -	74			81-IHVB & 81-IHVB-11M-2	ROCK ISLAND	19	8	
PLOT SCALE = 50.0000' / IN.	CHECKED -	REVISED -	CONTRACT NO. 64H09							
PLOT DATE = Fri Feb 04 07:53:40 2011	DATE -	REVISED -	FED. ROAD DIST. NO. - [ILLINOIS] FED. AID PROJECT							

STATE OF ILLINOIS
DEPARTMENT OF TRANSPORTATION

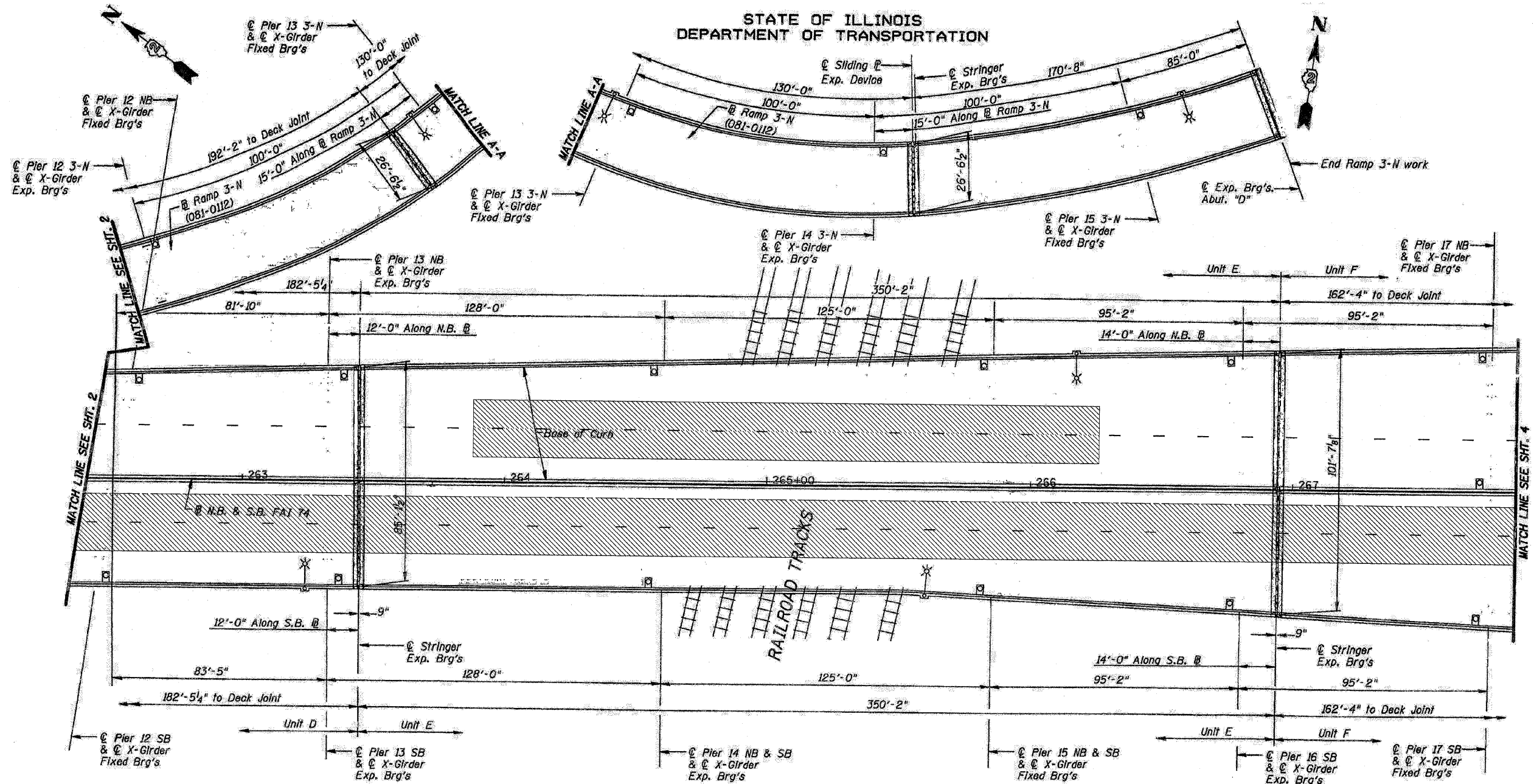

NOTE: The plan quantities for deck resurfacing and deck slab repair (partial) are estimated quantities. The areas shown on the deck plan are potential areas of deck resurfacing and deck slab repair (partial). The quantities are included as contingencies to be used as directed by the engineer during construction.

Legend



Limits of 1/2" Hot Mix Asphalt Surface Removal (Deck), and 1/2" Hot Mix Asphalt Surface Course, Mix "E", N90

Deck Survey Date: January 3, 2011

FILE NAME =	USER NAME = linkdj	DESIGNED -	REVISED -	STATE OF ILLINOIS DEPARTMENT OF TRANSPORTATION	F.A.I. RTE.	SECTION	COUNTY	TOTAL SHEETS	SHEET NO.
Q:\BR\CADD\plane\Rock Island County\0810142 & 0143\2011 resurfacing\0810142&0143.dgn		DRAWN -	REVISED -		74	81-IHVB & 81-IHVB-1JM-2	ROCK ISLAND	19	9
PLOT SCALE = 50.0000' / IN.		CHECKED -	REVISED -		CONTRACT NO. 64H09				
PLOT DATE = Fri Feb 04 07:53:23 2011		DATE -	REVISED -		FED. ROAD DIST. NO. [ILLINOIS] FED. AID PROJECT				

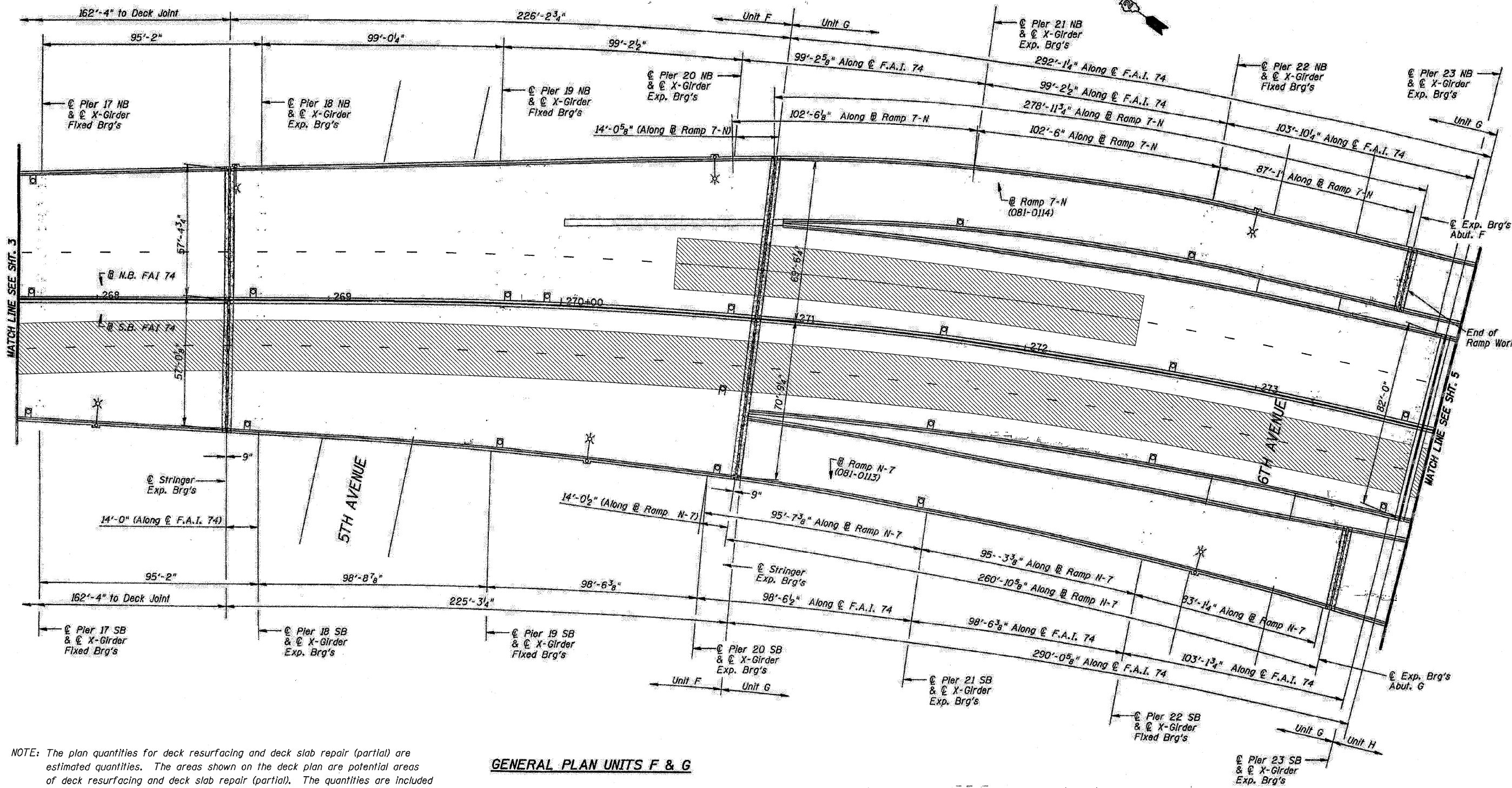

NOTE: The plan quantities for deck resurfacing and deck slab repair (partial) are estimated quantities. The areas shown on the deck plan are potential areas of deck resurfacing and deck slab repair (partial). The quantities are included as contingencies to be used as directed by the engineer during construction.

GENERAL PLAN UNITS F & G

Note: Dimensions shown are taken from existing plans.

Legend
 Limits of 1/2" Hot Mix Asphalt Surface Removal (Deck), and 1/2" Hot Mix Asphalt Surface Course, Mix "E", N90

Deck Survey Date: January 3, 2011

FILE NAME = G:\BR\CADD plans\Rock Island County\0810142 & 0143\2011 resurfacing\0810142&0143.dgn	USER NAME = linkdj	DESIGNED -	REVISED -	STATE OF ILLINOIS DEPARTMENT OF TRANSPORTATION	F.A.I. RTE. 74	SECTION 81-1HVB & 81-1HVB-1M-2	COUNTY ROCK ISLAND	TOTAL SHEETS 19	SHEET NO. 10
PLLOT SCALE = 50.0000' / IN.	CHECKED -	REVISED -	REVISED -		SCALE: -----	SHEET NO. -- OF -- SHEETS	STA. -----	TO STA. -----	CONTRACT NO. 64H09
PLLOT DATE = Fri Feb 04 07:53:10 2011	DATE -	REVISED -	REVISED -		FED. ROAD DIST. NO. - ILLINOIS FED. AID PROJECT				

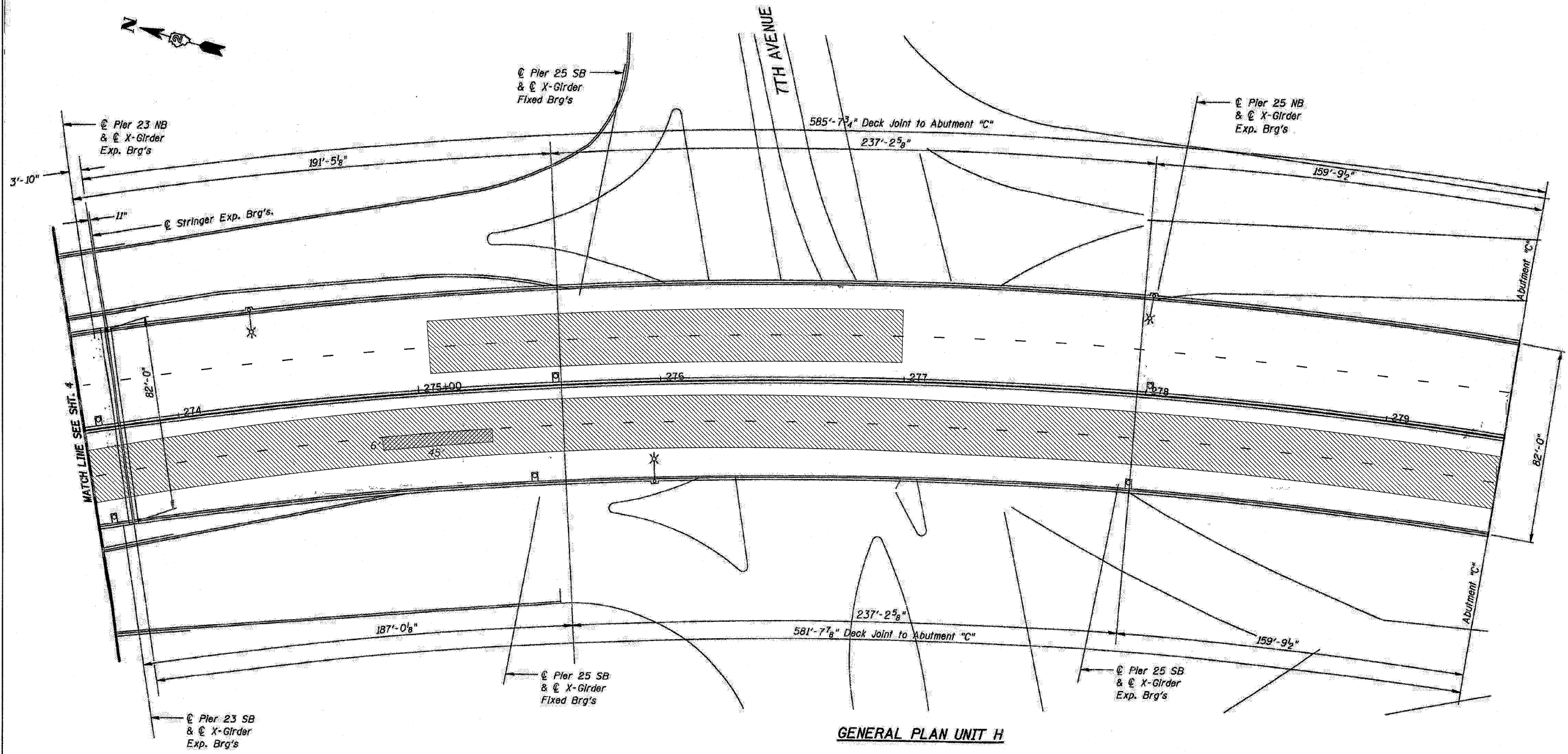

GENERAL PLAN UNIT H

NOTE: The plan quantities for deck resurfacing and deck slab repair (partial) are estimated quantities. The areas shown on the deck plan are potential areas of deck resurfacing and deck slab repair (partial). The quantities are included as contingencies to be used as directed by the engineer during construction.

Note: Dimensions shown are taken from existing plans. Legend

- Limits of 1/2" Hot Mix Asphalt Surface Removal (Deck), and 1/2" Hot Mix Asphalt Surface Course, Mix "E", N90
 - Deck Slab Repair (Partial)
- Deck Survey Date: January 3, 2011

FILE NAME =	USER NAME = linkdj	DESIGNED -	REVISED -
D:\BR\CADD plans\Rock Island County\0810142 & 0143\2011 resurfacing\0810142&0143.dgn		DRAWN -	REVISED -
PLOT SCALE = 50,0000 / IN.		CHECKED -	REVISED -
PLOT DATE = Fri Feb 04 07:52:59 2011		DATE -	REVISED -

**STATE OF ILLINOIS
DEPARTMENT OF TRANSPORTATION**

SCALE: _____ SHEET NO. ___ OF ___ SHEETS STA. _____ TO STA. _____

F.A.I. RTE.	SECTION	COUNTY	TOTAL SHEETS	SHEET NO.
74	81-1HVB & 81-1HVB-1JM-2	ROCK ISLAND	19	11
FED. ROAD DIST. NO. _____ ILLINOIS FED. AID PROJECT			CONTRACT NO. 64H09	

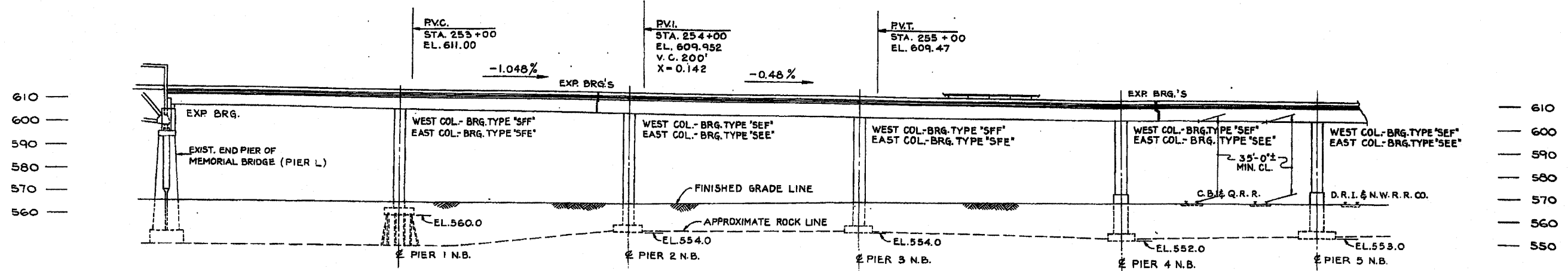

ELEVATION — N.B. ROADWAY
1" = 20'

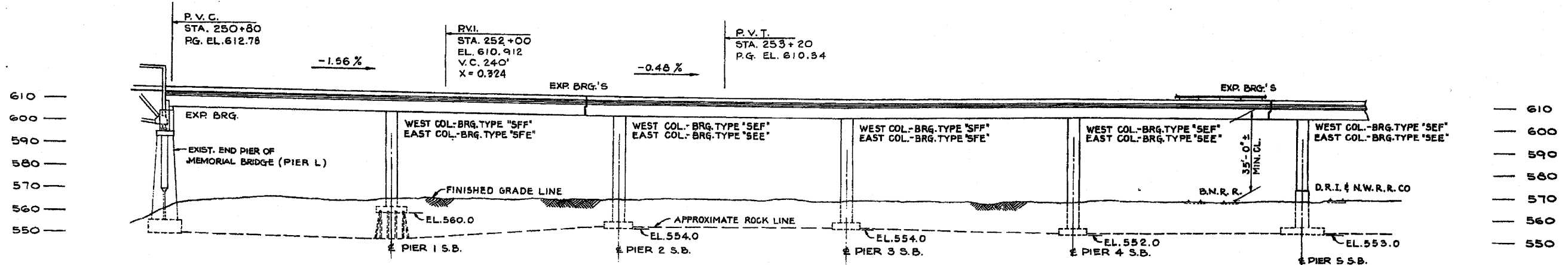

ELEVATION — S.B. ROADWAY
1" = 20'

FOR INFORMATION ONLY

**ELEVATION - N.B. & S.B. RDWAY
EXISTING PIER TO PIER 5**
F.A.I. 74-SECTION 81-1HVB
MOLINE VIADUCT
ROCK ISLAND COUNTY
STATION 246+20
SCALE: AS NOTED DATE:

FILE NAME =	USER NAME = linkdj	DESIGNED -	REVISED -	STATE OF ILLINOIS DEPARTMENT OF TRANSPORTATION	SCALE: _____ SHEET NO. ___ OF ___ SHEETS STA. _____ TO STA. _____	F.A.I. RTE.:	SECTION	COUNTY	TOTAL SHEETS	SHEET NO.
D:\BR\CADD plans\Rock Island County\081142 & 0143\2011 resur\facings\081142&0143.dgn		DRAWN -	REVISED -			74	81-1HVB & 81-1HVB-1JM-2	ROCK ISLAND	19	12
PLDT SCALE = 50.0000' / IN.		CHECKED -	REVISED -			CONTRACT NO. 64H09		FED. ROAD DIST. NO. _____ ILLINOIS FED. AID PROJECT		
PLDT DATE = Fri Feb 04 07:52:42 2011		DATE -	REVISED -							

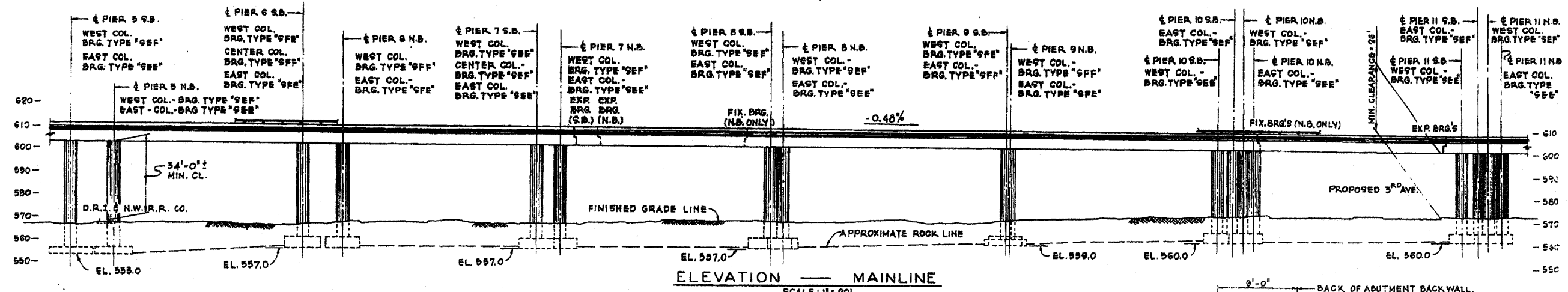

ELEVATION — MAINLINE
SCALE: 1" = 20'

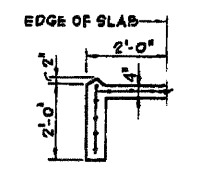

SECTION A-A
SCALE: 1/2" = 1'-0"

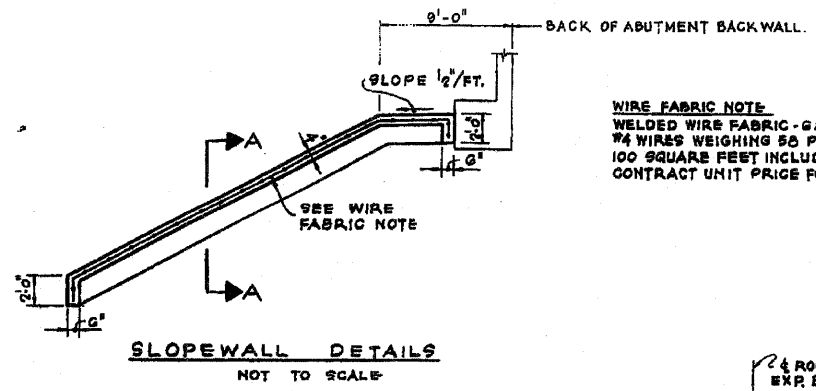

SLOPEWALL DETAILS
NOT TO SCALE

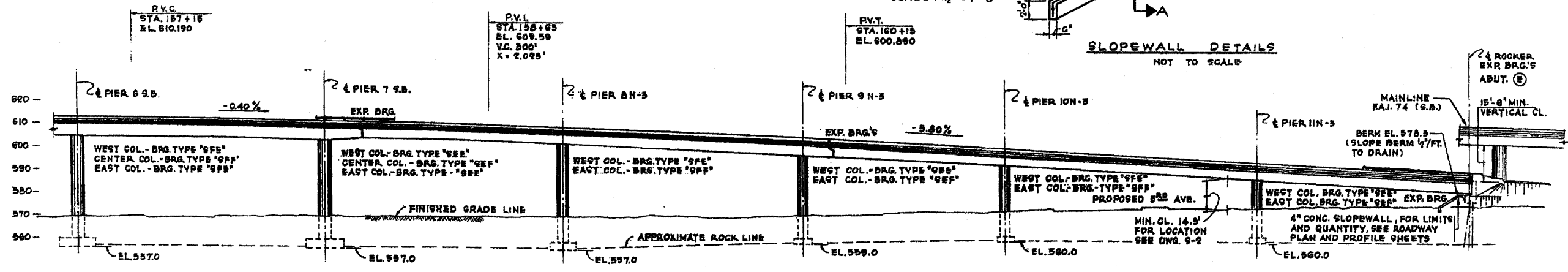

ELEVATION — RAMP N-3
SCALE: 1" = 20'

FOR INFORMATION ONLY

ELEVATIONS
MAINLINE - PIER 5 TO PIER 11
RAMP N-3 - PIER 6 S.B. TO ABUT. (E)
F.A.I. 74 - SECTION 81-1HVB
MOLINE VIADUCT
ROCK ISLAND COUNTY
STATION 255+20
SCALE: AS NOTED DATE:

FILE NAME =	USER NAME = linkdj	DESIGNED -	REVISED -	STATE OF ILLINOIS DEPARTMENT OF TRANSPORTATION	F.A.I. RTE.	SECTION	COUNTY	TOTAL SHEETS	SHEET NO.
D:\BR\CADD plans\Rock Island County\0810142 & 0143\2011 resurfacing\0810142&0143.dgn	DRAWN -	REVISED -	74		81-1HVB & 81-1HVB-1M-2	ROCK ISLAND	19	13	
PLOT SCALE = 50.0000 / IN.	CHECKED -	REVISED -	CONTRACT NO. 64H09						
PLOT DATE = Fri Feb 04 07:52:24 2011	DATE -	REVISED -	FED. ROAD DIST. NO. - [ILLINOIS] FED. AID PROJECT						

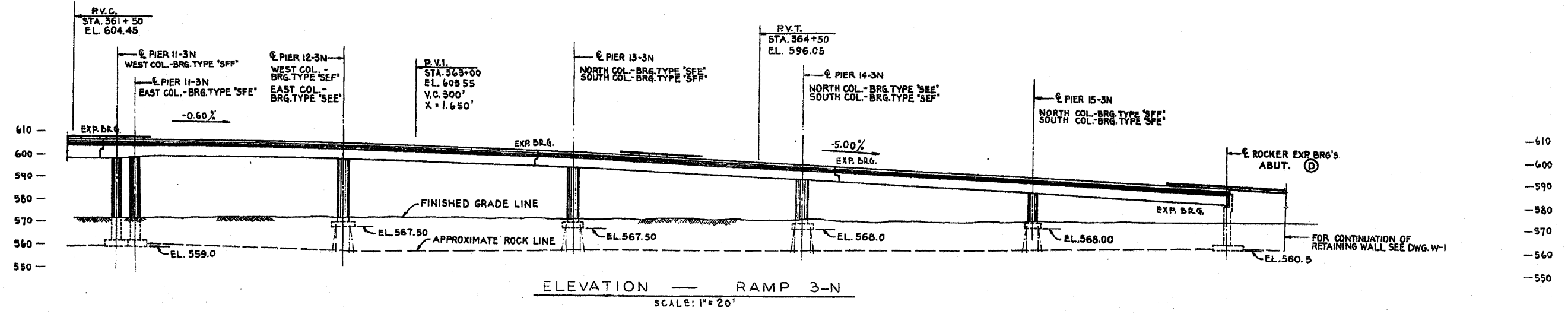

ELEVATION — RAMP 3-N
SCALE: 1"=20'

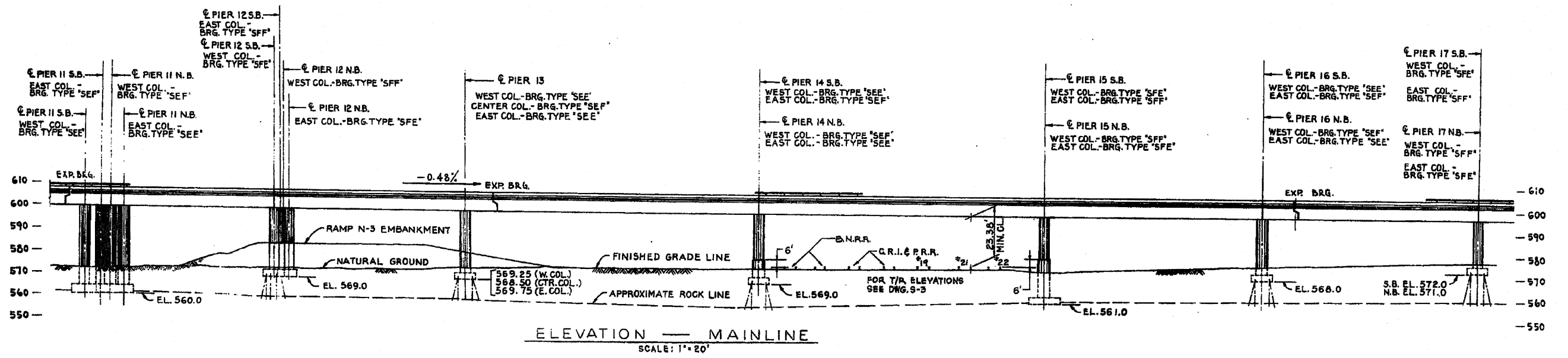

ELEVATION — MAINLINE
SCALE: 1"=20'

FOR INFORMATION ONLY

ELEVATIONS
RAMP 3-N — PIER 11 TO ABUT. (D)
MAINLINE — PIER 11 TO PIER 17
F.A.I. 74-SECTION 81-IHVB
MOLINE VIADUCT
ROCK ISLAND COUNTY
STATION 265 + 20
SCALE: AS NOTED DATE:

FILE NAME =	USER NAME = linkdj	DESIGNED -	REVISED -	STATE OF ILLINOIS DEPARTMENT OF TRANSPORTATION	F.A.I. RTE. 74	SECTION 81-IHVB & 81-IHVB-10M-2	COUNTY ROCK ISLAND	TOTAL SHEETS	SHEET NO.
Q:\BR\CADD\plans\Rock Island County\0810142 & 0143\2011 resurfacing\0810142&0143.dgn	DRAWN -	REVISED -	19					14	
PLOT SCALE = 50.0000' / IN.	CHECKED -	REVISED -	CONTRACT NO. 64H09						
PLOT DATE = Fri Feb 04 07:52:14 2011	DATE -	REVISED -	FED. ROAD DIST. NO. [ILLINOIS] FED. AID PROJECT						

SCALE: _____ SHEET NO. ____ OF ____ SHEETS STA. _____ TO STA. _____

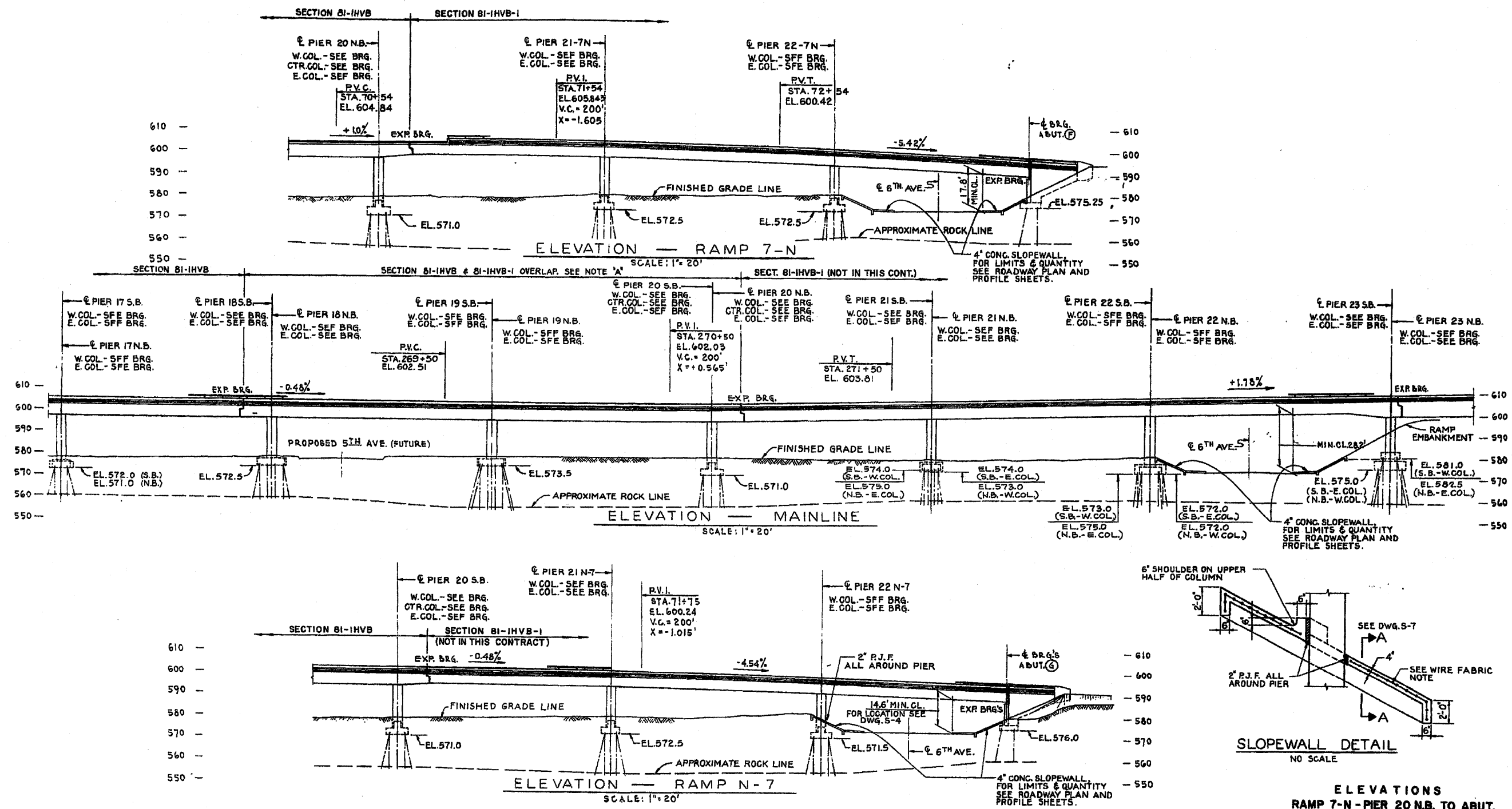

FOR INFORMATION ONLY

WIRE FABRIC NOTE:
 WELDED WIRE FABRIC 6x6 MESH #4 WIRES
 WEIGHING 55 POUNDS PER 100 SQUARE FEET
 INCLUDED IN CONTRACT UNIT PRICE FOR
 SLOPE WALL.

ELEVATIONS
 RAMP 7-N - PIER 20 N.B. TO ABUT.
 S.B. ROWAY. - PIER 17 TO PIER 23
 RAMP N-7 - PIER 20 S.B. TO ABUT.
 F.A.1.74-SECTION 81-IHVB
 MOLINE VIADUCT
 ROCK ISLAND COUNTY
 STATION 265+20
 SCALE AS NOTED DATE

FILE NAME =	USER NAME = linkdj	DESIGNED -	REVISED -	STATE OF ILLINOIS DEPARTMENT OF TRANSPORTATION	F.A.I. RTE.	SECTION	COUNTY	TOTAL SHEETS	SHEET NO.
D:\BRV\CADD plans\Rock Island County\0810142 & 0143\2011 resurfacing\0810142&0143.dgn		DRAWN -	REVISED -		74	81-IHVB & 81-IHVB-1M-2	ROCK ISLAND	19	15
PLOT SCALE = 50.0000' / IN.		CHECKED -	REVISED -		CONTRACT NO. 64H09				
PLOT DATE = Fri Feb 04 07:51:39 2011		DATE -	REVISED -		FED. ROAD DIST. NO. [ILLINOIS] FED. AID PROJECT				

SCALE: _____ SHEET NO. ____ OF ____ SHEETS STA. _____ TO STA. _____

TRAFFIC CONTROL TYPICAL WEAVE

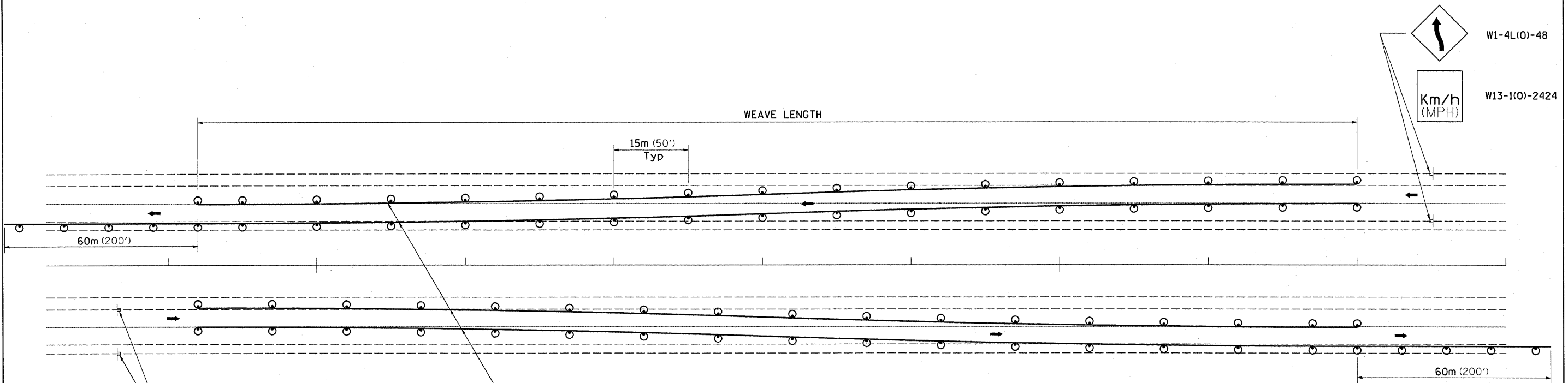

Temporary Pavement Marking required if Typical Weave is used for 14 days or more.



W1-4R(O)-48

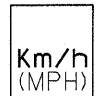

W13-1(O)-2424

LEGEND

- ⊙ DRUM WITH STEADY BURN MONO-DIRECTIONAL LIGHTS
- ⊞ SIGN ON PERMANENT MOUNT

DESIGNER NOTE:

1. USE ON LONG 4-LANE PROJECTS WHERE THE CONTRACTOR MAY CHANGE A PORTION OF THE WORK TO THE OPPOSITE LANE.
2. USE WHERE THE PROJECT IS ADJACENT TO ANOTHER AND THE CONTRACTOR COULD BE WORKING ON DIFFERENT LANES.
3. TEMPORARY PAVEMENT MARKING SHALL BE USED WHEN TYPICAL WEAVE IS USED FOR 14 DAYS OR MORE.
4. TRAFFIC CONTROL TYPICAL WEAVE SHALL BE INCLUDED IN THE COST OF THE SPECIFIC TRAFFIC CONTROL STANDARDS OF ITEMS.

STANDARD WEAVE CONDITIONS FOR DIFFERENT SPEED LIMITS

POSTED SPEED LIMIT	ADVISORY SPEED LIMIT	WEAVE LENGTH
110 Km/h (65 MPH)	80 Km/h (45 MPH)	240m (780 FT.)
90 Km/h (55 MPH)	60 Km/h (35 MPH)	200m (660 FT.)
80 Km/h (45 MPH)	40 Km/h (25 MPH)	165m (540 FT.)

ALL DIMENSIONS ARE IN MILLIMETERS (INCHES) UNLESS OTHERWISE NOTED.

FILE NAME =	USER NAME = linkdj	DESIGNED -	REVISED - 5-30-91	STATE OF ILLINOIS DEPARTMENT OF TRANSPORTATION	REGION 2 / DISTRICT 2 STANDARD	F.A.I. RTE.	SECTION	COUNTY	TOTAL SHEETS	SHEET NO.	
0:\BR\CADD plans\Rock Island County\0810142 & 0143\2011 resurfacing\0810142&0143.dgn		DRAWN -	REVISED -			74	(81-1HVB & 81-1HVB-1)M-2	Rock Island	19	16	
		CHECKED -	REVISED -			SCALE: _____ SHEET NO. ___ OF ___ SHEETS STA. _____ TO STA. _____		FED. ROAD DIST. NO. _____ ILLINOIS FED. AID PROJECT			
		DATE -	REVISED -			CONTRACT NO. 64H09					

TYPICAL PAVEMENT MARKINGS

TYPICAL PAVEMENT MARKING FOR FLUSH MEDIAN AT LEFT TURN LANE

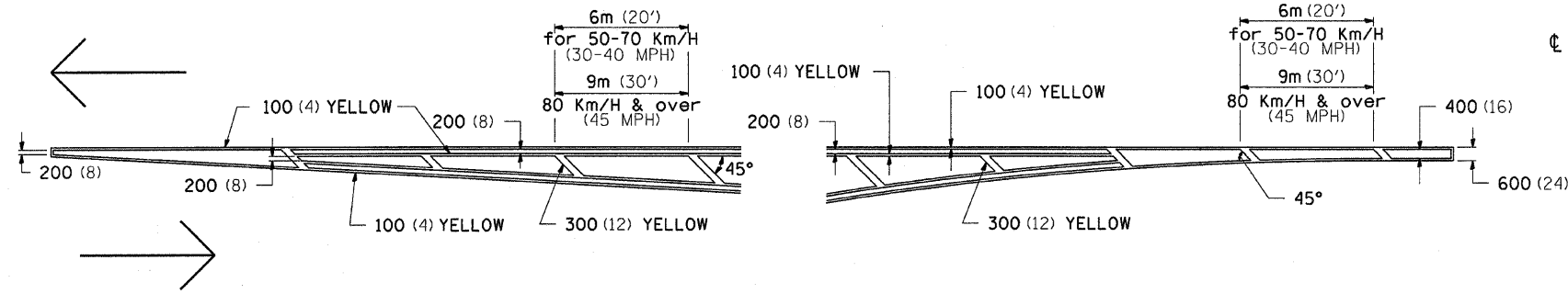

MEDIAN PAVEMENT MARKING

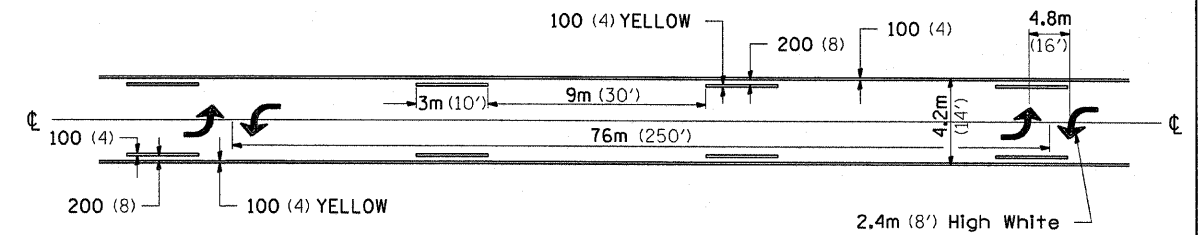

TYPICAL ISLAND OFFSET SHOULDER WIDTH

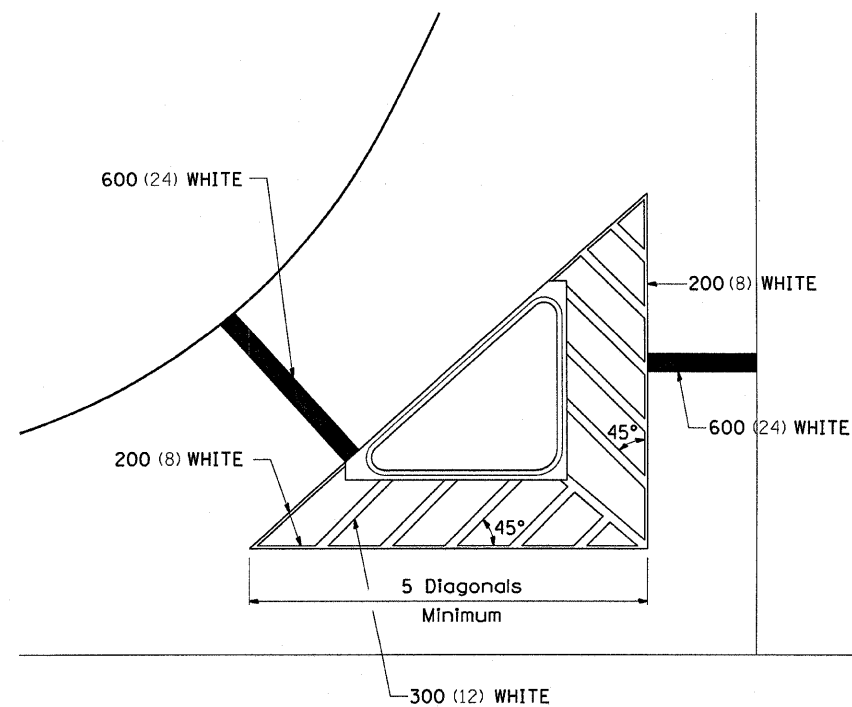

TYPICAL PARKING SPACING

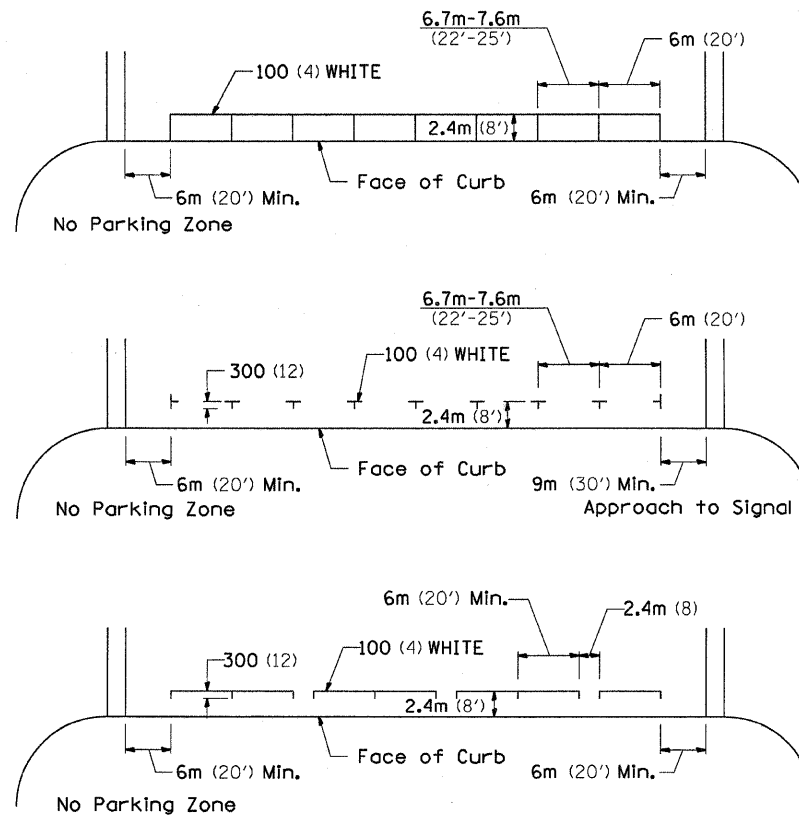

•• ALL DIMENSIONS ARE IN MILLIMETERS (INCHES) UNLESS OTHERWISE NOTED.

STANDARD CROSSWALK MARKING

See Schedules for Locations

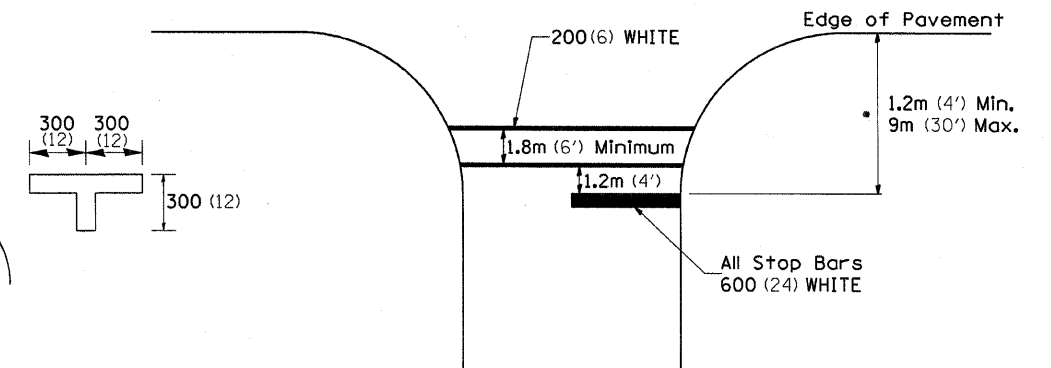

• Distance to the nearest edge of the intersecting roadway in the absence of a marked crosswalk.

FILE NAME =	USER NAME = jinkdj	DESIGNED -	REVISED - 1-11-08	STATE OF ILLINOIS DEPARTMENT OF TRANSPORTATION	REGION 2 / DISTRICT 2 STANDARD	F.A.I. RTE.	SECTION	COUNTY	TOTAL SHEETS	SHEET NO.	
D:\BR\CADD plans\Rock Island County\081142 & 0143\2011 resurfacing\081142&0143.dgn		DRAWN -	REVISED -			74	81-IHVB & 81-IHVB-DM-2	ROCK ISLAND	19	17	
PLOT SCALE = 50.0000' / IN.		CHECKED -	REVISED -			CONTRACT NO. 64H09					
PLOT DATE = Fri Feb 04 07:51:14 2011		DATE -	REVISED -			FED. ROAD DIST. NO. ILLINOIS FED. AID PROJECT					

TYPICAL PAVEMENT MARKINGS

ARROW LAYOUT

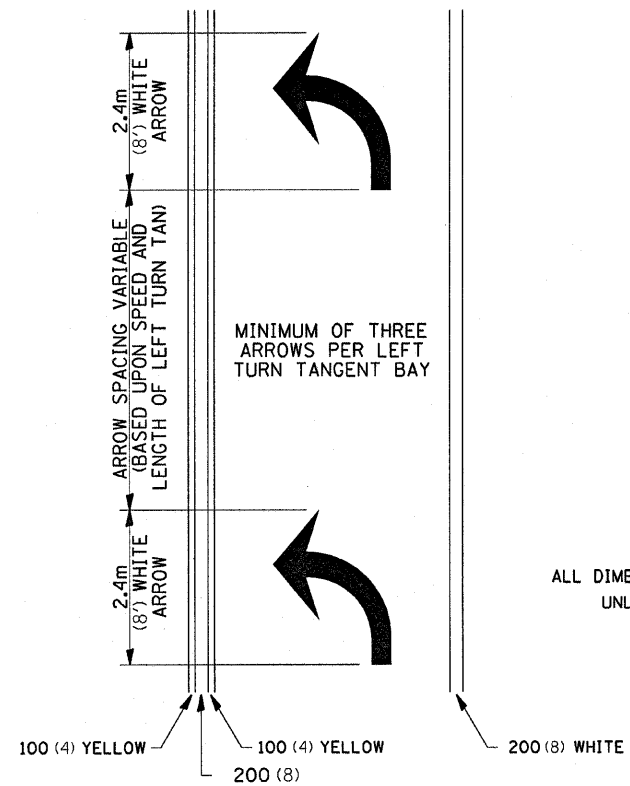

- ◀ ONE-WAY AMBER MARKER
- △ ONE-WAY CRYSTAL MARKER
- ◆ TWO-WAY AMBER MARKER

ALL DIMENSIONS ARE IN MILLIMETERS (INCHES) UNLESS OTHERWISE NOTED.

TYPICAL PAVEMENT MARKING FOR FLUSH MEDIAN

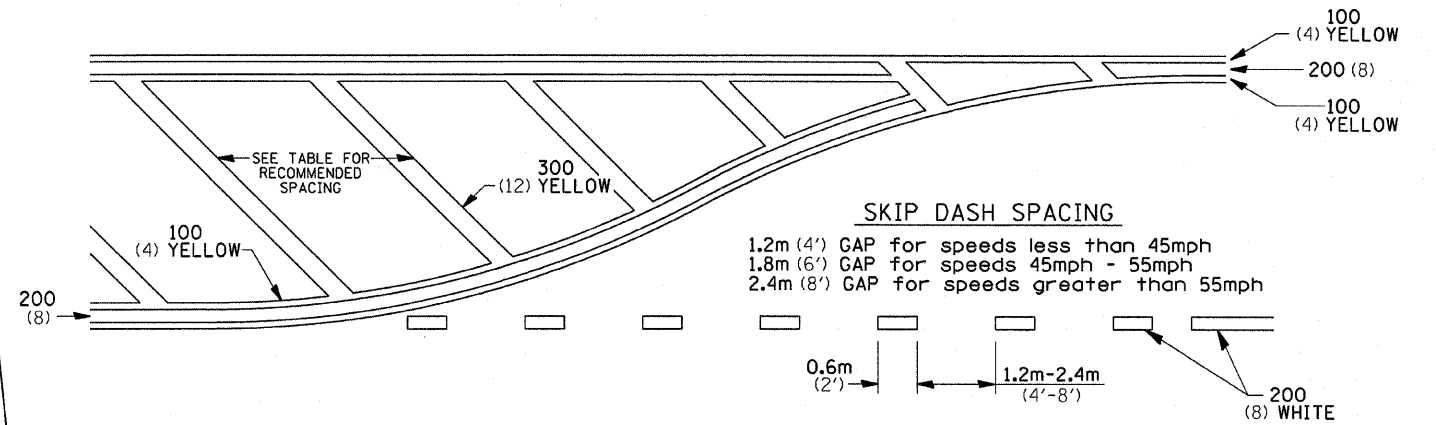

RECOMMENDED SPACING BETWEEN DIAGONALS (IN FEET)

Speed Limit Range	Continuous Median Area	Intersection Channelization	Objects (Islands)
less than 50km/H (30MPH)	15.3m (50')	4.53m (15')	3.05m (10')
50-60km/H (30-40MPH)	22.9m (75')	6.1m (20')	4.53m (15')
70km/H (45MPH) & over	22.9m (75')	9.05m (30')	6.1m (20')

NOTE: If the spacing recommended in the Table does not permit at least five diagonal lines in the area being marked, the spacing from the next lowest speed range should be used. The recommended spacing is measured parallel to the pavement center line.

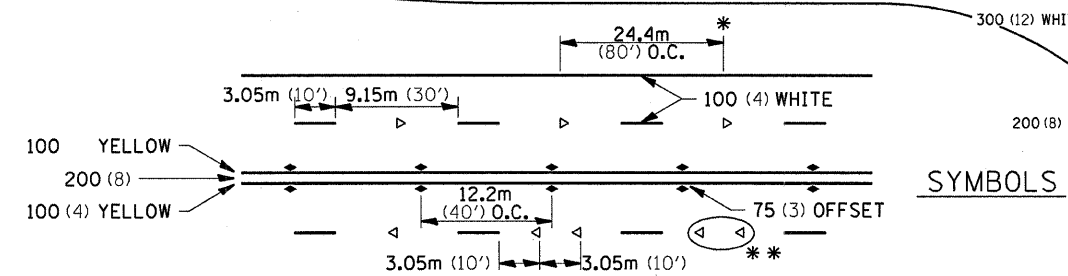
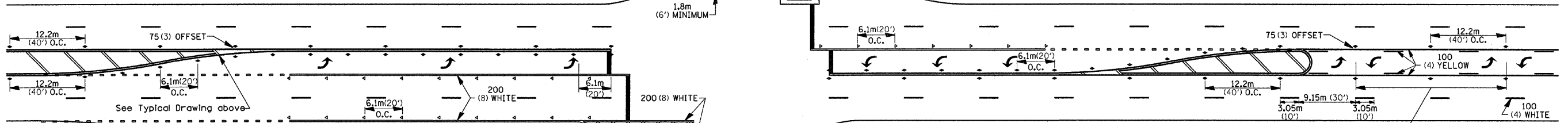

- REDUCE TO 12.2m (40') O.C. ON CURVES WHERE ADVISORY SPEEDS ARE 15km/H (10MPH) LOWER THAN POSTED SPEEDS.
- USE DOUBLE MARKERS WHEN ADT ≥ 25,000

MULTI-LANE / UNDIVIDED

SYMBOLS

See Typical Drawing above

TYPICAL PAVEMENT MARKING FOR TWO LANE SECTION - NO PASSING ZONES

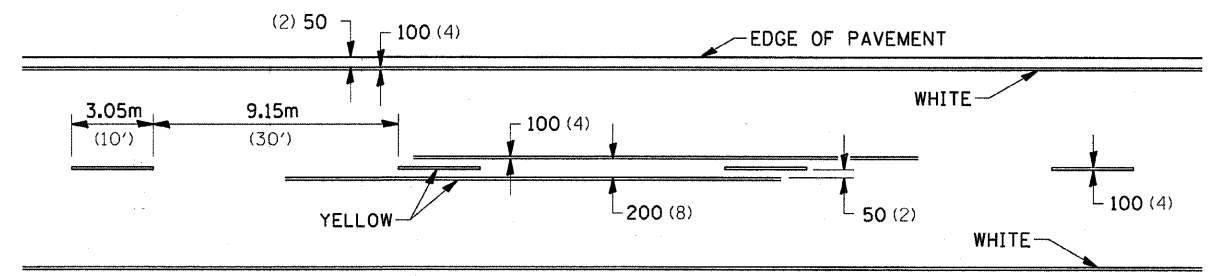

FILE NAME =	USER NAME = linkdj	DESIGNED -	REVISED - 1-11-08
D:\BRV\CADD plans\Rook Island County\0810142 & 0143\2011 resurfacing\0810142&0143.dgn		DRAWN -	REVISED -
		CHECKED -	REVISED -
		DATE -	REVISED -

STATE OF ILLINOIS
DEPARTMENT OF TRANSPORTATION

REGION 2 / DISTRICT 2 STANDARD	
SCALE: _____	SHEET NO. ___ OF ___ SHEETS
STA. _____ TO STA. _____	

F.A.I. RTE.	SECTION	COUNTY	TOTAL SHEETS	SHEET NO.
74	81-IHVB & 81-IHVB-11M-2	ROCK ISLAND	19	18
CONTRACT NO. 64H09				
FED. ROAD DIST. NO. - ILLINOIS FED. AID PROJECT				

PAINING DETAILS

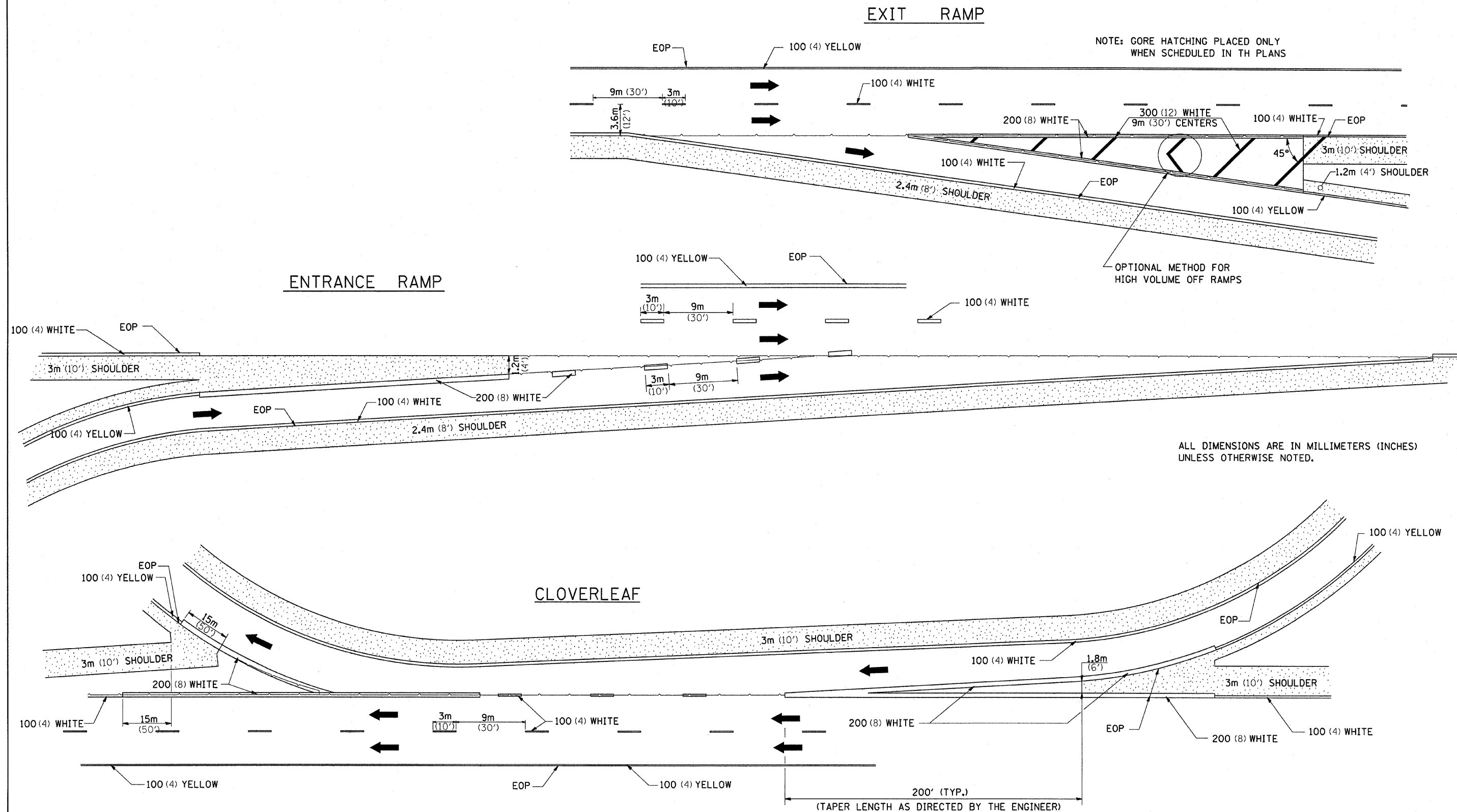

FILE NAME =	USER NAME = linkdj	DESIGNED -	REVISED - 6-26-90	STATE OF ILLINOIS DEPARTMENT OF TRANSPORTATION	REGION 2 / DISTRICT 2 STANDARD	F.A.I. RTE.	SECTION	COUNTY	TOTAL SHEETS	SHEET NO.
D:\NBR\CADD plans\Rock Island County\0811142 & 0143\2011 resurfacing\08110142&0143.dgn	DRAWN -	REVISED -	74			81-1HVB & 81-1HVB-11M-2	ROCK ISLAND	19	19	
PLOT SCALE = 50.0000 / IN.	CHECKED -	REVISED -	CONTRACT NO. 64H09							
PLOT DATE = Fri Feb 04 07:51:01 2011	DATE -	REVISED -	FED. ROAD DIST. NO. [ILLINOIS] FED. AID PROJECT							