

BENCH MARK DATA:

B.M. #7 - R.R. Spk in N. Side 10' Oak
 42' Rt of Existing F.A. Rt. 26 @
 Sta. 1306+42, Elev. 333.67
 (Destroyed during Stage I Construction)
 (Engineer will furnish new Bench Mark)
 No Existing Structures.

STATE OF ILLINOIS
 DEPARTMENT OF PUBLIC WORKS & BUILDINGS
 DIVISION OF HIGHWAYS

ROUTE NO.	SEC.	COUNTY	TOTAL SHEETS	SHEET NO.
F.A. - 57	46-2	KANKAKEE	46	12
STA.	TO STA.			
FED. ROAD DIST. NO. 7	ILLINOIS FED. AID PROJECT			

SHT. 2
 OF 29

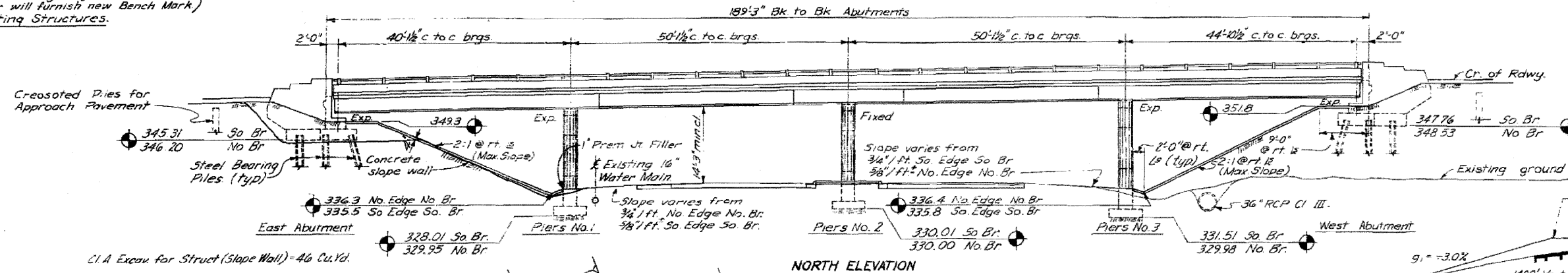

APPROACH SLAB PILING

Type: Creosoted Timber
 Capacity: 15 Tons
 Spacing: See General Layout, this sheet.
 Total No. Req'd: 39
 Estimated Lengths: 25'

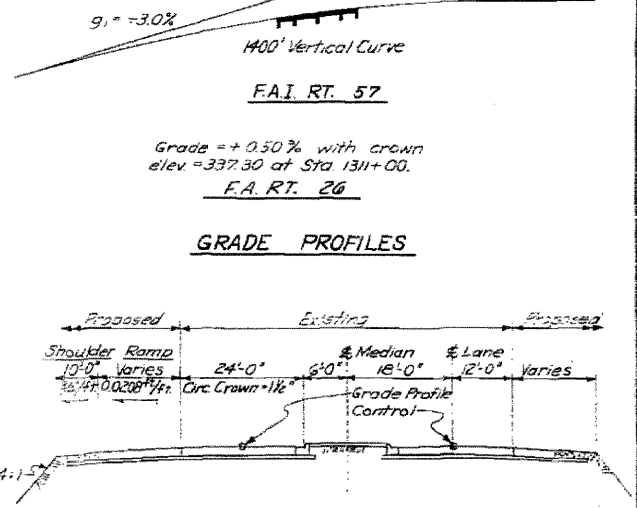
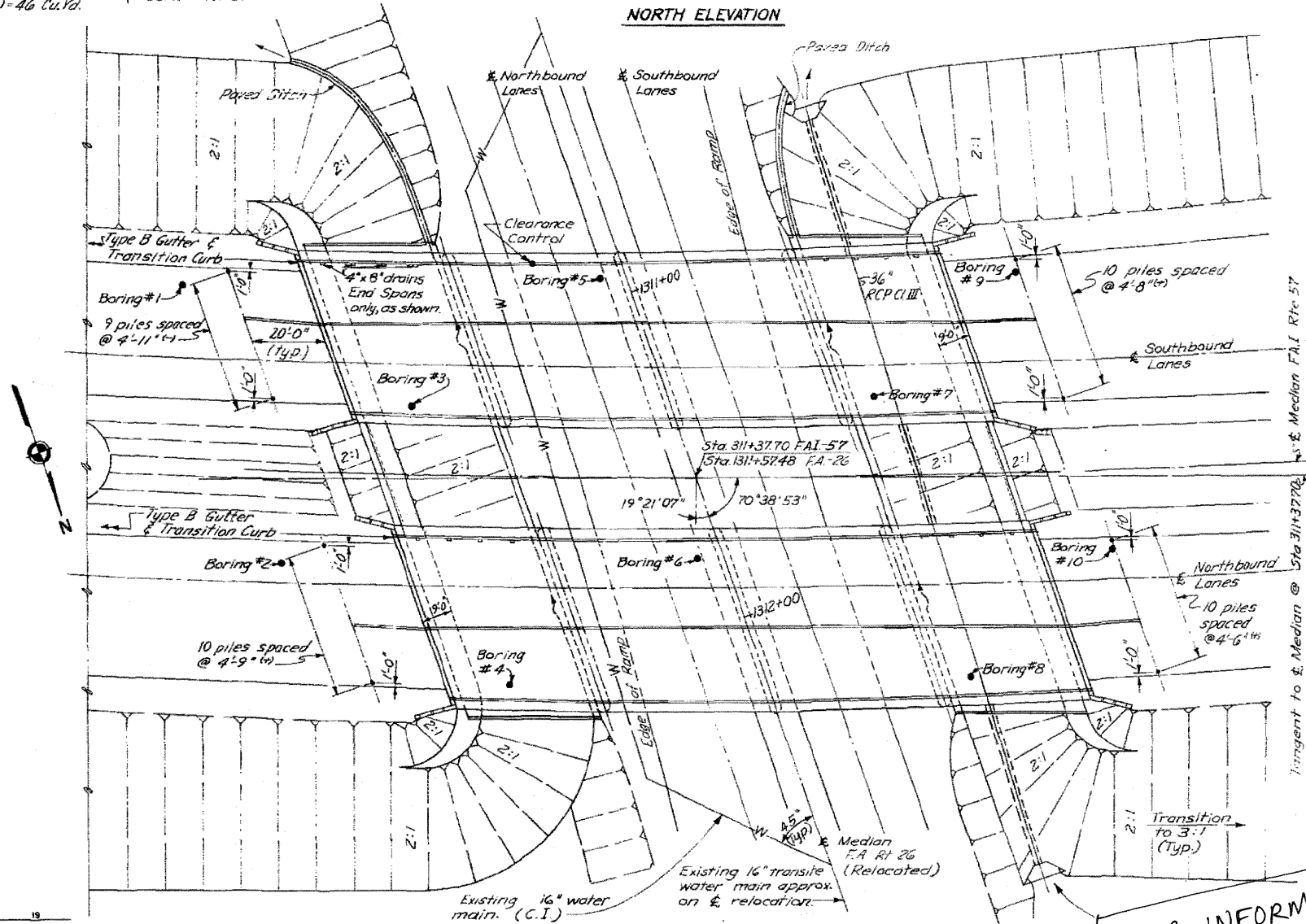

HORIZONTAL CURVE DATA - F.A.I. RT. 57

PI. = Sta. 300+42.50
 Δ = 59°17'30"
 D = 2°00'
 R = 2864.93'
 T = 1630.54'
 L = 2964.58'
 E = 431.39'
 Superelev = 0.03 ft/ft.

BILL OF MATERIAL

Item	Unit	Quantity
Slope Wall (4')	Sq Yds	1.437
Creosoted Piles (20' x 38')	Lin Ft.	975
Class A Excavation	Cu Yds	46

FOR INFORMATION ONLY

ILLINOIS DIVISION OF HIGHWAYS
 ELEVATION AND GENERAL LAYOUT
 FAI. RTE. 57 SEC. 46-2 HB
 KANKAKEE COUNTY
 STA. 311 + 37.70

DESIGNED	L.J.L.	EXAMINED	ENGINEER OF BRIDGE AND TRAFFIC STRUCTURES
CHECKED	K.J.H.	PASSED	ENGINEER OF DESIGN
DRAWN	L.S.	APPROVED	CHIEF HIGHWAY ENGINEER
CHECKED	L.J.L.		

Note: See following sheet for Stations & Elevations

Added 4-26-11

Revised Slope wall between abutments & raised slope wall quantity from 1262 cu yd to 1437 cu yd - 1-28-63 L.A.W.
 Revised approach pile length from 55' to 52' & quantity from 1365 to 975 lin ft.