

STATE OF ILLINOIS  
DEPARTMENT OF PUBLIC WORKS & BUILDINGS  
DIVISION OF HIGHWAYS

Contract 66409 375F.  
ROUTE NO. SEC. COUNTY TOTAL SHEETS  
FA. RTE. 57 46-2VB KANKAKEE 28 3  
STA. 325+93.10  
FED. ROAD DIST. NO. ILLINOIS FED. AID PROJECT NO. 20-107-1000

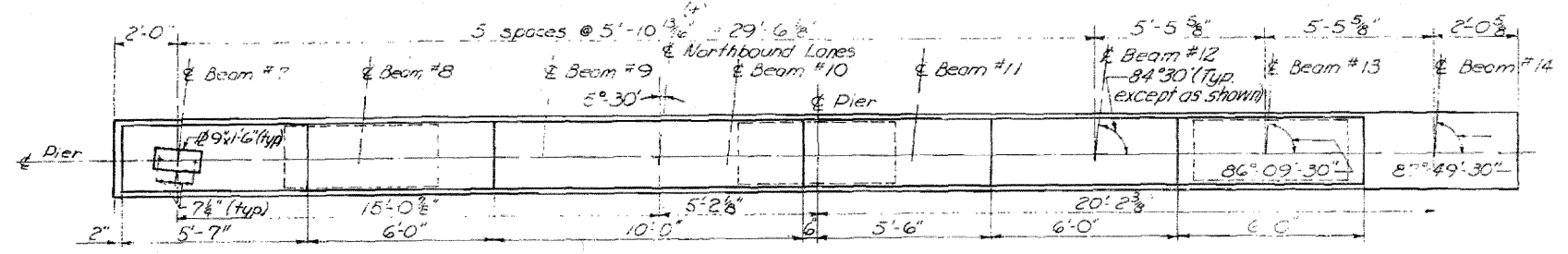

TOP PLAN

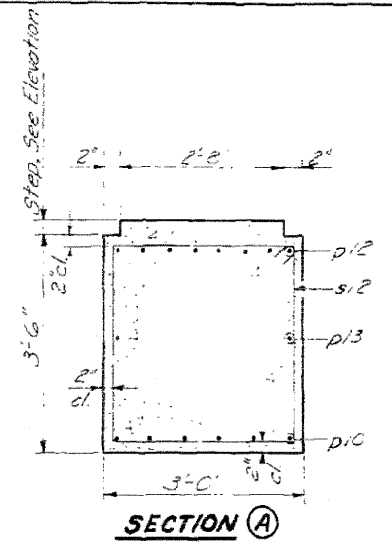

SECTION A

SECTION B

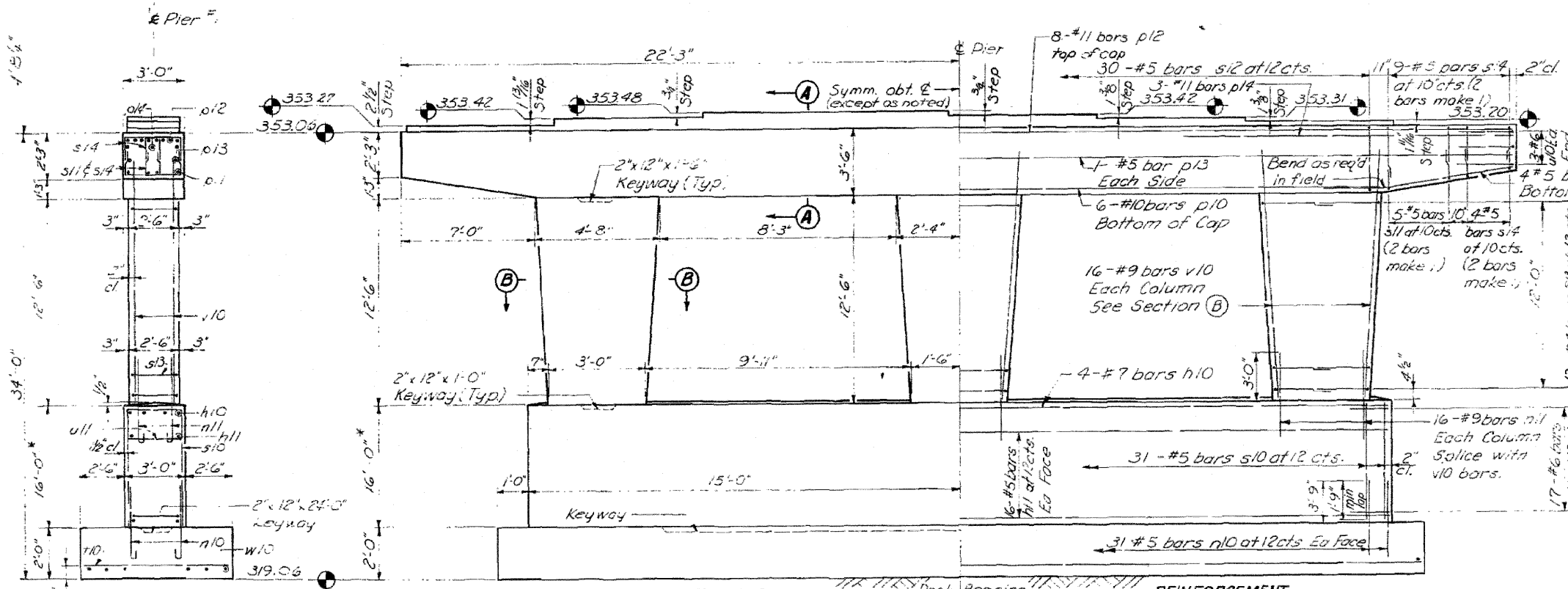

ELEVATION  
(Looking West)

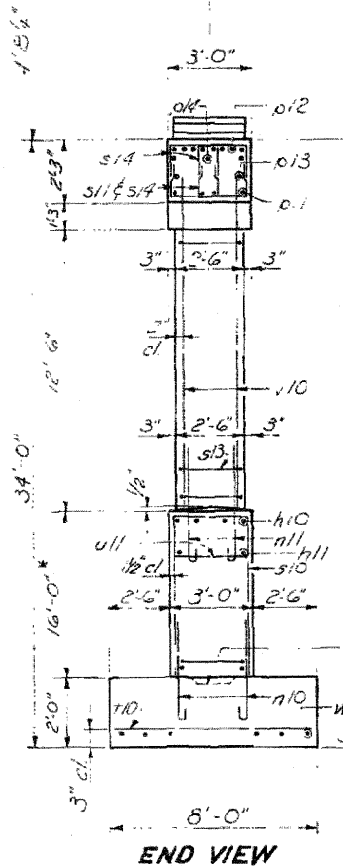

END VIEW

\* Dimension to be varied if field investigation reveals necessary change in bottom of footing elevation. Maximum allowable variation is in accordance with Art. 5.10 (b) of the Standard Specifications.

NOTE:  
All edges shall have standard 3/4" chamfer except footing

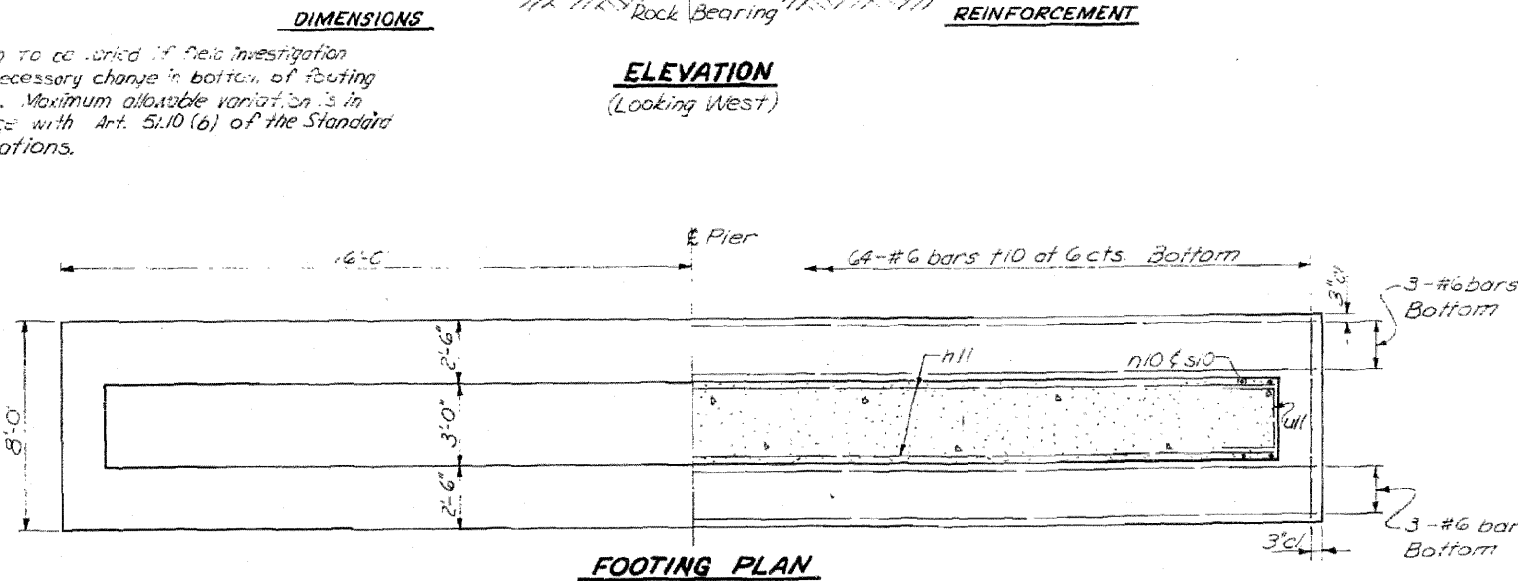

FOOTING PLAN

PIER NO. 1 NORTH BRIDGE  
BILL OF MATERIAL

Bar	No.	Size	Length	Shape
p/2	4	#7	29.3'	—
p/3	32	#5	29.9'	—
p/10	22	#5	6.1'	—
n/1	48	#9	3.5'	—
p/1	6	#10	30.6'	—
p/2	18	#5	8.5'	—
p/3	18	#5	24.2'	—
s/4	6	#7	4.2'	—
s/10	31	#5	3.6'	—
s/11	20	#5	6.6'	—
s/12	30	#5	12.8'	—
s/13	28	#4	7.9'	—
s/14	52	#5	5.4'	—
n/0	64	#6	7.2'	—
n/10	6	#6	5.7'	—
n/11	34	#6	5.2'	—
n/12	48	#9	1.55'	—
w/10	6	#6	3.6'	—

Class 1 Concrete C.S. 1032  
Reinforcement Bars C.S. 1193B  
Type A Excav. for Struct. C.S. 16  
Back Excav. for Struct. C.S. 16

NOTE  
Reinforcing details to show for change in elevation in accordance with Art. 5.10 (b) of the Standard Specifications.

DESIGNED VNS  
CHECKED D.N.  
DRAWN  
CHECKED R.J.H.

EXAMINED  
ENGINEER OF BRIDGE AND TRAFFIC STRUCTURES  
PASSED  
ENGINEER IN CHARGE  
APPROVED  
CHIEF HIGHWAY ENGINEER

Added 4-26-11

FOR INFORMATION ONLY

ILLINOIS DIVISION OF HIGHWAYS  
PIER NO. 1, NORTH BRIDGE  
F.A.I. RTE. 57 SEC. 46-2VB  
KANKAKEE COUNTY  
STA. 325+93.10