

- LEGEND**
- ◀●▶ TEMPORARY TRAFFIC SIGNAL
 - ▨ AREA OF CONSTRUCTION
 - ↔ DIRECTION OF TRAFFIC
 - ▨ PAVEMENT WIDENING
 - TEMPORARY CONCRETE BARRIER
 - ▨ IMPACT ATTENUATOR
 - ▨ GEOTEXTILE RETAINING WALL
 - PEDESTRIAN PUSH BUTTON

PROP. CURVE IL61A
 PI STA. = 768+27.01
 $\Delta = 22^\circ 28' 00''$ (LT)
 $D = 3^\circ 08' 00''$
 $R = 1,828.59'$
 $T = 363.18'$
 $L = 717.02'$
 $E = 35.72'$
 $e = 5.6\%$
 $T.R. = 40'$
 $S.E. RUN = 149'$
 BEGIN SE TRANSITION AT STA. 763+25
 BEGIN FULL SE AT STA. 765+14
 END FULL SE AT STA. 771+31
 END SE TRANSITION AT STA. 773+20
 P.C. STA. = 764+63.83
 P.T. STA. = 771+80.85

- NOTES:**
- INSTALL SOLAR-POWERED YELLOW FLASHING BEACON ON SIGNAL AHEAD SIGN FOR NORTHBOUND IL 61.

STAGE III

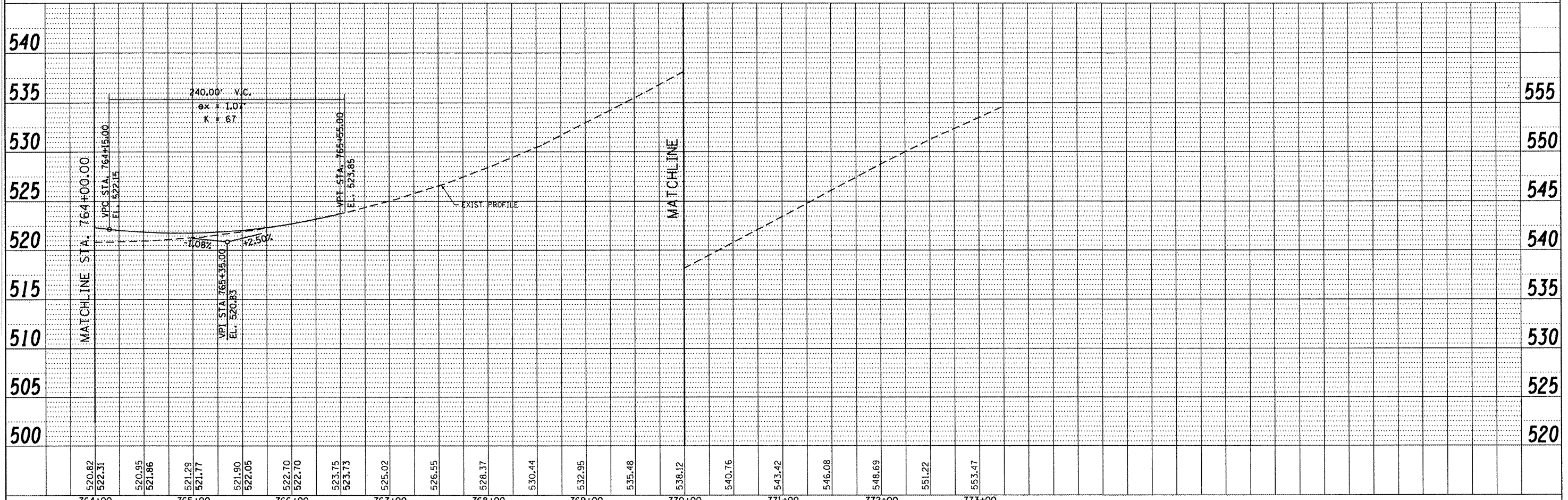

520.82	522.31	520.95	521.86	521.29	521.77	521.90	522.05	522.70	522.70	523.75	523.73	525.02	526.55	528.37	530.44	532.95	535.48	538.12	540.76	543.42	546.08	548.69	551.22	553.47
764+00	764+00	765+00	765+00	766+00	766+00	767+00	767+00	768+00	768+00	769+00	769+00	770+00	770+00	771+00	771+00	772+00	772+00	773+00	773+00					

WHKS & CO.
 ENGINEERING
 7018 KINGSMILL CT.,
 SPRINGFIELD, IL
 (217) 483-9457
 DESIGN FIRM #184001038

STATE OF ILLINOIS
 DEPARTMENT OF TRANSPORTATION

TRAFFIC CONTROL PLANS - STAGE III
 IL 61 OVER LAMOINE RIVER
 SCALE: 1" = 50' SHEET NO. 2 OF 2 SHEETS STA. 764+00.00 TO STA. 773+25.00

F.A. RTE.	SECTION	COUNTY	TOTAL SHEETS	SHEET NO.
542	105BR-1	MCDONOUGH	117	38
CONTRACT NO. 68482			ILLINOIS FED. AID PROJECT	