

SEC 31, T20N, R3E, 3RD PM

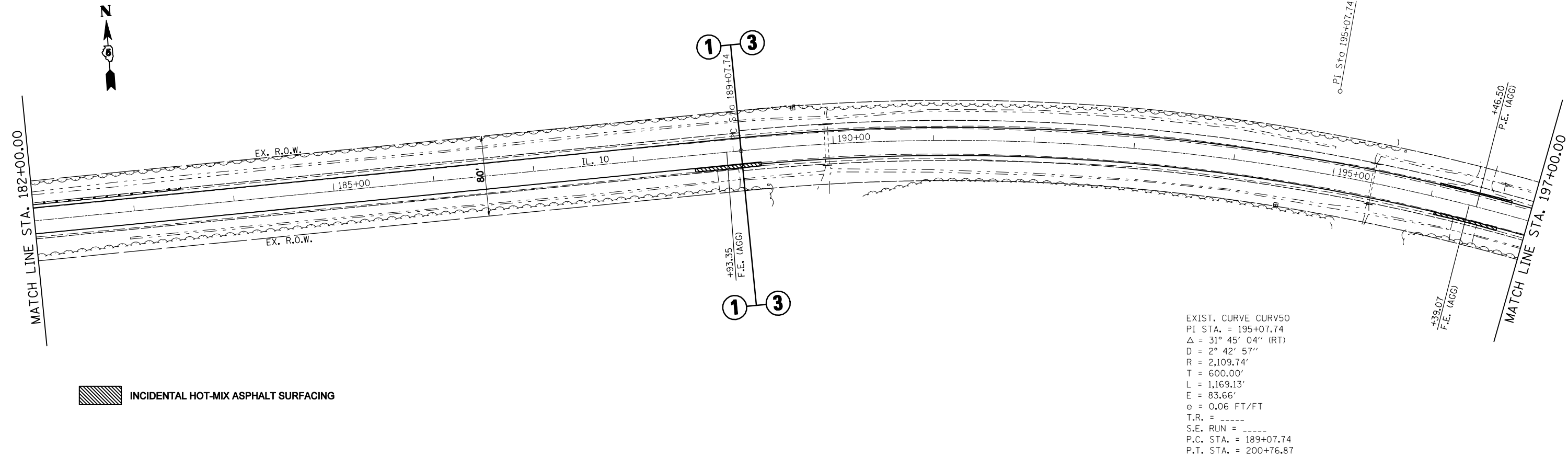

EXIST. CURVE CURV50  
 PI STA. = 195+07.74  
 $\Delta = 31^\circ 45' 04''$  (RT)  
 $D = 2^\circ 42' 57''$   
 $R = 2,109.74'$   
 $T = 600.00'$   
 $L = 1,169.13'$   
 $E = 83.66'$   
 $e = 0.06$  FT/FT  
 $T.R. =$  -----  
 $S.E. RUN =$  -----  
 $P.C. STA. = 189+07.74$   
 $P.T. STA. = 200+76.87$

SEC 5, T19N, R3E, 3RD PM

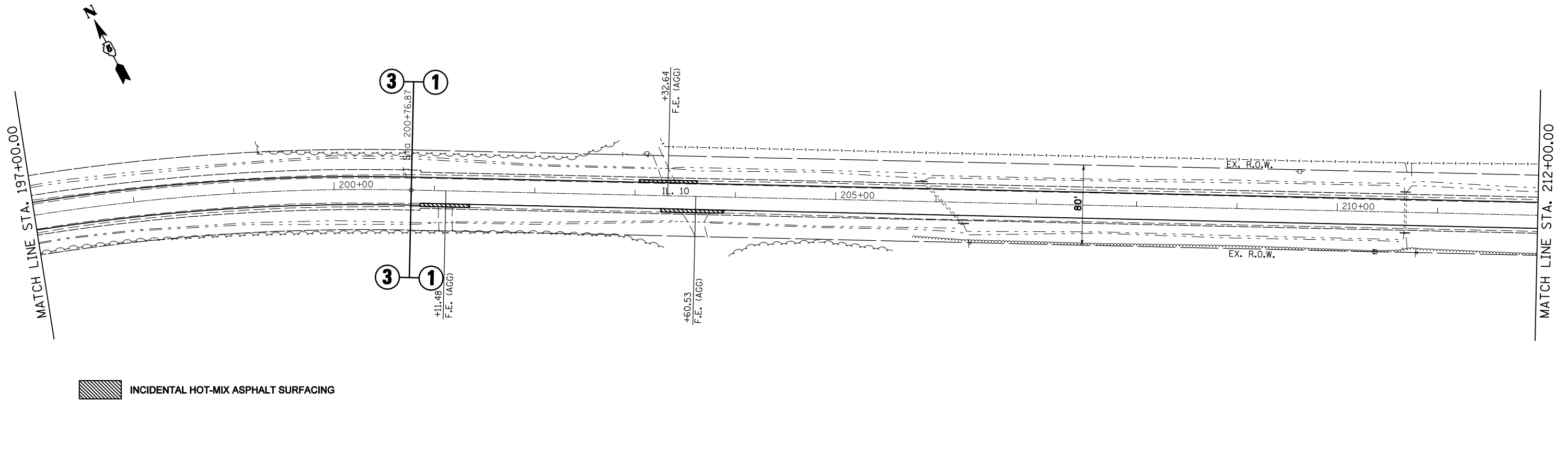

FILE NAME =	USER NAME = coombessf	DESIGNED -	REVISED -
ct:\pw\work\p\dot\coombessf\d0106513\0570660-shr-Plan_50.dgn		DRAWN -	REVISED -
PLOT SCALE = 100.0000' / IN.		CHECKED -	REVISED -
PLOT DATE = 2/3/2011		DATE -	REVISED -

STATE OF ILLINOIS  
 DEPARTMENT OF TRANSPORTATION

PLAN SHEETS

SCALE: SHEET NO. OF SHEETS STA. 182+00.00 TO STA. 212+00.00

F.A.P. RTE.	SECTION	COUNTY	TOTAL SHEETS	SHEET NO.
721	(113RS-4, 124RS)	DeWitt	153	31
CONTRACT NO. 70660			ILLINOIS FED. AID PROJECT	

Sheet: 45 of 7652  
 Date: 11/10/11