

SEC 1, T19N, R3E, 3RD PM

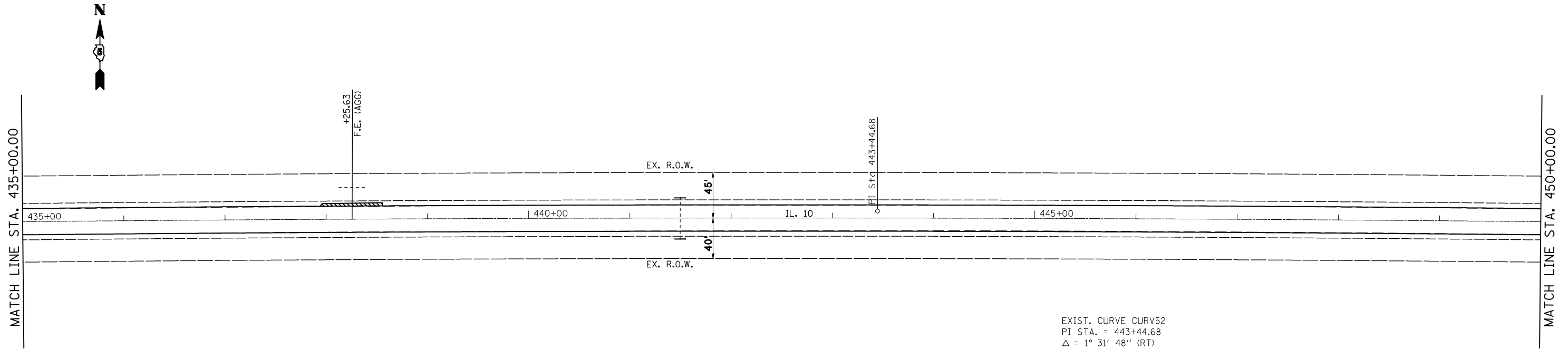

EXIST. CURVE CURV52  
 PI STA. = 443+44.68  
 $\Delta = 1^\circ 31' 48''$  (RT)  
 $D = 0^\circ 04' 27''$   
 $R = 77,185.06'$   
 $T = 1,030.56'$   
 $L = 2,061.00'$   
 $E = 6.88'$   
 $e = \text{-----}$   
 $T.R. = \text{-----}$   
 $S.E. \text{ RUN} = \text{-----}$   
 $P.C. \text{ STA.} = 433+14.12$   
 $P.T. \text{ STA.} = 453+75.12$

INCIDENTAL HOT-MIX ASPHALT SURFACING

SEC 1, T19N, R3E, 3RD PM

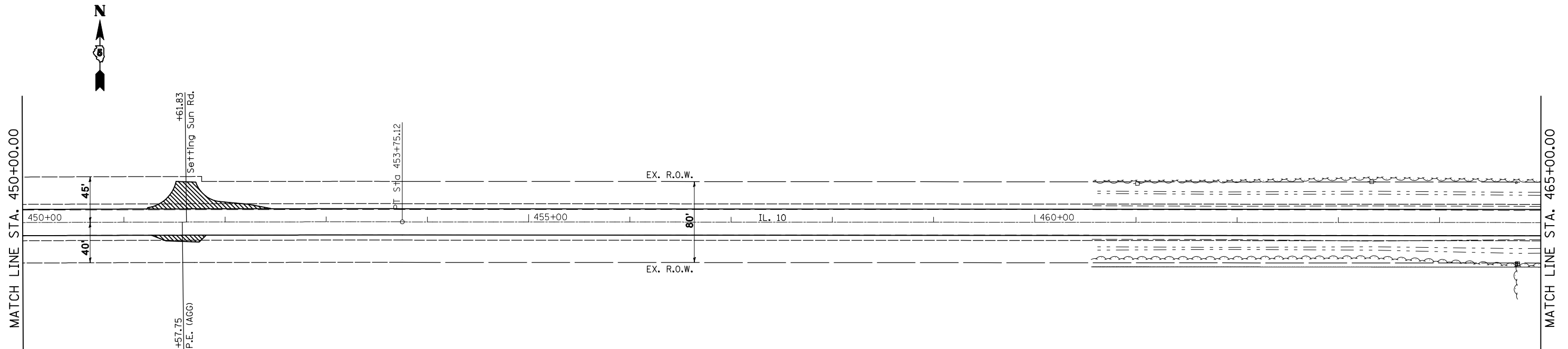

INCIDENTAL HOT-MIX ASPHALT SURFACING

FILE NAME =	USER NAME = coombessf	DESIGNED -	REVISED -
ct:\pw\work\p\dot\coombessf\d0106513\0570660-sh1-Plan_50.dgn		DRAWN -	REVISED -
	PLOT SCALE = 100.0000' / IN.	CHECKED -	REVISED -
	PLOT DATE = 2/3/2011	DATE -	REVISED -

**STATE OF ILLINOIS  
 DEPARTMENT OF TRANSPORTATION**

**PLAN SHEETS**

SCALE: SHEET NO. OF SHEETS STA. 435+00.00 TO STA. 465+00.00

F.A.P. RTE.	SECTION	COUNTY	TOTAL SHEETS	SHEET NO.
721	(113RS-4, 124RS)	DeWitt	153	40
CONTRACT NO. 70660			ILLINOIS FED. AID PROJECT	

Sheet: 13 of 1562