

SEC 6 , T19N, R4E, 3RD PM

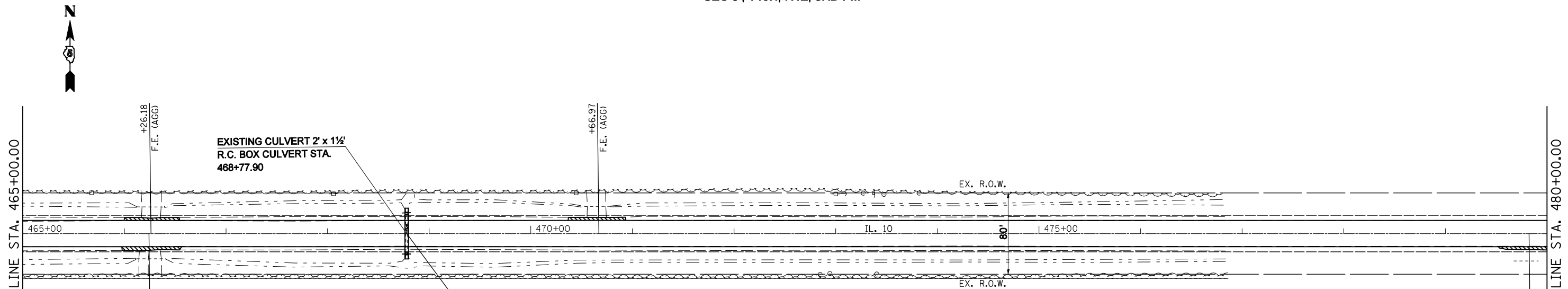

INCIDENTAL HOT-MIX ASPHALT SURFACING

REMOVAL OF EXISTING STRUCTURES NO. 3

PROPOSED PRECAST BOX CULVERT (M273)
 W/ PRECAST END SECTIONS
 3' X 2' X 38.0' (LT - 19', RT - 19')
 STA. 468+77.90
 U.S.F.L. = 718.30
 D.S.F.L. = 718.36

		Existing Low Grade Elev. = 721.67 ft. @ Sta. 469+64							
Drainage Area = 0.02 mi. ²		Proposed Low Grade Elev. = 721.67 ft. @ Sta. 469+64							
Flood	Freq.	Q	Opening Sq. Ft.		Natural H.W.E.	Head - Ft.		Headwater Elevation	
	Yr.	C.F.S.	Existing	Proposed		Existing	Proposed	Existing	Proposed
	10	13	3	5				722.7	720.4
Design	50	22	3	5				Over	721.1
Base	100	26	3	5				Over	721.6
Overtopping									
Max. Calc.	500	35	3	5				Over	Over
10 YEAR VELOCITY THROUGH EXISTING BRIDGE : 5 ft/s					10 YEAR VELOCITY THROUGH PROPOSED BRIDGE : 3.7 ft/s				
ALL-TIME H.W.E. & DATE : Unknown									

SEC 6 , T19N, R4E, 3RD PM

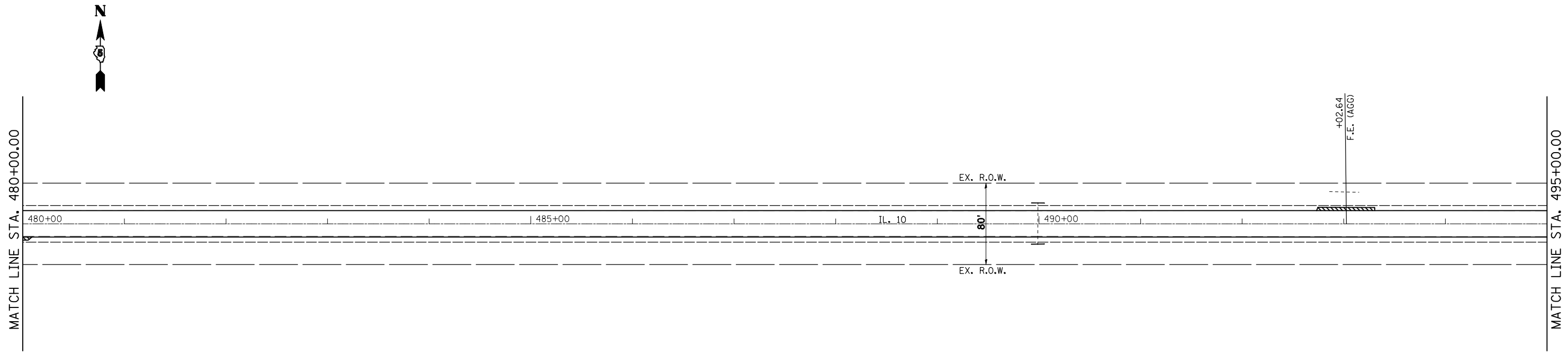

INCIDENTAL HOT-MIX ASPHALT SURFACING

FILE NAME =	USER NAME = coombessf	DESIGNED -	REVISED -
ct:\pw\work\p\dot\coombessf\d0106513\0570660-sh1-Plan_50.dgn		DRAWN -	REVISED -
PLOT SCALE = 100.0000' / IN.		CHECKED -	REVISED -
PLOT DATE = 2/3/2011		DATE -	REVISED -

STATE OF ILLINOIS
DEPARTMENT OF TRANSPORTATION

PLAN SHEETS

SCALE: SHEET NO. OF SHEETS STA. 465+00.00 TO STA. 495+00.00

F.A.P. RTE.	SECTION	COUNTY	TOTAL SHEETS	SHEET NO.
721	(113RS-4, 124RS)	DeWitt	153	41
CONTRACT NO. 70660			ILLINOIS FED. AID PROJECT	