

STATE OF ILLINOIS
DEPARTMENT OF TRANSPORTATION
DIVISION OF HIGHWAYS

F.A. RTE.	SECTION	COUNTY	TOTAL SHEETS	SHEET NO.
CH 19	40PT	DOUGLAS	25	1
		ILLINOIS	CONTRACT NO. 70875	

FOR INDEX OF SHEETS, SEE SHEET NO. 2
 FOR SUMMARY OF QUANTITIES, SEE SHEET NO. 4-5

TRAFFIC DATA (2010):	
ADT =	450
PU & PC% =	79.9 (359)
SUZ =	9.3 (42)
MUZ =	10.8 (49)

PROPOSED
HIGHWAY PLANS

C.H. 19 (FICKLIN ROAD)
SECTION 40PT

DOUGLAS COUNTY

C-95-052-10
RESURFACING (3P) & MEDIAN REMOVAL
FROM CSX RR TO US 36



DESIGN DESIGNATION:
 RURAL MINOR COLLECTOR

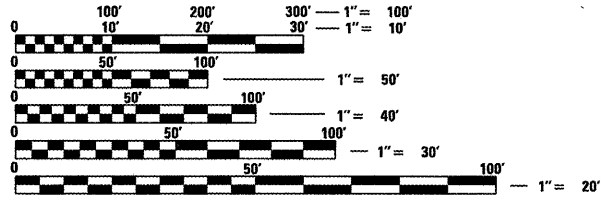

FULL SIZE PLANS HAVE BEEN PREPARED USING STANDARD ENGINEERING SCALES. REDUCED SIZED PLANS WILL NOT CONFORM TO STANDARD SCALES. IN MAKING MEASUREMENTS ON REDUCED PLANS, THE ABOVE SCALES MAY BE USED.

J.U.L.I.E.
 JOINT UTILITY LOCATION INFORMATION FOR EXCAVATION
 1-800-892-0123
 OR 811

SECTION 40PT
 BEGIN STATION 0+32.00

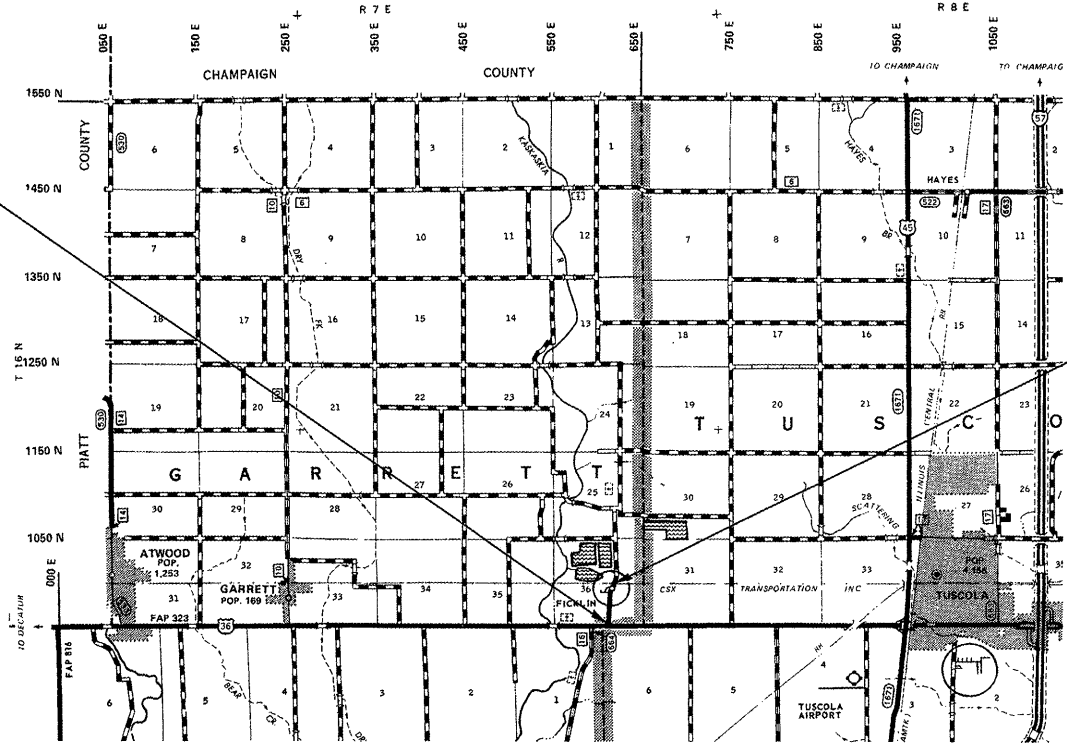

SECTION 40PT
 END STATION 26+36.00

PROJECT ENGINEER: KEVIN TRAPP (217-465-4181)
PROJECT DESIGNER: DANA HENNESS

GROSS LENGTH = 2,604.00 FT. = 0.493 MILE
 NET LENGTH = 2,604.00 FT. = 0.493 MILE

CONTRACT NO. 70875

STATE OF ILLINOIS
DEPARTMENT OF TRANSPORTATION
DIVISION OF HIGHWAYS

SUBMITTED 1/25 20 11
Quayle Crowe
 DEPUTY DIRECTOR OF HIGHWAYS, REGION ENGINEER

March 25 20 11
Scott E. Stitt P.E.
 ENGINEER OF DESIGN AND ENVIRONMENT

March 25 20 11
Christine M. Reed
 DIRECTOR OF HIGHWAYS, CHIEF ENGINEER

PRINTED BY THE AUTHORITY
OF THE STATE OF ILLINOIS