

# LOCATION MAP 3 - (NORTH LEG) - CHAMPAIGN COUNTY

## FAI-57 FROM 2 MILE SOUTH OF THOMASBORO TO US 136

CONCRETE PATCH OMISSIONS  
 STA. 1015+88.00 TO STA. 1017+69.00 (NB)  
 STA. 1127+91.00 TO STA. 1129+71.00 (NB)  
 STA. 1234+55.00 TO STA. 1236+35.00 (NB)  
 STA. 1015+88.00 TO STA. 1017+69.00 (SB)  
 STA. 1127+63.00 TO STA. 1129+43.00 (SB)  
 STA. 1234+55.00 TO STA. 1236+35.00 (SB)

END PROJECT  
 STA. 1270+77.24

SN 010-0164  
 STA. 1235+45.33

SN 010-0165  
 STA. 1128+67.19

SN 010-0156  
 STA. 1016+78.72

STATION EQUATION  
 STA. 966+67.89(BK)=  
 STA. 966+67.62(AH)

BEGIN PROJECT  
 SB STA. 918+62.00

BEGIN PROJECT  
 NB STA. 902+84.00

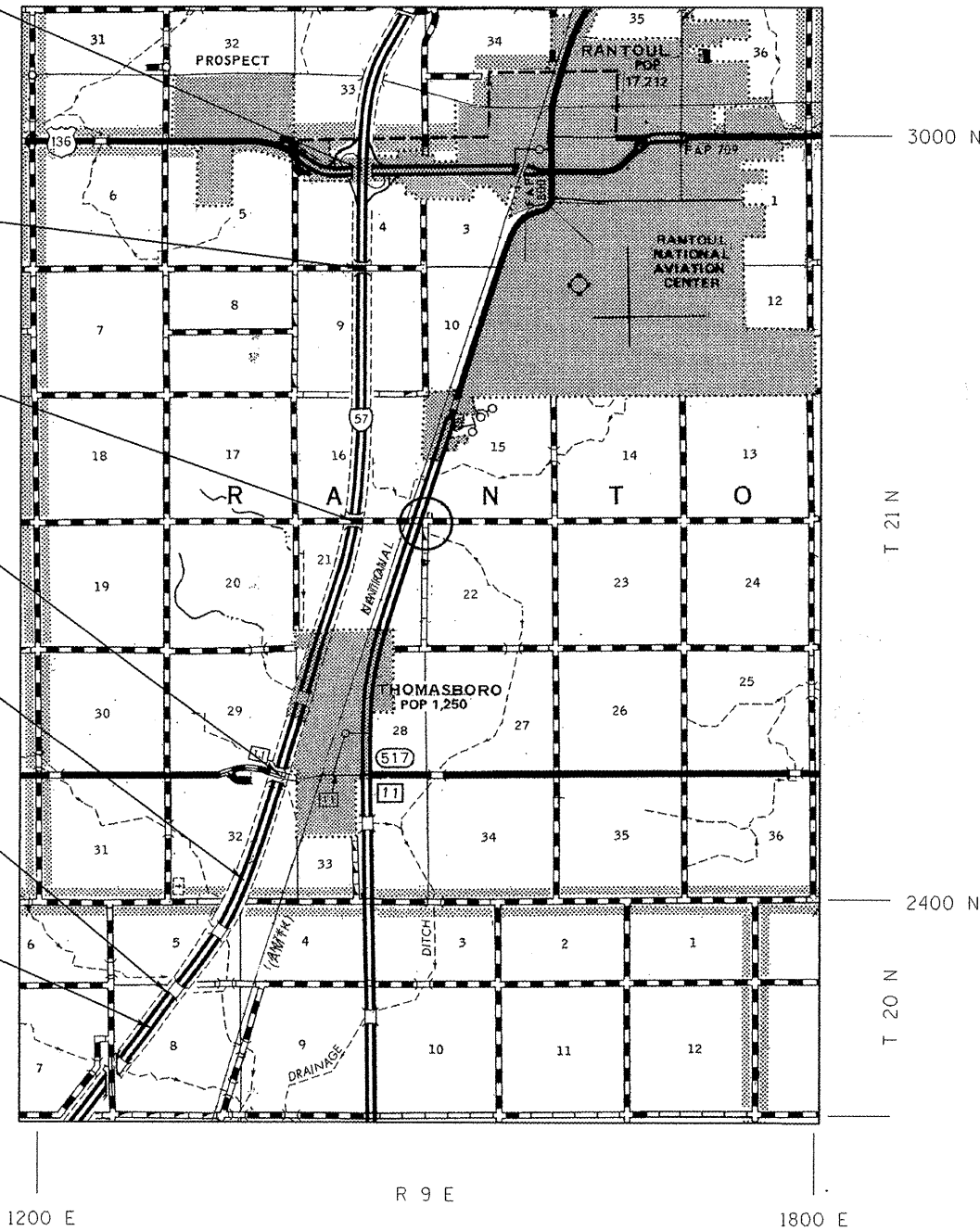

**SCALE**  
 1.28125" = 1.0 MI  
 0 0.5 1.0

GROSS LENGTH OF LOCATION #3 (NORTH LEG) = 36793.51 FT. = 6.968 MILE  
 NET LENGTH OF LOCATION #3 (NORTH LEG) = 36252.51 FT. = 6.866 MILE

- \* D5 CRACK & JOINT SEAL 2011-2
- \*\* CHAMPAIGN, DOUGLAS, & VERMILION

FILE NAME =	USER NAME = ppersonbr	DESIGNED -	REVISED -
at:\pr\work\pvidot\personbr\d0252772\05	0881-shr-cover.dgn	DRAWN -	REVISED -
	PLOT SCALE = 40.0000" / 1"	CHECKED -	REVISED -
	PLOT DATE = 2/4/2011	DATE -	REVISED -

**STATE OF ILLINOIS**  
**DEPARTMENT OF TRANSPORTATION**

<b>LOCATION MAP #3 - NORTH LEG</b>			
SCALE:	SHEET NO. 2 OF 2 SHEETS	STA. 902+84.00 TO STA. 1270+77.24	

F.A. RTE.	SECTION	COUNTY	TOTAL SHEETS	SHEET NO.
VAR.	*	**	29	6
CONTRACT NO. 70881				
ILLINOIS FED. AID PROJECT				