

LOCATION MAP 5 – DOUGLAS COUNTY

FAP 808 (IL 130) FROM VILLA GROVE NCL TO US 36

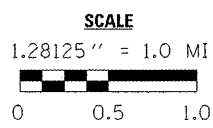
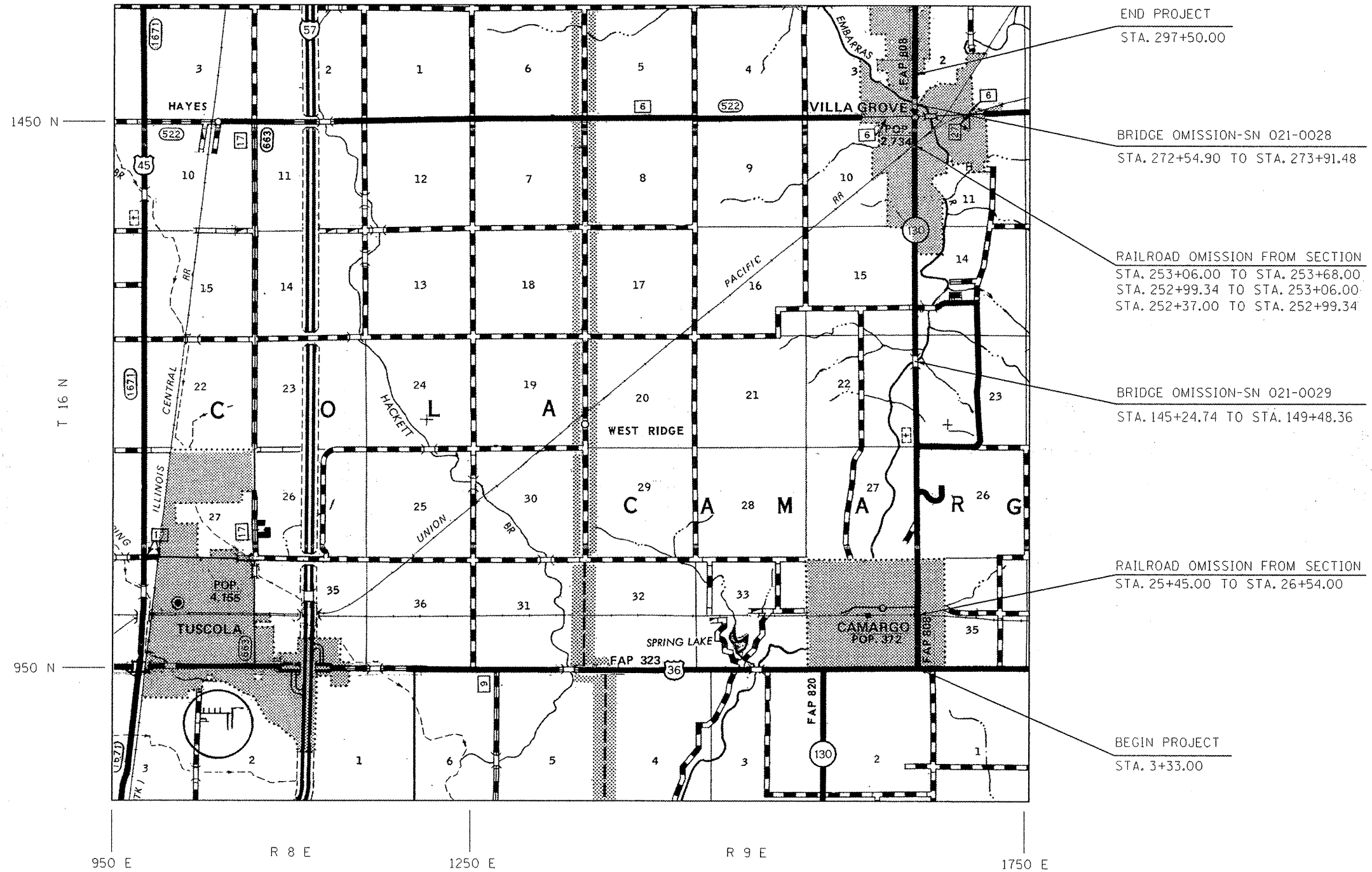

GROSS LENGTH OF LOCATION #5 = 29417.00 FT. = 5.571 MILE
NET LENGTH OF LOCATION #5 = 28616.80 FT. = 5.420 MILE

- * D5 CRACK & JOINT SEAL 2011-2
- ** CHAMPAIGN, DOUGLAS, & VERMILION

| | | | | | | | | | | | | |
|--|-----------------------------|------------|-----------|---|---------------------------|-------------------|--------------------|-----------|---------|--------|--------------|-----------|
| FILE NAME = | USER NAME = piersonbr | DESIGNED - | REVISED - | STATE OF ILLINOIS DEPARTMENT OF TRANSPORTATION | LOCATION MAP 5 | | | F.A. RTE. | SECTION | COUNTY | TOTAL SHEETS | SHEET NO. |
| et:\p\work\p\ridot\piersonbr\08252772\08 | 0881-sht-cover.dgn | DRAWN - | REVISED - | | SCALE: | SHEET NO. OF | SHEETS | VAR. | * | ** | 29 | 8 |
| | PLOT SCALE = 40,0000 "/ in. | CHECKED - | REVISED - | | STA. 3+33.00 | TO STA. 297+50.00 | CONTRACT NO. 70881 | | | | | |
| | PLOT DATE = 2/4/2011 | DATE - | REVISED - | | ILLINOIS FED. AID PROJECT | | | | | | | |
| | | | | | | | | | | | | |