

# LOCATION MAP 6 – DOUGLAS COUNTY

## FAP 880 ( IL 130 ) FROM COLES COUNTY LINE TO US 36

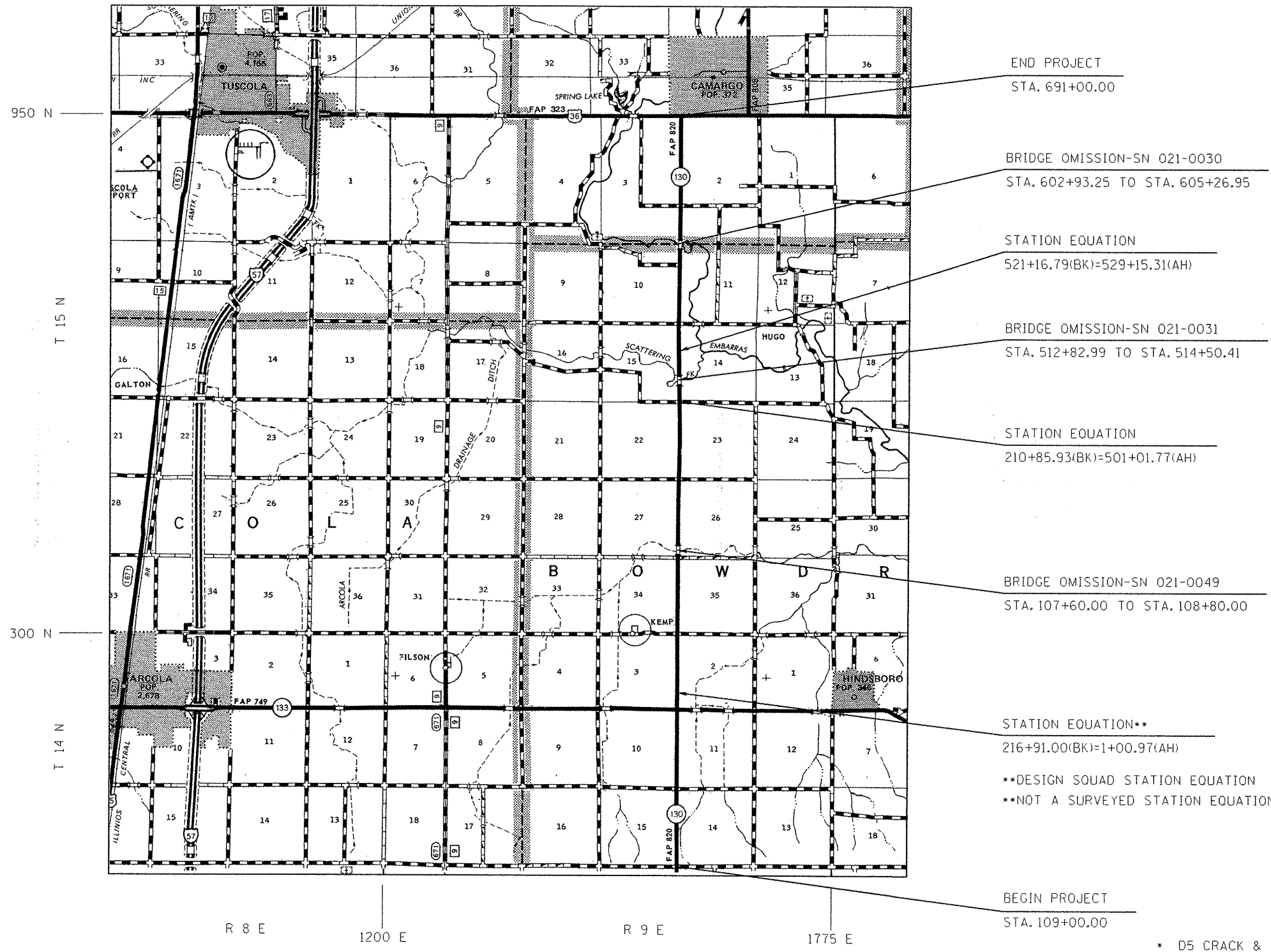

GROSS LENGTH OF LOCATION #6 = 50775.67 FT. = 9.617 MILE  
 NET LENGTH OF LOCATION #6 = 50254.55 FT. = 9.518 MILE

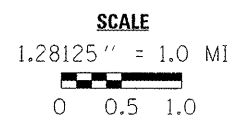

FILE NAME : c:\pv\work\pilot\pierson\ld0252772\09	USER NAME : piersonr 0881-shr-cover.dgn	DESIGNED -	REVISED -	<b>STATE OF ILLINOIS DEPARTMENT OF TRANSPORTATION</b>	<b>LOCATION MAP 6</b>	F.A. RTE.	SECTION	COUNTY	TOTAL SHEETS	SHEET NO.
		DRAWN -	REVISED -			VAR.	*	**	29	9
		CHECKED -	REVISED -		SCALE:	SHEET NO. OF SHEETS		STA. 109+00.00 TO STA. 691+00.00		
		PLOT DATE : 2/4/2011	DATE -			CONTRACT NO. 70881				
ILLINOIS FED. AID PROJECT										

- \* D5 CRACK & JOINT SEAL 2011-2
- \*\* CHAMPAIGN, DOUGLAS, & VERMILION