

STATE OF ILLINOIS  
DEPARTMENT OF TRANSPORTATION  
DIVISION OF HIGHWAYS

**PROPOSED  
HIGHWAY PLANS**

VARIOUS ROUTES  
SECTION D5 CRACK & JOINT SEAL 2011-2  
ROUT & SEAL  
CHAMPAIGN, DOUGLAS, VERMILION COUNTIES

C-95-058-10

SEE PAGES 3-9 FOR LOCATION MAPS, GROSS & NET LENGTHS OF PROJECT BY LOCATION

F.A. RTE.	SECTION	COUNTY	TOTAL SHEETS	SHEET NO.
VAR.	.	**	29	1
		ILLINOIS	CONTRACT NO. 70881	

\* D5 CRACK & JOINT SEAL 2011-2  
\*\* CHAMPAIGN, DOUGLAS, & VERMILION  
D-95-058-10

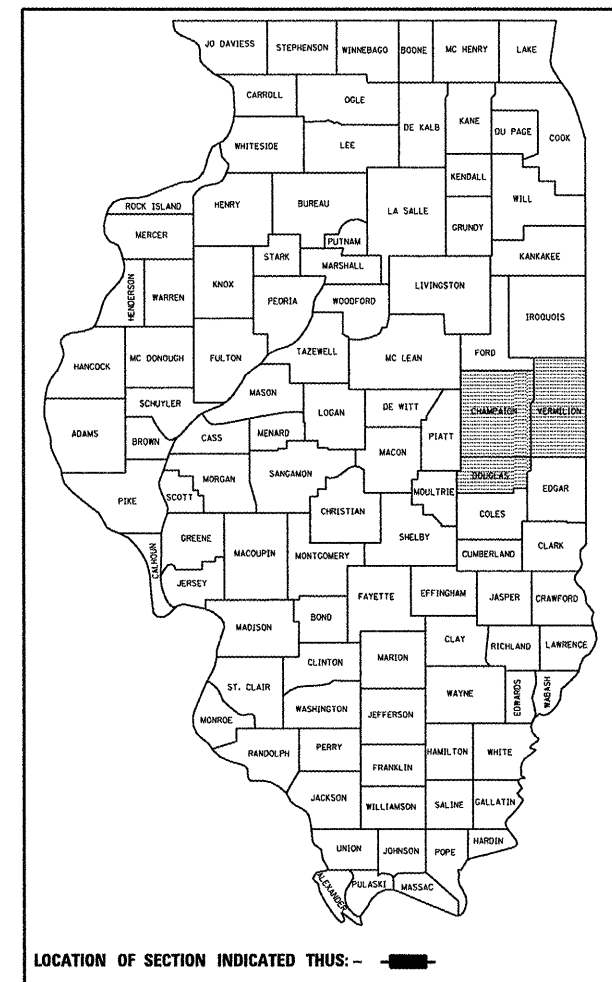

FOR INDEX OF SHEETS, SEE SHEET NO. 2

LOCATION 1: FAP 332 (US 150 / IL 1)  
AVERAGE ADT = 12,000 (2010)  
FROM GEORGETOWN NCL TO WETVILLE SCL

LOCATION 2: FAS 518 (CH 22)  
AVERAGE ADT = 1000 (2010)  
FROM ROYAL ROAD TO I-74 INTERCHANGE

LOCATION 3: FAI-57 SOUTH LEG  
AVERAGE ADT = 32500 (2010)  
FROM SO. OF I-74 TO OLYMPIA DRIVE

LOCATION 3: FAI-57 NORTH LEG  
AVERAGE ADT = 20800 (2010)  
FROM SO. OF THOMASBORO TO US 136

LOCATION 4: FAP 332 (US 136 / IL 1)  
AVERAGE ADT = 20000 (2010)  
FROM WINTER AVE. TO MAIN STREET

LOCATION 5: FAP 808 (IL 130)  
AVERAGE RURAL ADT = 2800 (2010)  
AVERAGE URBAN ADT = 5000 (2010)  
FROM VILLA GROVE NCL TO US 36

LOCATION 6: FAP 820 (IL 130)  
AVERAGE ADT = 2300 (2010)  
FROM COLES COUNTY LINE TO US 36

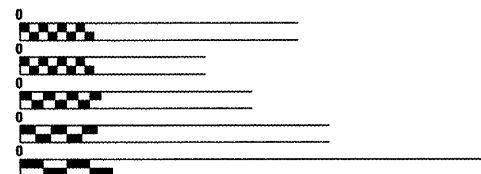

FULL SIZE PLANS HAVE BEEN PREPARED USING STANDARD ENGINEERING SCALES. REDUCED SIZED PLANS WILL NOT CONFORM TO STANDARD SCALES. IN MAKING MEASUREMENTS ON REDUCED PLANS, THE ABOVE SCALES MAY BE USED.

J.U.L.I.E.  
JOINT UTILITY LOCATION INFORMATION FOR EXCAVATION  
1-800-892-0123  
OR 811

PROJECT ENGINEER: NANCY FASIG  
PROJECT MANAGER: TODD BLACK  
PHONE NUMBER: (217)-465-4181  
CONTRACT NO. 70881

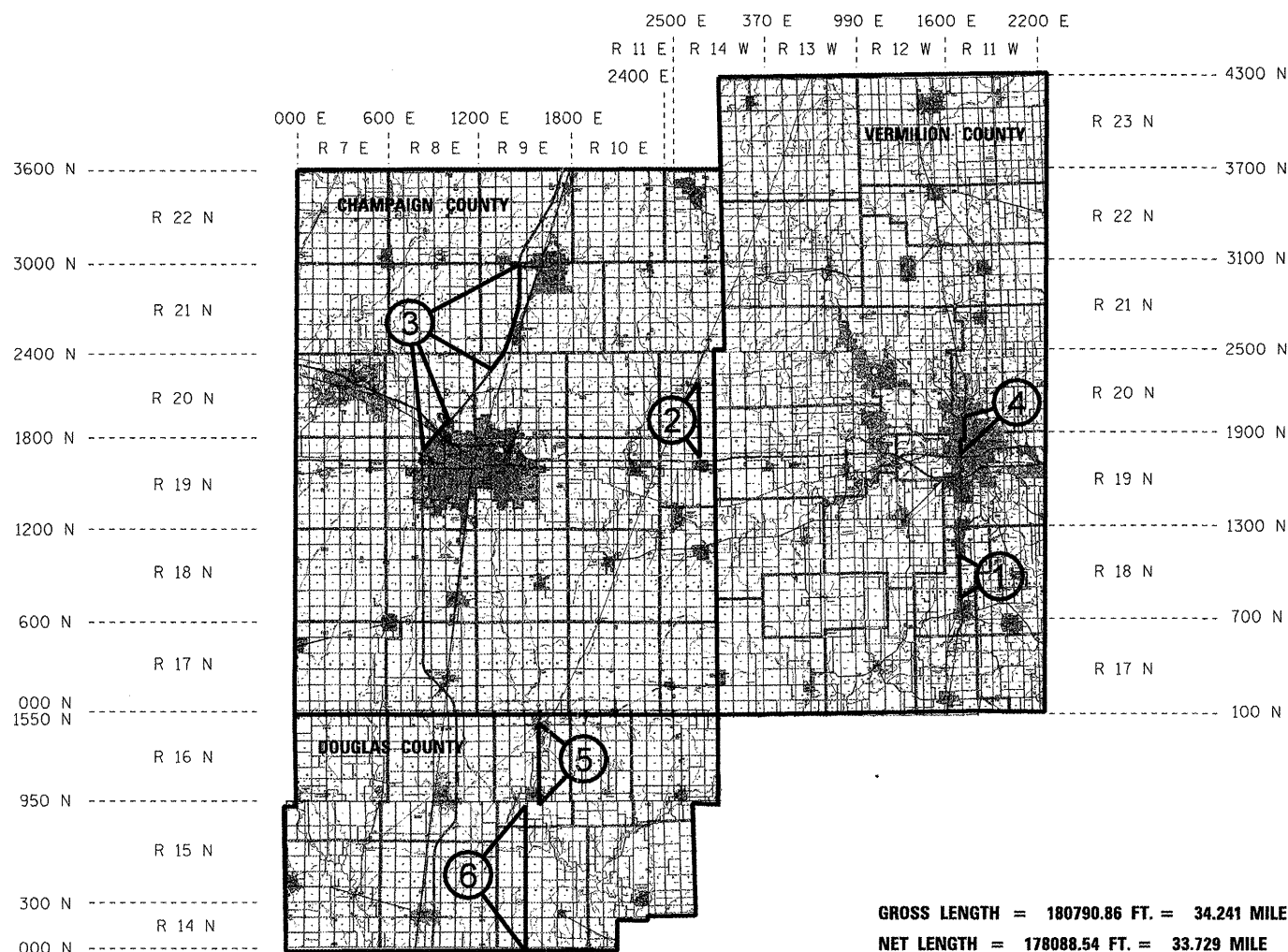

GROSS LENGTH = 180790.86 FT. = 34.241 MILE  
NET LENGTH = 178088.54 FT. = 33.729 MILE

STATE OF ILLINOIS  
DEPARTMENT OF TRANSPORTATION  
DIVISION OF HIGHWAYS

SUBMITTED 02/01 20 11

Joseph E. Crowe (RAG)  
DEPUTY DIRECTOR OF HIGHWAYS, REGION ENGINEER

March 05 20 11  
Scott E. Stitt P.E. I.C.  
ENGINEER OF DESIGN AND ENVIRONMENT

March 05 20 11  
Christine M. Reed I.C.  
DIRECTOR OF HIGHWAYS, CHIEF ENGINEER

PRINTED BY THE AUTHORITY  
OF THE STATE OF ILLINOIS

## INDEX OF SHEETS

1	COVER SHEET
2	INDEX OF SHEETS / HIGHWAY STANDARDS
3 - 9	LOCATION MAPS
10	GENERAL NOTES
11	SUMMARY OF QUANTITIES
12 - 13	SCHEDULE OF QUANTITIES
14 - 23	TYPICAL CROSS SECTIONS
24	TYPICAL DETAIL FOR CRACK AND JOINT SEALING
25 - 29	TYPICAL APPLICATIONS OF PAVEMENT MARKINGS AND MARKERS

## HIGHWAY STANDARDS

000001 - 06	STANDARD SYMBOLS, ABBREVIATIONS, AND PATTERNS
001006	DECIMAL OF AN INCH AND OF A FOOT
701306 - 03	LANE CLOSURE, 2L, 2W, SLOW MOVING OPERATIONS DAY ONLY, FOR SPEEDS > 45 MPH
701311 - 03	LANE CLOSURE, 2L, 2W, MOVING OPERATIONS - DAY ONLY
701400 - 05	APPROACH TO LANE CLOSURE, FREEWAY / EXPRESSWAY
701406 - 06	LANE CLOSURE, FREEWAY / EXPRESSWAY - DAY ONLY
701411 - 07	LANE CLOSURE, MULTI-LANE, AT ENTRANCE OR EXIT RAMP, FOR SPEEDS > 45 MPH
701426 - 04	LANE CLOSURE, MULTI LANE, INTERMITTANT OR MOVING OPERATION FOR SPEEDS > 45 MPH
701427	LANE CLOSURE, MULTI LANE, INTERMITTANT OR MOVING OPERATION FOR SPEEDS < 45 MPH
701501 - 06	URBAN LANE CLOSURE, 2L, 2W UNDIVIDED
701602 - 05	URBAN LANE CLOSURE, MULTI-LANE, 2W WITH BIDIRECTIONAL LEFT TURN LANE
701606 - 07	URBAN LANE CLOSURE, MULTI-LANE, 2W WITH MOUNTABLE MEDIAN
701701 - 07	URBAN LANE CLOSURE, MULTI-LANE INTERSECTION
701901 - 01	TRAFFIC CONTROL DEVICES
780001 - 02	TYPICAL PAVEMENT MARKINGS

- \* D5 CRACK & JOINT SEAL 2011-2
- \*\* CHAMPAIGN, DOUGLAS, & VERMILION

FILE NAME =	USER NAME = piersonbr	DESIGNED - JAH	REVISED -	<b>STATE OF ILLINOIS DEPARTMENT OF TRANSPORTATION</b>	<b>INDEX OF SHEETS / HIGHWAY STANDARDS</b>	F.A.P. RTE.	SECTION	COUNTY	TOTAL SHEETS	SHEET NO.	
c:\pr\work\puidot\piersonbr\0252772\05	0881-sh1-cover.dgn	DRAWN -	REVISED -			VAR.	*	**	29	2	
PLOT SCALE = 40.0000' / in.	CHECKED -	REVISED -	REVISED -			CONTRACT NO. 70881					
PLOT DATE = 2/4/2011	DATE - 1-13-10	REVISED -	REVISED -			ILLINOIS FED. AID PROJECT					
					SCALE:	SHEET NO. OF SHEETS		STA. TO STA.			

# LOCATION MAP 1 – VERMILION COUNTY

## FAP 332 ( IL 1 ) FROM GEORGETOWN NCL TO WESTVILLE SCL

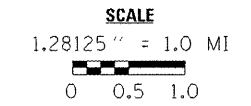
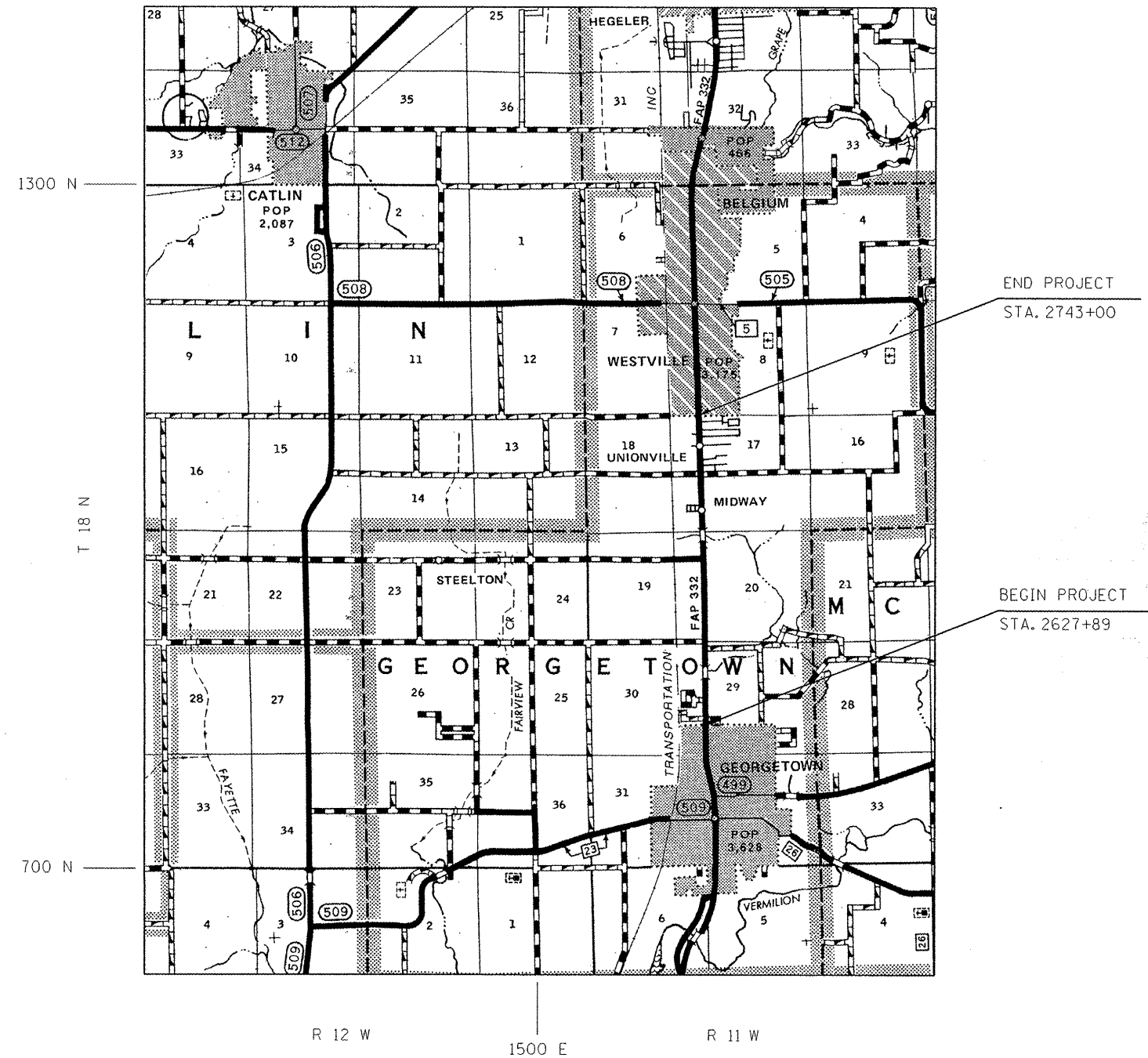

GROSS LENGTH OF LOCATION #1 = 11511.00 FT. = 2.180 MILE  
 NET LENGTH OF LOCATION #1 = 11511.00 FT. = 2.180 MILE

- \* D5 CRACK & JOINT SEAL 2011-2
- \*\* CHAMPAIGN, DOUGLAS, & VERMILION

FILE NAME :	USER NAME :	DESIGNED :	REVISED :
ct:\p-work\p\p\dot\personbr\d0252772\05	piersonbr	-	-
	70881-shr-cover.dgn	DRAWN :	REVISED :
		-	-
	PLOT SCALE : 40.0000" / 1in.	CHECKED :	REVISED :
		-	-
	PLOT DATE : 2/4/2011	DATE :	REVISED :
		-	-

**STATE OF ILLINOIS  
 DEPARTMENT OF TRANSPORTATION**

<b>LOCATION MAP 1</b>			
SCALE:	SHEET NO. OF	SHEETS	STA. 2627+89 TO STA. 2743+00

F.A. RTE.	SECTION	COUNTY	TOTAL SHEETS	SHEET NO.
VAR.	*	**	29	3
CONTRACT NO. 70881				
ILLINOIS FED. AID PROJECT				

# LOCATION MAP 2 – CHAMPAIGN COUNTY

## FAS 518 ( CH 22 ) FROM ROYAL ROAD TO I-74 NORTH OF OGDEN

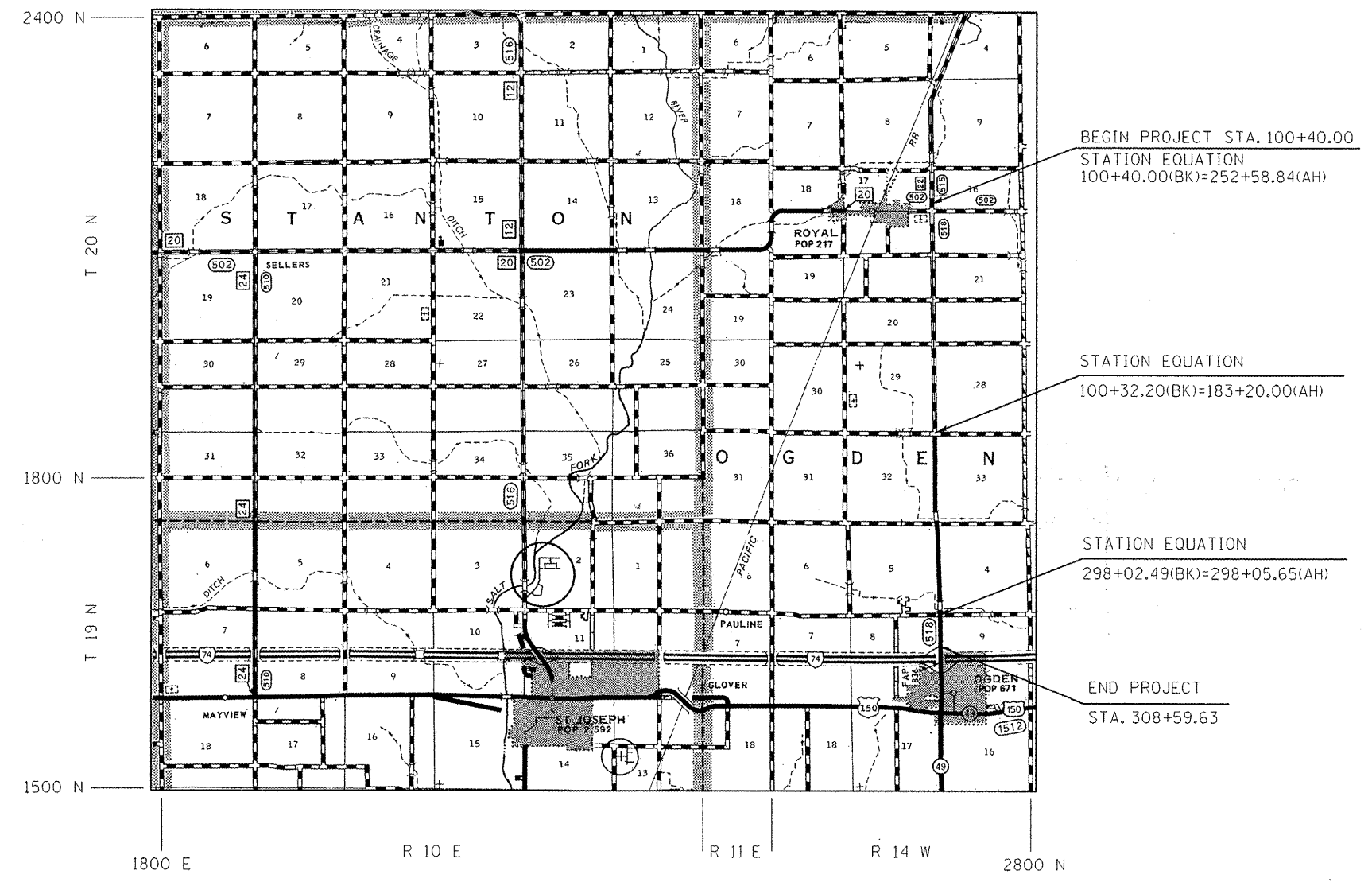

BEGIN PROJECT STA. 100+40.00  
STATION EQUATION  
100+40.00(BK)=252+58.84(AH)

STATION EQUATION  
100+32.20(BK)=183+20.00(AH)

STATION EQUATION  
298+02.49(BK)=298+05.65(AH)

END PROJECT  
STA. 308+59.63

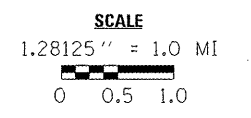

GROSS LENGTH OF LOCATION #2 = 27763.11 FT. = 5.258 MILE  
NET LENGTH OF LOCATION #2 = 27763.11 FT. = 5.258 MILE

\* D5 CRACK & JOINT SEAL 2011-2  
\*\* CHAMPAIGN, DOUGLAS, & VERMILION

FILE NAME :	USER NAME : p1ersonbr	DESIGNED -	REVISED -	<b>STATE OF ILLINOIS DEPARTMENT OF TRANSPORTATION</b>	<b>LOCATION MAP 2</b>	F.A. RTE.	SECTION	COUNTY	TOTAL SHEETS	SHEET NO.
ct:\pwork\p1ridot\p1ersonbr\d0252772\05	0881-shr-cover.dgn	DRAWN -	REVISED -			VAR.		**	29	4
	PLOT SCALE = 40.0000' / 1"	CHECKED -	REVISED -		SCALE:				CONTRACT NO. 70881	
	PLOT DATE = 2/4/2011	DATE -	REVISED -		SHEET NO. OF SHEETS				ILLINOIS FED. AID PROJECT	
									STA. 100+40.00 TO STA. 308+59.63	



# LOCATION MAP 3 - (NORTH LEG) - CHAMPAIGN COUNTY

## FAI-57 FROM 2 MILE SOUTH OF THOMASBORO TO US 136

CONCRETE PATCH OMISSIONS  
 STA. 1015+88.00 TO STA. 1017+69.00 (NB)  
 STA. 1127+91.00 TO STA. 1129+71.00 (NB)  
 STA. 1234+55.00 TO STA. 1236+35.00 (NB)  
 STA. 1015+88.00 TO STA. 1017+69.00 (SB)  
 STA. 1127+63.00 TO STA. 1129+43.00 (SB)  
 STA. 1234+55.00 TO STA. 1236+35.00 (SB)

END PROJECT  
 STA. 1270+77.24

SN 010-0164  
 STA. 1235+45.33

SN 010-0165  
 STA. 1128+67.19

SN 010-0156  
 STA. 1016+78.72

STATION EQUATION  
 STA. 966+67.89(BK)=  
 STA. 966+67.62(AH)

BEGIN PROJECT  
 SB STA. 918+62.00

BEGIN PROJECT  
 NB STA. 902+84.00

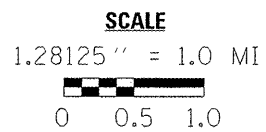
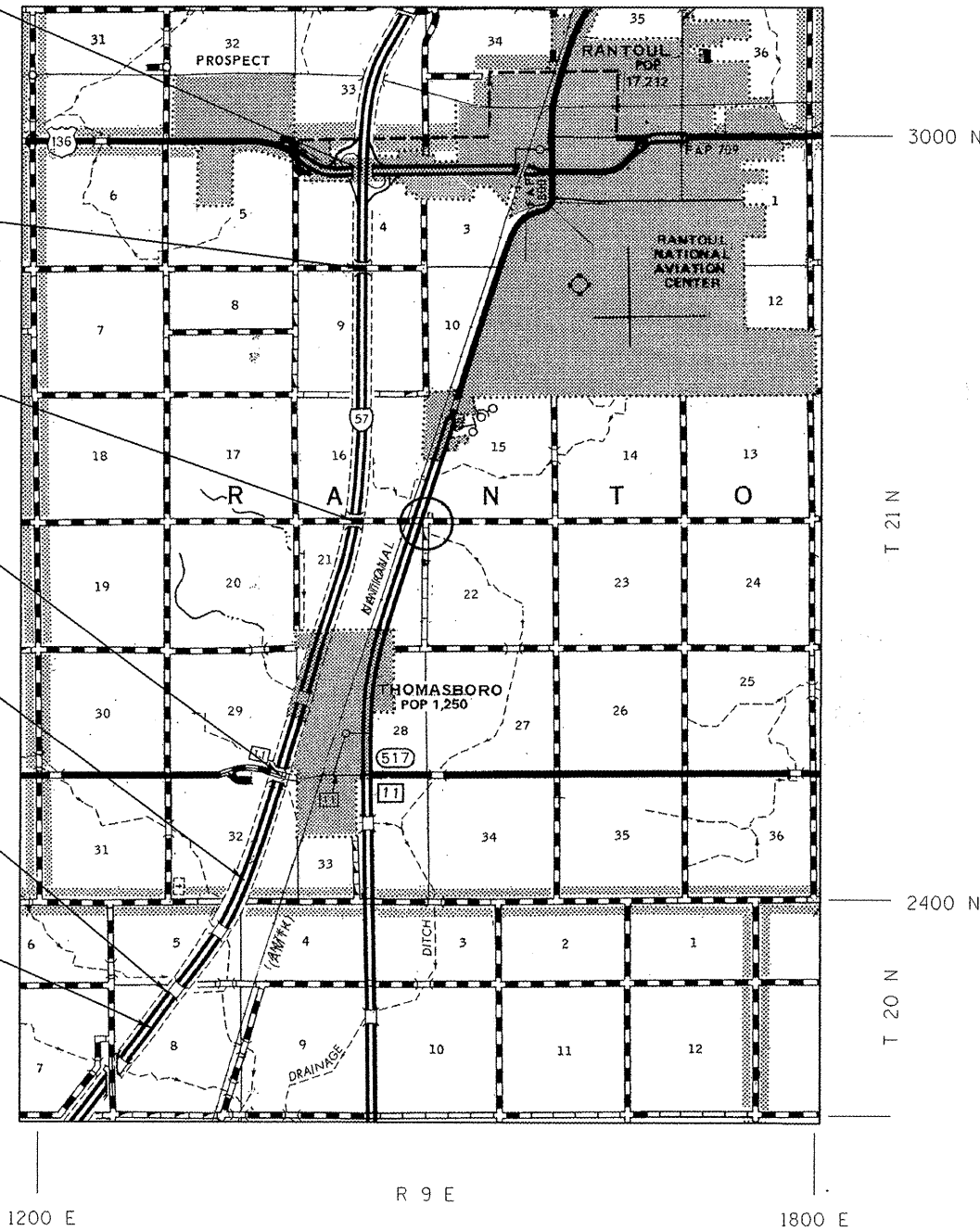

GROSS LENGTH OF LOCATION #3 (NORTH LEG) = 36793.51 FT. = 6.968 MILE  
 NET LENGTH OF LOCATION #3 (NORTH LEG) = 36252.51 FT. = 6.866 MILE

- \* D5 CRACK & JOINT SEAL 2011-2
- \*\* CHAMPAIGN, DOUGLAS, & VERMILION

FILE NAME =	USER NAME = ppersonbr	DESIGNED -	REVISED -
at:\pr-work\pvidot\personbr\d0252772\0570881-shr-cover.dgn		DRAWN -	REVISED -
		CHECKED -	REVISED -
		DATE -	REVISED -

**STATE OF ILLINOIS**  
**DEPARTMENT OF TRANSPORTATION**

<b>LOCATION MAP #3 - NORTH LEG</b>			
SCALE:	SHEET NO. 2 OF 2 SHEETS	STA. 902+84.00 TO STA. 1270+77.24	

F.A. RTE.	SECTION	COUNTY	TOTAL SHEETS	SHEET NO.
VAR.	*	**	29	6
CONTRACT NO. 70881			ILLINOIS FED. AID PROJECT	

# LOCATION MAP 4 – DANVILLE – VERMILION COUNTY

## FAP 332 ( US 136 ) FROM WINTER AVENUE TO MLK MEMORIAL ( MAIN ST )

END PROJECT  
STA. 183+00.00

STATION EQUATION  
STA. 50+00.00(BK) FAIRCHILD ST.=  
STA. 100+00.00(AH) VERMILION ST.

STATION EQUATION  
STA. 35+00.00(BK)=  
STA. 43+43.83(AH)

STATION EQUATION  
STA. 150+99.40(BK) GILBERT ST.=  
STA. 26+58.00(AH) FAIRCHILD ST.

RAILROAD OMISSION FROM SECTION  
STA. 133+00.00 TO STA. 134+20.00

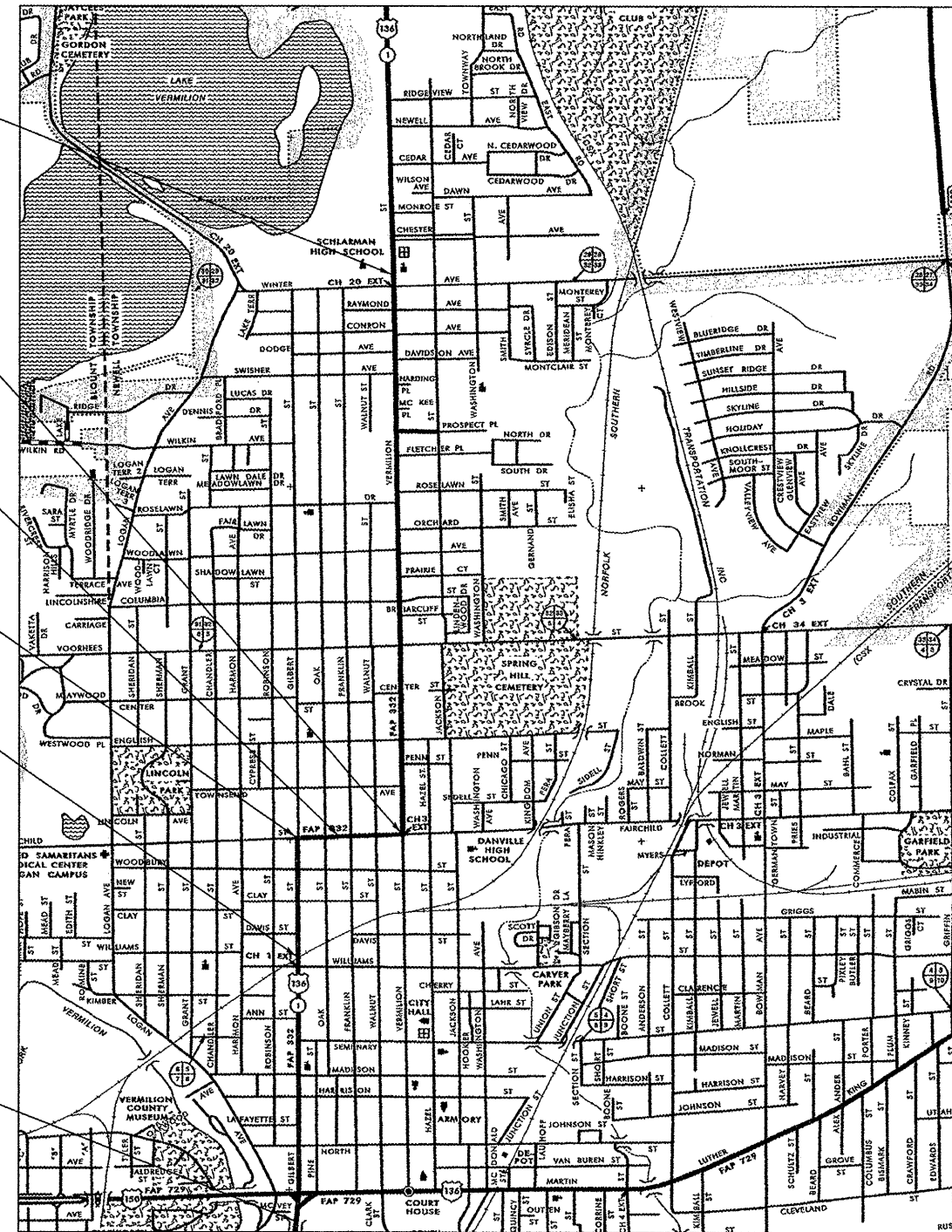

BEGIN PROJECT  
STA. 96+60.00

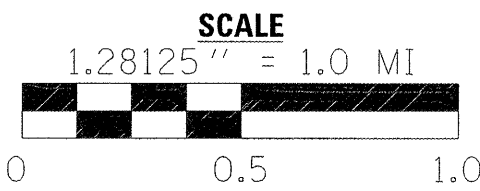

GROSS LENGTH OF LOCATION #4 = 15237.57 FT. = 2.886 MILE  
NET LENGTH OF LOCATION #4 = 15117.57 FT. = 2.863 MILE

- \* D5 CRACK & JOINT SEAL 2011-2
- \*\* CHAMPAIGN, DOUGLAS, & VERMILION

FILE NAME =	USER NAME = piersonbr	DESIGNED -	REVISED -
c:\pwork\p1dot\piersonbr\d0252772\050881-sht-cover.dgn		DRAWN -	REVISED -
		CHECKED -	REVISED -
		DATE -	REVISED -

**STATE OF ILLINOIS  
DEPARTMENT OF TRANSPORTATION**

<b>LOCATION MAP #4</b>			
SCALE:	SHEET NO. OF	SHEETS	STA. 96+60.00 TO STA. 183+00.00

F.A. RTE.	SECTION	COUNTY	TOTAL SHEETS	SHEET NO.
VAR.	*	**	29	7
CONTRACT NO. 70881				
ILLINOIS FED. AID PROJECT				

# LOCATION MAP 5 – DOUGLAS COUNTY

## FAP 808 ( IL 130 ) FROM VILLA GROVE NCL TO US 36

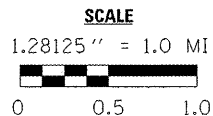
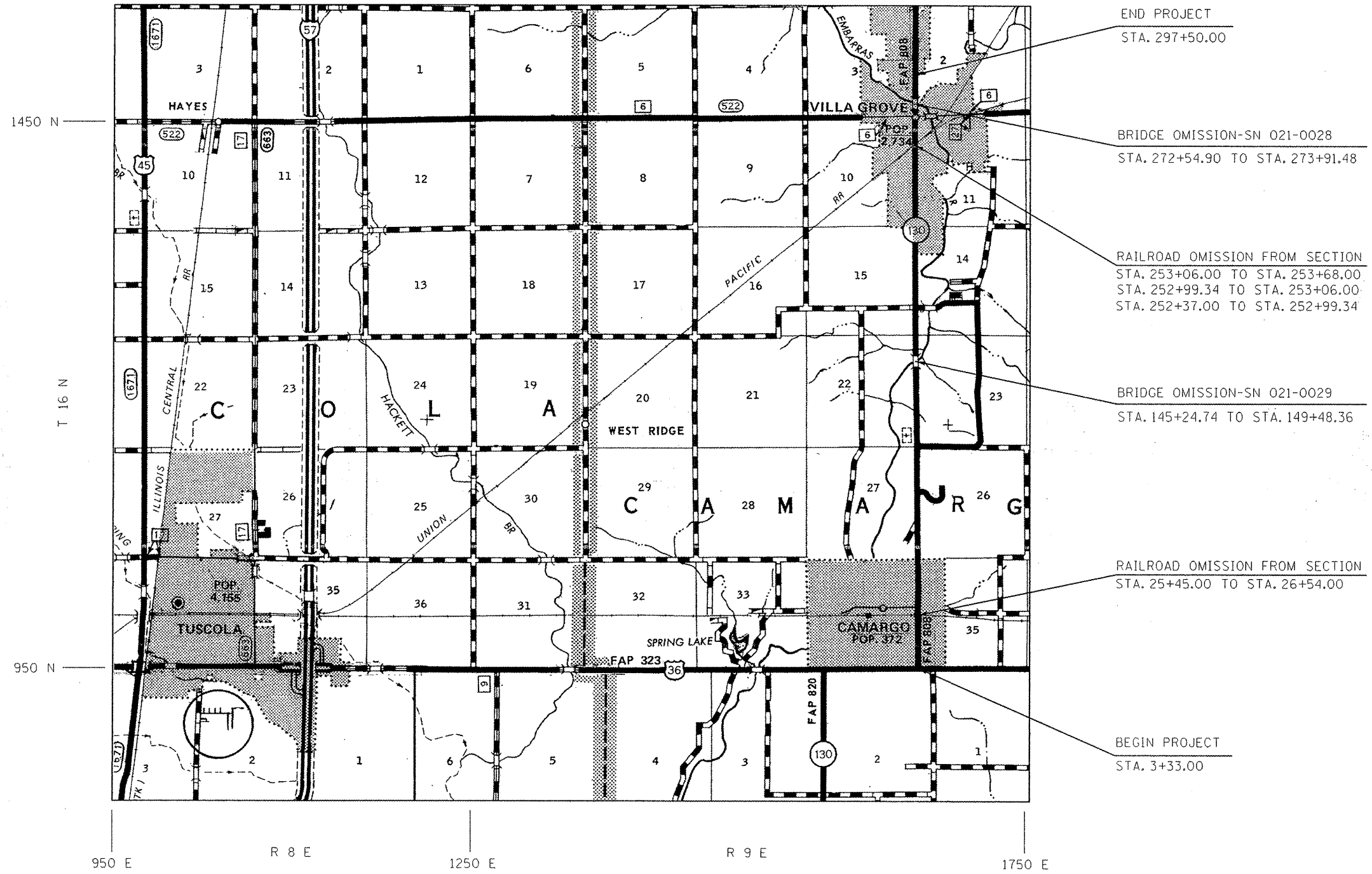

GROSS LENGTH OF LOCATION #5 = 29417.00 FT. = 5.571 MILE  
NET LENGTH OF LOCATION #5 = 28616.80 FT. = 5.420 MILE

- \* D5 CRACK & JOINT SEAL 2011-2
- \*\* CHAMPAIGN, DOUGLAS, & VERMILION

FILE NAME = c:\pwwork\p\p\dot\piersonbr\d0252772\0881-sht-cover.dgn	USER NAME = piersonbr	DESIGNED -	REVISED -	<b>STATE OF ILLINOIS DEPARTMENT OF TRANSPORTATION</b>	<b>LOCATION MAP 5</b>				F.A. RTE.	SECTION	COUNTY	TOTAL SHEETS	SHEET NO.
PLOT SCALE = 40,0000 "/ in.	CHECKED -	REVISED -	REVISED -		SCALE:	SHEET NO. OF	SHEETS	STA. 3+33.00	TO STA. 297+50.00	*	**	29	8
PLOT DATE = 2/4/2011	DATE -	REVISED -	REVISED -		CONTRACT NO. 70881								
ILLINOIS FED. AID PROJECT													



# LOCATION MAP 6 – DOUGLAS COUNTY

## FAP 880 ( IL 130 ) FROM COLES COUNTY LINE TO US 36

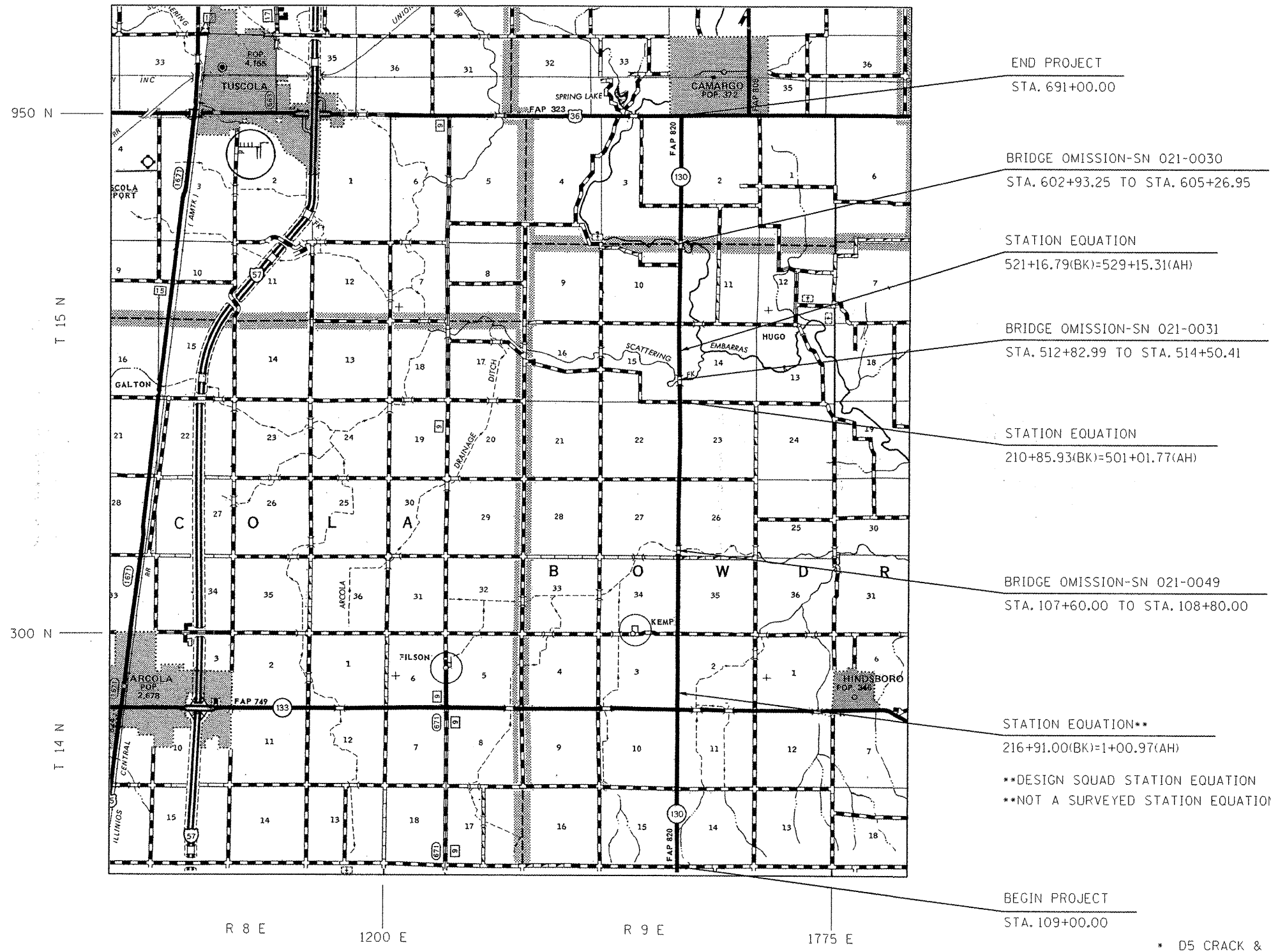

GROSS LENGTH OF LOCATION #6 = 50775.67 FT. = 9.617 MILE  
NET LENGTH OF LOCATION #6 = 50254.55 FT. = 9.518 MILE

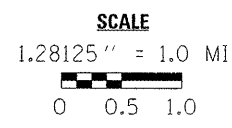

FILE NAME : c:\pv\work\pilot\personbr\d0252772\09	USER NAME : personbr 0981-shr-cover.dgn	DESIGNED - DRAWN -	REVISED - REVISED -	STATE OF ILLINOIS DEPARTMENT OF TRANSPORTATION	LOCATION MAP 6			F.A. RTE.	SECTION	COUNTY	TOTAL SHEETS	SHEET NO.	
	PLOT SCALE = 40.0000' / 1"	CHECKED -	REVISED -		SCALE:	SHEET NO.	OF	SHEETS	STA. 109+00.00	TO STA. 691+00.00	**	29	9
	PLOT DATE = 2/4/2011	DATE -	REVISED -		CONTRACT NO. 70881								
ILLINOIS FED. AID PROJECT													

- \* D5 CRACK & JOINT SEAL 2011-2
- \*\* CHAMPAIGN, DOUGLAS, & VERMILION

**GENERAL NOTES**

G.N. - 100

ENGLISH UNITS OF MEASUREMENT SHALL GOVERN OVER AND SUPERSEDE ANY METRIC UNITS SHOWN IN THIS CONTRACT. WHERE INCLUDED METRIC UNITS ARE FOR INFORMATION ONLY.

G.N. - 451(SPECIAL)

CRACK ROUTING AND FILLING CONSISTS OF BOTH LONGITUDINAL AND TRANSVERSE CRACKS, AN APPLICATION RATE OF 0.40 LBS. / FOOT WAS USED TO DETERMINE CRACK FILLING QUANTITIES.

LOCATION # 1

LONGITUDINAL CRACKS ALONG CENTERLINE AND BETWEEN PAVING LANES SHALL BE ROUTED AND SEALED.  
 LONGITUDINAL CRACKS WITHIN PAVING LANES GREATER THAN 1/4" IN WIDTH SHALL BE ROUTED AND SEALED.  
 LONGITUDINAL CRACKS ALONG EDGE OF PAVEMENT GREATER THAN 1/4" IN WIDTH SHALL BE ROUTED AND SEALED.  
 TRANSVERSE CRACKS GREATER THAN OR EQUAL TO 1/4" IN WIDTH SHALL BE ROUTED AND SEALED.  
 CRACKING IN PAVED SHOULDER, CURB & GUTTER, MAILBOX TURNOUTS AND ENTRANCES SHALL BE OMITTED.

LONGITUDINAL : 57,555 FOOT (ESTIMATED)  
 TRANSVERSE : 5,525 FOOT (ESTIMATED)

LOCATION # 2

LONGITUDINAL CRACKS ALONG CENTERLINE SHALL BE ROUTED AND SEALED.  
 LONGITUDINAL CRACKS WITHIN PAVING LANES GREATER THAN 1/4" IN WIDTH SHALL BE ROUTED AND SEALED.  
 TRANSVERSE CRACKS GREATER THAN OR EQUAL TO 1/4" IN WIDTH SHALL BE ROUTED AND SEALED.  
 CRACKING IN MAILBOX TURNOUTS AND ENTRANCES SHALL BE OMITTED.

LONGITUDINAL : 41,645 FOOT (ESTIMATED)  
 TRANSVERSE : 1,179 FOOT (ESTIMATED)

LOCATION # 3

LONGITUDINAL CRACKS ALONG MAINLINE CENTERLINE SHALL BE ROUTED AND SEALED.  
 LONGITUDINAL CRACKS ALONG EDGE OF PAVEMENT GREATER THAN 1/4" IN WIDTH SHALL BE ROUTED AND SEALED.  
 LONGITUDINAL CRACKS BETWEEN MAINLINE EDGE OF PAVEMENT AND RAMPS SHALL BE ROUTED AND SEALED.  
 LONGITUDINAL CRACKS WITHIN PAVING LANES GREATER THAN 1/4" IN WIDTH SHALL BE ROUTED AND SEALED.  
 TRANSVERSE CRACKS GREATER THAN OR EQUAL TO 1/4" IN WIDTH SHALL BE ROUTED AND SEALED.  
 CRACKING IN PAVED SHOULDERS, RAMPS, AND CURB & GUTTER SHALL BE OMITTED.

LONGITUDINAL : 273,746 FOOT (ESTIMATED)  
 TRANSVERSE : 2,227 FOOT (ESTIMATED)

LOCATION # 4

LONGITUDINAL CRACKS ALONG CENTERLINE AND BETWEEN PAVING LANES SHALL BE ROUTED AND SEALED.  
 LONGITUDINAL CRACKS WITHIN PAVING LANES GREATER THAN 1/4" IN WIDTH SHALL BE ROUTED AND SEALED.  
 TRANSVERSE CRACKS GREATER THAN OR EQUAL TO 1/4" IN WIDTH SHALL BE ROUTED AND SEALED.  
 CRACKING IN PAVED SHOULDER, CURB & GUTTER, MAILBOX TURNOUTS AND ENTRANCES SHALL BE OMITTED.

LONGITUDINAL : 60,095 FOOT (ESTIMATED)  
 TRANSVERSE : 19,877 FOOT (ESTIMATED)

LOCATION # 5

LONGITUDINAL CRACKS ALONG CENTERLINE SHALL BE ROUTED AND SEALED.  
 LONGITUDINAL CRACKS ALONG EDGE OF PAVEMENT IN HEYWORTH GREATER THAN 1/4" IN WIDTH SHALL BE ROUTED AND SEALED.  
 LONGITUDINAL CRACKS WITHIN PAVING LANES GREATER THAN 1/4" IN WIDTH SHALL BE ROUTED AND SEALED.  
 TRANSVERSE CRACKS GREATER THAN OR EQUAL TO 1/4" IN WIDTH SHALL BE ROUTED AND SEALED.  
 CRACKING IN PAVED SHOULDER, CURB & GUTTER, MAILBOX TURNOUTS AND ENTRANCES SHALL BE OMITTED.

LONGITUDINAL : 35,770 FOOT (ESTIMATED)  
 TRANSVERSE : 17,170 FOOT (ESTIMATED)

LOCATION # 6

LONGITUDINAL CRACKS ALONG CENTERLINE SHALL BE ROUTED AND SEALED.  
 LONGITUDINAL CRACKS WITHIN PAVING LANES GREATER THAN 1/4" IN WIDTH SHALL BE ROUTED AND SEALED.  
 TRANSVERSE CRACKS GREATER THAN OR EQUAL TO 1/4" IN WIDTH SHALL BE ROUTED AND SEALED.  
 CRACKING IN PAVED SHOULDER, CURB & GUTTER, MAILBOX TURNOUTS AND ENTRANCES SHALL BE OMITTED.

LONGITUDINAL : 62,819 FOOT (ESTIMATED)  
 TRANSVERSE : 24,122 FOOT (ESTIMATED)

NOTE: ANY CHANGES TO THE INTENT OF THE ROUTING AND SEALING AT THE ABOVE LISTED LOCATIONS SHALL BE APPROVED IN ADVANCE BY THE ENGINEER

\* D5 CRACK & JOINT SEAL 2011-2  
 \*\* CHAMPAIGN, DOUGLAS, & VERMILION

FILE NAME =	USER NAME = piersnrb	DESIGNED - JAH	REVISED -	<b>STATE OF ILLINOIS DEPARTMENT OF TRANSPORTATION</b>	<b>GENERAL NOTES</b>				F.A.P. RTE.	SECTION	COUNTY	TOTAL SHEETS	SHEET NO.
c:\pwork\pwork\pwork\piersnrb\09252772\0570881-shr-cover.dgn	DRAWN -	REVISD -	VAR.						*	**	29	10	
PLOT SCALE = 40.0000 1/ in.	CHECKED -	REVISED -	CONTRACT NO. 70881										
PLOT DATE = 2/4/2011	DATE - 1-13-10	REVISED -	SCALE:		SHEET NO. OF	SHEETS	STA. TO STA.	ILLINOIS FED. AID PROJECT					

### SUMMARY OF QUANTITIES

LOCATION OF WORK:

LOCATION #1  
LOCATION #4

LOCATION #2  
LOCATION #3

LOCATION #3

LOCATION #5  
LOCATION #6

URBAN  
100% STATE  
ROUT & SEAL  
VERMILION CO.  
0005

RURAL  
100% STATE  
ROUT & SEAL  
CHAMPAIGN CO.  
0005

URBAN  
100% STATE  
ROUT & SEAL  
CHAMPAIGN CO.  
0005

RURAL  
100% STATE  
ROUT & SEAL  
DOUGLAS CO.  
0005

CONSTRUCTION TYPE CODE:

CODE NO	ITEM	UNIT	TOTAL QUANTITY				
45100100	CRACK ROUTING (PAVEMENT)	FOOT	601,732.0	143,052.0	249,934.0	68,865.0	139,881.0
45100200	CRACK FILLING	POUND	240,693.0	57,221.0	99,974.0	27,546.0	55,952.0
67100100	MOBILIZATION	L SUM	1.0	0.20	0.40	0.10	0.30
70100420	TRAFFIC CONTROL AND PROTECTION, STANDARD 701411	EACH	18.0			18.0	
70100460	TRAFFIC CONTROL AND PROTECTION, STANDARD 701306	L SUM	1.0		0.25		0.75
70100700	TRAFFIC CONTROL AND PROTECTION, STANDARD 701406	L SUM	1.0		0.75	0.25	
70102620	TRAFFIC CONTROL AND PROTECTION, STANDARD 701501	L SUM	1.0				1.00
70102625	TRAFFIC CONTROL AND PROTECTION, STANDARD 701606	L SUM	1.0	1.00			
70102632	TRAFFIC CONTROL AND PROTECTION, STANDARD 701602	L SUM	1.0	1.00			
70102635	TRAFFIC CONTROL AND PROTECTION, STANDARD 701701	L SUM	1.0	1.00			
X7015005	CHANGEABLE MESSAGE SIGN	<b>CAL DA</b>	12.0		6.0	6.0	
* 78001110	PAINT PAVEMENT MARKING - LINE 4"	FOOT	64,802.0	8,024.0	29,200.0	3,520.0	24,058.0
* SPECIALTY ITEM							

\* D5 CRACK & JOINT SEAL 2011-2  
\*\* CHAMPAIGN, DOUGLAS, & VERMILION

FILE NAME =	USER NAME = piersonbr	DESIGNED -	REVISED -	<b>STATE OF ILLINOIS DEPARTMENT OF TRANSPORTATION</b>	<b>SUMMARY OF QUANTITIES</b>			F.A.P. RTE.	SECTION	COUNTY	TOTAL SHEETS	SHEET NO.	
ct:\pav-work\pripdot\piersonbr\d0252772\05	0881-shr-cover.dgn	DRAWN -	REVISED -		SCALE:	SHEET NO. 1 OF 1 SHEETS	STA.	TO STA.	VAR.	*	**	29	11
	PLOT SCALE = 40.0000' / 1"	CHECKED -	REVISED -		CONTRACT NO. 70881								
	PLOT DATE = 2/4/2011	DATE -	REVISED -		ILLINOIS FED. AID PROJECT								

## SCHEDULE OF QUANTITIES

LOCATION OF WORK:	LOCATION #1	LOCATION #2	LOCATION #3 SOUTH LEG	LOCATION #3 NORTH LEG	LOCATION #3 NORTH LEG
	FAP 332 ( IL1)	FAS 518 ( CH22)	FAI-57	FAI-57	FAI-57
	STA. 2627+89.00 TO STA. 2743+00.00	STA. 252+58.84 TO STA. 308+59.63	STA. 544+40.00 TO STA. 637+33.00	STA. 902+84.00 TO STA. 1258+58.40	STA. 1258+58.40 TO STA. 1270+77.24
	URBAN VERMILION CO.	RURAL CHAMPAIGN CO.	URBAN CHAMPAIGN CO.	RURAL CHAMPAIGN CO.	URBAN CHAMPAIGN CO.

<u>CODE NO</u>	<u>ITEM</u>	<u>UNIT</u>	<u>QUANTITY</u>	<u>QUANTITY</u>	<u>QUANTITY</u>	<u>QUANTITY</u>	<u>QUANTITY</u>
45100100	CRACK ROUTING (PAVEMENT)	FOOT	63,080.0	42,824.0	56,555.0	207,110.0	12,310.0
45100200	CRACK FILLING	POUND	25,232.0	17,130.0	22,622.0	82,844.0	4,924.0
67100100	MOBILIZATION	L SUM	0.10	0.10	0.10	0.30	
70100420	TRAFFIC CONTROL AND PROTECTION, STANDARD 701411	EACH			12.00		6.00
70100460	TRAFFIC CONTROL AND PROTECTION, STANDARD 701306	L SUM		0.25			
70100700	TRAFFIC CONTROL AND PROTECTION, STANDARD 701406	L SUM			0.25	0.75	
70102620	TRAFFIC CONTROL AND PROTECTION, STANDARD 701501	L SUM					
70102625	TRAFFIC CONTROL AND PROTECTION, STANDARD 701606	L SUM	1.00				
70102632	TRAFFIC CONTROL AND PROTECTION, STANDARD 701602	L SUM					
70102635	TRAFFIC CONTROL AND PROTECTION, STANDARD 701701	L SUM					
X7015005	CHANGEABLE MESSAGE SIGN	DAY			6.00	6.00	
78001110	PAINT PAVEMENT MARKING - LINE 4"	FOOT	3,453.0	8,329.0	2,788.0	20,871.0	732.0

\* D5 CRACK & JOINT SEAL 2011-2  
\*\* CHAMPAIGN, DOUGLAS, & VERMILION

FILE NAME =	USER NAME = ppersonbr	DESIGNED -	REVISED -	<b>STATE OF ILLINOIS DEPARTMENT OF TRANSPORTATION</b>	<b>SCHEDULE OF QUANTITIES</b>			F.A.P. RTE.	SECTION	COUNTY	TOTAL SHEETS	SHEET NO.
et:\pwork\pwork\personbr\d0252772\0570881-shit-cover.dgn		DRAWN -	REVISED -					*	**	29	12	
	PLOT SCALE = 40.0000' / in.	CHECKED -	REVISED -		SCALE:	SHEET NO. 1 OF 2 SHEETS	STA.	TO STA.		CONTRACT NO. 70881		
	PLOT DATE = 2/4/2011	DATE -	REVISED -							ILLINOIS FED. AID PROJECT		



# EXISTING TYPICAL CROSS SECTION ①

NOTE:  
CONTRACT WORK SHALL BE COMPLETED  
IN SUCH A MANNER AS TO PRESERVE  
THE EFFECTIVENESS OF THE CENTERLINE  
MILLED RUMBLE STRIPS.

STATION TO STATION  
2627+89.00 2743+00.00

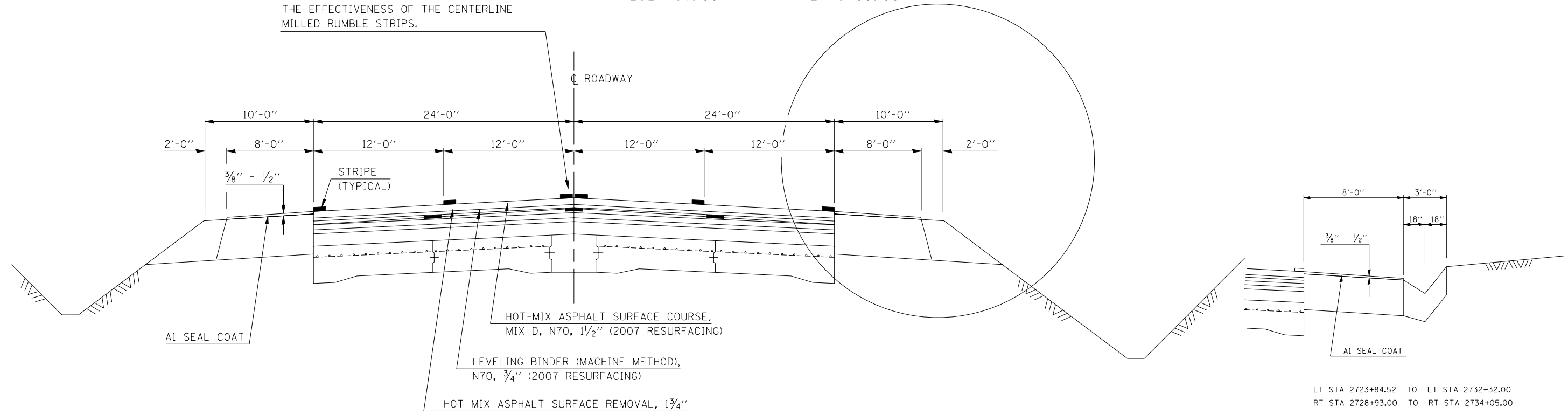

LOCATION #1  
SHEET 1 OF 1

- D5 CRACK & JOINT SEAL 2011-2
- CHAMPAIGN, DOUGLAS, EDGAR & VERMILION

FILE NAME =	USER NAME = blockrt	DESIGNED -	REVISED -
ct:\pw\work\p\dot\blockrt\d0252772\0570881-typical.dgn		DRAWN -	REVISED -
		CHECKED -	REVISED -
		DATE -	REVISED -

STATE OF ILLINOIS  
DEPARTMENT OF TRANSPORTATION

TYPICAL CROSS SECTIONS - LOCATION #1

SCALE: SHEET NO. OF SHEETS STA. TO STA.

F.A. RTE.	SECTION	COUNTY	TOTAL SHEETS	SHEET NO.
	•	••	29	14
CONTRACT NO. 70881			ILLINOIS FED. AID PROJECT	



## EXISTING TYPICAL CROSS SECTION (SOUTH LEG) ①

STATION	TO	STATION
544+40.00		581+60.00 ②
② 583+40.00		596+88.00 ③
③ 598+68.00		637+33.00

**CONCRETE PATCH OMISSIONS:**  
 STATION 565+68.00 TO STATION 567+48.00  
 STATION 581+60.00 TO STATION 583+40.00  
 STATION 596+88.00 TO STATION 598+68.00  
 STATION 625+76.00 TO STATION 627+56.00

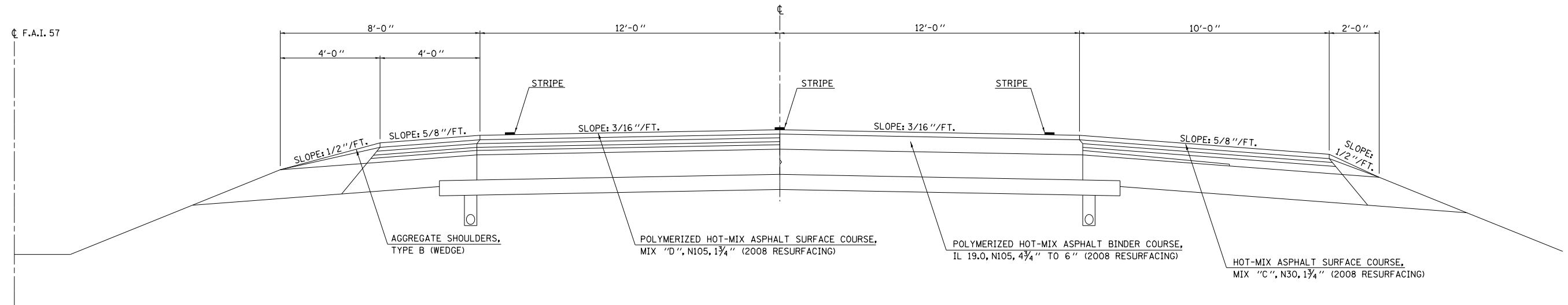

## EXISTING TYPICAL CROSS SECTION (SOUTH LEG) ②

SN 010-0050

STATION	TO	STATION
① 581+60.00		583+40.00 ①

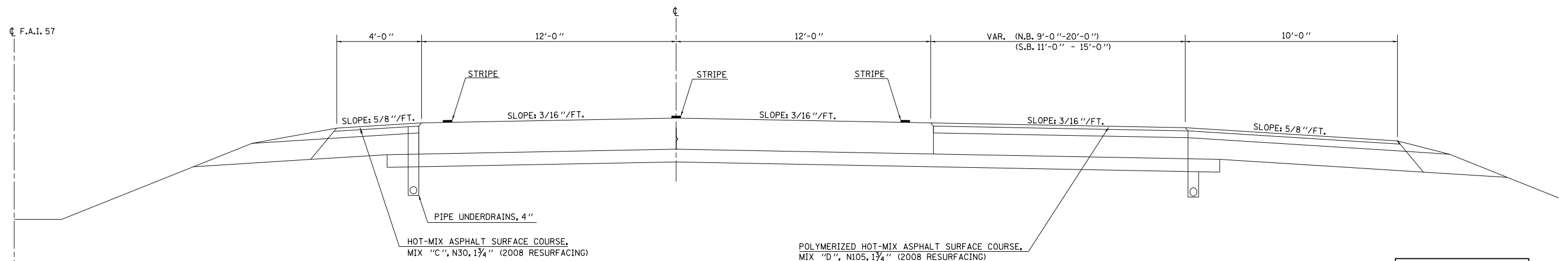

LOCATION #3  
(SOUTH LEG)  
SHEET 1 OF 2

- D5 CRACK & JOINT SEAL 2011-2
- CHAMPAIGN, DOUGLAS, EDGAR & VERMILION

FILE NAME =	USER NAME = ppersonbr	DESIGNED -	REVISED -
et:\pwork\pwork\personbr\d0252772\0570881-typical.dgn		DRAWN -	REVISED -
		CHECKED -	REVISED -
		DATE -	REVISED -

**STATE OF ILLINOIS  
DEPARTMENT OF TRANSPORTATION**

**TYPICAL CROSS SECTIONS - LOCATION #3**

SCALE:      SHEET NO. OF SHEETS      STA. TO STA.

F.A. RTE.	SECTION	COUNTY	TOTAL SHEETS	SHEET NO.
VAR.	•	••	29	16
CONTRACT NO. 70881				
ILLINOIS FED. AID PROJECT				





**CONCRETE PATCH OMISSIONS:**

(NB) STATION 1015+88.00 TO STATION 1017+69.00  
 (NB) STATION 1127+91.00 TO STATION 1129+71.00  
 (NB) STATION 1234+55.00 TO STATION 1236+35.00

(SB) STATION 1015+88.00 TO STATION 1017+69.00  
 (SB) STATION 1127+63.00 TO STATION 1129+43.00  
 (SB) STATION 1234+55.00 TO STATION 1236+35.00

**EXISTING TYPICAL CROSS SECTION (NORTH LEG) ①**

STATION	TO	STATION	
NB 902+84.00		NB 966+67.89 (BK)	STA EQN 966+67.89 (BK) = 966+67.22 (AH)
NB 966+67.22 (AH)		NB 1270+77.24	
SB 918+62.00		SB 966+67.89 (BK)	STA EQN 966+67.89 (BK) = 966+67.62 (AH)
SB 966+67.62 (AH)		SB 1270+77.24	

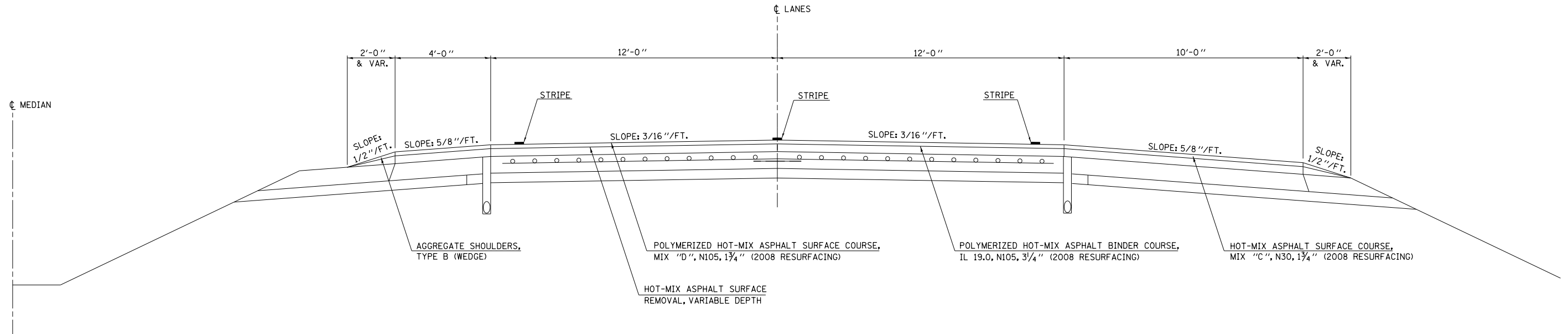

LOCATION #3  
 (NORTH LEG)  
 SHEET 1 OF 1

- D5 CRACK & JOINT SEAL 2011-2
- CHAMPAIGN, DOUGLAS, EDGAR & VERMILION

FILE NAME =	USER NAME = ppersonbr	DESIGNED -	REVISED -	<b>STATE OF ILLINOIS DEPARTMENT OF TRANSPORTATION</b>	<b>TYPICAL CROSS SECTIONS</b>			F.A. RTE.	SECTION	COUNTY	TOTAL SHEETS	SHEET NO.
et:\pw\work\p\pidot\ppersonbr\d0252772\0570881-typical.dgn		DRAWN -	REVISED -					VAR.	.	••	29	18
	PLOT SCALE = 40.0000' / in.	CHECKED -	REVISED -		SCALE:			CONTRACT NO. 70881				
	PLOT DATE = 2/4/2011	DATE -	REVISED -		SHEET NO. OF SHEETS			ILLINOIS FED. AID PROJECT				

# EXISTING TYPICAL CROSS SECTION ①

GILBERT ST.

STATION TO STATION  
96+60.00 100+35.00 ②

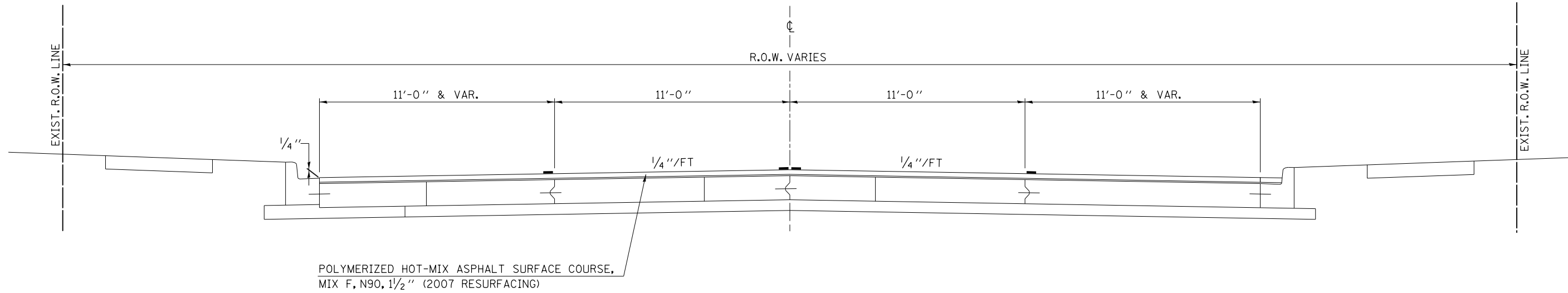

# EXISTING TYPICAL CROSS SECTION ②

GILBERT ST.

+ RAILROAD OMISSION 133+00.00 TO 134+20.00

STATION TO STATION  
① 100+35.00 133+00.00 +  
+ 134+20.00 150+99.40 (BK) ③ STA EQN 150+99.40 (GILBERT ST)BK = 26+58.00 (FAIRCHILD ST)AH

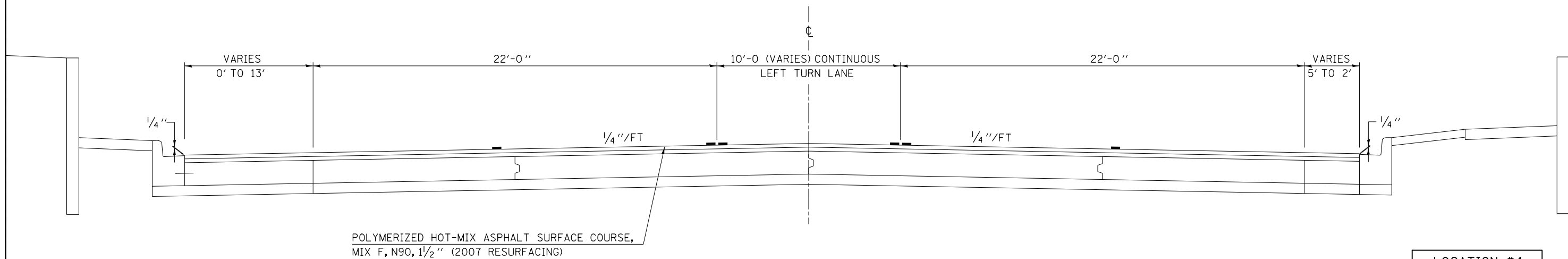

LOCATION #4  
SHEET 1 OF 3

\* 16'-0" RIGHT TURN LANE FROM 100+35.00 TO 103+20.00

• D5 CRACK & JOINT SEAL 2011-2  
•• CHAMPAIGN, DOUGLAS, EDGAR & VERMILION

FILE NAME = c:\pwork\pwork\personbr\d0252772\0570881-typical.dgn	USER NAME = personbr	DESIGNED -	REVISED -	<b>STATE OF ILLINOIS DEPARTMENT OF TRANSPORTATION</b>	<b>TYPICAL CROSS SECTIONS</b>			F.A. RTE.	SECTION	COUNTY	TOTAL SHEETS	SHEET NO.
	PLOT SCALE = 48.0000' / in.	DRAWN -	REVISED -		SCALE:	SHEET NO. OF SHEETS	STA. TO STA.	VAR.	.	••	29	19
	PLOT DATE = 2/4/2011	CHECKED -	REVISED -		CONTRACT NO. 70881							
		DATE -	REVISED -		ILLINOIS FED. AID PROJECT							

### EXISTING TYPICAL CROSS SECTION ③

FAIRCHILD ST.

②	STATION	TO	STATION	
	26+58.00 (AH)		35+00.00 (BK)	STA EQN 35+00.00 (BK) = 43+43.83 (AH)
	43+43.83 (AH)		50+00.00 (BK) ④	STA EQN 50+00.00 (FAIRCHILD ST) BK = 100+00.00 (VERMILION ST) AH

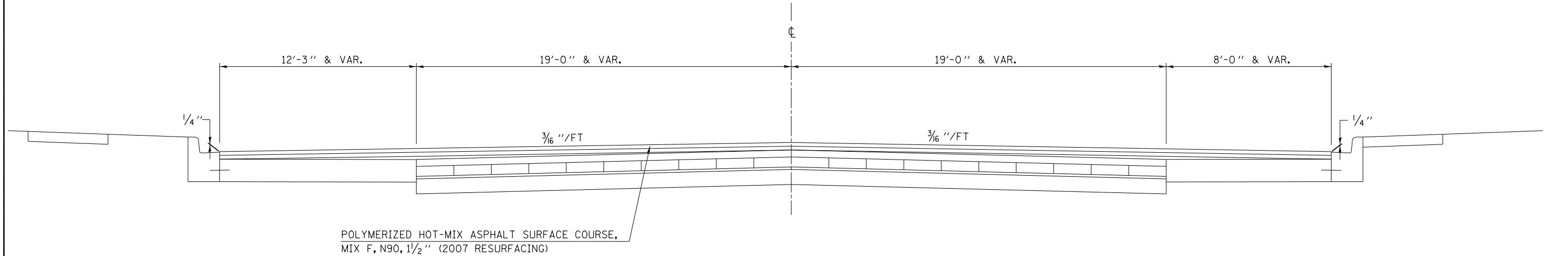

### EXISTING TYPICAL CROSS SECTION ④

VERMILION ST.

③	STATION	TO	STATION	⑤
	100+00.00 (AH)		129+16.10	

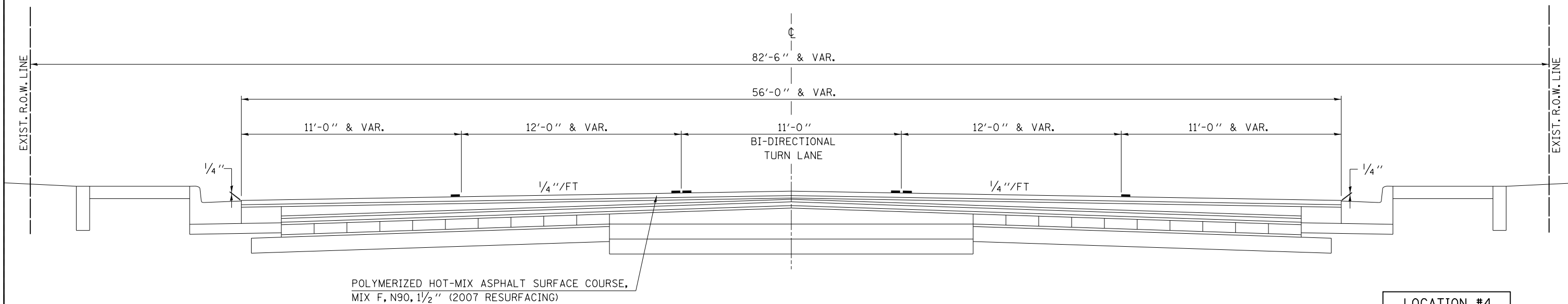

LOCATION #4  
SHEET 2 OF 3

- D5 CRACK & JOINT SEAL 2011-2
- CHAMPAIGN, DOUGLAS, EDGAR & VERMILION

FILE NAME =	USER NAME = ppersonbr	DESIGNED -	REVISED -
ci:\pwork\work\pwork\personbr\d0252772\0570881-typical.dgn		DRAWN -	REVISED -
		CHECKED -	REVISED -
		DATE -	REVISED -

STATE OF ILLINOIS  
DEPARTMENT OF TRANSPORTATION

TYPICAL CROSS SECTIONS

SCALE: SHEET NO. OF SHEETS STA. TO STA.

F.A. RTE.	SECTION	COUNTY	TOTAL SHEETS	SHEET NO.
VAR.	.	••	29	20
CONTRACT NO. 70881				
ILLINOIS FED. AID PROJECT				

### EXISTING TYPICAL CROSS SECTION ⑤

VERMILION ST.

STATION TO STATION  
 ④ 129+16.10 175+25.00 ⑥

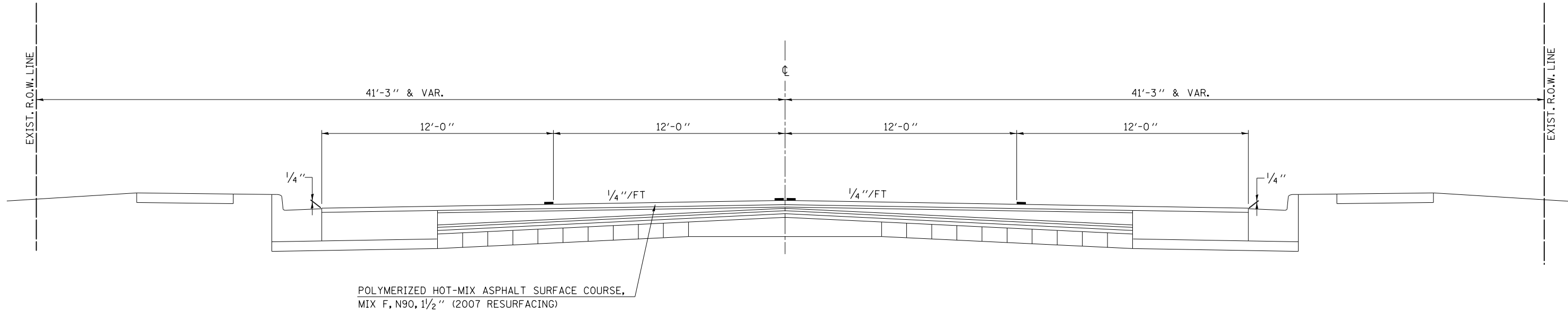

### EXISTING TYPICAL CROSS SECTION ⑥

VERMILION ST.

STATION TO STATION  
 ⑤ 175+25.00 183+00.00

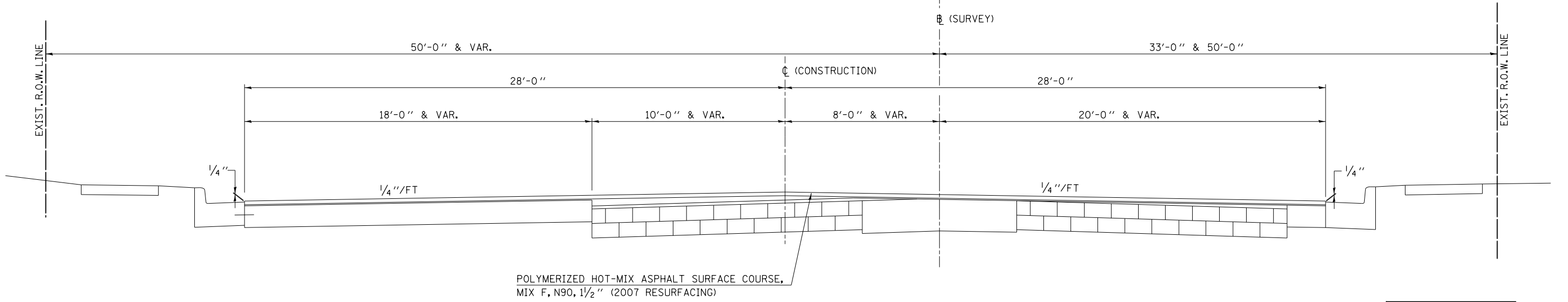

LOCATION #4  
 SHEET 3 OF 3

- D5 CRACK & JOINT SEAL 2011-2
- CHAMPAIGN, DOUGLAS, EDGAR & VERMILION

FILE NAME = c:\pwwork\pwwork\personbr\d0252772\0570881-typical.dgn	USER NAME = personbr	DESIGNED -	REVISED -	<b>STATE OF ILLINOIS DEPARTMENT OF TRANSPORTATION</b>	<b>TYPICAL CROSS SECTIONS</b>			F.A. RTE.	SECTION	COUNTY	TOTAL SHEETS	SHEET NO.
PLOT SCALE = 40.0000' / in.	CHECKED -	REVISED -	REVISED -					VAR.	.	••	29	21
PLOT DATE = 2/4/2011	DATE -	REVISED -	REVISED -		SCALE: SHEET NO. OF SHEETS STA. TO STA.			CONTRACT NO. 70881				
ILLINOIS FED. AID PROJECT												

## EXISTING TYPICAL CROSS SECTION ①

+ RAILROAD OMISSION 25+45.00 TO 26+54.00  
 \* BRIDGE OMISSION 145+24.74 TO 149+48.36

STATION	TO	STATION
3+33.00		25+45.00 +
+ 26+54.00		145+27.74 *
* 149+48.36		224+50.00 ②
② 278+06.00		297+50.00

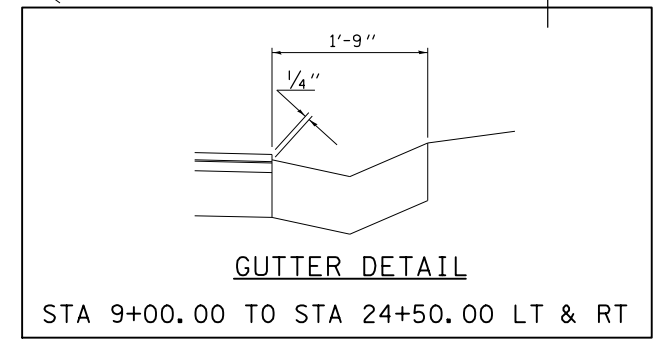
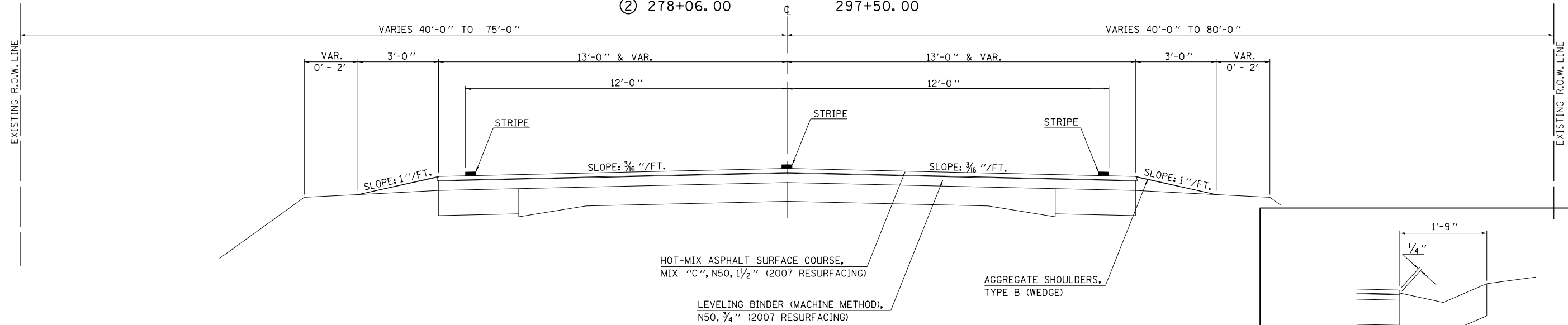

## EXISTING TYPICAL CROSS SECTION ②

+ RAILROAD OMISSION 252+37.00 TO 252+99.34  
 ++ RAILROAD OMISSION 253+06.00 TO 253+68.00  
 \* BRIDGE OMISSION 272+54.90 TO 273+91.48

STATION	TO	STATION
① 224+50.00		252+37.00 +
+ 252+99.34		253+06.00 ++
++ 253+68.00		272+54.90 *
* 273+91.48		278+06.00 ①

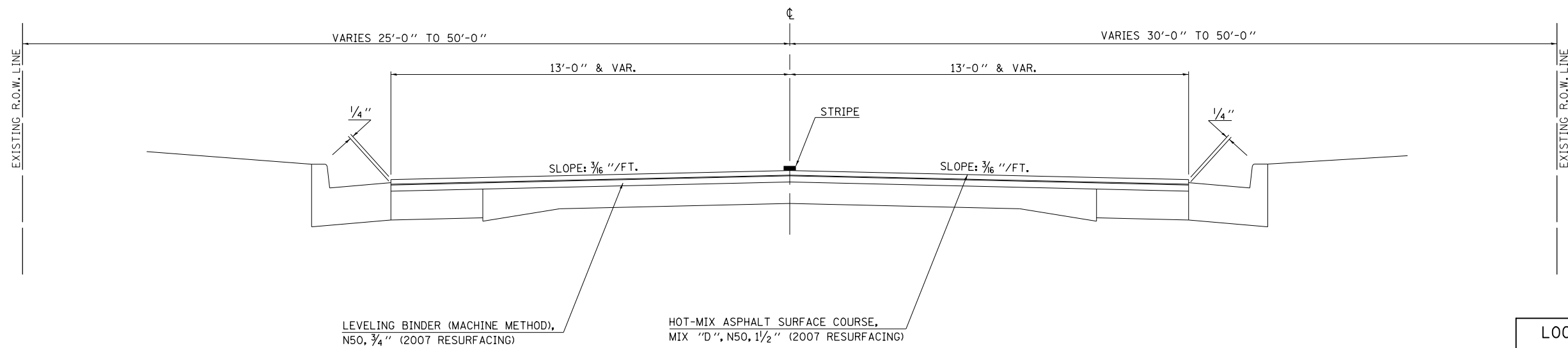

**LOCATION #5**  
 SHEET 1 OF 1

• D5 CRACK & JOINT SEAL 2011-2  
 \*\* CHAMPAIGN, DOUGLAS, EDGAR & VERMILION

FILE NAME =	USER NAME = ppersonbr	DESIGNED -	REVISED -	<b>STATE OF ILLINOIS DEPARTMENT OF TRANSPORTATION</b>	<b>TYPICAL CROSS SECTIONS</b>			F.A. RTE.	SECTION	COUNTY	TOTAL SHEETS	SHEET NO.	
et:\pw\work\p\idot\ppersonbr\d0252772\0570881-typical.dgn		DRAWN -	REVISED -		SCALE:	SHEET NO. OF	SHEETS	STA.	TO STA.	•	••	29	22
	PLOT SCALE = 40.0000' / in.	CHECKED -	REVISED -		CONTRACT NO. 70881								
	PLOT DATE = 2/4/2011	DATE -	REVISED -		ILLINOIS FED. AID PROJECT								



### HMA PAVEMENT

(USE PAY ITEMS : 45100100 CRACK ROUTING (PAVEMENT)  
AND 45100200 CRACK FILLING)

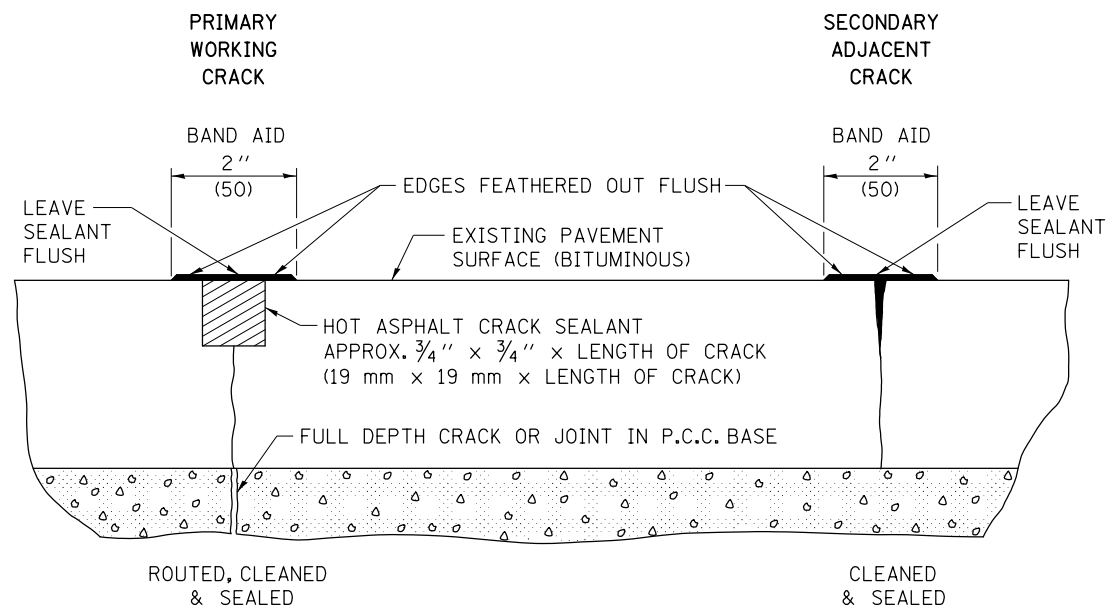

### PCC PAVEMENT

(USE PAY ITEMS : 45200100 JOINT OR CRACK ROUTING (P.C.C. PAVEMENT & SHOULDER)  
AND 45200300 JOINT OR CRACK FILLING)

#### TRANSVERSE CRACKS AND JOINTS AND CENTERLINE JOINT

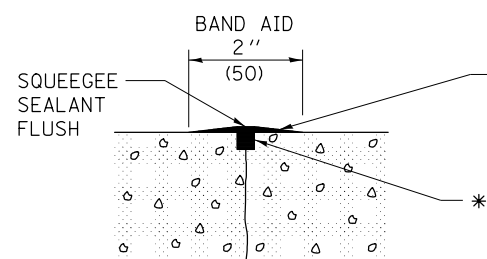

#### LONGITUDINAL SHOULDER JOINT

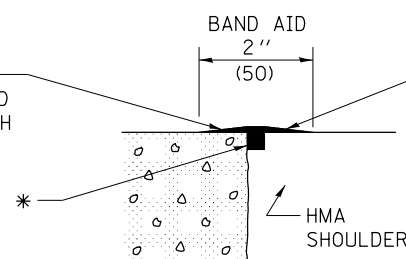

#### ANY WIDE LONGITUDINAL JOINT OR CRACK

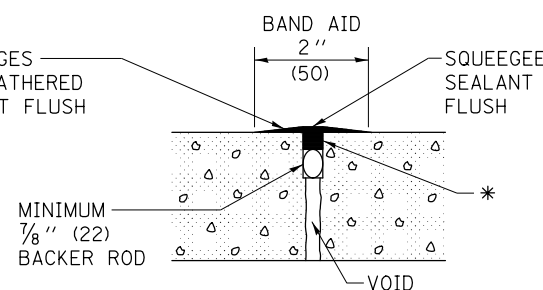

\* HOT ASPHALT CRACK SEALANT APPROX. 3/4" x 3/4" x LENGTH OF CRACK. ACTUAL QUANTITY WILL VARY AS NEEDED FOR PRIMARY OR SECONDARY WORKING CRACK.

#### LONGITUDINAL RANDOM CRACK

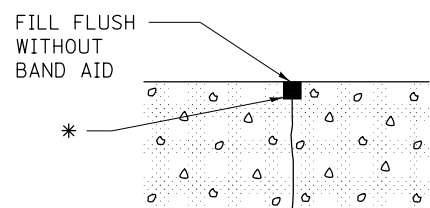

#### TRANSVERSE EXPANSION JOINT

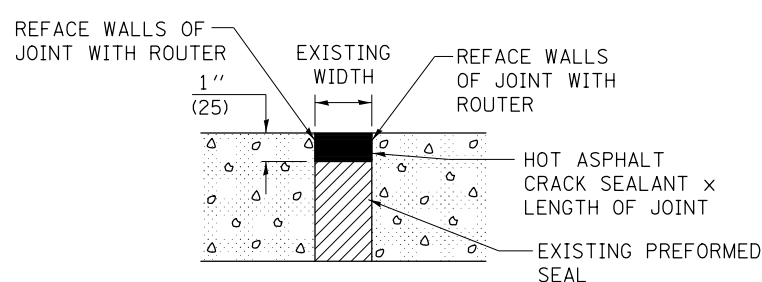

- \* D5 CRACK & JOINT SEAL 2011-2
- \*\* CHAMPAIGN, DOUGLAS, & VERMILION

Note: All dimensions are in INCHES (millimeters) unless otherwise shown.

### DISTRICT 5 DETAIL NO. 45AAAAAA

FILE NAME =	USER NAME = ppersonbr	DESIGNED -	REVISED - 12/06
et:\pw\work\p\pidot\ppersonbr\d0252772\0570881-shit-cover.dgn		DRAWN -	REVISED - 08/07
	PLOT SCALE = 40.0000' / in.	CHECKED -	REVISED - 12/08
	PLOT DATE = 2/4/2011	DATE -	REVISED -

STATE OF ILLINOIS  
DEPARTMENT OF TRANSPORTATION

CRACK AND JOINT SEALING

SCALE: SHEET NO. OF SHEETS STA. TO STA.

F.A. RTE.	SECTION	COUNTY	TOTAL SHEETS	SHEET NO.
VAR.	*	**	29	24
CONTRACT NO. 70881				
FED. ROAD DIST. NO. ILLINOIS FED. AID PROJECT				





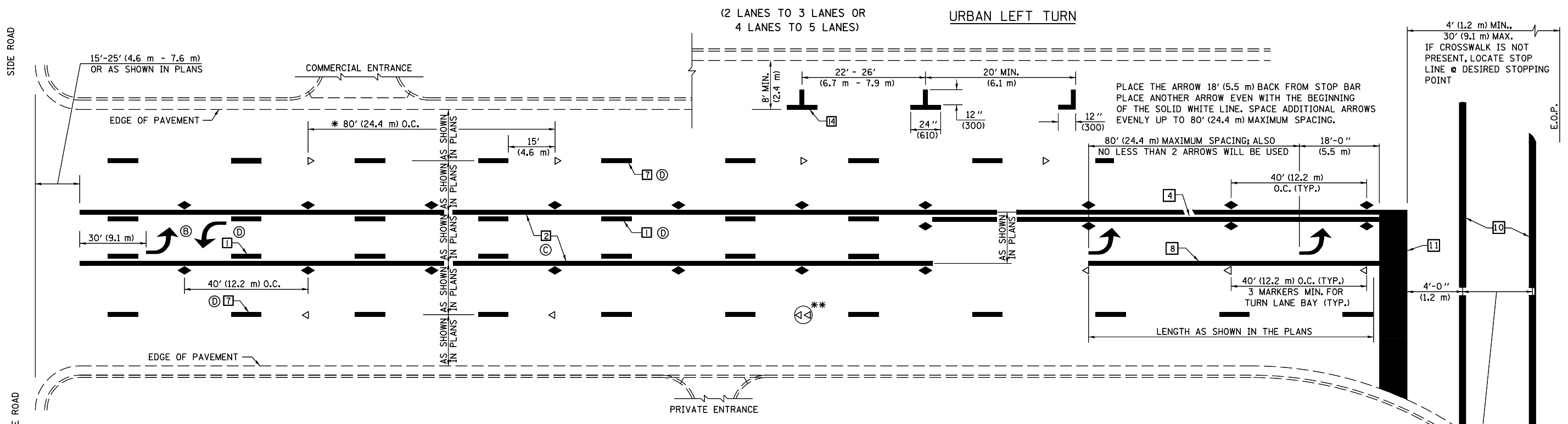

\* REDUCE TO 40 FEET (12.2 METERS) ON CENTER ON CURVES WHERE ADVISORY SPEEDS ARE 10 MPH (15 km/h) LOWER THAN POSTED SPEEDS.

\*\* DOUBLE LANE LINE MARKERS SHALL BE SPECIFIED AND SPACED AS SHOWN IN HIGHWAY STANDARD 781001 FOR MULTI-LANE DIVIDED AND UNDIVIDED HIGHWAYS.

- GENERAL NOTES:**
- ⓑ TURN ARROW PAIRS SHALL BE PLACED AT 250' (75 m) INTERVALS AND SHALL BE EVENLY SPACED BETWEEN BOTH ENDS OF THE BIDIRECTIONAL LEFT TURN LANE.
  - ⓒ THE SOLID YELLOW PAVEMENT MARKINGS [2] SHOULD GENERALLY START OR END NEAR THE RADIUS POINT OF EACH STREET RETURN EXCEPT WHERE ONE OR BOTH ENDS WOULD INCLUDE STOP BARS.
  - ⓓ THE SKIP-DASH PAVEMENT MARKINGS [1] OR [7] SHOULD BE CENTERED BETWEEN BOTH ENDS OF EACH CITY BLOCK AND SHALL BE PLACED SO THEY LINE UP ACROSS FROM EACH OTHER. SEE EXAMPLE ON SHEET 2 OF 3.
  - ⓔ USE LARGE ARROW SIZE FOR BOTH RURAL AND URBAN LOCATIONS. (SEE LAST PAGE OF SECTION 780x FOR SYMBOLS TABLE)

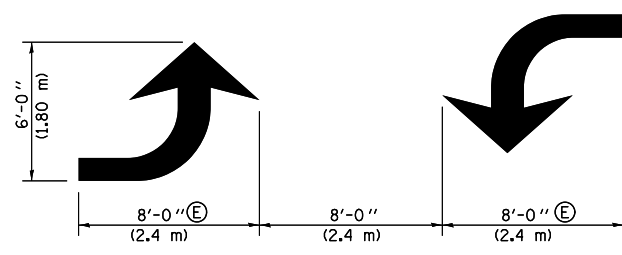
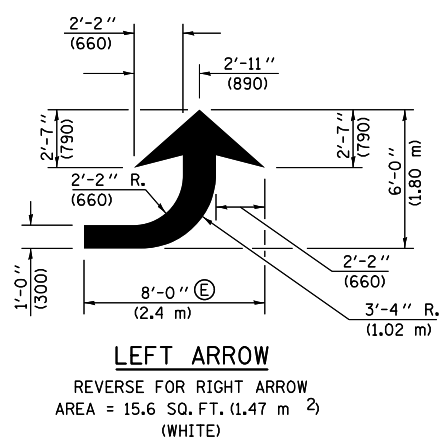

**BLOOMINGTON-NORMAL CITY LIMITS ONLY**

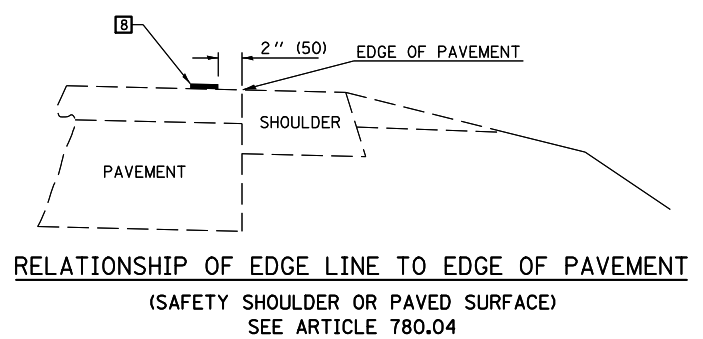
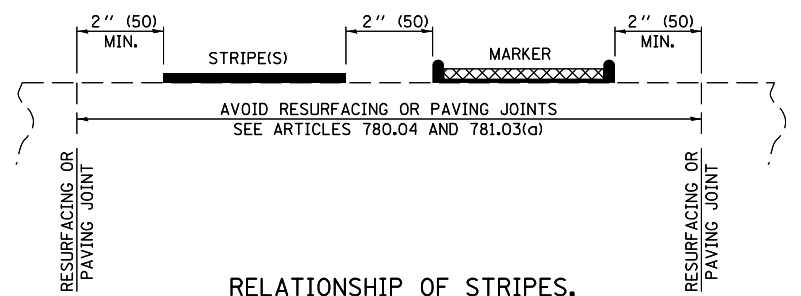
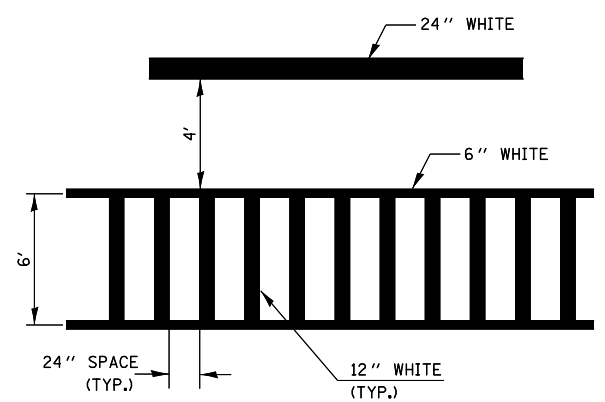

\* D5 CRACK & JOINT SEAL 2011-2  
 \*\* CHAMPAIGN, DOUGLAS, & VERMILION

Note: All dimensions are in INCHES (millimeters) unless otherwise shown.

FILE NAME =		USER NAME = ppersonbr		DESIGNED -		REVISED - 11/06		<b>STATE OF ILLINOIS DEPARTMENT OF TRANSPORTATION</b>		<b>PAVEMENT MARKING AND MARKERS (RURAL &amp; URBAN APPLICATIONS)</b>				F.A. RTE.		SECTION		COUNTY		TOTAL SHEETS		SHEET NO.	
e:\pwork\pwork\pwork\personbr\d0252772\0570881-shit-cover.dgn		DRAWN -		REVISOR - 09/2009 - KJT		REVISED -								VAR.		.		**		29		26	
PLOT SCALE = 40.0000' / in.		CHECKED -		REVISED -		REVISED -				SCALE:				SHEET NO. 2 OF 4 SHEETS		STA.		TO STA.		CONTRACT NO. 70881			
PLOT DATE = 2/4/2011		DATE -		REVISED -		REVISED -														FED. ROAD DIST. NO. ILLINOIS FED. AID PROJECT			

**DISTRICT 5 DETAIL NO. 7800AAA**

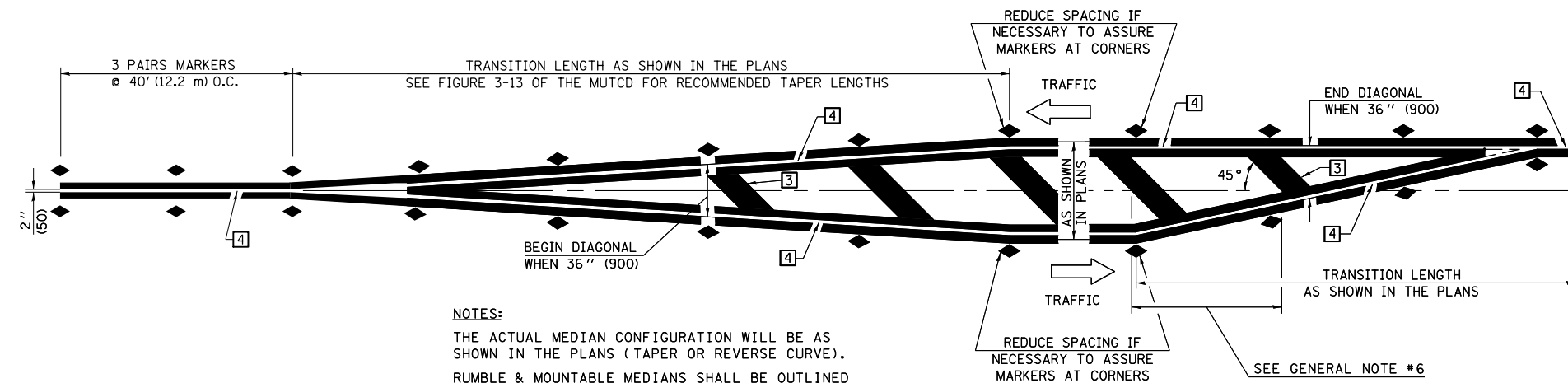

**NOTES:**  
 THE ACTUAL MEDIAN CONFIGURATION WILL BE AS SHOWN IN THE PLANS (TAPER OR REVERSE CURVE).  
 RUMBLE & MOUNTABLE MEDIANS SHALL BE OUTLINED WITH [2].

**TYPICAL MEDIAN TRANSITIONS**

**GENERAL NOTES**

1. WHEN MEDIANS ARE PRESENT, PAVEMENT MARKINGS ARE TO BE PLACED ADJACENT TO MEDIANS.
2. SOME OF THE INFORMATION INCLUDED WITH THIS DETAIL MAY NOT BE APPLICABLE TO THIS IMPROVEMENT.
3. PAVEMENT MARKINGS ARE TO BE EXTENDED THROUGH OMISSIONS WHEN APPLICABLE.
4. A STRIPING KEY IS AVAILABLE ELSEWHERE AND SHALL BE SHOWN WHERE THE QUANTITIES ARE LISTED.
5. FINAL PAVEMENT MARKINGS SHALL BE IN PLACE PRIOR TO PLACING ANY RAISED REFLECTIVE PAVEMENT MARKERS.
6. THE FOLLOWING CRITERIA SHALL BE USED FOR SELECTING THE DIAGONAL PAVEMENT MARKING SPACING,  
 < 30 MPH USE 15' (< 50 km/h USE 4.5 m)  
 30-45 MPH USE 20' (50-75 km/h USE 6.0 m)  
 > 45 MPH USE 30' (> 75 km/h USE 9.0 m)

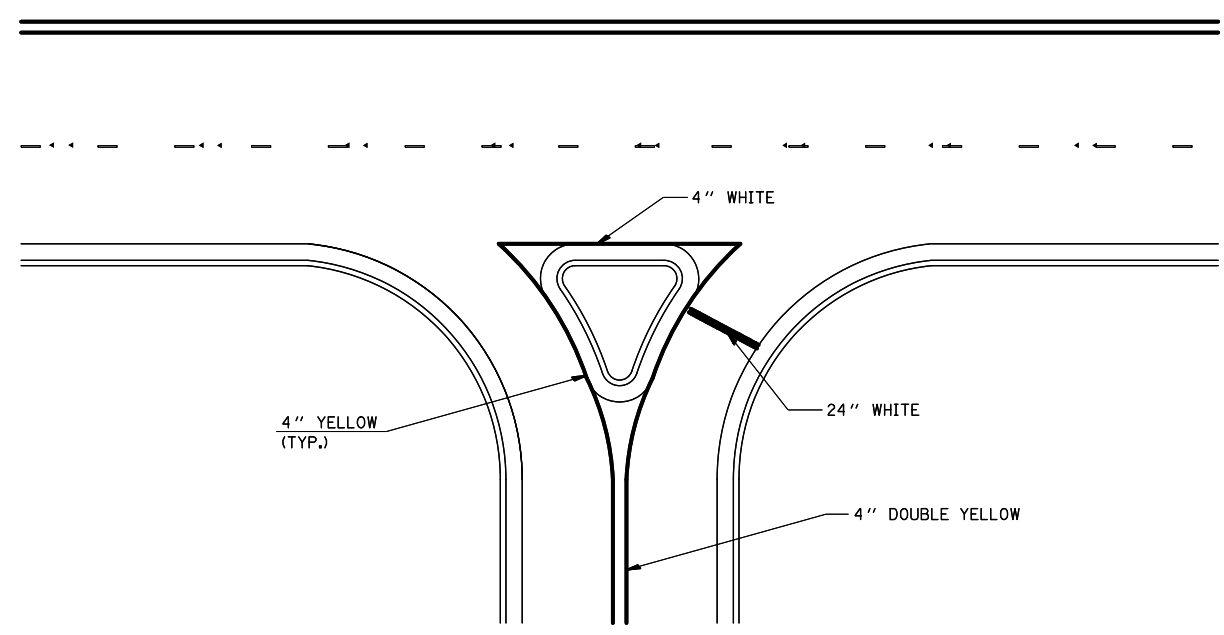

**RIGHT IN - RIGHT OUT ACCESS**

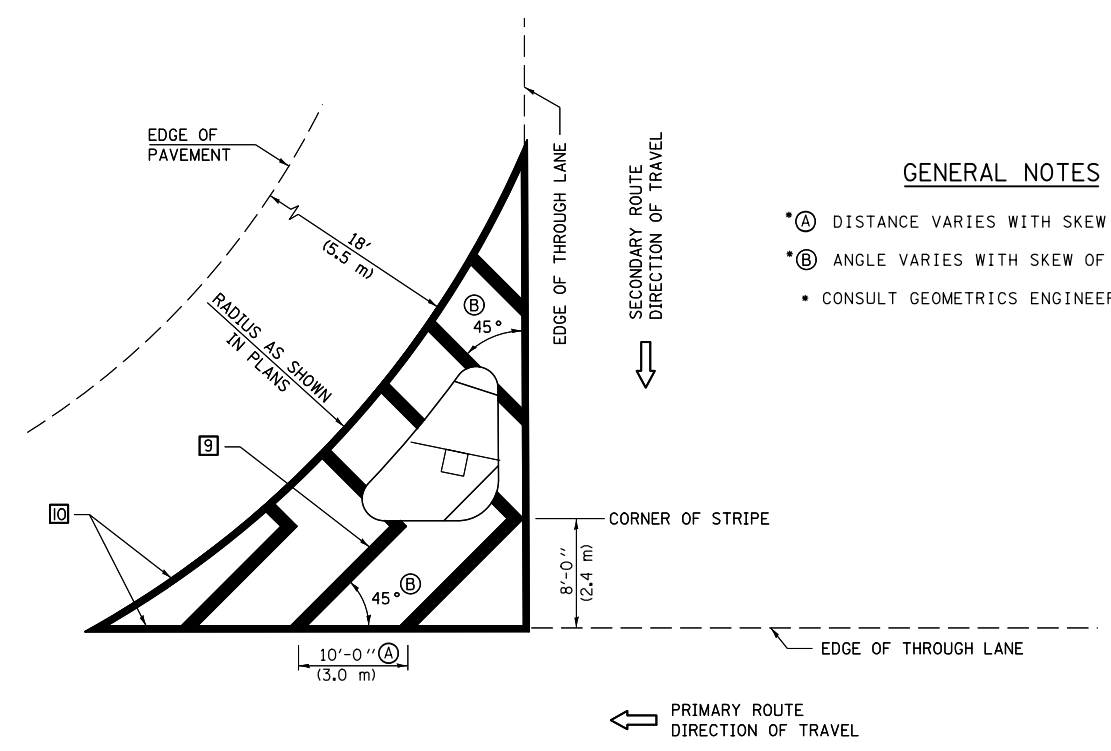

**GENERAL NOTES**

- (A) DISTANCE VARIES WITH SKEW OF INTERSECTION.
- (B) ANGLE VARIES WITH SKEW OF INTERSECTION.
- CONSULT GEOMETRICS ENGINEER

**ISLAND**

\* D5 CRACK & JOINT SEAL 2011-2  
 \*\* CHAMPAIGN, DOUGLAS, & VERMILION  
 Note: All dimensions are in INCHES (millimeters) unless otherwise shown.

FILE NAME =	USER NAME = ppersonbr	DESIGNED -	REVISED - 11/06
et:\pwork\pwork\personbr\d0252772\0570881-shit-cover.dgn		DRAWN -	REVISED - 09/2009 - KJT
	PLOT SCALE = 40.0000' / in.	CHECKED -	REVISED -
	PLOT DATE = 2/4/2011	DATE -	REVISED -

**STATE OF ILLINOIS  
 DEPARTMENT OF TRANSPORTATION**

**PAVEMENT MARKING AND MARKERS  
 (RURAL & URBAN APPLICATIONS)**

SCALE: SHEET NO. 3 OF 4 SHEETS STA. TO STA.

**DISTRICT 5 DETAIL NO. 7800AAAA**

F.A. RTE.	SECTION	COUNTY	TOTAL SHEETS	SHEET NO.
VAR.	*	**	29	27
CONTRACT NO. 70881				
FED. ROAD DIST. NO. ILLINOIS FED. AID PROJECT				

RAILROAD CROSSING WITH INTERCONNECT ONLY

RAILROAD CROSSING WITH INTERCONNECT AND PRE-SIGNALS

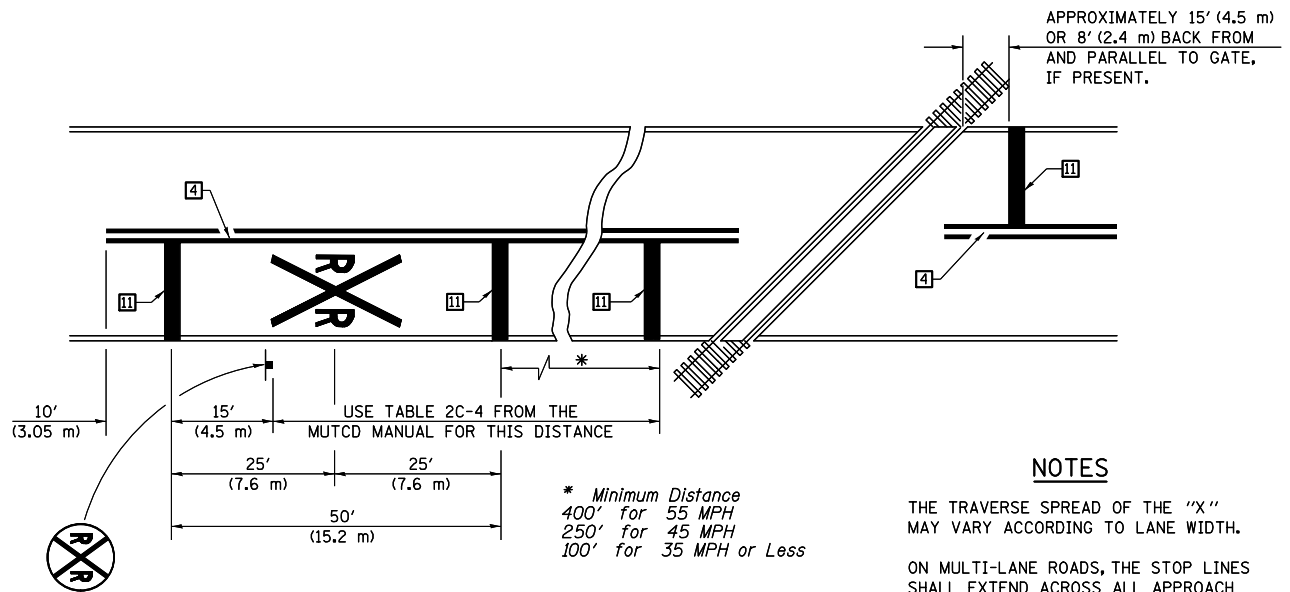

PAVEMENT MARKINGS AT RAILROAD-HIGHWAY GRADE CROSSING

NOTES

APPROXIMATELY 15' (4.5 m) OR 8' (2.4 m) BACK FROM AND PARALLEL TO GATE, IF PRESENT.

THE TRAVERSE SPREAD OF THE "X" MAY VARY ACCORDING TO LANE WIDTH.

ON MULTI-LANE ROADS, THE STOP LINES SHALL EXTEND ACROSS ALL APPROACH LANES AND SEPARATE RXR SYMBOLS SHALL BE PLACED ADJACENT TO EACH OTHER IN EACH LANE.

WHEN THE PAVEMENT MARKING SYMBOL IS USED, A PORTION OF THE SYMBOL SHOULD BE LOCATED DIRECTLY ADJACENT TO THE ADVANCE WARNING SIGN (W10-1) AS PLACED BY TABLE II-1, CONDITION B OF THE MUTCD.

\* Minimum Distance  
400' for 55 MPH  
250' for 45 MPH  
100' for 35 MPH or Less

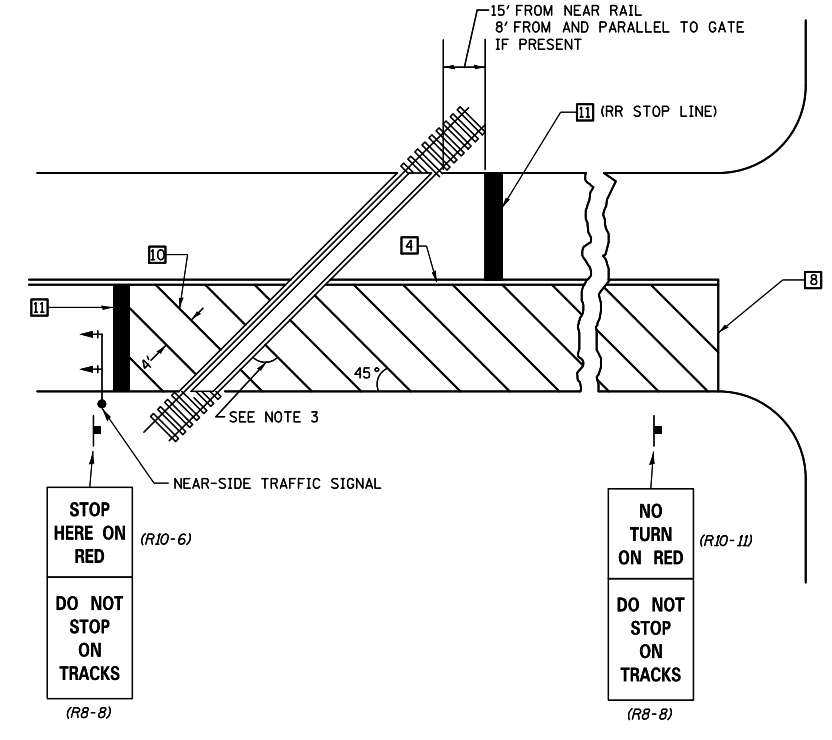
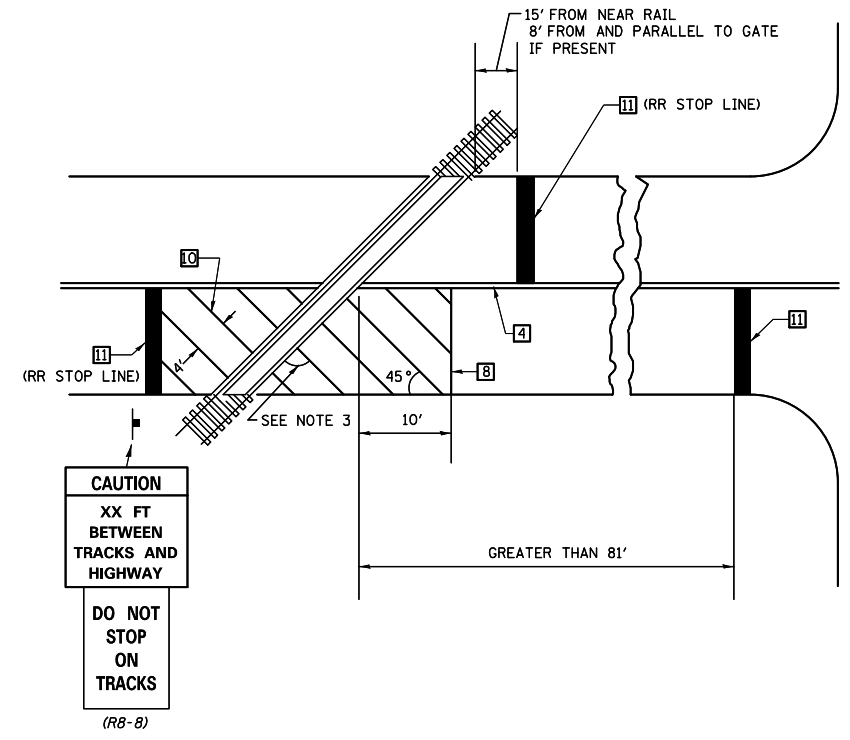

SUPPLEMENTAL PAVEMENT MARKING TREATMENT FOR RAILROAD-HIGHWAY GRADE CROSSING

GENERAL NOTES

- SUPPLEMENTAL PAVEMENT MARKINGS TO BE INSTALLED ONLY ON APPROACHES TO INTERSECTIONS CONTROLLED BY TRAFFIC SIGNALS WHICH ARE INTERCONNECTED WITH THE RAILROAD WARNING SIGNALS.
- EXTEND PAVEMENT MARKINGS TO THE INTERSECTION ONLY WHERE NEAR-SIDE TRAFFIC SIGNALS ARE USED.
- WHERE THE ANGLE BETWEEN THE DIAGONAL PAVEMENT MARKINGS AND THE TRACK WOULD BE LESS THAN 20°, THE PAVEMENT MARKINGS SHOULD BE PLACED IN THE OPPOSITE DIRECTION FROM THAT SHOWN.

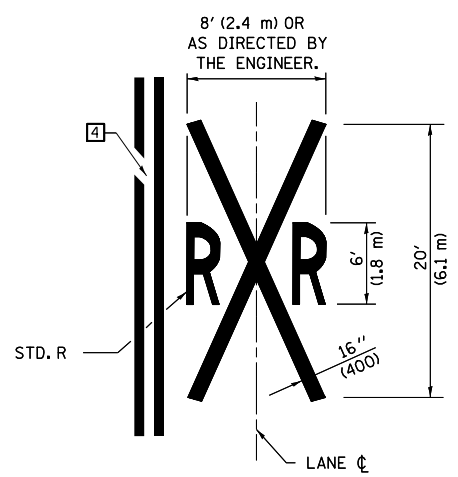

\* D5 CRACK & JOINT SEAL 2011-2  
\*\* CHAMPAIGN, DOUGLAS, & VERMILION

Note: All dimensions are in INCHES (millimeters) unless otherwise shown.

FILE NAME =	USER NAME = ppersonbr	DESIGNED -	REVISED - 11/06
et:\pw\work\p\idot\ppersonbr\d0252772\0570881-sh1-cover.dgn		DRAWN -	REVISED - 09/2009 - KJT
	PLOT SCALE = 48.0000' / in.	CHECKED -	REVISED -
	PLOT DATE = 2/4/2011	DATE -	REVISED -

STATE OF ILLINOIS  
DEPARTMENT OF TRANSPORTATION

PAVEMENT MARKING AND MARKERS  
(RURAL & URBAN APPLICATIONS)

SCALE: SHEET NO. 4 OF 4 SHEETS STA. TO STA.

DISTRICT 5 DETAIL NO. 7800AAA

F.A. RTE.	SECTION	COUNTY	TOTAL SHEETS	SHEET NO.
VAR.	*	**	29	28
CONTRACT NO. 70881				
FED. ROAD DIST. NO. ILLINOIS FED. AID PROJECT				

CENTERLINE INTERSTATE OR MULTI-LANE TWO WAY DIVIDED HIGHWAY

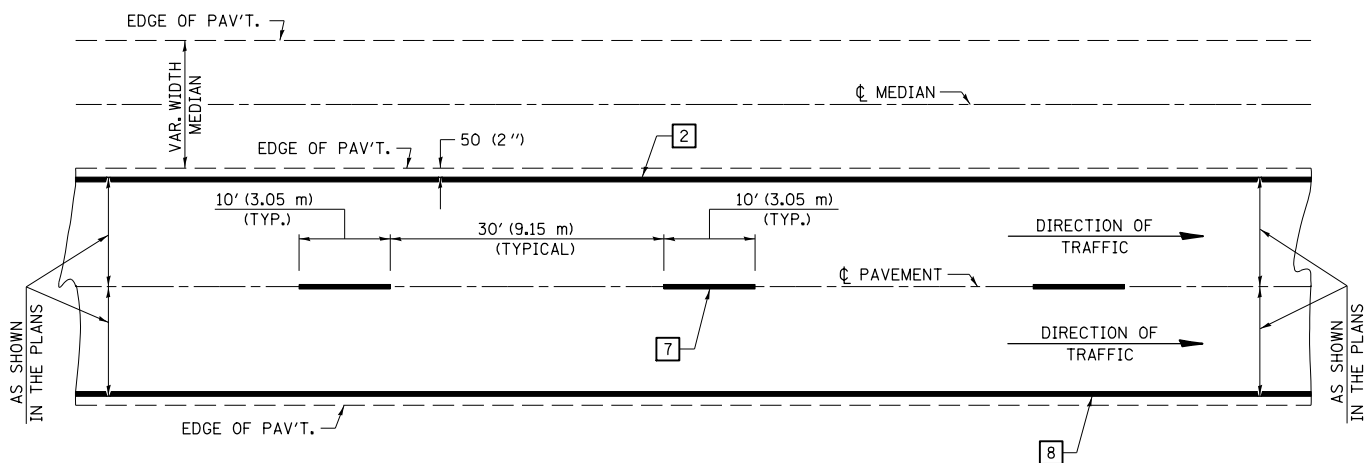

NOTE: PAVEMENT MARKINGS ARE TO BE EXTENDED THROUGH OMISSIONS WHEN APPLICABLE.

NOTE: SEE ARTICLES 780.04 & 781.03 FOR LOCATION OF STRIPES AND MARKERS RELATIVE TO EDGES OR JOINTS.

FOR RAISED REFLECTIVE PAVEMENT MARKERS, REFER TO STANDARD 781001.

TYPICAL EXIT RAMP TERMINAL

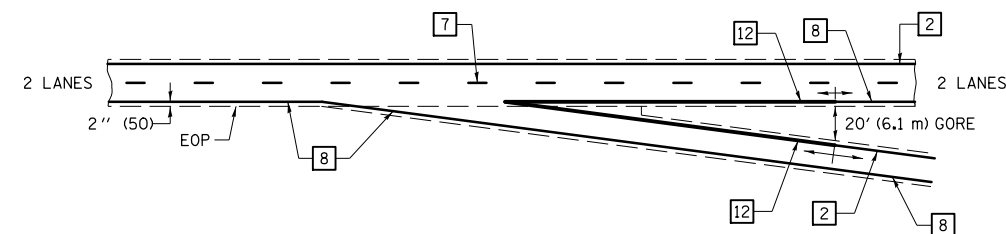

EXIT RAMP TERMINAL with EXCLUSIVE (auxiliary) LANE

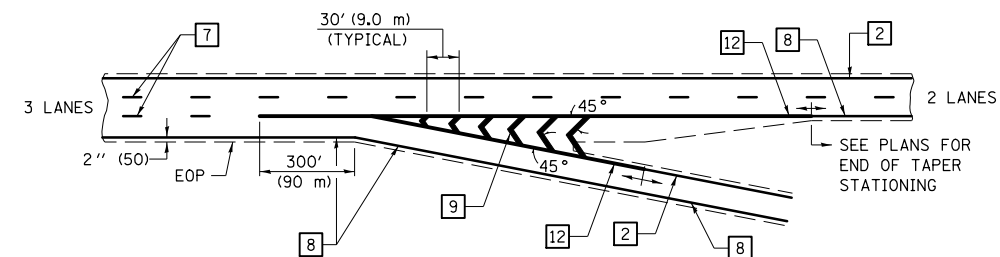

TYPICAL PAVEMENT MARKING LEGEND

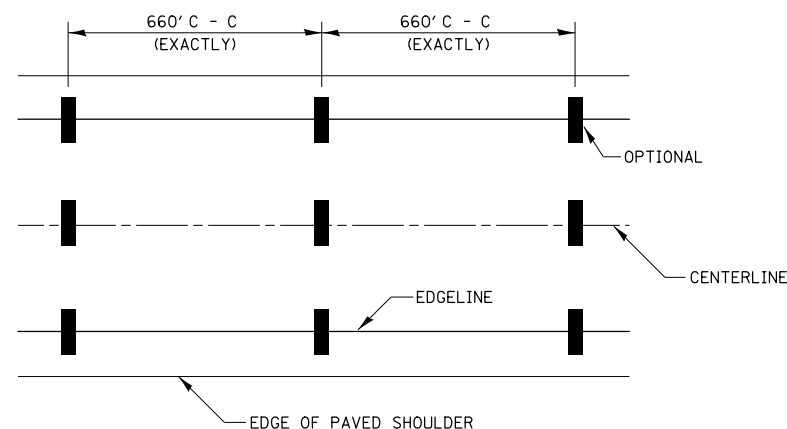

- 1 4" (100) SKIP-DASH (YELLOW)
- 2 4" (100) SOLID (YELLOW)
- 3 12" (300) DIAGONAL (YELLOW)
- 4 4" (100) DOUBLE YELLOW (NARROW)
- 5 RESERVED
- 6 RESERVED
- 7 4" (100) SKIP-DASH (WHITE)
- 8 4" (100) SOLID (WHITE)
- 9 12" (300) DIAGONAL (WHITE)
- 10 6" (150) SOLID (WHITE)
- 11 24" (600) STOP BAR (WHITE)
- 12 8" (200) SOLID (WHITE)
- 13 4" (100) LANE LINE EXTENSIONS (WHITE)

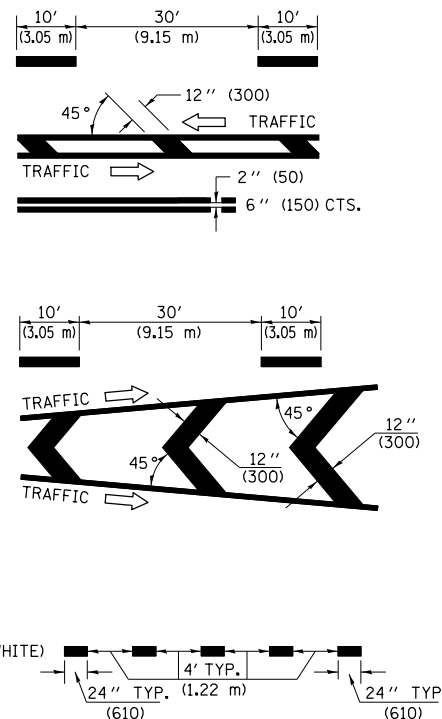

TYPICAL ENTRANCE RAMP TERMINAL

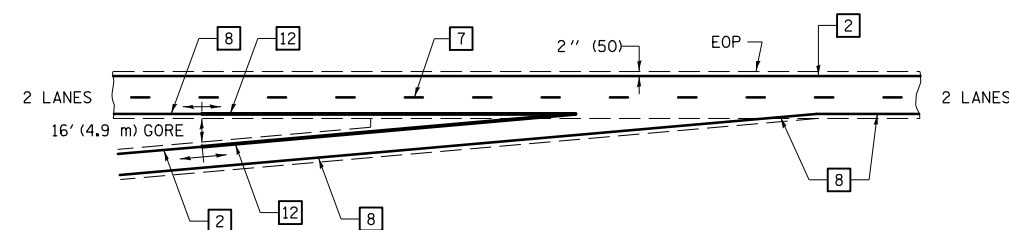

ENTRANCE RAMP TERMINAL with EXCLUSIVE LANE

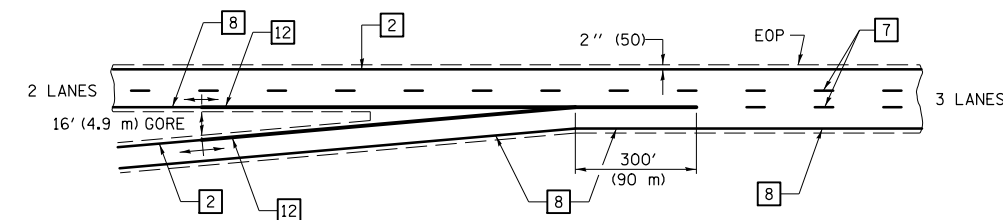

IT WILL BE NECESSARY TO HAVE A REPRESENTATIVE OF THE STATE POLICE PRESENT SO THAT THE ACCURACY OF MEASUREMENT CAN BE ATTESTED TO IN COURT.

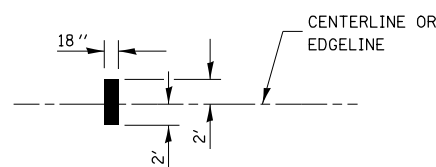

AERIAL SPEED CHECK ZONES

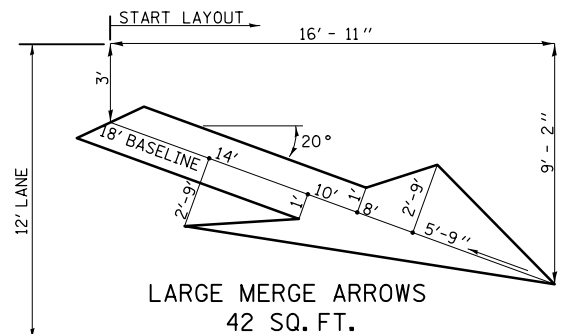

- \* D5 CRACK & JOINT SEAL 2011-2
  - \*\* CHAMPAIGN, DOUGLAS, & VERMILION
- Note: All dimensions are in INCHES (millimeters) unless otherwise shown.

DISTRICT 5 DETAIL NO. 7800BBBB

FILE NAME =	USER NAME = ppersonbr	DESIGNED -	REVISED - 11/06
ei:\pw\work\p\pidot\ppersonbr\d0252772\0570881-sh-t-cover.dgn		DRAWN -	REVISED -
	PLOT SCALE = 48.0000' / in.	CHECKED -	REVISED -
	PLOT DATE = 2/4/2011	DATE -	REVISED -

STATE OF ILLINOIS  
DEPARTMENT OF TRANSPORTATION

PAVEMENT MARKING (INTERSTATE & MULTI-LANE APPLICATIONS)

SCALE: SHEET NO. OF SHEETS STA. TO STA.

F.A. RTE.	SECTION	COUNTY	TOTAL SHEETS	SHEET NO.
VAR.	*	**	29	29
CONTRACT NO. 70881				
FED. ROAD DIST. NO.		ILLINOIS FED. AID PROJECT		