

SEC 6, T8N, R5W, 3RD PM

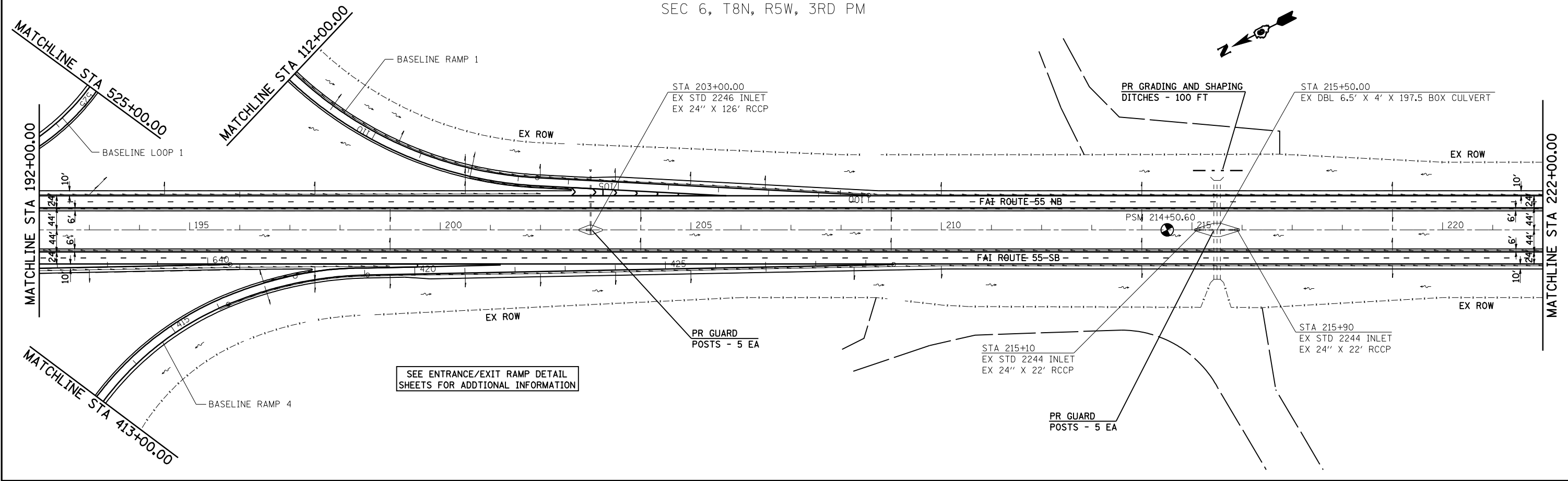

SEE ENTRANCE/EXIT RAMP DETAIL SHEETS FOR ADDITIONAL INFORMATION

SEC 6, T8N, R5W, 3RD PM

SEC 7, T8N, R5W, 3RD PM

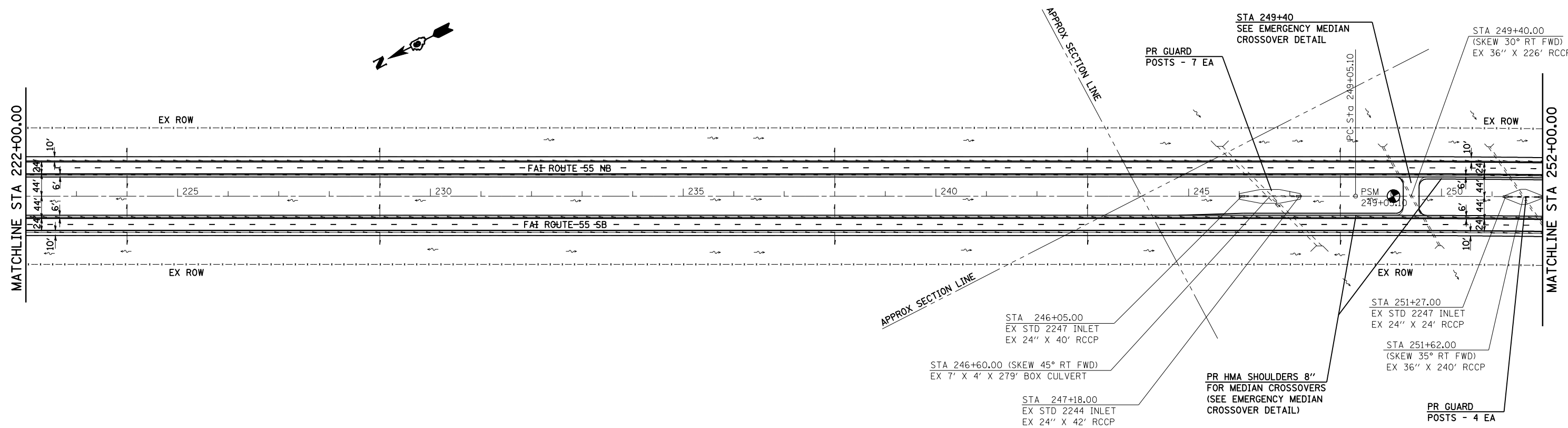

FILE NAME =	USER NAME = coxte	DESIGNED -	REVISED -
et:\pw\work\pms\dot\coxte\dms62217\067292	-sht-plan100.dgn	DRAWN -	REVISED -
	PLOT SCALE = 200.0000' / IN.	CHECKED -	REVISED -
	PLOT DATE = Feb-07-2011 02:00:35PM	DATE -	REVISED -

STATE OF ILLINOIS
DEPARTMENT OF TRANSPORTATION

I-55 PLAN SHEETS

SCALE: 1" = 100' SHEET NO. OF SHEETS STA. TO STA.

F.A.I. RTE.	SECTION	COUNTY	TOTAL SHEETS	SHEET NO.
55	(59,68)RS-3,BR		137	33
CONTRACT NO. 72921			ILLINOIS FED. AID PROJECT	

MONTGOMERY, MACOUPIN