

SEC 3, T7N, R6W, 3RD PM

SEC 10, T7N, R6W, 3RD PM

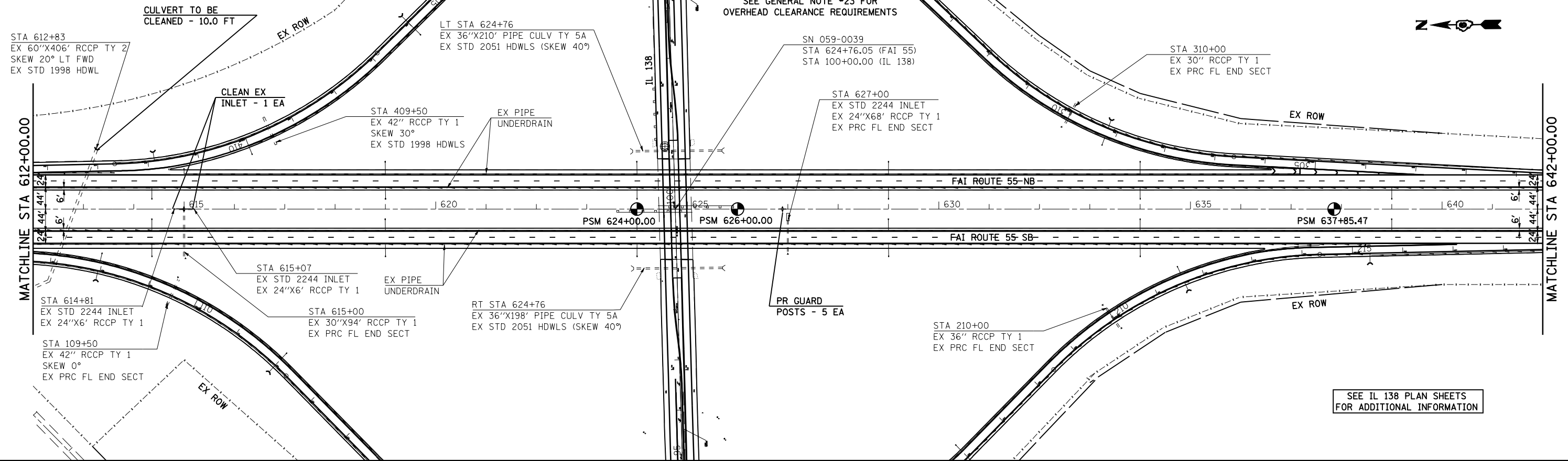

SEE IL 138 PLAN SHEETS FOR ADDITIONAL INFORMATION

SEC 10, T7N, R6W, 3RD PM

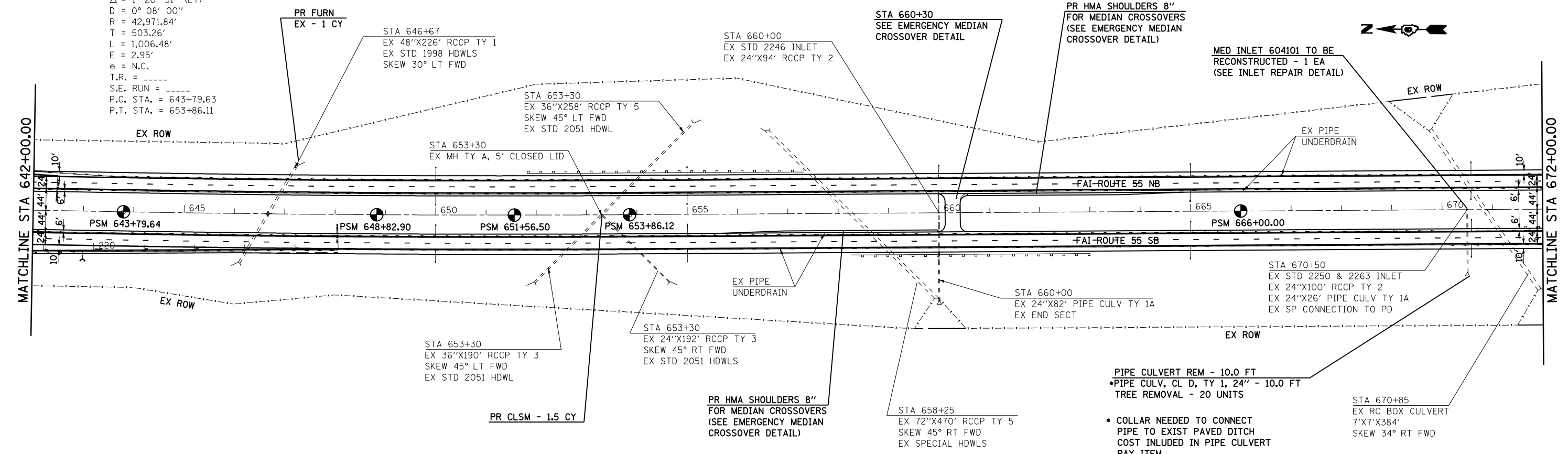

PIPE CULVERT REM - 10.0 FT
•PIPE CULV. CL D, TY 1, 24\" - 10.0 FT
TREE REMOVAL - 20 UNITS

* COLLAR NEEDED TO CONNECT PIPE TO EXIST PAVED DITCH
COST INCLUDED IN PIPE CULVERT PAY ITEM

FILE NAME =	USER NAME = coxte	DESIGNED -	REVISED -
et:\pwwork\pwwork\dot\coxte\dms62217\067292	-sht-plan100.dgn	DRAWN -	REVISED -
	PLOT SCALE = 200.0000' / IN.	CHECKED -	REVISED -
	PLOT DATE = Feb-07-2011 02:01:00PM	DATE -	REVISED -

STATE OF ILLINOIS
DEPARTMENT OF TRANSPORTATION

I-55 PLAN SHEETS

SCALE: 1" = 100' SHEET NO. OF SHEETS STA. TO STA.

F.A.I. RTE.	SECTION	COUNTY	TOTAL SHEETS	SHEET NO.
55	(59,68)RS-3,BR		137	40
CONTRACT NO. 72921			ILLINOIS FED. AID PROJECT	

MONTGOMERY, MACOUPIN