

DECATUR, ILLINOIS
 ENGINEERS - CONSULTANTS
 BLANK, WESSELINK, COOK & ASSOCIATES

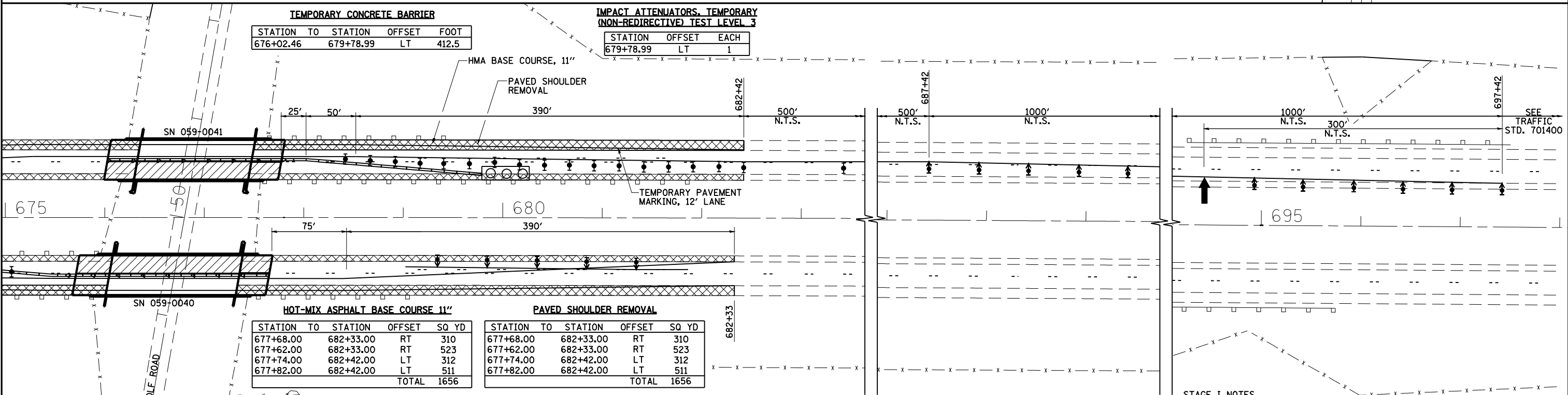
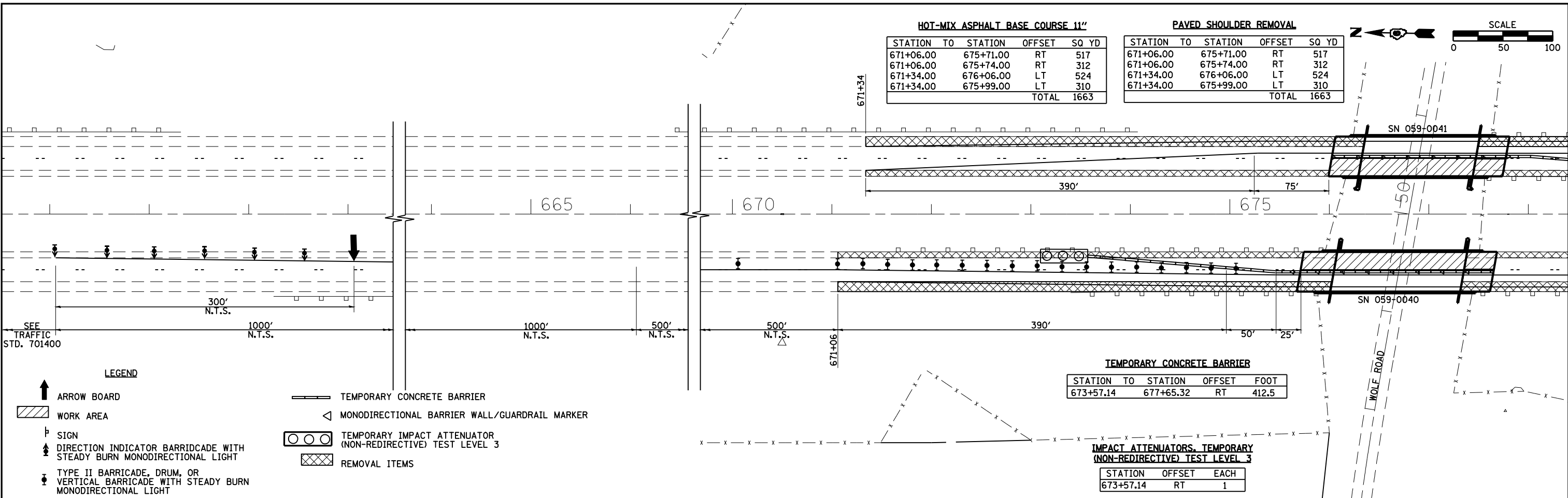

- SUGGESTED SEQUENCE OF CONSTRUCTION**
1. CONSTRUCT HMA BASE COURSE FOR STAGE I AND STAGE II TRAFFIC USING TRAFFIC CONTROL STANDARD 701406.
 2. ERECT SIGNS, TEMP. BARRIERS, ETC. ACCORDING TO TRAFFIC CONTROL STANDARDS 701400 AND 701402.
 3. PLACE TEMPORARY PAVEMENT MARKING LINE FOR A 12'-0" TRAFFIC LANE.
 4. CONSTRUCT STAGE I PORTION OF BRIDGE DECK.

- STAGE I NOTES**
1. TRAFFIC CONTROL FOR STAGE I CONSTRUCTION OF THE BRIDGE AND BRIDGE APPROACH PAVEMENTS SHALL BE IN ACCORDANCE WITH THE DETAILS SHOWN, STANDARD 701400, 701402, THE BRIDGE PLANS, AND THE SPECIAL PROVISIONS.
 2. ALL SIGNAGE, TRAFFIC CONTROL EQUIPMENT AND TEMPORARY PAVEMENT MARKING SHALL BE IN ACCORDANCE WITH THE LATEST VERSION OF HIGHWAY STANDARD 701400 & 701402 AND SHALL BE INCLUDED IN THE CONTRACT UNIT PRICE EACH FOR TRAFFIC CONTROL & PROTECTION 701402.

FILE NAME =	USER NAME = coxte	DESIGNED -	REVISED -
ei:\pw\work\p1dot\coxte\d0258400\067292\stg-staging_40_41.dgn		DRAWN -	REVISED -
PLOT SCALE = 100.0000' / IN.		CHECKED -	REVISED -
PLOT DATE = Feb-07-2011 02:04:53PM		DATE -	REVISED -

STATE OF ILLINOIS
DEPARTMENT OF TRANSPORTATION

STAGE I CONSTRUCTION (SN 059-0040 & 059-0041)
 SCALE: SHEET NO. 1 OF 2 SHEETS STA. TO STA.

F.A.I. RTE.	SECTION	COUNTY	TOTAL SHEETS	SHEET NO.
55	(59,68)RS-3, BR	MACOUPIN	137	95
CONTRACT NO. 72921				
FED. ROAD DIST. NO. ILLINOIS FED. AID PROJECT				