

BLANK, WESSELINK, COOK & ASSOCIATES
ENGINEERS - CONSULTANTS
DECATUR, ILLINOIS

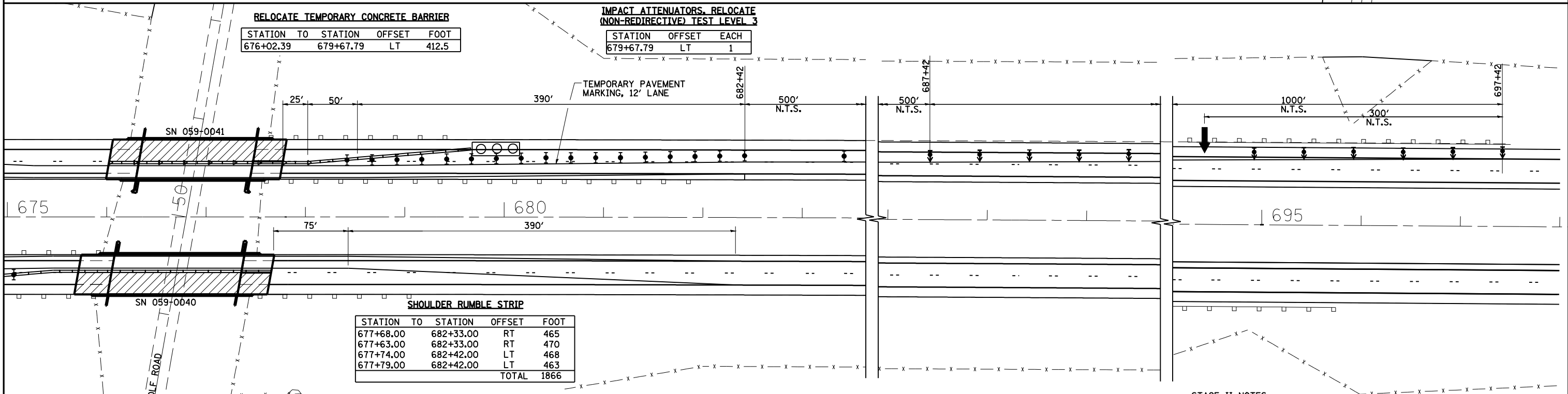
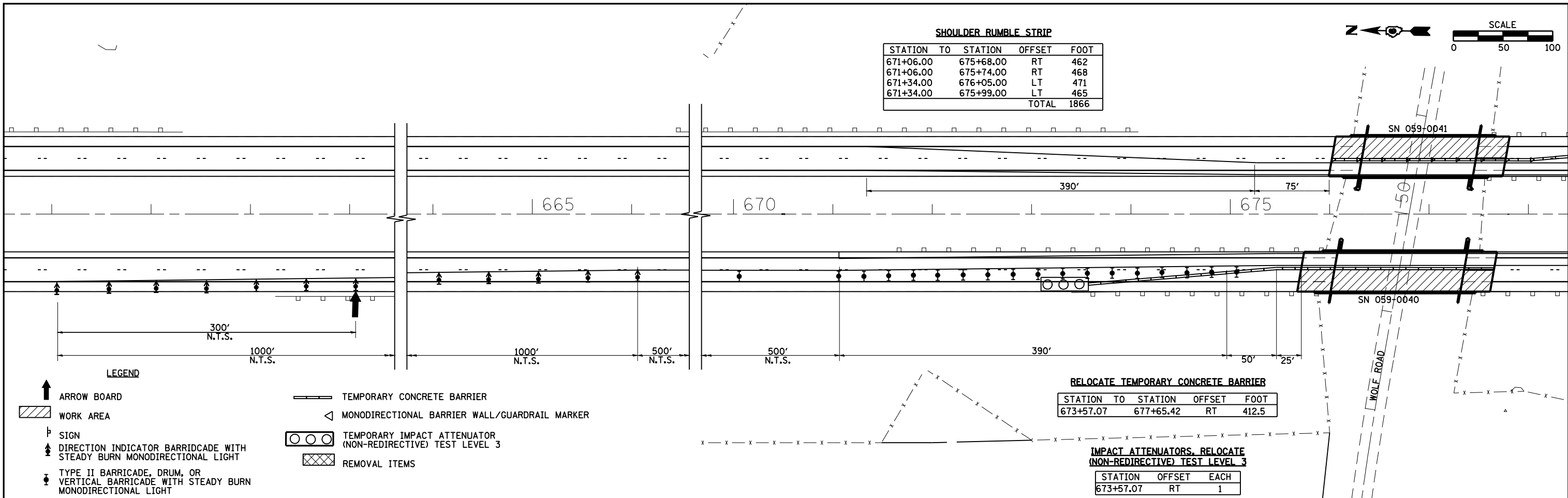

- SUGGESTED SEQUENCE OF CONSTRUCTION**
1. RELOCATE SIGNS, TEMP. BARRIERS, ETC. ACCORDING TO TRAFFIC CONTROL STANDARDS 701400 AND 701402.
 2. PLACE TEMPORARY PAVEMENT MARKING LINE FOR A 12'-0" TRAFFIC LANE.
 3. CONSTRUCT STAGE II PORTION OF BRIDGE DECK.
 4. REMOVE ALL TRAFFIC CONTROL ITEMS.

- STAGE II NOTES**
1. TRAFFIC CONTROL FOR STAGE II CONSTRUCTION OF THE BRIDGE AND BRIDGE APPROACH PAVEMENTS SHALL BE IN ACCORDANCE WITH THE DETAILS SHOWN, STANDARD 701400, 701402, THE BRIDGE PLANS, AND THE SPECIAL PROVISIONS.
 2. ALL SIGNAGE, TRAFFIC CONTROL EQUIPMENT AND TEMPORARY PAVEMENT MARKING SHALL BE IN ACCORDANCE WITH THE LATEST VERSION OF HIGHWAY STANDARD 701400 & 701402 AND SHALL BE INCLUDED IN THE CONTRACT UNIT PRICE EACH FOR TRAFFIC CONTROL & PROTECTION 701402.