

STATE OF ILLINOIS
DEPARTMENT OF TRANSPORTATION
DIVISION OF HIGHWAYS

**PROPOSED
HIGHWAY PLANS**

FAP 322/SBI 2 (US ROUTE 51)

SECTION (24,25)RS-3

PROJECT NHF-0322(095)

RESURFACING FROM
FAYETTE COUNTY LINE TO
KINOKA ROAD

MARION COUNTY

C-98-044-08

F.A.P. RTE.	SECTION	COUNTY	TOTAL SHEETS	SHEET NO.
322	(24,25)RS-3	MARION	27	1
ILLINOIS		CONTRACT NO. 76B76		

FOR INDEX OF SHEETS, SEE SHEET NO. 2

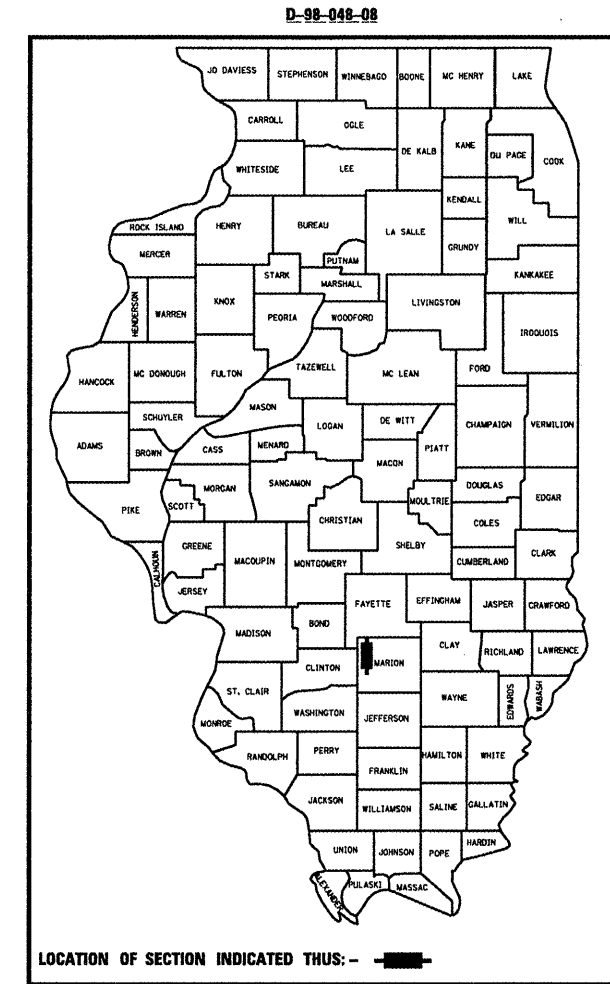

BEGIN PROJECT:
STA. 502 + 50
LAT: 38.823677
LONG: -89.088051

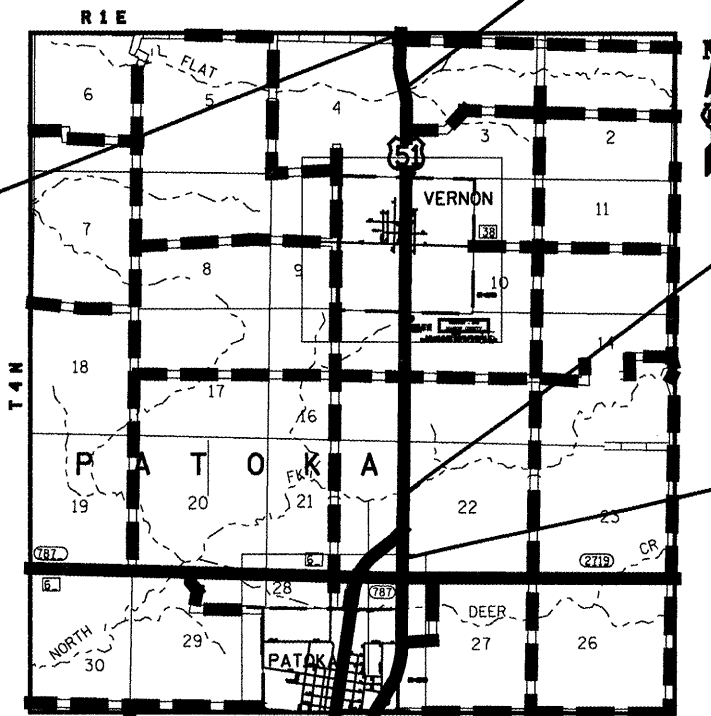

BRIDGE OMISSION:
SN 061-0001
STA. 522 + 75
TO
STA 524 + 95

BRIDGE OMISSION:
SN 061-0094
STA 684 + 70
TO
STA. 691 + 05

END PROJECT:
STA. 709 + 00
LAT: 38.765054
LONG: -89.086753

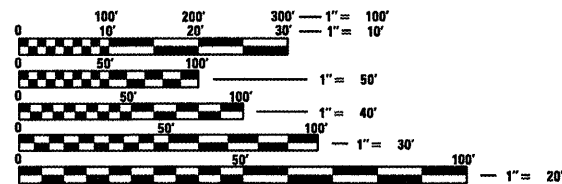

FULL SIZE PLANS HAVE BEEN PREPARED USING STANDARD ENGINEERING SCALES. REDUCED SIZED PLANS WILL NOT CONFORM TO STANDARD SCALES. IN MAKING MEASUREMENTS ON REDUCED PLANS, THE ABOVE SCALES MAY BE USED.

J.U.L.I.E.
JOINT UTILITY LOCATION INFORMATION FOR EXCAVATION
1-800-892-0123
OR 811

PROJECT ENGINEER TIM PADGETT (618)346-3325
PROJECT MANAGER JOHN RICHARDSON (618)346-3194
& LINCOLN HILL (618)346-3194

CONTRACT NO. 76B76

ADT
ADT: 3000(2011)
ADT: 3500(2031)
SU%: 5.1%
MU%: 10.2%

1" = 1 MILE
GROSS LENGTH = 20,650 FT. = 3.911 MILE
NET LENGTH = 19,795 FT. = 3.749 MILE

FUNCTIONAL CLASSIFICATION:
OTHER PRINCIPAL ARTERIAL

STATE OF ILLINOIS
DEPARTMENT OF TRANSPORTATION
DIVISION OF HIGHWAYS

SUBMITTED February 4, 20 11
Mark C. James
DEPUTY DIRECTOR OF HIGHWAYS, REGION ENGINEER

March 05, 20 11
Scott E. Stett, P.E.
ENGINEER OF DESIGN AND ENVIRONMENT

March 25, 20 11
Christine M. Reed
DIRECTOR OF HIGHWAYS, CHIEF ENGINEER

PRINTED BY THE AUTHORITY
OF THE STATE OF ILLINOIS