

GUARDRAIL LOCATION #2

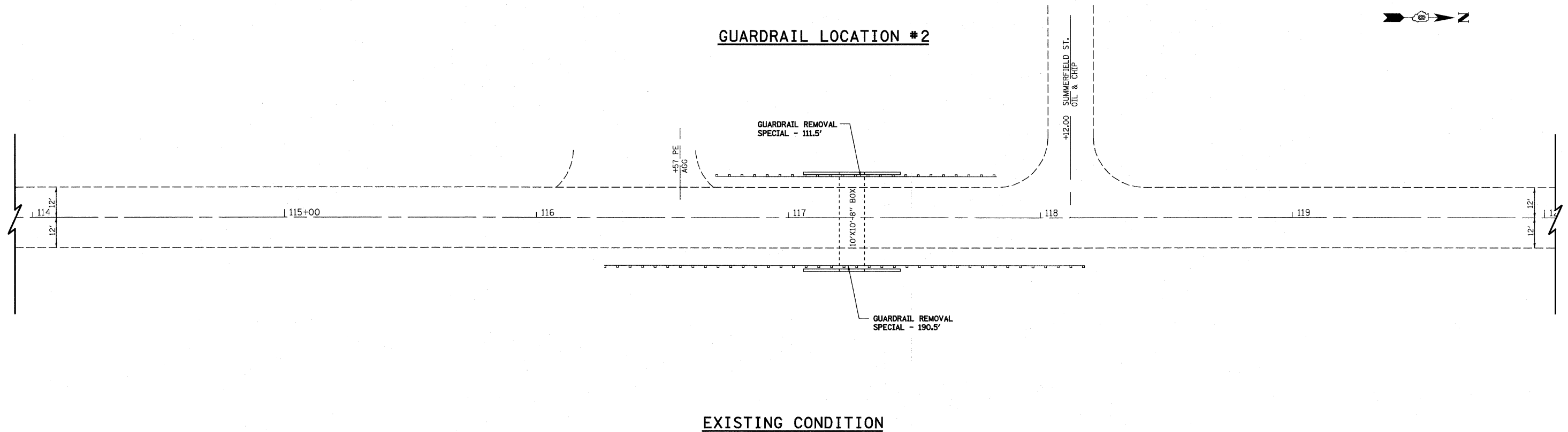

EXISTING CONDITION

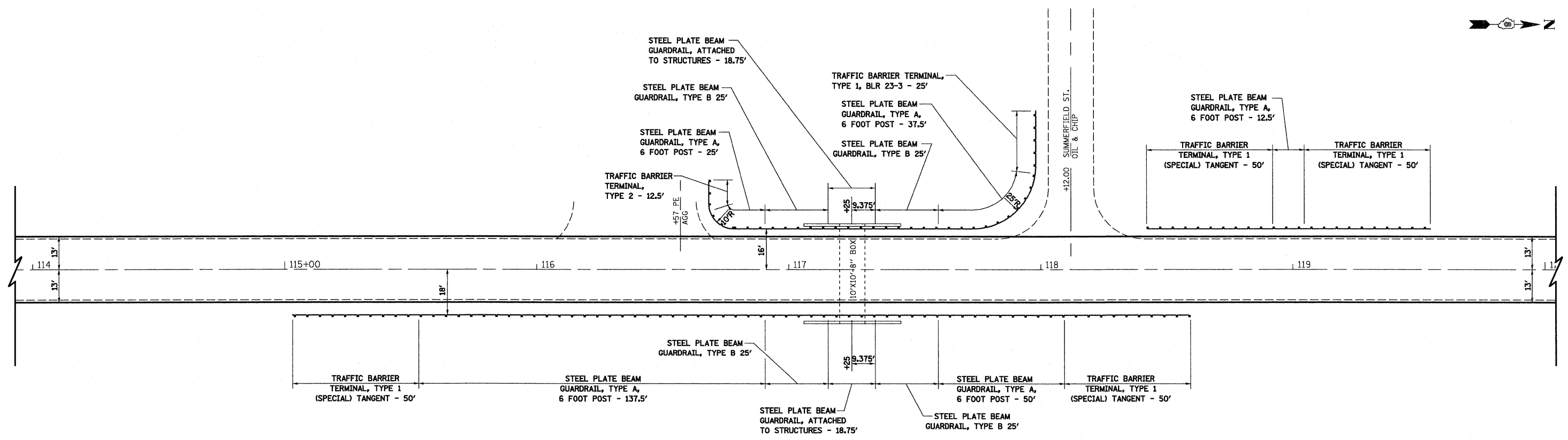
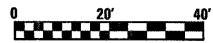

PROPOSED CONDITION



FILE NAME =	USER NAME = paul	DESIGNED - ESW	REVISED -	STATE OF ILLINOIS DEPARTMENT OF TRANSPORTATION	GUARDRAIL DETAILS			F.A.P. RTE.	SECTION	COUNTY	TOTAL SHEETS	SHEET NO.
S:\Projects\109-0028-2011 L 4 Lebanon 3rd\gpcad\05\109-0028-2011-001-001-001.dgn	DRAWN - PDB	REVISED -	314					(110, 111)RS-4	MADISON & ST. CLAIR	58	25	
PLOT SCALE = 40,0000 ' / IN.	CHECKED - BRM	REVISED -	CONTRACT NO. 76E29									
PLOT DATE = 2/7/2011	DATE - 11-10-10	REVISED -	FED. ROAD DIST. NO. ILLINOIS FED. AID PROJECT									
				SCALE: 1"=20'			SHEET NO. 2 OF 18 SHEETS		STA. TO STA.			