

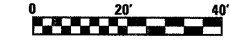

BEGIN RAILROAD
OMISSION
STA 63+41.00

BEGIN SECTION
(110,111)RS-4
STA 63+21.00

END RAILROAD
OMISSION
STA 63+50.00

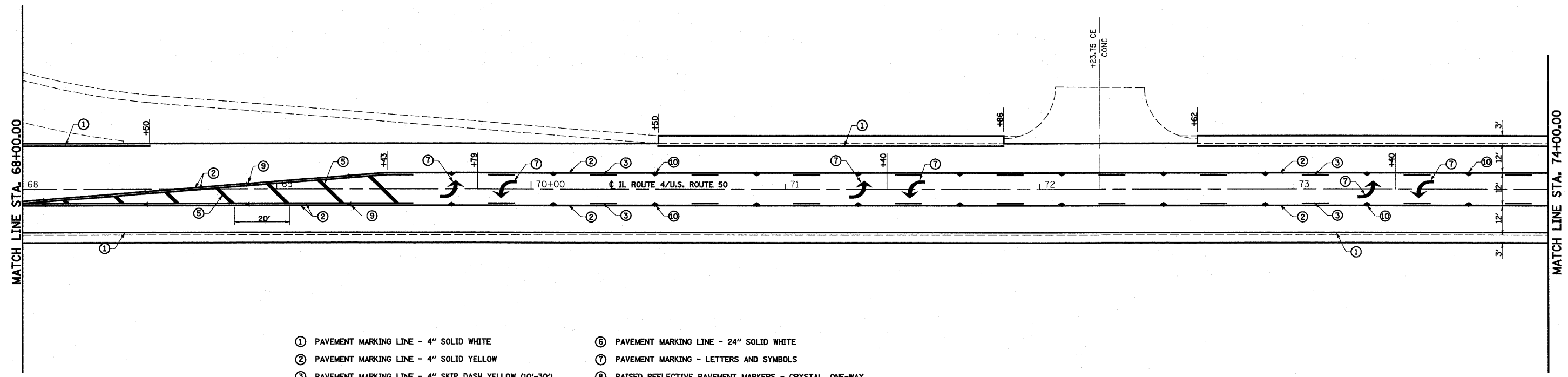
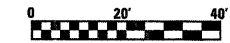
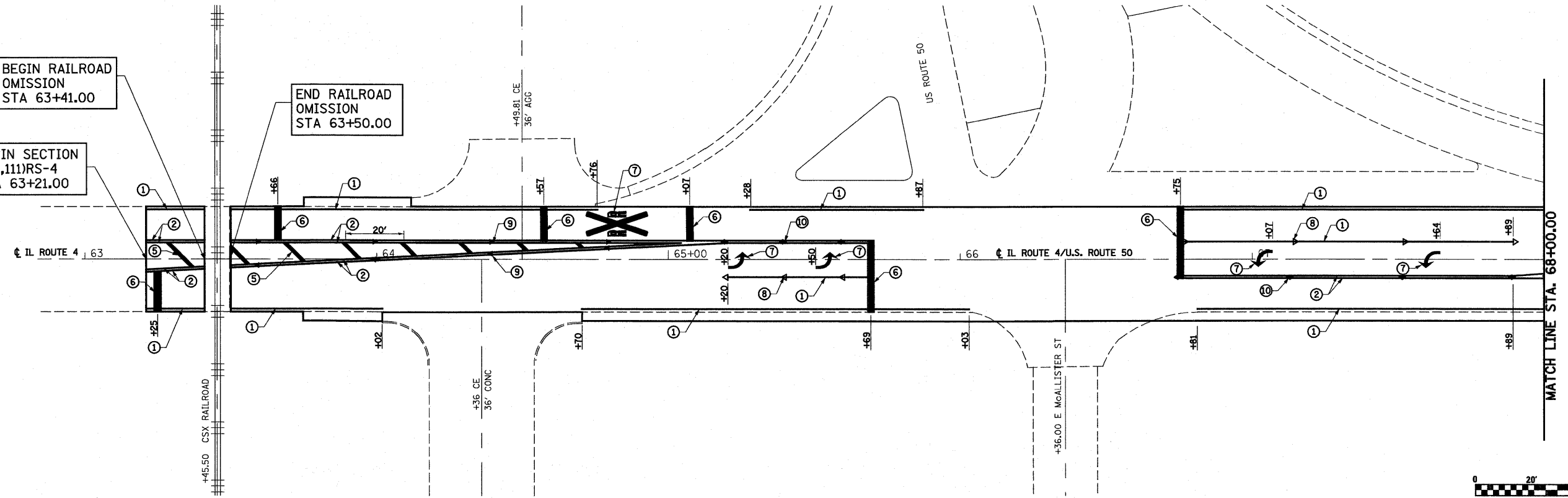

- ① PAVEMENT MARKING LINE - 4" SOLID WHITE
- ② PAVEMENT MARKING LINE - 4" SOLID YELLOW
- ③ PAVEMENT MARKING LINE - 4" SKIP DASH YELLOW (10'-30')
- ④ PAVEMENT MARKING LINE - 6" SOLID WHITE
- ⑤ PAVEMENT MARKING LINE - 12" SOLID YELLOW
- ⑥ PAVEMENT MARKING LINE - 24" SOLID WHITE
- ⑦ PAVEMENT MARKING - LETTERS AND SYMBOLS
- ⑧ RAISED REFLECTIVE PAVEMENT MARKERS - CRYSTAL, ONE-WAY
- ⑨ RAISED REFLECTIVE PAVEMENT MARKERS - AMBER, ONE-WAY
- ⑩ RAISED REFLECTIVE PAVEMENT MARKERS - AMBER, TWO-WAY

FILE NAME =	USER NAME = paul	DESIGNED - ESW	REVISED -	STATE OF ILLINOIS DEPARTMENT OF TRANSPORTATION	PAVEMENT MARKING, US ROUTE 50 /IL ROUTE 4	F.A.P RTE. 314	SECTION (110, 111)RS-4	COUNTY MADISON & ST. CLAIR	TOTAL SHEETS 58	SHEET NO. 51		
Plot Scale = 40,0000' / IN.	DATE = 11-1-10	DRAWN - PDB	REVISED -			SCALE: 1"=20'	SHEET NO. 1 OF 4 SHEETS	STA.	TO STA.	CONTRACT NO. 76E29		
PLOT DATE = 2/7/2011		CHECKED - BRM	REVISED -			FED. ROAD DIST. NO. ILLINOIS FED. AID PROJECT						
		DATE = 11-1-10	REVISED -									