

STATE OF ILLINOIS
DEPARTMENT OF TRANSPORTATION
DIVISION OF HIGHWAYS

**PROPOSED
HIGHWAY PLANS**

FAP ROUTE 805 (IL 161)
SECTION (7Z-2, 8Z-2)RS-1
PROJECT ACF-0805(072)
PATCHING & RESURFACING
MARION & CLINTON COUNTIES

C-98-003-11

F.A.P. RTE.	SECTION	COUNTY	TOTAL SHEETS	SHEET NO.
805	(7Z-2, 8Z-2)RS-1	IL	21	1
ILLINOIS CONTRACT NO. 76E51			CLINTON/MARION	

FOR INDEX OF SHEETS, SEE SHEET NO. 2

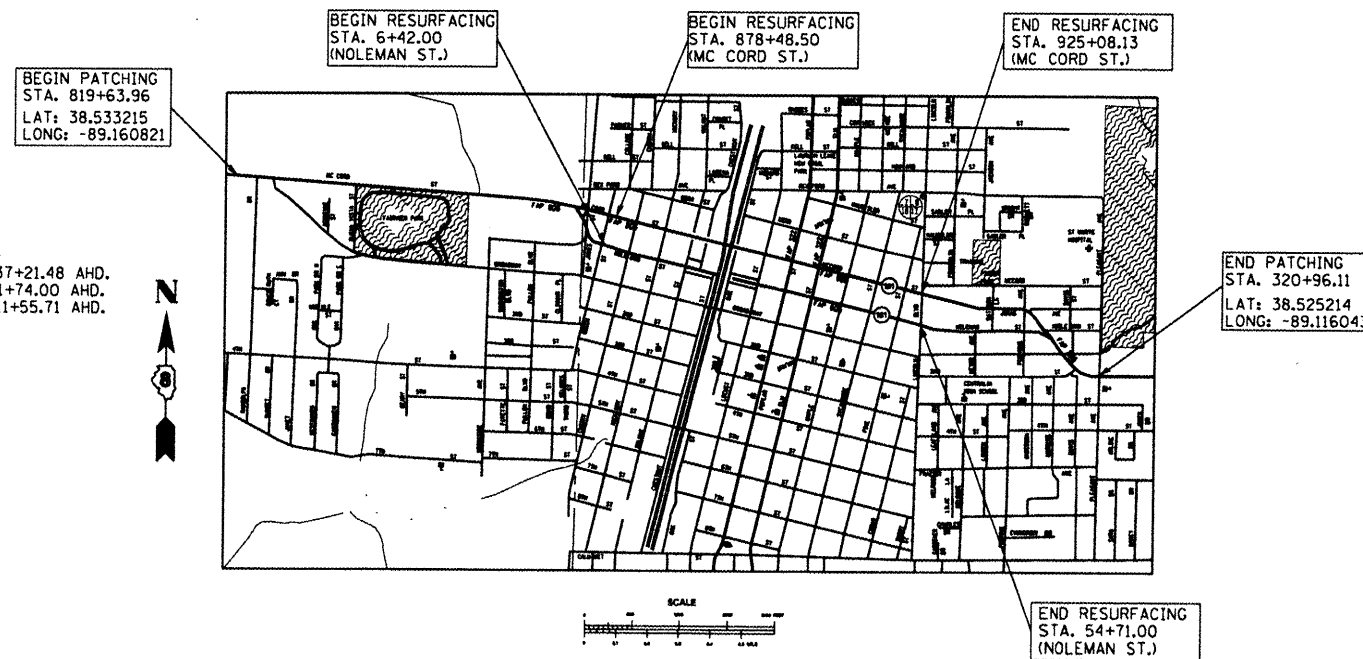

STATION EQUATION
STA. 937+20.78 BK = STA. 937+21.48 AHD.
STA. 54+71.00 BK = STA. 291+74.00 AHD.
STA. 948+03.17 BK = STA. 311+55.71 AHD.

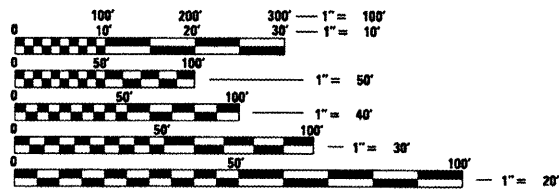

FULL SIZE PLANS HAVE BEEN PREPARED USING STANDARD ENGINEERING SCALES. REDUCED SIZED PLANS WILL NOT CONFORM TO STANDARD SCALES. IN MAKING MEASUREMENTS ON REDUCED PLANS, THE ABOVE SCALES MAY BE USED.

J.U.L.I.E.
JOINT UTILITY LOCATION INFORMATION FOR EXCAVATION
1-800-892-0123
OR 811

GROSS LENGTH = 12,697 FT. = 2.4 MILES
NET LENGTH = 12,967 FT. = 2.4 MILES

PROJECT ENGINEER: PATTI LEBEAU (618) 346-3179
PROJECT MANAGER: CHERYL KEPLAR (618) 346-3186

CONTRACT NO. 76E51

TRAFFIC DATA	2011 ADT	2031 ADT	SU	MU
RANDOLPH DR. TO BEECH ST.	9900	11400	2.0	2.3
BEECH ST. TO LINCOLN BLVD.	9300	11500	5.3	2.4
LINCOLN BLVD. TO PLEASANT AVE.	13100	15100	4.7	2.4

STATE OF ILLINOIS
DEPARTMENT OF TRANSPORTATION
DIVISION OF HIGHWAYS

SUBMITTED Feb 7 20 11
M. Cham
DEPUTY DIRECTOR OF HIGHWAYS, REGION 5 ENGINEER

March 05 20 11
Scott E. Stitt P.E.
ENGINEER OF DESIGN AND ENVIRONMENT

March 05 20 11
Christine M. Reed
DIRECTOR OF HIGHWAYS, CHIEF ENGINEER

PRINTED BY THE AUTHORITY
OF THE STATE OF ILLINOIS

GENERAL NOTES

1. CARE SHALL BE TAKEN AT ALL SIDE STREETS AND ENTRANCES DURING MILLING OPERATIONS TO ENSURE THAT THE PROPOSED RESURFACING WILL MEET THE EXISTING SIDE STREETS AND ENTRANCES.
2. THE WIDTHS OF HOT-MIX ASPHALT SURFACE REMOVAL SHOWN ON THE PLANS ARE THE NOMINAL WIDTHS. IRREGULARITIES IN THE SURFACE WIDTH MAY OCCUR THROUGHOUT THE LENGTH OF THE SECTION. HOT-MIX ASPHALT SURFACE REMOVAL WILL BE PAID FOR IN SQUARE YARDS BASED UPON THE NOMINAL WIDTHS INDICATED.
3. THE THICKNESS OF HOT-MIX ASPHALT SHOWN ON THE PLANS IS THE NOMINAL THICKNESS. DEVIATIONS MAY OCCUR DUE TO IRREGULARITIES IN THE EXISTING SURFACE OR BASE ON WHICH THE HOT-MIX ASPHALT IS PLACED.
4. THE CONTRACTOR AND THE ENGINEER SHALL BE AWARE THAT NO SURVEY WAS PERFORMED FOR THIS PROJECT. THE STATIONING AND TOPO SHOWN IN THE PLANS WAS CREATED USING MICROFILM AND FIELD MEASUREMENTS MADE BY DESIGN PERSONNEL. BOTH SHALL BE ASSUMED TO BE APPROXIMATE. THE CONTRACTOR SHALL VERIFY ALL DIMENSIONS AND CONDITIONS IN THE FIELD PRIOR TO CONSTRUCTION AND ORDERING OF MATERIALS.
5. THE PROPOSED PAVEMENT MARKING SHALL MATCH THE LOCATIONS OF THE EXISTING PAVEMENT MARKING, AS DIRECTED BY THE ENGINEER.
6. ANY EXCAVATION OR DROP-OFF OF MORE THAN 3" AT EDGE OF PAVEMENT SHALL BE PROTECTED WITH EXTENDED LEG BARRICADES AND APPROPRIATE LIGHTING.
7. ILLINOIS STATE LAW REQUIRES A 48-HOUR NOTICE BE GIVEN TO ALL UTILITIES BEFORE DIGGING. FIELD MARKING OF FACILITIES MAY BE OBTAINED BY CONTACTING J.U.L.I.E. OR FOR NON-MEMBERS, THE UTILITY DIRECTLY. AGENCIES KNOWN TO HAVE FACILITIES WITHIN THE PROJECT AREA ARE AS FOLLOWS:

UTILITY	ABOVE GROUND	BELOW GROUND
* AMEREN IP	X	X
* AT&T ILLINOIS	X	X
* CITY OF CENTRALIA		X
* ILLINOIS NETWORK ALLIANCE	X	X
* CHARTER COMMUNICATIONS, INC.	X	X
* COUNTRYMARK COOP. LLP		X
* KENTUCKY DATA LINK, INC.	X	X
* PAETEC	X	X
* US SIGNAL COMPANY, LLC	X	X
* US SONET	X	X

MEMBERS OF J.U.L.I.E. (800) 892-0123 ARE INDICATED BY *. NON-J.U.L.I.E. MEMBERS MUST BE NOTIFIED INDIVIDUALLY.

8. THE RESIDENT ENGINEER SHALL VERIFY THE EXISTENCE OF HIGHWAY LIGHTING AND/OR ITS UTILITIES WITHIN THE PROJECT LIMITS. IF HIGHWAY LIGHTING AND/OR ITS EXISTS WITHIN THE PROJECT LIMITS, AND IF THESE ITEMS REQUIRE LOCATING, THE CONTRACTOR SHALL BE DIRECTED TO DO SO ACCORDING TO SECTION 803 OF THE STANDARD SPECIFICATIONS. IF 'LOCATING UNDERGROUND CABLE' IS NOT INCLUDED AS PART OF THE PLANS, THIS WORK SHALL BE PAID FOR ACCORDING TO ARTICLE 109.04 OF THE STANDARD SPECIFICATIONS.
9. SHORT-TERM PAVEMENT MARKING SHALL BE APPLIED TO THE MILLED SURFACE, BINDER COURSE AND FINAL BITUMINOUS SURFACE. A QUANTITY FOR TEMPORARY PAVEMENT MARKING EQUAL TO THE AMOUNT OF PERMANENT PAVEMENT MARKING HAS BEEN ADDED TO THE PLANS. ONLY REMOVAL OF SHORT TERM PAVEMENT MARKING REMOVAL FROM FINAL SURFACE TO BE PAID AS 'WORK ZONE PAVEMENT MARKING REMOVAL'.
10. THE FOLLOWING MIXTURE REQUIREMENTS ARE APPLICABLE FOR THIS PROJECT:

MIXTURE USE	SURFACE	POLY-LEVEL BINDER	PATCHING
AC/PG	PG 64-22	SBS 76-22	PG 64-22
RAP % (MAX)	SEE SPEC.	SEE SPEC.	SEE SPEC.
DESIGN AIR VOIDS	4.0% @ Ndes=70	4.0% @ Ndes=50	4.0% @ Ndes=70
MIX COMPOSITION			
(GRADATION MIXTURE)	IL 12.5/9.5	IL 4.75	IL 19.0
FRICTION AGG	MIXTURE "D"	MIXTURE "C"	MIXTURE "B"

**TOP LIFT SHOULDERS - DESIGN THIS MIX AT 2.0% VOIDS AND ADD ASPHALT TO REDUCE VOIDS TO 1.5%.

PLAN QUANTITIES FOR BITUMINOUS CONCRETE SURFACE COURSE ITEMS ARE CALCULATED USING A UNIT WEIGHT OF 112 LB/SQ YD/IN (59.8KG/SQ M/25 MM THICKNESS).

11. CARE SHALL BE TAKEN WHEN REMOVING THE EXISTING PAVEMENT FROM STA. 878+48.50 TO STA. 884+15.00 (MC CORD ST.) SO AS NOT TO DISTURB THE EXISTING STORM SEWER.
12. OVER NIGHT LANE CLOSURES WILL BE ALLOWED FROM STA. 878+48.50 TO STA. 884+15.00 (MC CORD ST.) ONLY.
13. RESIDENT ENGINEER SHALL DETERMINE EXACT LOCATIONS WHERE CRACKS ARE TO BE ROUTED AND FILLED.
14. ANY RAISED REFLECTIVE PAVEMENT MARKERS ENCOUNTERED DURNING CRACK AND SEAL OPERATIONS SHALL BE LEFT IN PLACE. ROUTING SHALL BE GAPPED WHERE RAISED REFLECTIVE PAVEMENT MARKERS ARE ENCOUNTERED SO AS TO LEAVE THEM FUNCTIONAL.
15. ALL STRUCTURES ARE OMITTED FROM THE CONTRACT.
16. CARE SHALL BE TAKEN TO AVOID DAMAGING THE EXISTING DETECTOR LOOPS AND TO MINIMIZE COVERING STRIPING WHEN ENCOUNTERED. AREA SHALL BE OMITTED AS DIRECTED BE THE ENGINEER.

INDEX OF SHEETS

- 1 COVER SHEET
- 2 INDEX OF SHEETS, STANDARDS, AND GENERAL NOTES
- 3 SUMMARY OF QUANTITIES
- 4 LOCATION MAP
- 5-9 TYPICAL SECTIONS
- 10-12 SCHEDULES
- 13-19 PLAN SHEETS
- 20 DETECTOR LOOP REPLACEMENT SHEET
- 21 DETAILS

STANDARDS

- 000001-06
- 420001-07
- 420106-04
- 442101-07
- 442201-03
- 606001-04
- 701427
- 701502-04
- 701601-07
- 701602-05
- 701701-07
- 701901-01
- 780001-02
- 886001-01
- 886006-01

COMMITMENTS

NONE

FILE NAME : *FILEL*	USER NAME : *USER*	DESIGNED - ---	DRAWN - ---	REVISIONS - ---	STATE OF ILLINOIS	GENERAL NOTES	F.A.P. RTE.:	SECTION	COUNTY	TOTAL SHEETS	SHEET
	PLOT SCALE : *SCALE*	CHECKED - ---	REVISIONS - ---		DEPARTMENT OF TRANSPORTATION		805	17Z-2,8Z-21RS-1	*	21	2
	PLOT DATE : *DATE*	DATE - ---	REVISIONS - ---			SCALE: _____	SHEET NO. ___ OF ___ SHEETS	STA. _____	TO STA. _____	CONTRACT NO. T6E51	
							FED. ROAD DIST. NO. - ILLINOIS FED. AID PROJECT				
							*CLINTON/MARION				

SUMMARY OF QUANTITIES

SUMMARY OF QUANTITIES			URBAN TOTAL QUANTITIES	0005			SUMMARY OF QUANTITIES			URBAN TOTAL QUANTITIES	0005		
CODE NO	ITEM	UNIT		MARION CO.		CLINTON CO.	CODE NO	ITEM	UNIT		MARION CO.		CLINTON CO.
				80% FED. 20% STATE	50% STATE 50% CITY	80% FED. 20% STATE					80% FED. 20% STATE	50% STATE 50% CITY	80% FED. 20% STATE
31200100	STABILIZED SUBBASE 4"	SO YD	2266	2266		70300280	TEMPORARY PAVEMENT MARKING - LINE 24"	FOOT	278	278			
40600200	BITUMINOUS MATERIALS (PRIME COAT)	TON	18.5	18.3	0.2	70301000	WORK ZONE PAVEMENT MARKING REMOVAL	SO FT	736	736			
40600300	AGGREGATE (PRIME COAT)	TON	89	87	2	* 78000200	THERMOPLASTIC PAVEMENT MARKING - LINE 4"	FOOT	6074	6074			
40600990	TEMPORARY RAMP	SO YD	1604	1604		* 78000600	THERMOPLASTIC PAVEMENT MARKING - LINE 12"	FOOT	1241	1241			
40603340	HOT-MIX ASPHALT SURFACE COURSE, MIX "D", N70	TON	2599	2567	32	* 78000650	THERMOPLASTIC PAVEMENT MARKING - LINE 24"	FOOT	278	278			
42000501	PORTLAND CEMENT CONCRETE PAVEMENT 10" (JOINTED)	SO YD	2266	2266		* 78100100	RAISED REFLECTIVE PAVEMENT MARKER	EACH	205	205			
42001300	PROTECTIVE COAT	SO YD	2266	2266		78300200	RAISED REFLECTIVE PAVEMENT MARKER REMOVAL	EACH	205	205			
44000100	PAVEMENT REMOVAL	SO YD	2266	2266		80300100	LOCATING UNDERGROUND CABLE	FOOT	20	20			
44000157	HOT-MIX ASPHALT SURFACE REMOVAL, 2"	SO YD	3948	3948		88600600	DETECTOR LOOP REPLACEMENT	FOOT	1140	1140			
44000158	HOT-MIX ASPHALT SURFACE REMOVAL, 2 1/4"	SO YD	26127	25934	193	X4060826	POLYMERIZED LEVELING BINDER (MACHINE METHOD), IL-4.75, N50	TON	1079	1063	16		
44200168	PAVEMENT PATCHING, TYPE II, 14 INCH	SO YD	163	163									
44200172	PAVEMENT PATCHING, TYPE III, 14 INCH	SO YD	106	106									
44200174	PAVEMENT PATCHING, TYPE IV, 14 INCH	SO YD	631	631									
44200970	CLASS B PATCHES, TYPE II, 10 INCH	SO YD	229	229									
44200974	CLASS B PATCHES, TYPE III, 10 INCH	SO YD	207	207									
44201299	DOWEL BARS 1 1/2"	EACH	812	812									
44213200	SAW CUTS	FOOT	5527	5527									
44213204	TIE BARS 3/4"	EACH	76	76									
44300200	STRIP REFLECTIVE CRACK CONTROL TREATMENT	FOOT	3476	3476									
45100100	CRACK ROUTING (PAVEMENT)	FOOT	8551	8075	476								
45100200	CRACK FILLING	POUND	2882	2725	157								
67000400	ENGINEER'S FIELD OFFICE, TYPE A	CAL MO	5	5									
67100100	MOBILIZATION	L SUM	1	1									
70102622	TRAFFIC CONTROL AND PROTECTION, STANDARD 701502	L SUM	1	0.5	0.5								
70102630	TRAFFIC CONTROL AND PROTECTION, STANDARD 701601	L SUM	1	1									
70102632	TRAFFIC CONTROL AND PROTECTION, STANDARD 701602	L SUM	1	0.5	0.5								
70102635	TRAFFIC CONTROL AND PROTECTION, STANDARD 701701	L SUM	1	1									
70103815	TRAFFIC CONTROL SURVEILLANCE	CAL DA	5	5									
70300100	SHORT TERM PAVEMENT MARKING	FOOT	2209	2209									
70300220	TEMPORARY PAVEMENT MARKING - LINE 4"	FOOT	6074	6074									
70300260	TEMPORARY PAVEMENT MARKING - LINE 12"	FOOT	1241	1241									

*SPECIALTY
ITEM

FILE NAME =	USER NAME = #USER#	DESIGNED - ---	REVISED - ---	STATE OF ILLINOIS DEPARTMENT OF TRANSPORTATION	SUMMARY OF QUANTITIES	F.A.P. RTE.	SECTION	COUNTY	TOTAL SHEETS	SHEET NO.	
#FILE#		DRAWN - ---	REVISED - ---			805	(72-2, 82-2)RS-1	*	21	3	
	PLOT SCALE = #SCALE#	CHECKED - ---	REVISED - ---			CONTRACT NO. 76E51					
	PLOT DATE = #DATE#	DATE - ---	REVISED - ---			FED. ROAD DIST. NO. - ILLINOIS FED. AID PROJECT					
						SCALE: _____ SHEET NO. ___ OF ___ SHEETS STA. _____ TO STA. _____					
						*CLINTON/MARION					

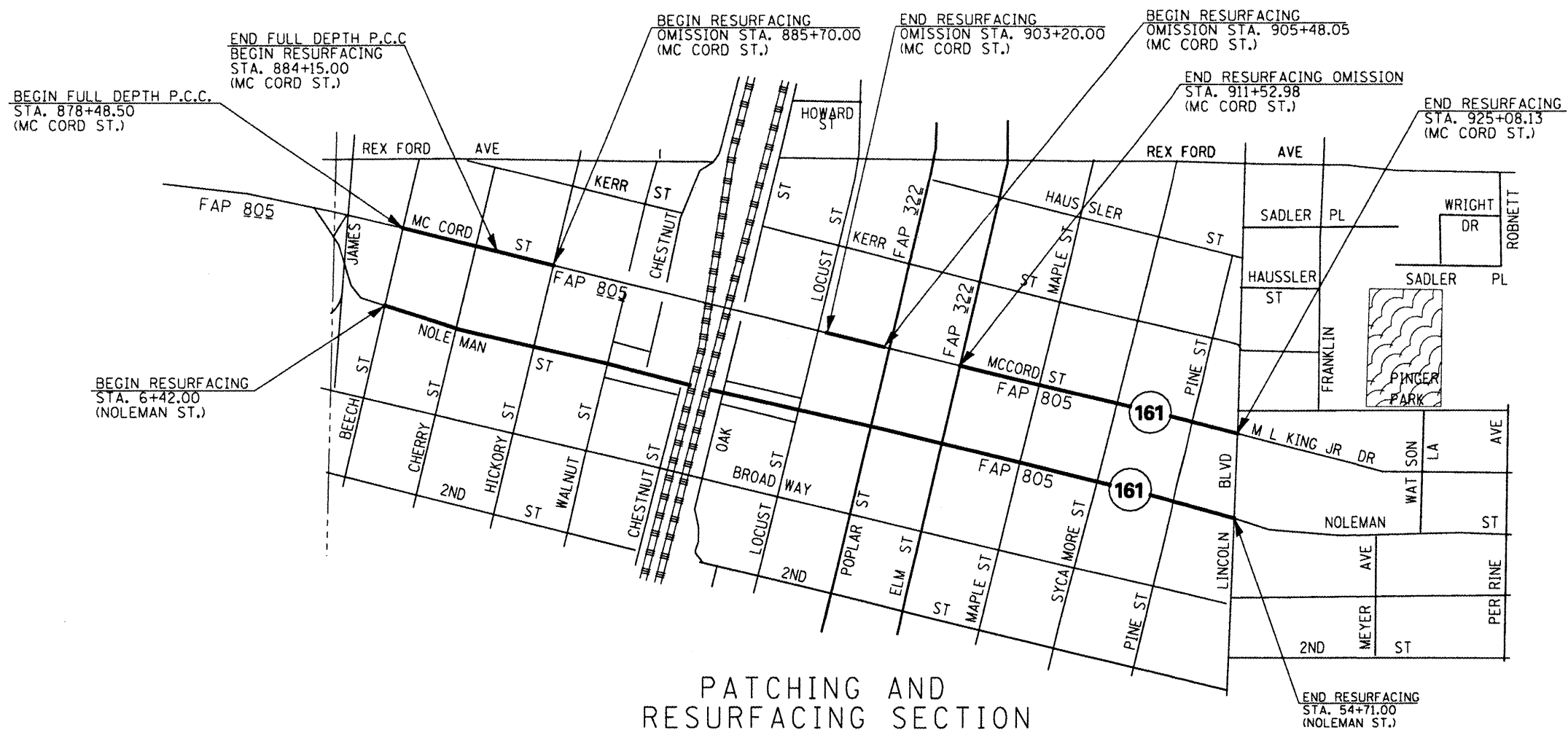

PATCHING AND RESURFACING SECTION

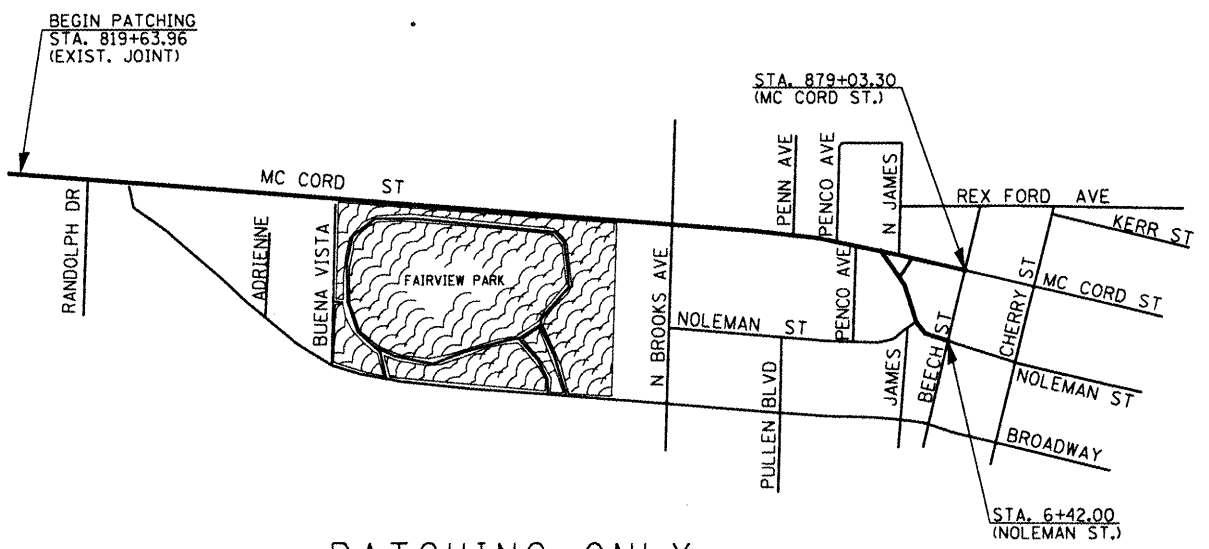

PATCHING ONLY SECTION

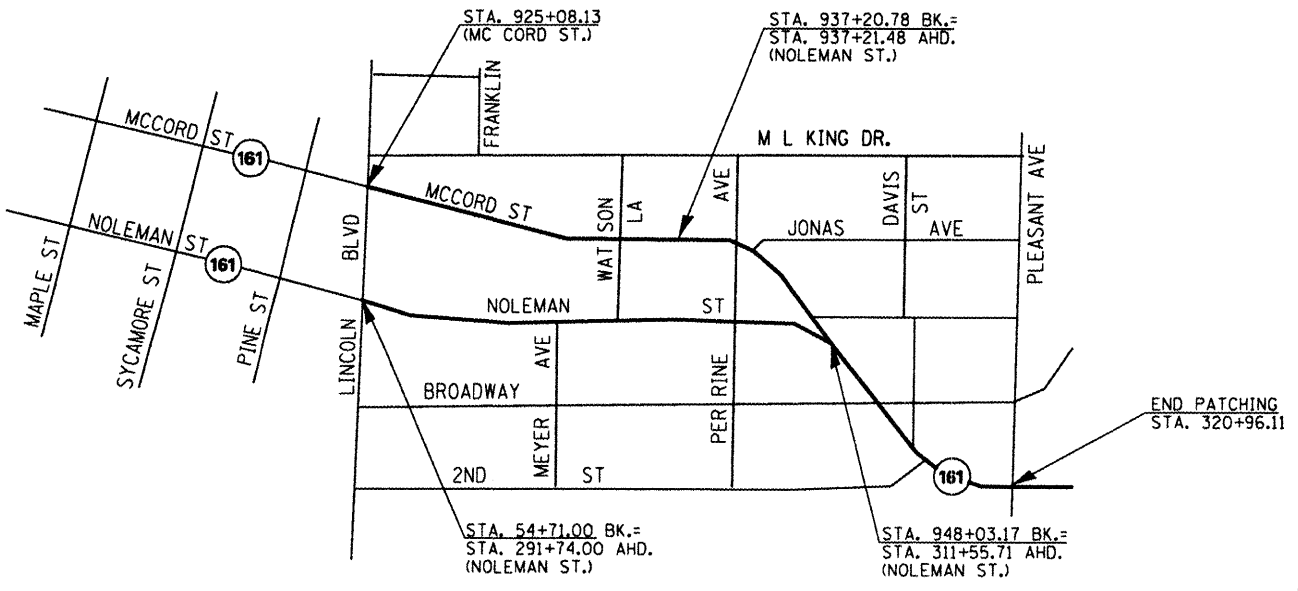

PATCHING ONLY SECTION

FILE NAME * #FILE#	USER NAME * #USER#	DESIGNED -	REVISED -	STATE OF ILLINOIS DEPARTMENT OF TRANSPORTATION	LOCATION MAP	F.A.P. RTE.	SECTION	COUNTY	TOTAL SHEETS	SHEET NO.
	PLOT SCALE = #SCALE#	DRAWN -	REVISED -			805	(7Z-2, 8Z-2)RS-1	*	21	4
	PLOT DATE = #DATE#	CHECKED -	REVISED -			CONTRACT NO. 76E51				
SCALE: _____ SHEET NO. _____ OF _____ SHEETS STA. _____ TO STA. _____						FED. ROAD DIST. NO. _____ ILLINOIS FED. AID PROJECT *CLINTON/MARION				

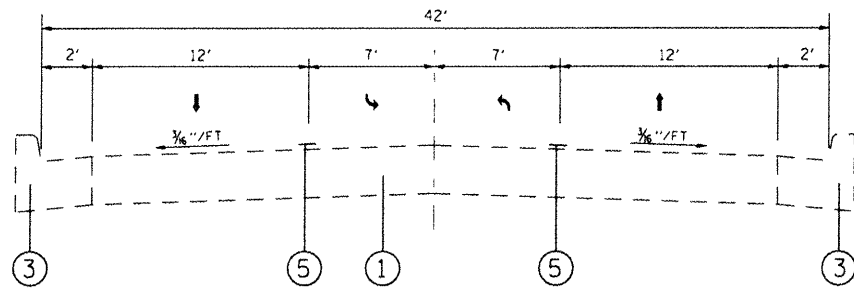

EXISTING
TYPICAL SECTION
(IL 161)

STA. 819+63.96 TO STA. 822+87
STA. 827+10 TO STA. 854+73

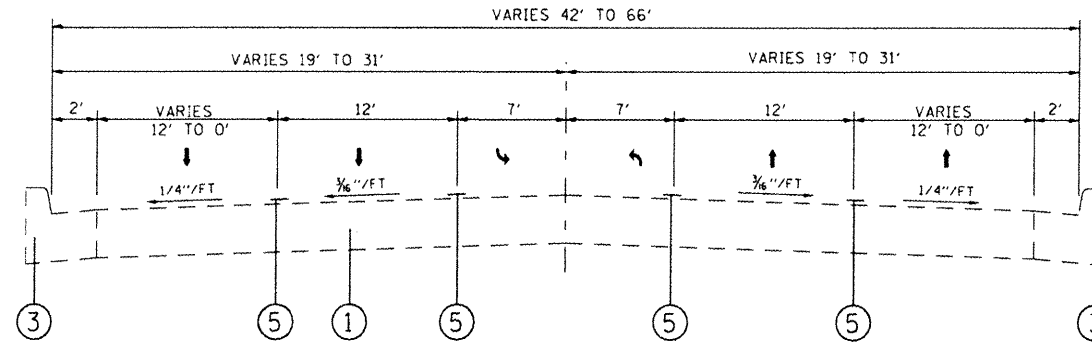

EXISTING
TYPICAL SECTION
(IL 161)

STA. 854+73 TO STA. 869+50

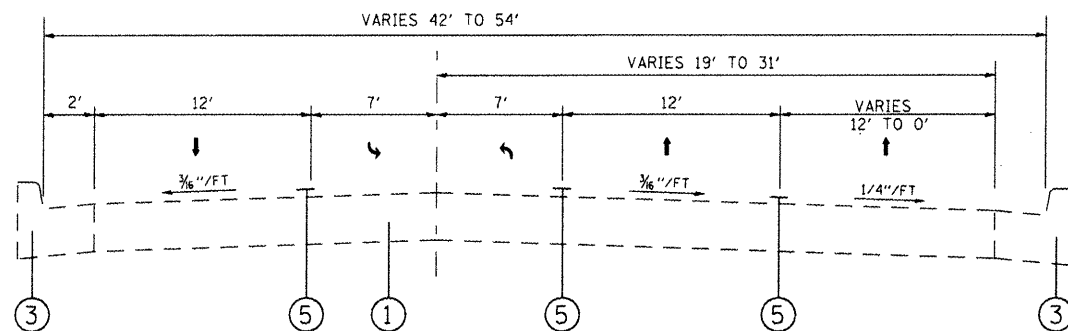

EXISTING
TYPICAL SECTION
(IL 161)

STA. 822+87 TO STA. 827+10

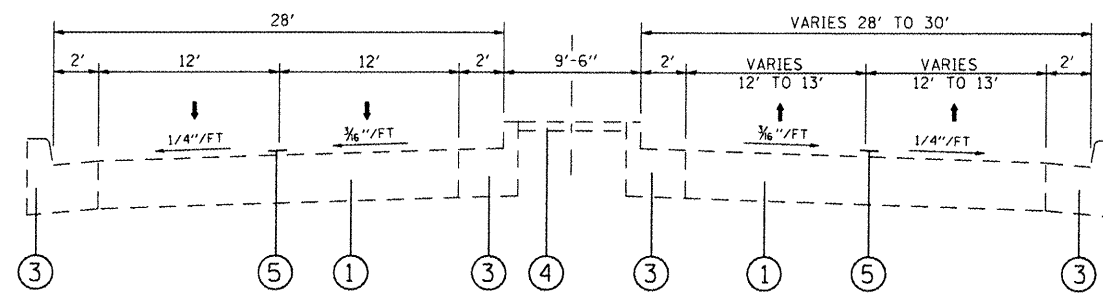

EXISTING
TYPICAL SECTION
(IL 161)

STA. 869+50 TO STA. 874+60

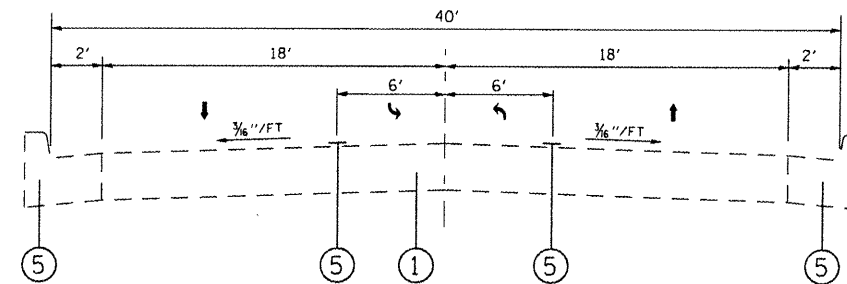

EXISTING
TYPICAL SECTION
(McCord Street)

STA. 874+60.00 TO STA. 878+48.50
STA. 885+70.00 TO STA. 903+20.00
STA. 905+48.05 TO STA. 911+52.98

LEGEND

- ① EXISTING PCC PAVEMENT 10"
- ② EXISTING PCC WIDENING, 10"
- ③ EXISTING CONC. CURB & GUTTER
- ④ EXISTING MEDIAN SURFACE, 4"
- ⑤ EXISTING PAVEMENT MARKING

FILE NAME *	USER NAME * #USER*	DESIGNED -	REVISED -
#FILE#		DRAWN -	REVISED -
	PLOT SCALE = #SCALE*	CHECKED -	REVISED -
	PLOT DATE = #DATE*	DATE -	REVISED -

STATE OF ILLINOIS
DEPARTMENT OF TRANSPORTATION

EXISTING TYPICAL SECTIONS
(PATCHING SECTION)

SCALE: _____ SHEET NO. ___ OF ___ SHEETS STA. _____ TO STA. _____

F.A.P. RTE.	SECTION	COUNTY	TOTAL SHEETS	SHEET NO.
805	(7Z-2, 82-2)RS-1	*	21	5
FED. ROAD DIST. NO. - ILLINOIS FED. AID PROJECT			CONTRACT NO. 76E51	
*CLINTON/MARION				

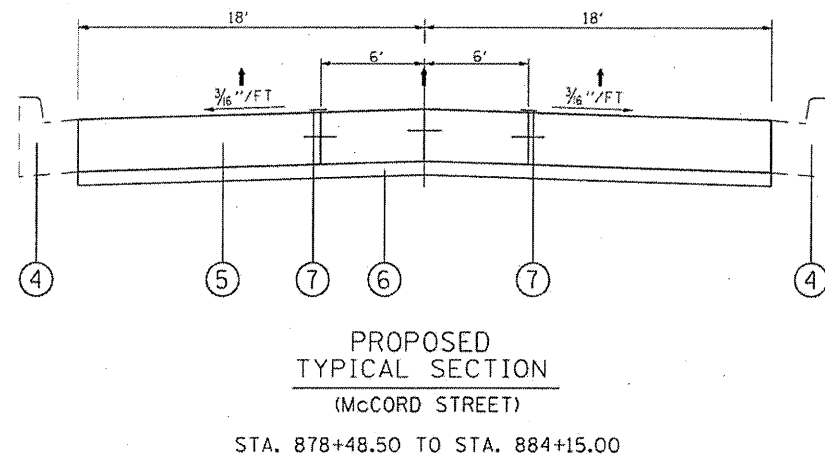
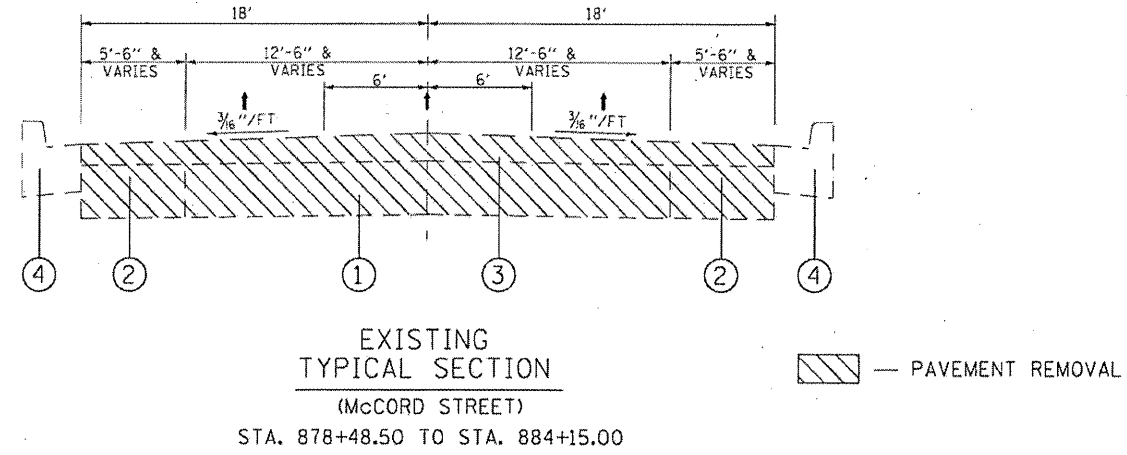

LEGEND

- ① EXISTING PAVEMENT
- ② EXISTING PCC WIDENING, 8"
- ③ EXISTING HMA RESURFACING, 4"
- ④ EXISTING CONC. CURB & GUTTER
- ⑤ PROPOSED PORTLAND CEMENT CONCRETE PAVEMENT, 10" (JOINTED)
- ⑥ PROPOSED STABILIZED SUBBASE, 4"
- ⑦ PROPOSED PAVEMENT MARKING

NOTE: THE P.C.C. PAVEMENT, 10" (JOINTED) SHALL BE PLACED ACCORDING TO STANDARD 420106 EXCEPT THE PAVEMENT SHALL BE CROWNED AS SHOWN ON TYPICAL IN ORDER TO MATCH EXISTING CONDITIONS. THE EXTRA TIE BARS FOR THE MIDDLE JOINT SHALL BE INCLUDED IN THE P.C.C. PAVEMENT PAY ITEM.

FILE NAME *	USER NAME * #USER*	DESIGNED - ---	REVISED - ---	STATE OF ILLINOIS DEPARTMENT OF TRANSPORTATION	EXISTING TYPICAL SECTIONS (PATCHING SECTION)	F.A.P. RTE.	SECTION	COUNTY	TOTAL SHEETS	SHEET NO.
#FILE#		DRAWN - ---	REVISED - ---			805	(72-2, 82-2)RS-1	*	21	6
		CHECKED - ---	REVISED - ---			SCALE: _____ SHEET NO. ___ OF ___ SHEETS STA. _____ TO STA. _____		CONTRACT NO. 76E51		
		DATE - -----	REVISED - ---			FED. ROAD DIST. NO. _____ ILLINOIS FED. AID PROJECT *CLINTON/MARION				

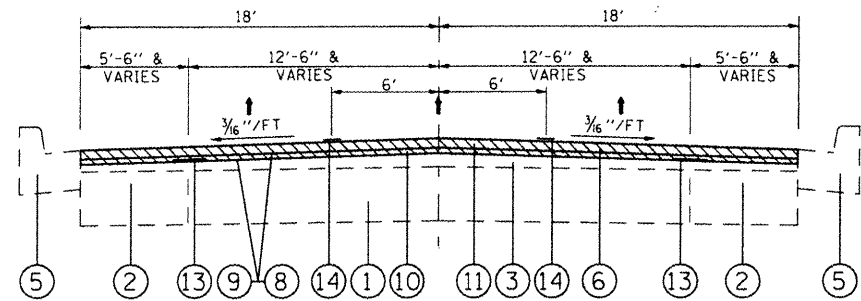

PROPOSED
TYPICAL SECTION
(McCORD STREET)
STA. 884+15.00 TO STA. 885+70.00

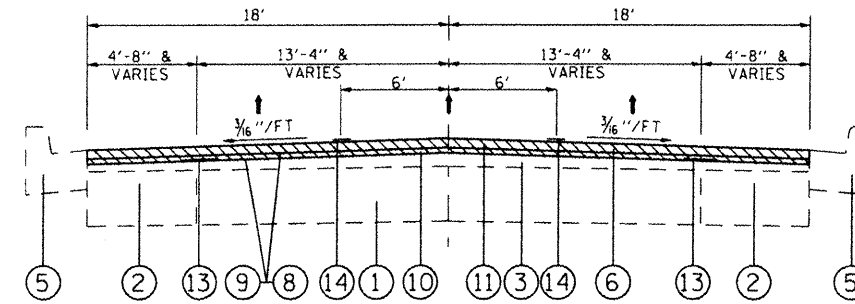

PROPOSED
TYPICAL SECTION
(McCORD STREET)
STA. 903+20.00 TO STA. 905+48.05

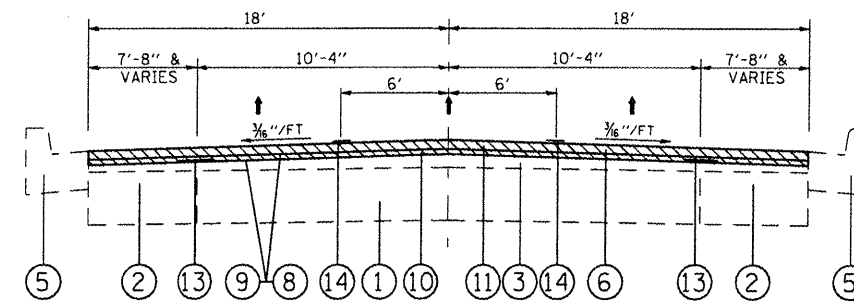

PROPOSED
TYPICAL SECTION
(McCORD STREET)
STA. 911+52.98 TO STA. 925+08.13

LEGEND

- ① EXISTING PAVEMENT
- ② EXISTING PCC WIDENING, 8"
- ③ EXISTING HMA RESURFACING, 4"
- ④ EXISTING HMA RESURFACING, 2"
- ⑤ EXISTING CONC. CURB & GUTTER
- ⑥ PROPOSED HMA SURFACE REMOVAL, 2 1/4"
- ⑦ PROPOSED HMA SURFACE REMOVAL, 2"
- ⑧ PROPOSED BITUMINOUS MATERIALS (PRIME COAT)
- ⑨ PROPOSED AGGREGATE (PRIME COAT)
- ⑩ PROPOSED LEVELING BINDER IL 4.75, 3/4 "
- ⑪ PROPOSED SURFACE COURSE, 1 1/2"
- ⑫ PROPOSED SURFACE COURSE, 2"
- ⑬ PROPOSED STRIP REFLECTIVE CRACK CONTROL
- ⑭ PROPOSED PAVEMENT MARKING

NOTE:
THE INTENT OF THE MILLING IS TO REMOVE
HMA SURFACE MATERIAL ONLY. THE UNDERLYING
CONCRETE PAVEMENT SHALL NOT BE DISTURBED.

FILE NAME : *FILEL*	USER NAME : *USER*	DESIGNED - DRAWN -	REVISED - REVISED -	STATE OF ILLINOIS DEPARTMENT OF TRANSPORTATION	TYPICAL SECTIONS (RESURFACING SECTION)		F.A.P. RTE. 805	SECTION (7Z-2, 8Z-2)RS-1	COUNTY -	TOTAL SHEETS 21	SHEET NO. 7	
	PLOT SCALE : *SCALE*	CHECKED - DATE -	REVISED - REVISED -		SCALE: _____	SHEET NO. ___ OF ___ SHEETS	STA. _____ TO STA. _____	CONTRACT NO. 76E51				
	PLOT DATE : *DATE*	DATE -	REVISED -		FED. ROAD DIST. NO. - ILLINOIS FED. AID PROJECT *CLINTON/MARION							

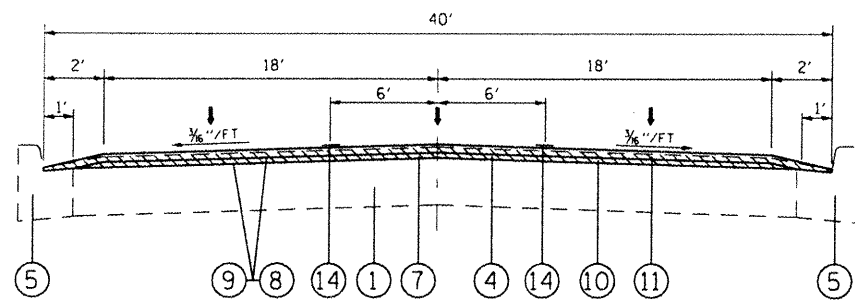

PROPOSED
TYPICAL SECTION
(NOLEMAN STREET)
STA. 6+42.00 TO STA. 19+15.80
STA. 39+80.38 TO STA. 54+71.00

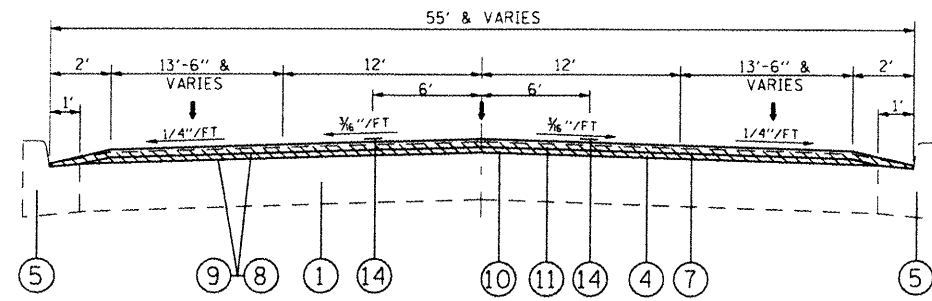

PROPOSED
TYPICAL SECTION
(NOLEMAN STREET)
STA. 29+31.00 TO STA. 39+80.38

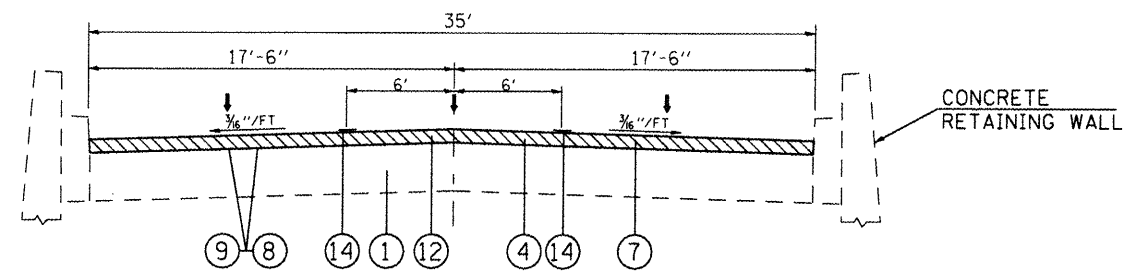

PROPOSED
TYPICAL SECTION
(NOLEMAN STREET)
STA. 19+15.80 TO STA. 29+31.00

LEGEND

- ① EXISTING PAVEMENT
- ② EXISTING PCC WIDENING, 8"
- ③ EXISTING HMA RESURFACING, 4"
- ④ EXISTING HMA RESURFACING, 2"
- ⑤ EXISTING CONC. CURB & GUTTER
- ⑥ PROPOSED HMA SURFACE REMOVAL, 2 1/4"
- ⑦ PROPOSED HMA SURFACE REMOVAL, 2"
- ⑧ PROPOSED BITUMINOUS MATERIALS (PRIME COAT)
- ⑨ PROPOSED AGGREGATE (PRIME COAT)
- ⑩ PROPOSED LEVELING BINDER IL 4.75, 3/4 "
- ⑪ PROPOSED SURFACE COURSE, 1 1/2"
- ⑫ PROPOSED SURFACE COURSE, 2"
- ⑬ PROPOSED STRIP REFLECTIVE CRACK CONTROL
- ⑭ PROPOSED PAVEMENT MARKING

NOTE:
THE INTENT OF THE MILLING IS TO REMOVE
HMA SURFACE MATERIAL ONLY. THE UNDERLYING
CONCRETE PAVEMENT SHALL NOT BE DISTURBED.

FILE NAME : #FILE#	USER NAME : #USER#	DESIGNED -	REVISED -	STATE OF ILLINOIS DEPARTMENT OF TRANSPORTATION	TYPICAL SECTIONS (RESURFACING SECTION)		F.A.P. RTE.	SECTION	COUNTY	TOTAL SHEETS	SHEET NO.	
	PLOT SCALE : #SCALE#	DRAWN -	REVISED -		SCALE: _____	SHEET NO. _____ OF _____ SHEETS	STA. _____ TO STA. _____	805	(7Z-2, 8Z-2)RS-1	*	21	8
	PLOT DATE : #DATE#	CHECKED -	REVISED -					CONTRACT NO. 76E51				
							FED. ROAD DIST. NO. - ILLINOIS FED. AID PROJECT					
							*CLINTON/MARION					

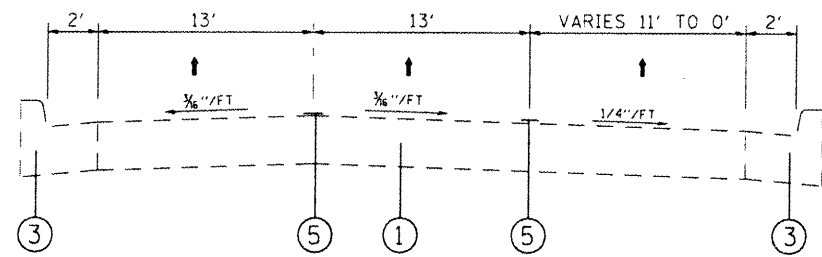

EXISTING
TYPICAL SECTION
(McCORD STREET)
STA. 925+08.13 TO STA. 928+45.00

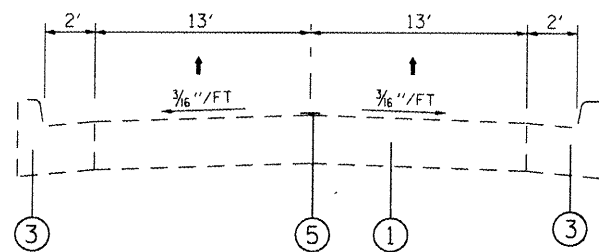

EXISTING
TYPICAL SECTION
(McCORD STREET)
STA. 928+45.00 TO STA. 312+25.19
(SEE STATION EQUATION)

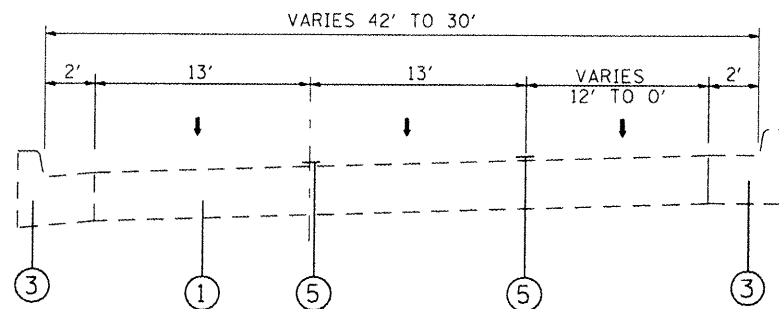

EXISTING
TYPICAL SECTION
(NOLEMAN STREET)
STA. 291+74.00 TO STA. 298+17.16

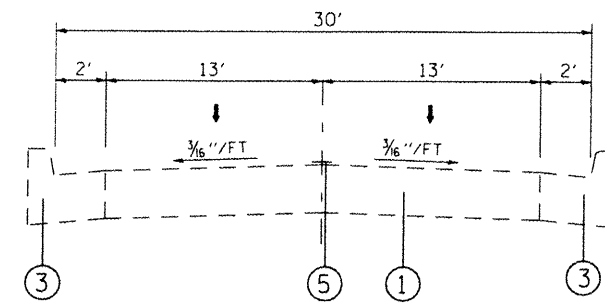

EXISTING
TYPICAL SECTION
(NOLEMAN STREET)
STA. 298+17.16 TO STA. 307+98.00

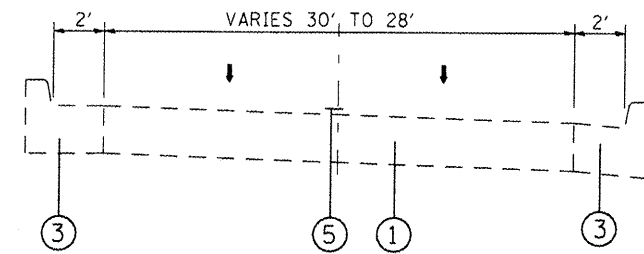

EXISTING
TYPICAL SECTION
(NOLEMAN STREET)
STA. 307+98.00 TO STA. 312+25.19

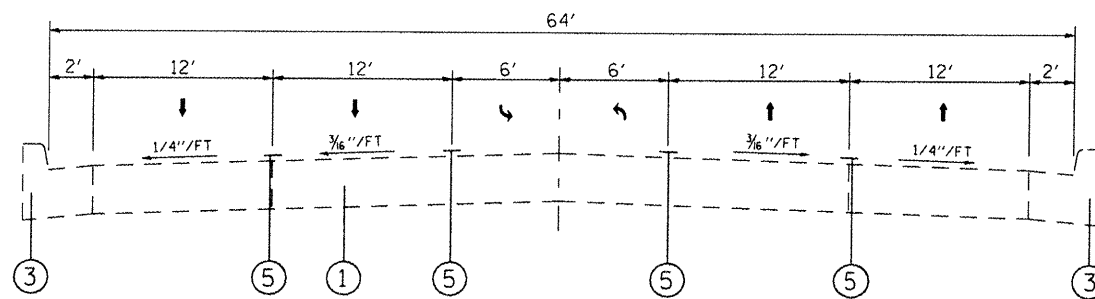

EXISTING
TYPICAL SECTION
(IL 161)
STA. 312+25.19 TO STA. 320+96.11

LEGEND

- ① EXISTING PCC PAVEMENT 10"
- ② EXISTING PCC WIDENING, 10"
- ③ EXISTING CONC. CURB & GUTTER
- ④ EXISTING MEDIAN SURFACE, 4"
- ⑤ EXISTING PAVEMENT MARKING

STATION EQUATION

STA. 937+20.78 BK = STA. 937+21.48 AHD.
STA. 54+71.00 BK = STA. 291+74.00 AHD.
STA. 948+03.17 BK = STA. 311+55.71 AHD.

FILE NAME :	USER NAME : *USER*	DESIGNED - ---	REVISED - ---
*FILE#		DRAWN - ---	REVISED - ---
	PLOT SCALE = *SCALE*	CHECKED - ---	REVISED - ---
	PLOT DATE = *DATE*	DATE - ---	REVISED - ---

STATE OF ILLINOIS
DEPARTMENT OF TRANSPORTATION

EXISTING TYPICAL SECTIONS
(PATCHING SECTION)

SCALE: _____ SHEET NO. ___ OF ___ SHEETS STA. _____ TO STA. _____

F.A.P. RTE.	SECTION	COUNTY	TOTAL SHEETS	SHEET NO.
805	(72-2, BZ-21RS-1	*	21	9
FED. ROAD DIST. NO. - ILLINOIS FED. AID PROJECT			CONTRACT NO. 76E51	
*CLINTON/MARION				

MAINLINE RESURFACING SCHEDULE							
LOCATION		BIT. MAT'L PRIME COAT (TON)	AGGREGATE PRIME COAT (TON)	LEVELING BINDER IL 4.75 (TON)	HMA SURFACE COURSE (TON)	STRIP REFLECTIVE CRACK CONTROL (FT)	COMMENTS
STA.	to STA.						
MC CORD ST.							
884+15.00	to 885+70.00	0.38	1.86	26.04	52.08	310	
903+20.00	to 905+48.05	0.58	2.74	38.31	76.62	456	
911+52.98	to 925+08.13	3.4	16.26	227.64	455.28	2710	
NOLEMAN ST.							
6+42.00	to 19+15.80	3.54	16.98	237.81	475.63		
19+15.80	to 29+31.00	2.48	11.84	0.00	442.09		
29+31.00	to 30+15.52	0.24	1.18	16.46	32.92		
30+15.52	to 30+87.71	0.22	1.10	15.29	30.58		
30+87.71	to 31+66.80	0.26	1.26	17.73	35.47		
31+66.80	to 34+44.00	0.94	4.54	63.57	127.14		
34+44.00	to 37+97.46	1.34	6.48	90.60	181.21		
37+97.46	to 39+80.38	0.6	2.90	40.56	81.13		
39+80.38	to 54+71.00	4.14	19.88	278.32	556.64		
LINCOLN BLVD.							
94+33.80	to 96+06.74	0.38	1.84	25.70	51.41		
TOTAL =		18.5	89	1079	2599	3476	

SURFACE REMOVAL SCHEDULE			
LOCATION		HMA SURF. REMOVAL, 2 1/4" (SQ YD)	HMA SURF. REMOVAL, 2" (SQ YD)
STA.	to STA.		
McCord St.			
884+15.00	to 885+70.00	620	
903+20.00	to 905+48.05	912.2	
911+52.98	to 925+08.13	5420.6	
Noleman St.			
6+42.00	to 19+15.80	5662.22	
19+15.80	to 29+31.00		3947.22
29+31.00	to 30+15.52	391.94	
30+15.52	to 30+87.71	364	
30+87.71	to 31+66.80	422.22	
31+66.80	to 34+44.00	1513.56	
34+44.00	to 37+97.46	2615.56	
37+97.46	to 39+80.38	965.83	
39+80.38	to 54+71.00	6626.67	
Lincoln Blvd.			
94+33.80	to 96+06.74	612	
TOTALS		26127	3948

LOCATION			LENGTH FOOT	THERMOPLASTIC PAVEMENT MARKING			RAISED REFLECTIVE PAVEMENT MARKING EACH	RAISED REFLECTIVE PAVEMENT MARKING REMOVAL EACH	COMMENTS
STATION	TO	STATION		4" SKIP-DASH WHITE LANE LINE FOOT	12" CROSSWALKS FOOT	24" STOP BARS FOOT			
MC CORD ST.									
879+03	to	885+70	667	500			17	17	
903+20	to	905+48	228	171			6	6	
911+53	to	925+08	1355	1016			34	34	
NOLEMAN ST.									
6+42.00	to	19+15.80	1250	938	222	38	31	31	
19+15.80	to	29+31.00	1092	819			27	27	
29+31.00	to	30+15.52	102	77	162	35	3	3	
30+15.52	to	30+87.71	135	101			3	3	
30+87.71	to	31+66.80	150	113			4	4	
31+66.80	to	34+44.00	278	209	106	53	7	7	
34+44.00	to	38+71.45	515	386	106	53	13	13	
38+71.45	to	39+80.38	107	80	124		3	3	
39+80.38	to	54+71.00	1482	1112	248	54	37	37	
LINCOLN BLVD.									
94+33.80	to	96+06.74			160	20	2	2	
SUB-TOTALS				5522	1128	253	186	186	
ADD 10% FOR PATCHING AREAS				552.15	112.8	25.3	18.605	18.605	
GRAND TOTALS				6074	1241	278	205	205	

P.C.C. PAVEMENT CONCRETE SCHEDULE						
LOCATION		PAVEMENT REMOVAL (SQ YD)	STABILIZED SUBBASE 4" (SQ YD)	P.C.C. PAVEMENT 10" (SQ YD)	PROTECTIVE COAT (SQ YD)	TIE BARS 3/4" (EACH)
STA.	to STA.					
MC CORD ST.						
878+48.50	to 884+15.00	2266	2266	2266	2266	76
TOTAL		2266	2266	2266	2266	76 *

*TIE BARS TO BE USED TO TIE P.C.C. PAVEMENT TO EXISTING CURB & GUTTER (SEE STANDARD 606001)

FILE NAME =	USER NAME = #USER#	DESIGNED - ---	REVISED - ---	STATE OF ILLINOIS DEPARTMENT OF TRANSPORTATION	SCHEDULES	F.A.P. RTE. 805	SECTION (7Z-2, 8Z-2/RS-1)	COUNTY *	TOTAL SHEETS 21	SHEET NO. 10		
#FILE#		DRAWN - ---	REVISED - ---			SCALE: _____	SHEET NO. ___ OF ___ SHEETS	STA. _____ TO STA. _____	FED. ROAD DIST. NO. - ILLINOIS FED. AID PROJECT			
	PLOT SCALE = #SCALE#	CHECKED - ---	REVISED - ---			CONTRACT NO. 76E51						
	PLOT DATE = #DATE#	DATE - -----	REVISED - ---			*CLINTON/MARION						

TEMPORARY RAMP SCHEDULE				
LOCATION	WIDTH	LENGTH	TEMPORARY RAMP	COMMENTS
STATION	FOOT	FOOT	SQ YD	
MC CORD ST.				
884+15.00	36	7.5	30	
885+70.00	36	7.5	30	
911+52.98	36	7.5	30	
925+08.13	36	7.5	30	
SIDEROADS				
884+43	30	7.5	50	ALLEY
912+52	30	7.5	50	ALLEY
914+73	75	7.5	125	MAPLE
916+89	30	7.5	50	ALLEY
919+02.87	50	7.5	83	SYCAMORE
NOLEMAN ST.				
6+42.00	38	6.7	57	
54+71.00	38	6.7	57	
SIDEROADS				
7+96.77	25	6.7	37	ALLEY
10+10.77	50	6.7	74	CHERRY
12+26.77	25	6.7	37	ALLEY
14+42.79	40	6.7	60	HICKORY
16+56.11	35	6.7	52	ALLEY
18+78.79	40	6.7	60	WALNUT
29+73.09	50	6.7	74	LOCUST
31+87.47	30	6.7	45	ALLEY
36+02.97	70	6.7	104	POPLAR
36+09.47	25	6.7	37	ALLEY
38+34.46	70	6.7	104	ELM
40+57.47	20	6.7	30	ALLEY
42+65.46	60	6.7	89	MAPLE
44+65.46	25	6.7	37	ALLEY
46+95.47	50	6.7	74	SYCAMORE
49+08.46	25	6.7	37	ALLEY
51+25.43	40	6.7	60	PINE ST.
TOTAL =			1604	

PAVEMENT CRACK ROUTING AND FILLING SCHEDULE							
LOCATION			LENGTH	WIDTH	CRACK ROUTING (PAVEMENT)	CRACK FILLING	COMMENTS
STA.	TO	STA.	FOOT	FOOT	FOOT	POUND	
819+64	TO	822+87	323	40	215	71	IL 161
822+87	TO	827+10	423	42	296	98	IL 161
827+10	TO	854+73	2763	40	1842	608	IL 161
854+73	TO	869+50	1477	42	1034	341	IL 161
869+50	TO	874+60	510	56	476	157	IL 161
874+60	TO	878+49	389	40	259	86	MC CORD ST.
885+70	TO	903+20	1750	40	1167	385	MC CORD ST.
905+48	TO	911+53	605	40	403	133	MC CORD ST.
925+08	TO	928+45	337	26	146	48	MC CORD ST.
928+45	TO	312+25	2028	26	879	290	MC CORD ST.
291+74	TO	298+17	643	26	279	92	NOLEMAN ST.
298+17	TO	307+98	981	26	425	140	NOLEMAN ST.
307+98	TO	312+25	427	28	199	66	NOLEMAN ST.
312+25	TO	320+97	872	64	930	307	IL 161
TOTALS					8551	2822	

ESTIMATED APPLICATION RATES: 0.33 LB/FT

FILE NAME :	USER NAME : #USER#	DESIGNED - ---	REVISED - ---	STATE OF ILLINOIS DEPARTMENT OF TRANSPORTATION	PATCHING SCHEDULE	F.A.P. RTE.	SECTION	COUNTY	TOTAL SHEETS	SHEET NO.	
#FILE#		DRAWN - ---	REVISED - ---			805	(72-2, 82-2)RS-1	*	21	11	
	PLOT SCALE : #SCALE#	CHECKED - ---	REVISED - ---			CONTRACT NO. 76E51					
	PLOT DATE : #DATE#	DATE - -----	REVISED - ---			FED. ROAD DIST. NO. ILLINOIS FED. AID PROJECT *CLINTON/MARION					

LOCATION	LANE	LENGTH	WIDTH	PAVEMENT PATCHING 14"			CLASS B PATCHES, 10"			DOWELL BARS	SAWCUTS
				TYPE 2	TYPE 3	TYPE 4	TYPE 2	TYPE 3	TYPE 4		
MILE POINT	LT/MD/RT	(FEET)	(FEET)	(SQ YDS)	(SQ YDS)	(SQ YDS)	(SQ YDS)	(SQ YDS)	(SQ YDS)	EACH	FEET
NOLEMAN											
1.159											
1.159	LT	200	6			133					
1.199	RT	20	4	9							
1.298	LT	20	6	13							
1.331	RT	15	12		20						
1.375	RT	100	12			133					
1.390	LT	6	8	5							
1.403	RT	30	6		20						
1.434	LT	12	12		16						
1.444	RT	15	6	10							
1.474	RT	10	6	7							
1.567	LT	4	12	5							
1.571	RT	75	6			50					
1.580	LT	50	6			33					
1.587	RT	15	6	10							
1.594	RT	40	6			27					
1.702	LT	40	6			27					
1.713	LT	10	20		22						
1.713	MD	10	12	13							
1.713	RT	10	20		22						
1.747	LT	4	12	5							
1.747	RT	15	12		20						
1.800	MD	10	6	7							
2.061	LT	6	12	8							
2.076	RT	40	12			53					
2.087											
2.145	LT	6	12				8			20	48
2.145	MD	6	12				8			20	48
2.145	RT	6	12				8			20	48
2.192	RT	14	12					19		20	64
2.253	LT	6	12				8			20	48
2.253	RT	6	12				8			20	48
SUB-TOTAL					92	120	456	40	19	120	304

LOCATION	LANE	LENGTH	WIDTH	PAVEMENT PATCHING 14"			CLASS B PATCHES, 10"			DOWELL BARS	SAWCUTS
				TYPE 2	TYPE 3	TYPE 4	TYPE 2	TYPE 3	TYPE 4		
MILE POINT	LT/RT/TL	(FEET)	(FEET)	(SQ YDS)	(SQ YDS)	(SQ YDS)	(SQ YDS)	(SQ YDS)	(SQ YDS)	EACH	FEET
IL 161 E.B.											
2.65	LT	12	12					16		20	60
2.651	LT	10	12					13		20	56
2.651	RT	6	12				8			20	48
2.651	TL	6	12				8			20	48
2.657	LT	6	12				8			20	48
IL 161 W.B.											
2.504	LT	6	12				8			20	48
2.654	LT	6	12				8			20	48
2.659	RT	6	12				8			20	48
2.659	LT	6	12				8			20	48
2.659	TL	6	12				8			20	48
SUB-TOTAL							64	29		200	500

LOCATION	LANE	LENGTH	WIDTH	PAVEMENT PATCHING 14"			CLASS B PATCHES, 10"			DOWELL BARS	SAWCUTS
				TYPE 2	TYPE 3	TYPE 4	TYPE 2	TYPE 3	TYPE 4		
MILE POINT	LT/MD/RT	(FEET)	(FEET)	(SQ YDS)	(SQ YDS)	(SQ YDS)	(SQ YDS)	(SQ YDS)	(SQ YDS)	EACH	FEET
MC CORD											
1.598	LT	6	12					8		20	48
1.598	MD	6	12					8		20	48
1.598	RT	6	12					8		20	48
1.607	LT	6	12					8		20	48
1.607	MD	6	12					8		20	48
1.607	RT	6	12					8		20	48
1.609	LT	6	12	8							
1.609	MD	6	12	8							
1.609	RT	6	12	8							
1.620	LT	6	12	8							
1.620	MD	6	12	8							
1.620	RT	6	12	8							
1.649	LT	4	12	5							
1.649	MD	4	12	5							
1.649	RT	4	12	5							
1.750	RT	15	12					20		20	66
1.750	RT	6	20					13		36	72
1.763	RT	10	6					7		10	38
1.764	LT	10	12					13		20	56
1.764	MD	10	12					13		20	56
1.764	RT	10	12					13		20	56
1.788	RT	12	12			16					
1.870	RT	30	12				40				
1.890	RT	40	12				53				
1.991	LT	15	12					20		20	66
1.991	MD	15	12					20		20	66
1.991	RT	15	12					20		20	66
2.018	RT	6	12					8		20	48
2.030	RT	6	12					8		20	48
2.030	MD	6	12					8		20	48
2.030	LT	6	12					8		20	48
SUB-TOTAL					63	16	93	87	132	386	1022

LOCATION	LANE	LENGTH	WIDTH	PAVEMENT PATCHING 14"			CLASS B PATCHES, 10"			DOWELL BARS	SAWCUTS
				TYPE 2	TYPE 3	TYPE 4	TYPE 2	TYPE 3	TYPE 4		
MILE POINT	LT/MD/RT	(FEET)	(FEET)	(SQ YDS)	(SQ YDS)	(SQ YDS)	(SQ YDS)	(SQ YDS)	(SQ YDS)	EACH	FEET
SUB-TOTALS											
NOLEMAN				79	76	456	40	19		120	2496
MC CORD				63	16	93	87	132		386	1714
IL 161							72	29		200	596
TOTALS				142	92	549	199	180		706	4806
15% FOR ANTICIPATED FAILURES				21	14	82	30	27		106	721
GRAND TOTALS				163	106	631	229	207		812	5527

FILE NAME #	USER NAME # USER**	DESIGNED - ---	REVISED - ---
#FILE#		DRAWN - ---	REVISED - ---
	PLOT SCALE # SCALE*	CHECKED - ---	REVISED - ---
	PLOT DATE # DATE*	DATE - ---	REVISED - ---

**STATE OF ILLINOIS
DEPARTMENT OF TRANSPORTATION**

PATCHING SCHEDULE

SCALE: _____ SHEET NO. ____ OF ____ SHEETS STA. _____ TO STA. _____

F.A.P. RTE.	SECTION	COUNTY	TOTAL SHEETS	SHEET NO.
805	(72-2, 82-2)RS-1	*	21	12
CONTRACT NO. 76E51				
FED. ROAD DIST. NO. [ILLINOIS] FED. AID PROJECT *CLINTON/MARION				

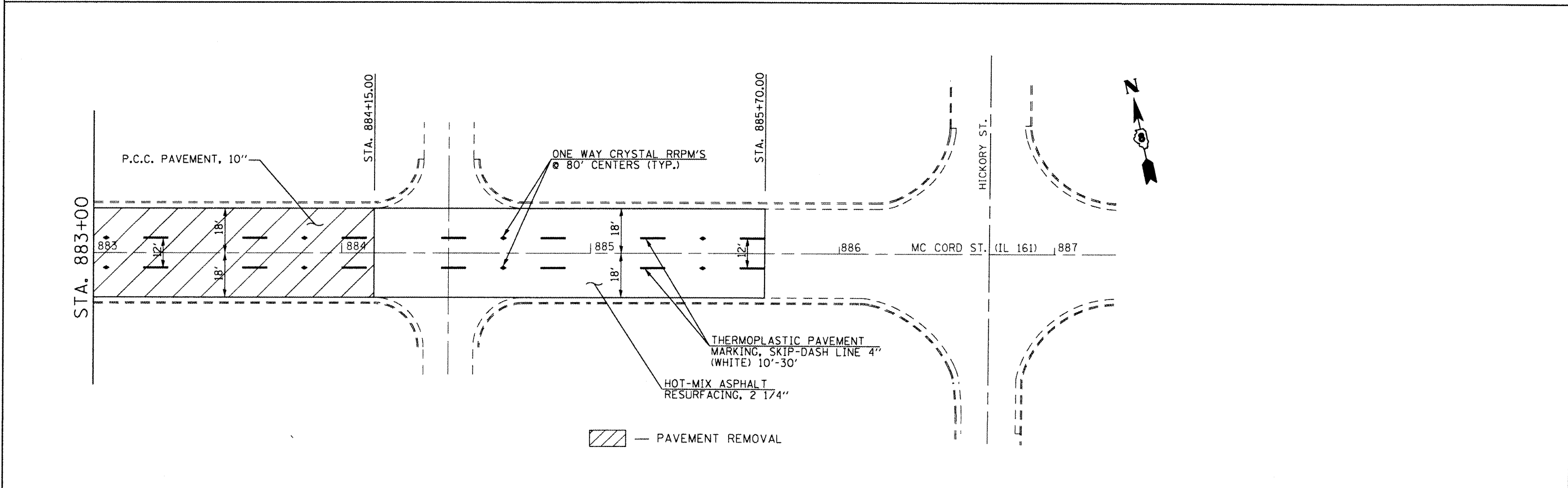
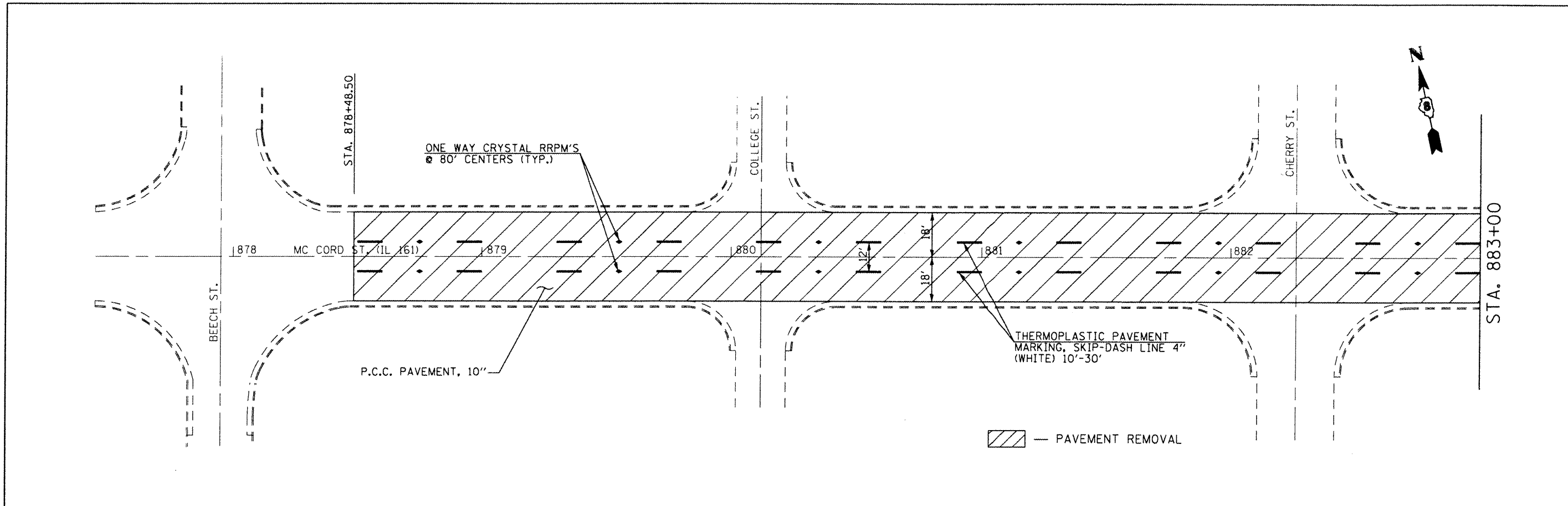

FILE NAME : #FILE#	USER NAME : #USER#	DESIGNED -	REVISED -	STATE OF ILLINOIS DEPARTMENT OF TRANSPORTATION	PLAN VIEW & PAVEMENT MARKING SHEETS (MC CORD ST.)		F.A.P. RTE.	SECTION	COUNTY	TOTAL SHEETS	SHEET NO.
	PLOT SCALE : #SCALE#	CHECKED -	REVISED -		805	172-2,82-21RS-1		21	13		
	PLOT DATE : #DATE#	DATE -	REVISED -		SCALE: _____ SHEET NO. ___ OF ___ SHEETS STA. _____ TO STA. _____		CONTRACT NO. 76E51		ILLINOIS FED. AID PROJECT		

*CLINTON/MARION

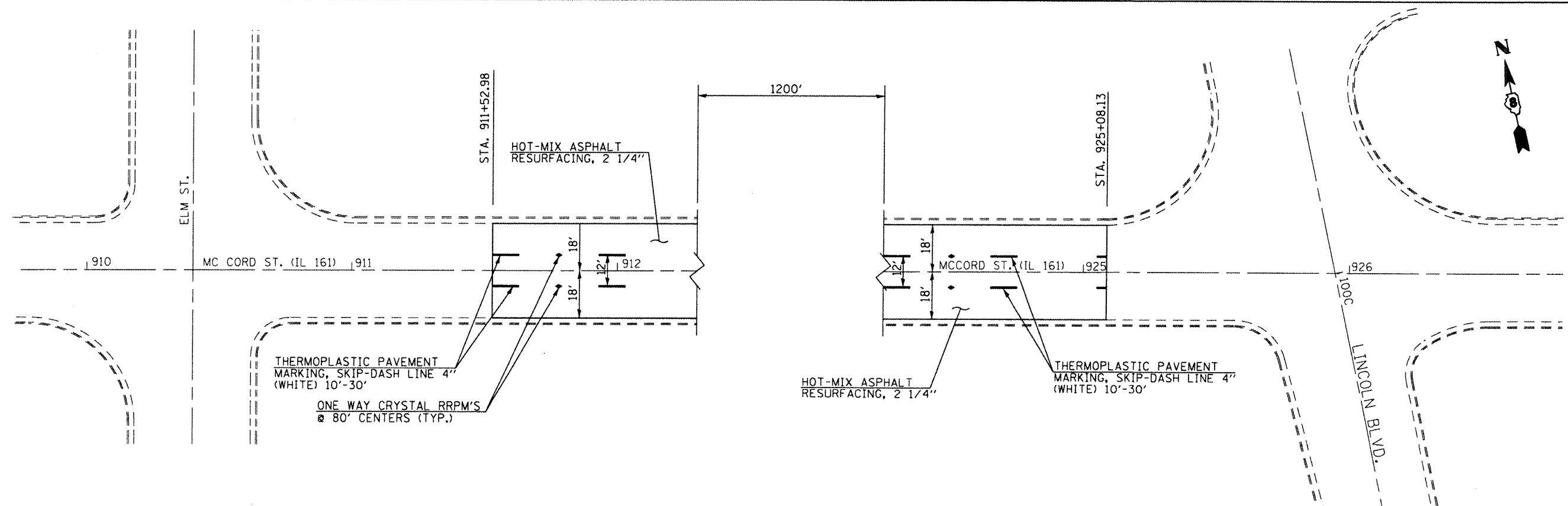
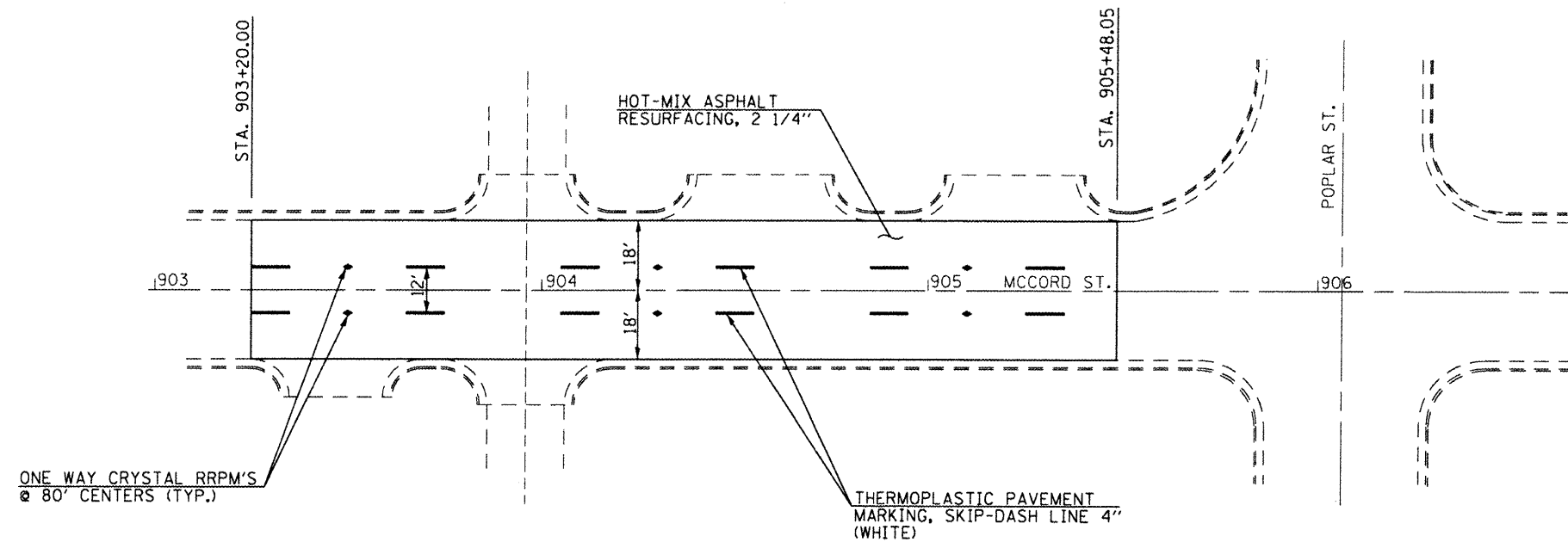

FILE NAME :	USER NAME : #USER#	DESIGNED -	REVISED -
#FILE#		DRAWN -	REVISED -
	PLOT SCALE = #SCALE#	CHECKED -	REVISED -
	PLOT DATE = #DATE#	DATE -	REVISED -

**STATE OF ILLINOIS
DEPARTMENT OF TRANSPORTATION**

**PLAN VIEW & PAVEMENT
MARKING SHEETS
(MC CORD ST.)**

SCALE: _____ SHEET NO. _____ OF _____ SHEETS STA. _____ TO STA. _____

F.A.P. RTE.	SECTION	COUNTY	TOTAL SHEETS	SHEET NO.
805	(72-2,82-2)RS-1		21	14
CONTRACT NO. 76E51			ILLINOIS FED. AID PROJECT	

*CLINTON/MARION

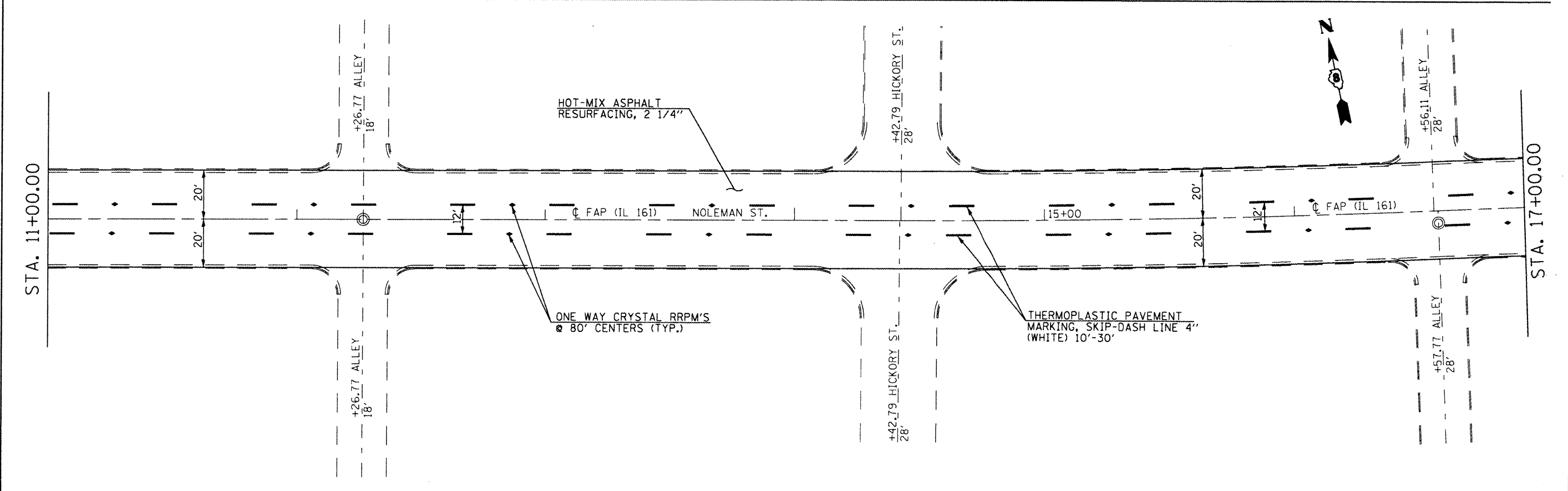
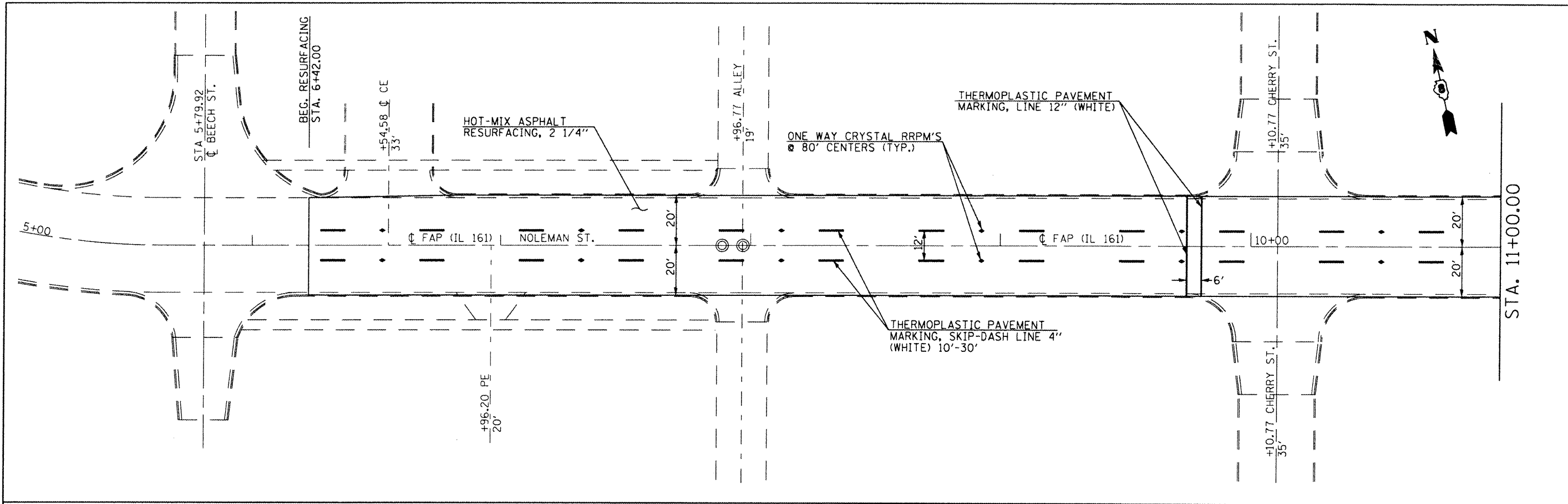

FILE NAME : #FILE#	USER NAME : #USER#	DESIGNED -	REVISED -
		DRAWN -	REVISED -
		CHECKED -	REVISED -
		DATE -	REVISED -

**STATE OF ILLINOIS
DEPARTMENT OF TRANSPORTATION**

**PLAN VIEW & PAVEMENT
MARKING SHEETS
(NOLEMAN ST.)**

SCALE: _____ SHEET NO. ____ OF ____ SHEETS STA. _____ TO STA. _____

F.A.P. RTE.	SECTION	COUNTY	TOTAL SHEETS	SHEET NO.
805	(72-2,82-2)RS-1	*	21	15
CONTRACT NO. 76E51				
ILLINOIS FED. AID PROJECT				

*CLINTON/MARION

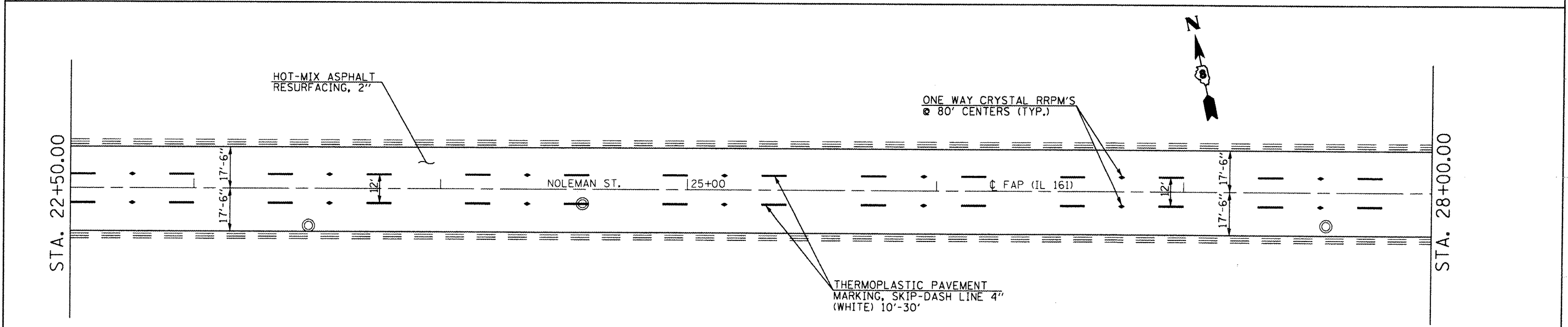
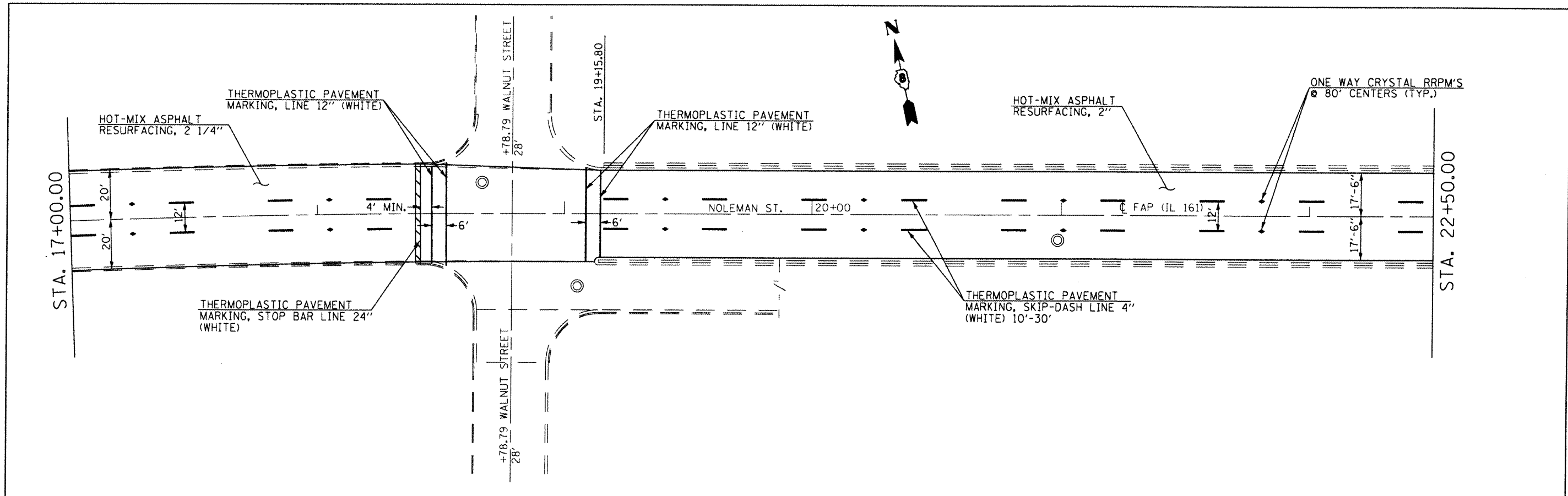

NOTE: MAINTAIN MINIMUM 14' VERTICAL CLEARANCE THRU UNDERPASS AREA

FILE NAME	USER NAME	DESIGNED	REVISED
#FILE#	#USER#	---	---
		DRAWN	REVISED
		---	---
		CHECKED	REVISED
		---	---
		DATE	REVISED
		---	---

**STATE OF ILLINOIS
DEPARTMENT OF TRANSPORTATION**

**PLAN VIEW & PAVEMENT
MARKING SHEETS
(NOLEMAN ST.)**

SCALE: _____ SHEET NO. ____ OF ____ SHEETS STA. _____ TO STA. _____

F.A.P. RTE.	SECTION	COUNTY	TOTAL SHEETS	SHEET NO.
805	(7Z-2,8Z-2)RS-1	*	21	16
CONTRACT NO. 76E51			ILLINOIS FED. AID PROJECT	

*CLINTON/MARION

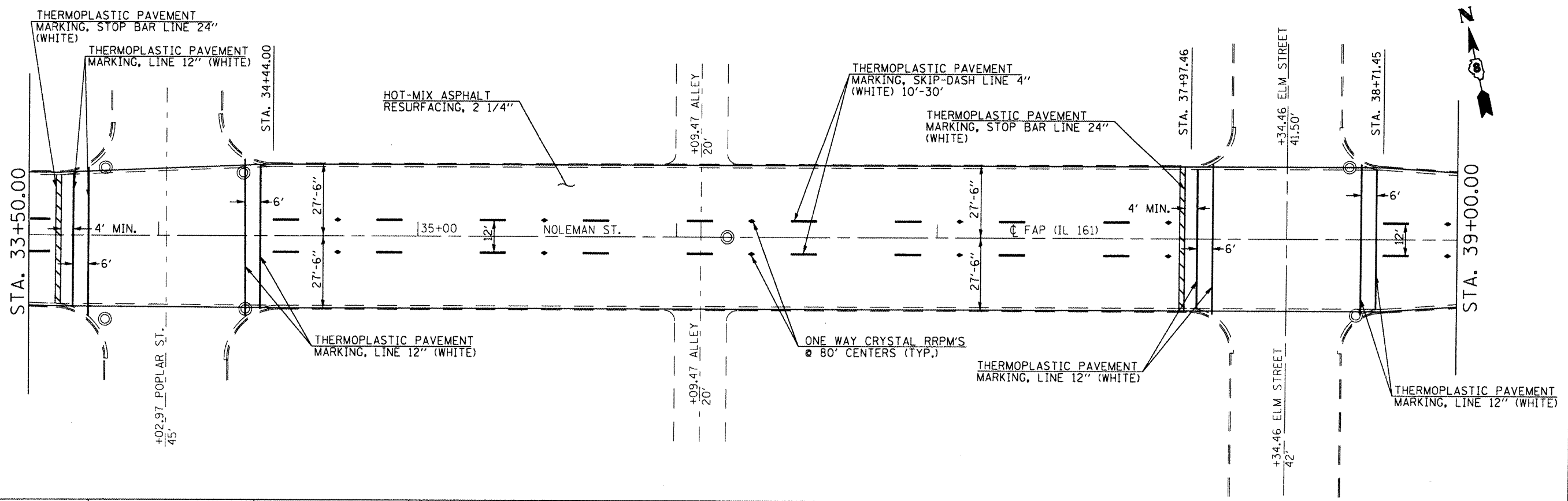
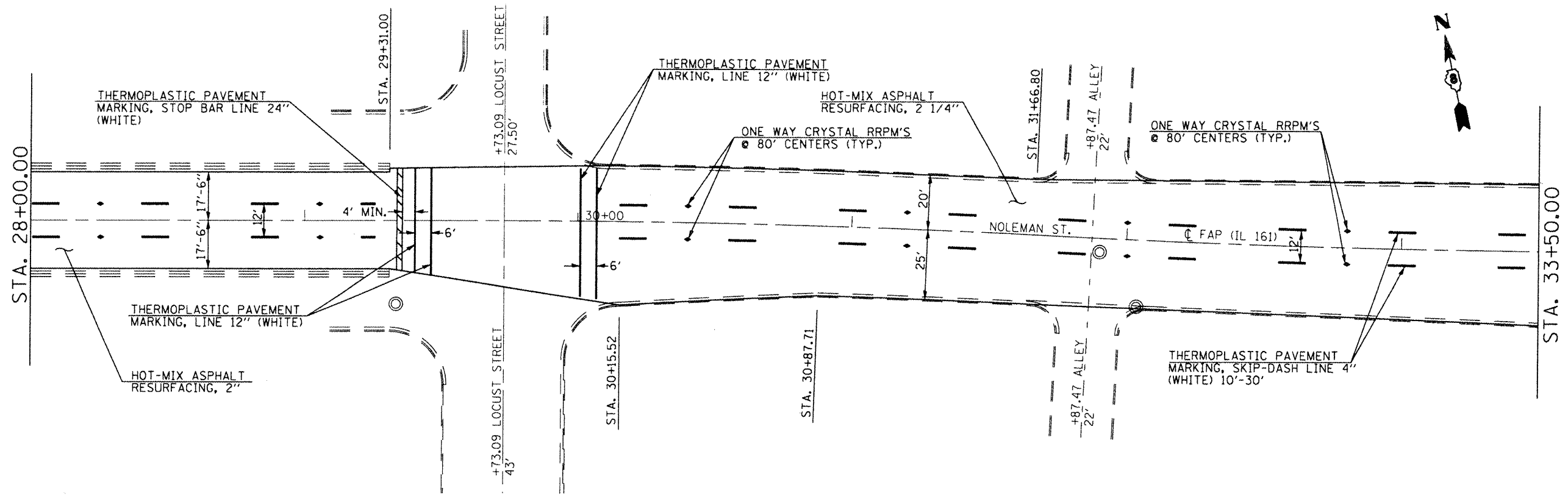

FILE NAME :
 *FILE#

USER NAME : *USER#
 PLOT SCALE : *SCALE#
 PLOT DATE : *DATE#

DESIGNED -	REVISD -
DRAWN -	REVISD -
CHECKED -	REVISD -
DATE -	REVISD -

**STATE OF ILLINOIS
 DEPARTMENT OF TRANSPORTATION**

**PLAN VIEW & PAVEMENT
 MARKING SHEETS
 (NOLEMAN ST.)**

SCALE: _____ SHEET NO. _____ OF _____ SHEETS STA. _____ TO STA. _____

F.A.P. RTE.	SECTION	COUNTY	TOTAL SHEETS	SHEET NO.
805	172-2,82-21RS-1	*	21	17
CONTRACT NO. 76E51			ILLINOIS FED. AID PROJECT	

*CLINTON/MARION

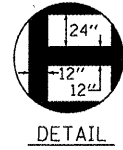
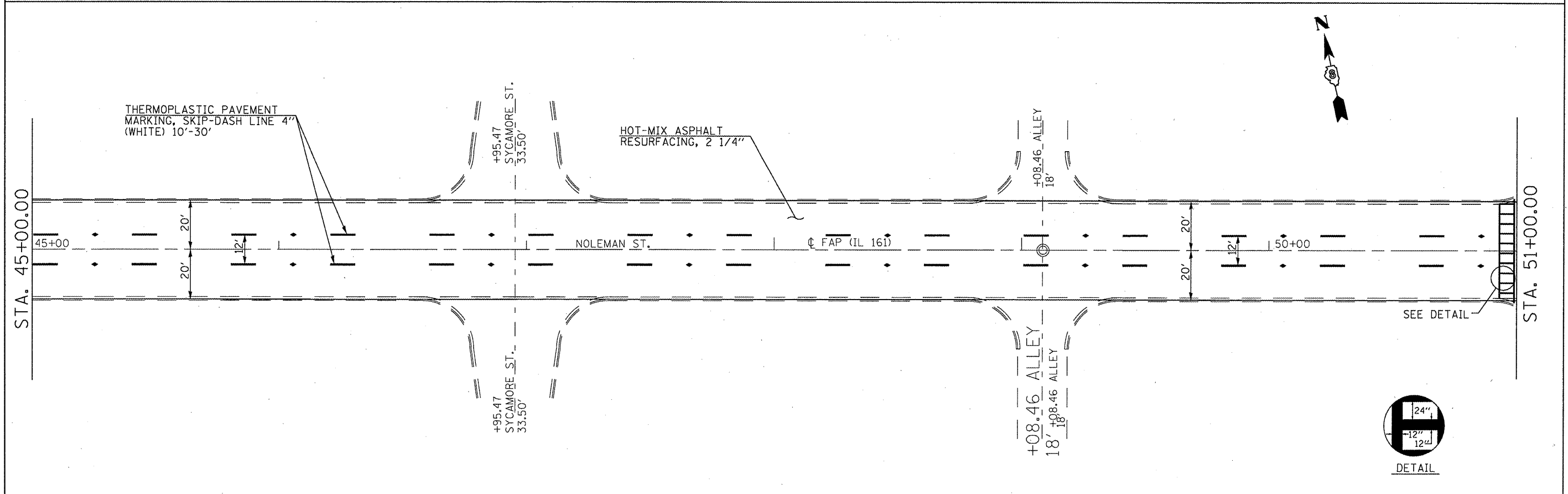
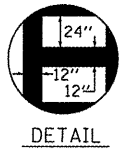
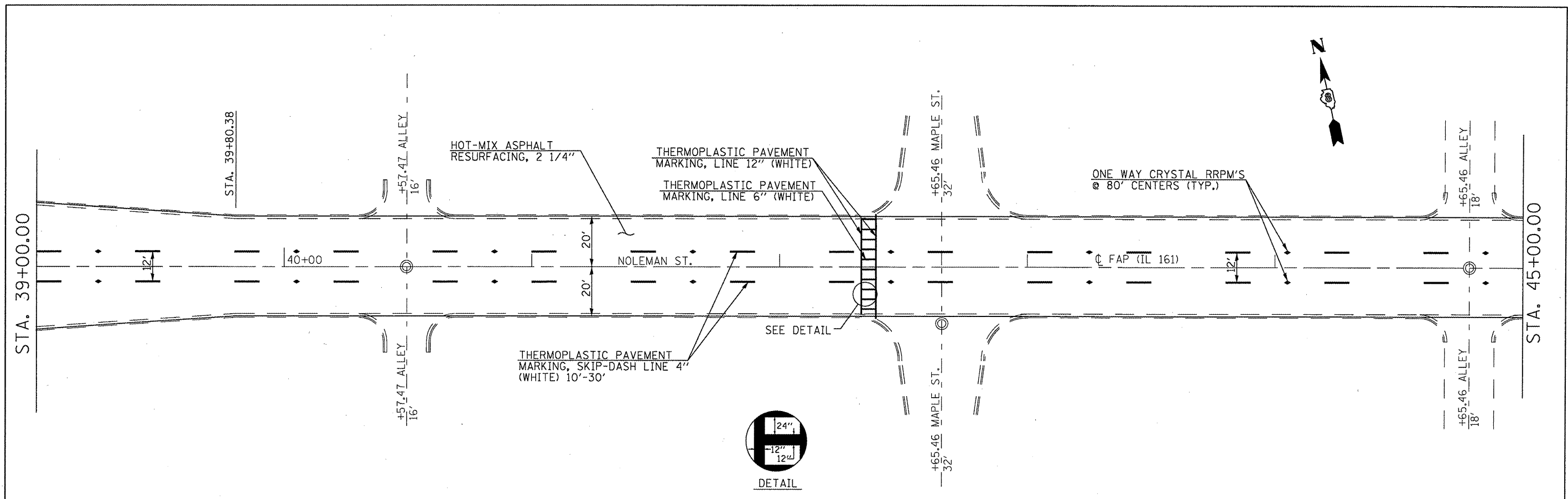

FILE NAME = #FILE#	USER NAME = #USER#	DESIGNED - ---	REVISED - ---	STATE OF ILLINOIS DEPARTMENT OF TRANSPORTATION	PLAN VIEW & PAVEMENT MARKING SHEETS (NOLEMAN ST.)		F.A.P. RTE.	SECTION	COUNTY	TOTAL SHEETS	SHEET NO.
	PLOT SCALE = #SCALE#	CHECKED - ---	REVISED - ---		805	(72-2,8Z-2)RS-1		21	18		
	PLOT DATE = #DATE#	DATE - ---	REVISED - ---		SCALE: _____	SHEET NO. _____ OF _____ SHEETS	STA. _____ TO STA. _____	CONTRACT NO. 76E51		ILLINOIS FED. AID PROJECT	

*CLINTON/MARION

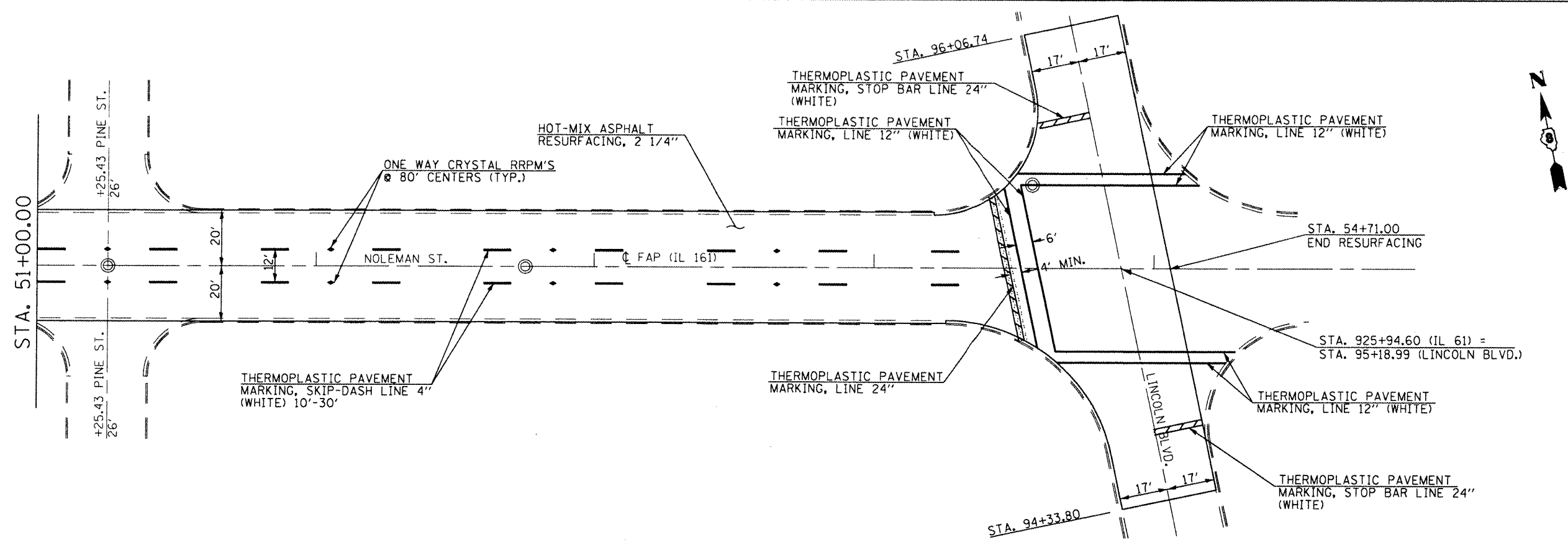

FILE NAME : #FILEL#	USER NAME : #USER#	DESIGNED -	REVISED -
		DRAWN -	REVISED -
	PLOT SCALE : #SCALE#	CHECKED -	REVISED -
	PLOT DATE : #DATE#	DATE -	REVISED -

**STATE OF ILLINOIS
DEPARTMENT OF TRANSPORTATION**

PLAN VIEW & PAVEMENT MARKING SHEETS (NOLEMAN ST.)	
SCALE: _____	SHEET NO. _____ OF _____ SHEETS STA. _____ TO STA. _____

F.A.P. RTE.	SECTION	COUNTY	TOTAL SHEETS	SHEET NO.
805	(172-2,82-2)RS-1	*	21	19
CONTRACT NO. 76E51			ILLINOIS FED. AID PROJECT	

*CLINTON/MARION

NOTES:

SEE TABLE "DETECTOR LOOP REQUIREMENTS AND CALCULATIONS" FOR LOOP SIZE AND CALCULATED NUMBER OF TURNS.

SEE "DETAIL A" FOR INSTALLING DETECTOR LOOP WIRES IN EXISTING CONDUITS.

SCHEDULE OF QUANTITIES			TOTAL QUANTITIES
CODE NO	ITEM	UNIT	
80300100	LOCATING UNDERGROUND CABLE	FOOT	20
88600600	DETECTOR LOOP REPLACEMENT	FOOT	1140

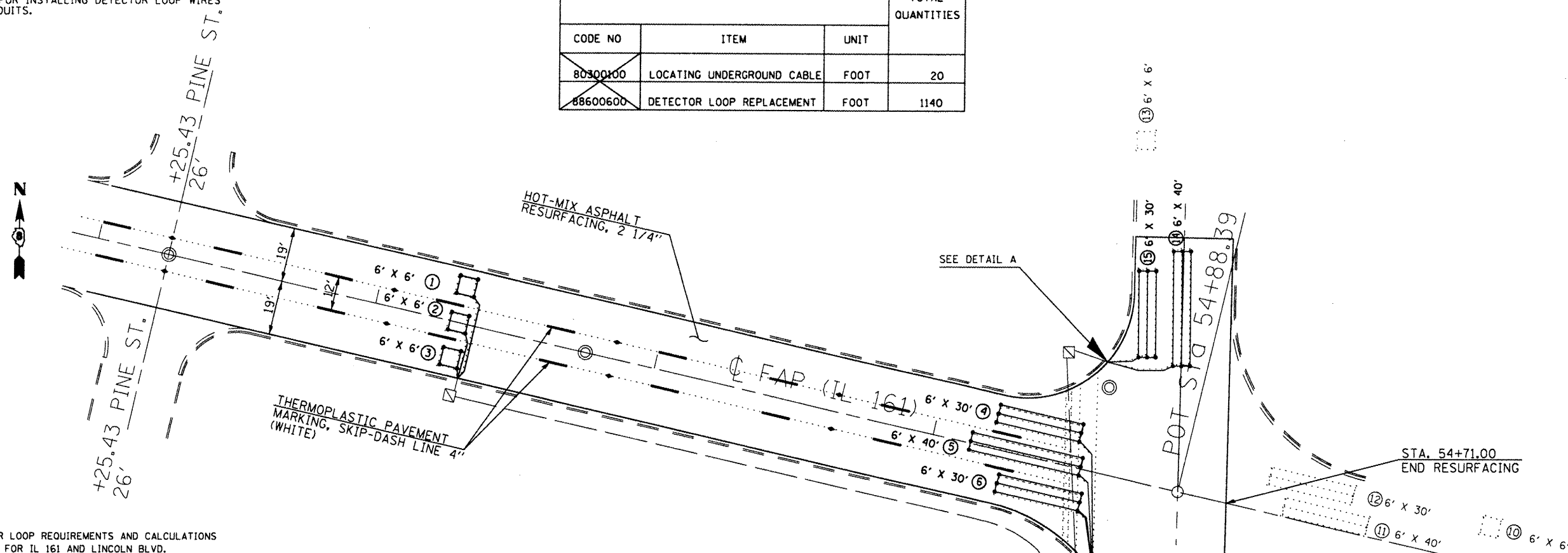

DETECTOR LOOP REQUIREMENTS AND CALCULATIONS FOR IL 161 AND LINCOLN BLVD.

LOOP#	PHASE #	LOOP SIZE (FT. X FT.)	REQUIRED # OF TURNS	CALCULATED INDUCTANCE MICROHENRIES (μH)	CALCULATED RESISTANCE OHMS (Ω)
1.SEB A CCO	6	6 X 6	5	351.3	2.2
2.SEB B CCO	6	6 X 6	5	248.2	2.1
3.SEB C CCO	6	6 X 6	5	245.3	2.0
4.SEB LT	1	6 X 30-0	3-6-3	520.3	1.8
5.SEB A THRU	6	6 X 40-0	3-6-3	667.5	2.0
6.SEB B THRU	6	6 X 30-0	3-6-3	514.6	1.6
7.NB CCO	4	NA	NA	NA	NA
8.NB THRU	4	NA	NA	NA	NA
9.NB RT	4	NA	NA	NA	NA
10.NWB CCO	2	NA	NA	NA	NA
11.NWB LT	5	NA	NA	NA	NA
12.NWB RT	2	NA	NA	NA	NA
13.SB CCO	8	NA	NA	NA	NA
14.SB LT	3	6 X 40-0	3-6-3	740.1	3.7
15.SB THRU	8	6 X 30-0	3-6-3	587.2	3.3

THE ABOVE VALUES ARE CALCULATED OF COMBINED LOOP AND LEAD-IN INDUCTANCE AND RESISTANCE. ACTUAL MEASURED VALUES SHOULD BE WITHIN +/- 20% OF THESE VALUES.

Q=QUADRAPOLE

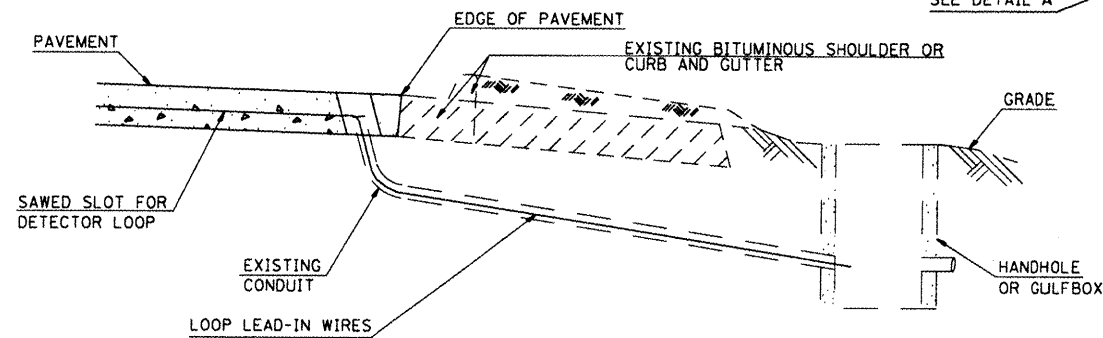

DETAIL A (NO SCALE)

INSTALLING DETECTOR LOOP WIRES IN EXISTING CONDUIT

1. DRILL OUT PAVEMENT SEALANT AND CLEAN EXISTING CONDUIT.
2. REMOVE EXISTING DETECTOR LOOP WIRES TO HANDHOLE OR GULFBOX.
3. INSTALL NEW LOOP LEAD-IN WIRES IN EXISTING CONDUIT.
4. SPLICE NEW DETECTOR LOOP WIRES TO EXISTING LOOP LEAD-IN CABLE IN HANDHOLE OR GULFBOX.
5. FILL HOLE WITH APPROVED SEALER. PREVENT SEALER FROM ENTERING INTO CONDUIT.
6. LOCATING UNDERGROUND CABLE WILL BE PAID FOR SEPARATELY.

NOT A PAY ITEM. THE COST OF THIS WORK SHALL BE INCLUDED IN THE PAY ITEM "DETECTOR LOOP REPLACEMENT"

TRAFFIC SIGNALS LEGEND

- EX. HANDHOLE
- ⊗ EX. DETECTOR LOOP
- ⊗ EX. TRAFFIC SIGNAL CONTROLLER
- EXISTING CONDUIT
- ▭ PROPOSED DETECTOR LOOP

FILE NAME : #FILE#	USER NAME : #USER#	DESIGNED -	REVISED -
		DRAWN -	REVISED -
		CHECKED -	REVISED -
		DATE -	REVISED -

STATE OF ILLINOIS
DEPARTMENT OF TRANSPORTATION

DETECTOR LOOP REPLACEMENT PLAN (PRELIMINARY)

SCALE: SHEET NO. OF SHEETS STA. TO STA.

F.A.P. RTE.	SECTION	COUNTY	TOTAL SHEETS	SHEET NO.
805	(72-2,82-2)RS-1	*	21	20

CONTRACT NO. 76E51

*CLINTON/MARION

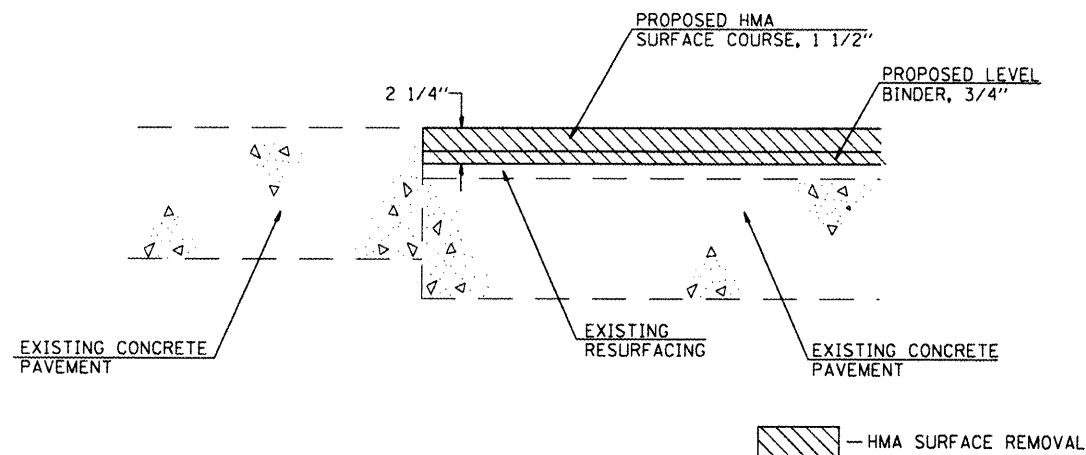

**RESURFACING DETAIL
(MC CORD ST.)**

- STA. 884+15.00
- STA. 885+70.00
- STA. 903+20.00
- STA. 905+48.05
- STA. 911+52.98
- STA. 925+08.13

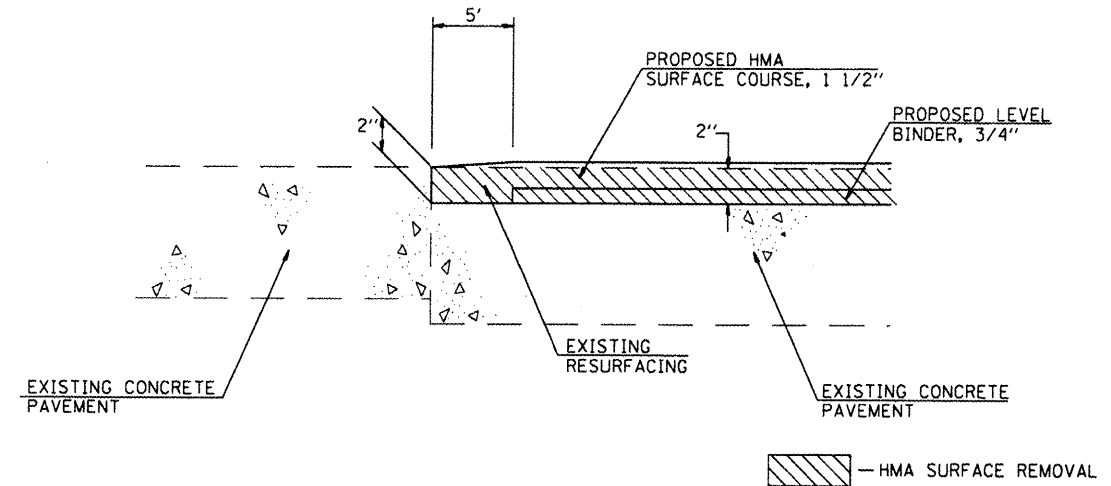

**RESURFACING DETAIL
(NOLEMAN ST.)**

- STA. 6+42.00
- STA. 54+71.00
- STA. 96+06.74 (LINCOLN BLVD.)
- STA. 94+33.80 (LINCOLN BLVD.)

FILE NAME *	USER NAME * #USER#	DESIGNED -	REVISED -
#FILE#		DRAWN -	REVISED -
		CHECKED -	REVISED -
		DATE -	REVISED -

**STATE OF ILLINOIS
DEPARTMENT OF TRANSPORTATION**

DETAILS

SCALE: _____ SHEET NO. ___ OF ___ SHEETS STA. _____ TO STA. _____

F.A.P. RTE.	SECTION	COUNTY	TOTAL SHEETS	SHEET NO.
805	(7Z-2, 8Z-2)RS-1	*	21	21
FED. ROAD DIST. NO. _____ ILLINOIS FED. AID PROJECT			CONTRACT NO. 76E51	

*CLINTON/MARION