

LEGEND

	- HOT-MIX ASPHALT SHOULDERS, 14 3/4"		- POLYMERIZED HOT-MIX ASPHALT SURFACE COURSE, MIX "D", 1 1/2"
	- POLYMERIZED HOT-MIX ASPHALT SURFACE COURSE, MIX "E", 1 1/2"		- POLYMERIZED HOT-MIX ASPHALT SURFACE COURSE, MIX "C", 1 3/4"
	- POLYMERIZED HOT-MIX ASPHALT BINDER COURSE, N105, IL-19.0, 2 3/4"		- PORTLAND CEMENT CONCRETE BASE COURSE, 10"
	- HOT-MIX ASPHALT BINDER COURSE, IL-19.0, N90, 10 1/2"		- HOT-MIX ASPHALT SHOULDERS, 8"
	- SUB-BASE GRANULAR MATERIAL, TYPE A, 8"		- POLYMERIZED HOT-MIX ASPHALT SURFACE COURSE, MIX D, 1 1/2"
	- PORTLAND CEMENT CONCRETE 9 1/2" (JOINTED)		- HOT-MIX ASPHALT SURFACE COURSE, MIX C, N70, 4"
	- PORTLAND CEMENT SHOULDERS, 9 1/2"		

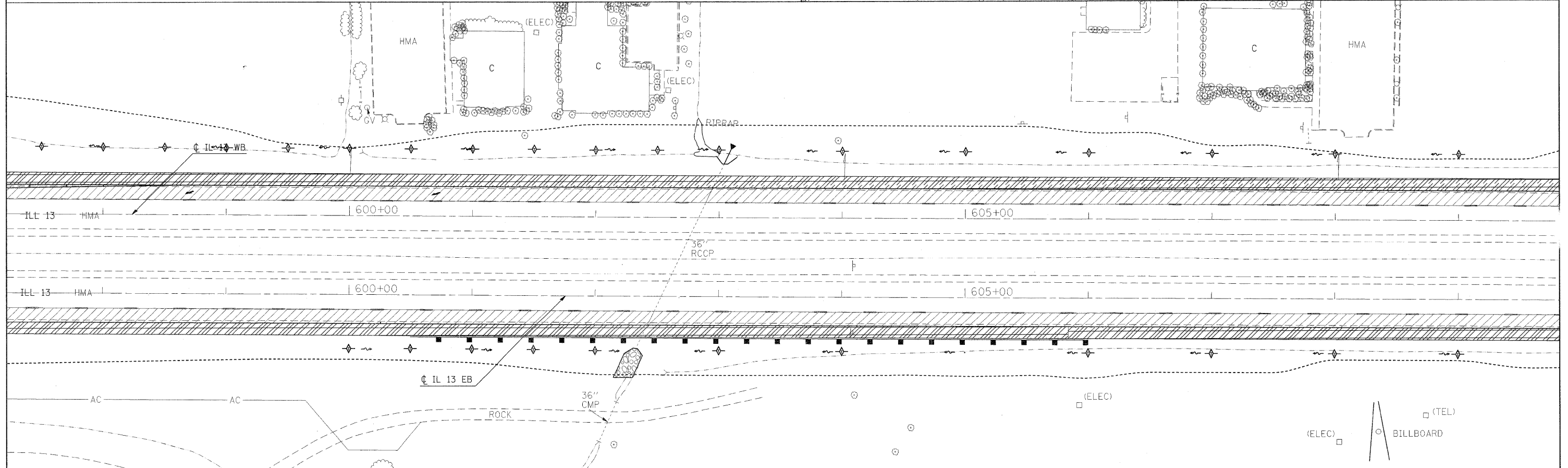

FILE NAME =	USER NAME = knightsm	DESIGNED -	REVISED -	STATE OF ILLINOIS DEPARTMENT OF TRANSPORTATION	CONSTRUCTION SHEET	F.A.P. RTE. 331	SECTION (I-3, I-2)N-1, TS-2	COUNTY WILLIAMSON	TOTAL SHEETS 251	SHEET NO. 65		
c:\pw\work\pwi\dots\knightsm\d0135592\78133-shr:eros.dgn	PLOT SCALE = 40,000' / IN.	DRAWN -	REVISED -			SCALE:	SHEET NO. OF SHEETS	STA. TO STA.	ILLINOIS FED. AID PROJECT			
	PLOT DATE = 1/3/2011	CHECKED -	REVISED -						CONTRACT NO. 78133			
		DATE -	REVISED -						ILLINOIS FED. AID PROJECT			