

STAGE 2 NOTES

1. REMOVE EXISTING SHOULDER AND PAVEMENT, CURB AND GUTTER AND ISLAND. PLACE EMBANKMENT, CURB AND GUTTER, ISLAND DRAINAGE ITEMS AND PCC PAVEMENT.
2. CLOSE IL 13 EB OUTSIDE THROUGH LANE AND RIGHT TURN LANE ACCORDING TO STD 701701. ADD RIGHT TURN LANE CLOSED AHEAD SIGN.
3. CLOSE IL 148 NB OUTSIDE THROUGH LANE AND RIGHT TURN LANE ACCORDING TO STD 701701. ADD RIGHT TURN LANE CLOSED AHEAD SIGN.
4. CLOSE IL 148 SB OUTSIDE THROUGH LANE ACCORDING TO STD 701701.
5. AS SOON AS POSSIBLE MOVE BARRICADES BACK TO ALLOW TWO THROUGH LANES OF TRAFFIC ON IL 13.
6. CULVERT EXTENSION AT STA 629+80 MUST BE ACCOMPLISHED PRIOR TO STAGE 2 CONSTRUCTION.
7. FOR EACH PARTIAL OR FULL DAY IL 13 IS RESTRICTED TO ONE THROUGH LANE, A LANE RENTAL WILL BE CHARGED.
8. FOR EACH PARTIAL OR FULL DAY ANY TURN LANE IS CLOSED, AN INTERSECTION RENTAL DAY WILL BE CHARGED.

STAGE 2

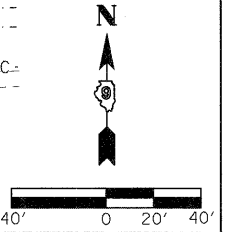
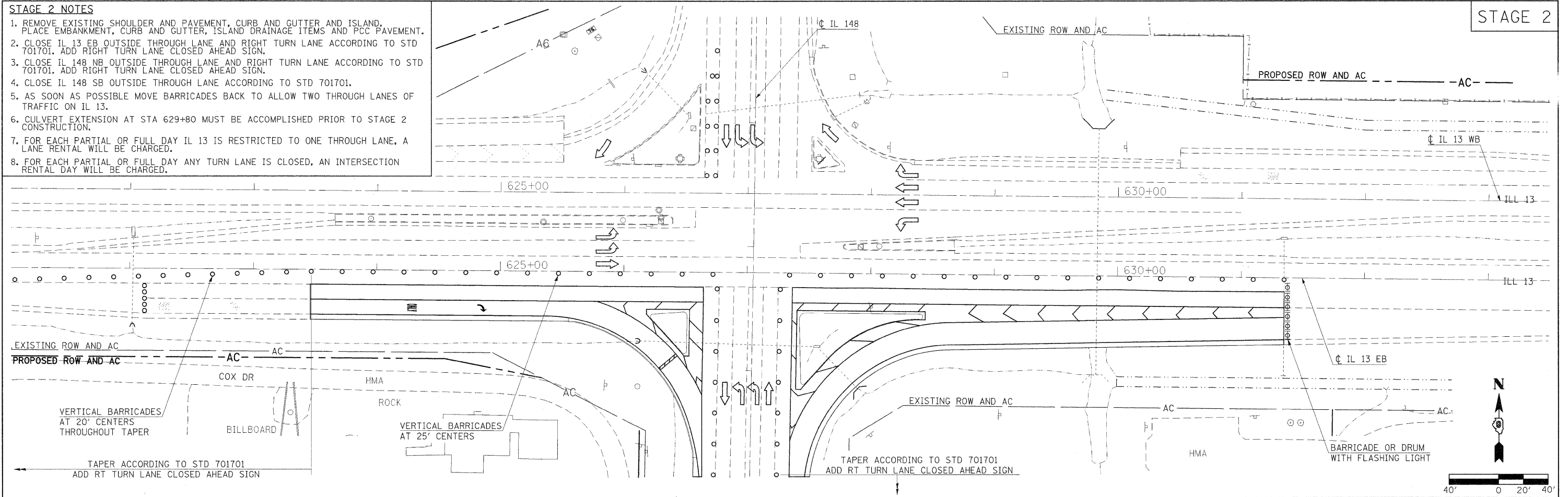

STAGE 3 NOTES

1. REMOVE EXISTING PAVEMENT AND REPLACE WITH PCC PAVEMENT.
2. CLOSE IL 13 EB OUTSIDE THROUGH AND RIGHT TURN LANES ACCORDING TO STD 701701.
3. CLOSE IL 148 LEFT AND THROUGH LANES ACCORDING TO STD BLR 21.
4. CLOSE IL 148 SB THROUGH LANES ACCORDING TO STD 701701. REPLACE LEFT LANE/RIGHT LANE SIGN WITH SIGN W20-5c-48 (CENTERLINE CLOSED).
5. CLOSE IL 13 WB LEFT TURN LANE ACCORDING TO STD 701701.
6. AS SOON AS POSSIBLE MOVE BARRICADES BACK TO ALLOW TWO THROUGH LANES OF TRAFFIC ON IL 13.
7. FOR EACH PARTIAL OR FULL DAY IL 13 IS RESTRICTED TO ONE THROUGH LANE, A LANE RENTAL WILL BE CHARGED.
8. FOR EACH PARTIAL OR FULL DAY ANY TURN LANE IS CLOSED, AN INTERSECTION RENTAL DAY WILL BE CHARGED.

STAGE 3

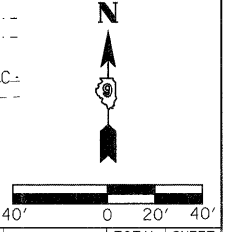
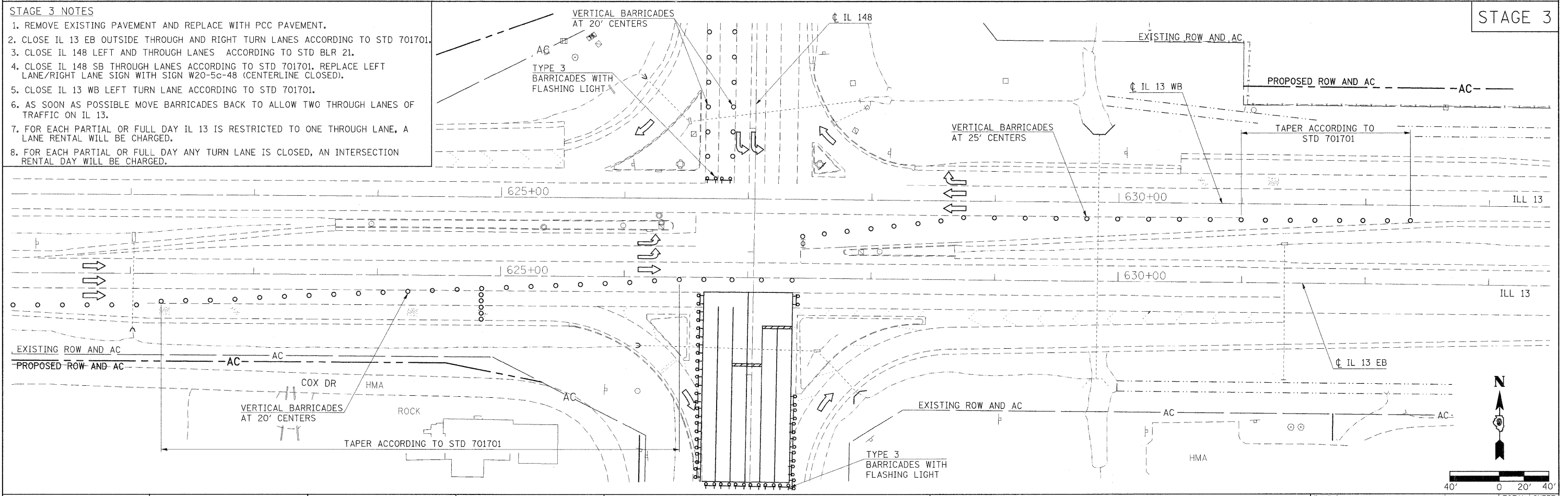

FILE NAME = c:\pva\work\pva\dot\knight\sm\dl135592\78133-shr-staging.dgn

USER NAME = knightm	DESIGNED -	REVISED -
PLOT SCALE = 48,0000' / IN.	DRAWN -	REVISED -
PLOT DATE = 1/3/2011	CHECKED -	REVISED -
	DATE -	REVISED -

**STATE OF ILLINOIS
DEPARTMENT OF TRANSPORTATION**

**STAGING SHEET
STAGES 2 AND 3**

SCALE: 1"=40' SHEET NO. OF SHEETS STA. TO STA.

F.A.P. RTE.	SECTION	COUNTY	TOTAL SHEETS	SHEET NO.
331	(I-3,I-2)N-1,TS-2	WILLIAMSON	251	74
			CONTRACT NO. 78133	
ILLINOIS FED. AID PROJECT				