

- STAGE 4 NOTES**
1. REMOVE EXISTING SHOULDERS, CURB AND GUTTER AND ISLAND. PLACE EMBANKMENT, CURB AND GUTTER, ISLAND DRAINAGE ITEMS AND PCC PAVEMENT.
 2. CLOSE IL 13 WB OUTSIDE THROUGH LANE AND RIGHT TURN LANE ACCORDING TO STD 701701. ADD RIGHT TURN LANE CLOSED AHEAD SIGN.
 3. CLOSE IL 13 INSIDE LEFT TURN LANE AS SHOWN. IL 13 EB OUTSIDE LEFT TURN LANE TO REMAIN OPEN.
 4. CLOSE IL 148 SB OUTSIDE THROUGH LANE AND RIGHT TURN LANE ACCORDING TO STD 701701. ADD RIGHT TURN LANE CLOSED AHEAD SIGN.
 5. CLOSE IL 148 NB OUTSIDE THROUGH LANE ACCORDING TO STD 701701.
 6. AS SOON AS POSSIBLE MOVE BARRICADES BACK TO ALLOW TWO THROUGH LANES OF TRAFFIC ON IL 13.
 7. FOR EACH PARTIAL OR FULL DAY IL 13 IS RESTRICTED TO ONE THROUGH LANE, A LANE RENTAL WILL BE CHARGED.
 8. FOR EACH PARTIAL OR FULL DAY ANY TURN LANE IS CLOSED, AN INTERSECTION RENTAL DAY WILL BE CHARGED.

- STAGE 5 NOTES**
1. REMOVE EXISTING PAVEMENT AND REPLACE WITH PCC PAVEMENT.
 2. CLOSE IL 13 WB OUTSIDE THROUGH AND RIGHT TURN LANES ACCORDING TO STD 701701.
 3. CLOSE SB IL 148 LEFT AND INSIDE THROUGH LANE ACCORDING TO STD BLR 21.
 4. CLOSE IL 148 NB THROUGH LANES ACCORDING TO STD 701701. REPLACE LEFT LANE/RIGHT LANE SIGN WITH W20-5c(0)-48 (CENTERLANE CLOSED).
 5. CLOSE IL 13 EB LEFT TURN LANE ACCORDING TO STD 701701.
 6. AS SOON AS POSSIBLE MOVE BARRICADES BACK TO ALLOW TWO THROUGH LANES OF TRAFFIC ON IL 13.
 7. FOR EACH PARTIAL OR FULL DAY IL 13 IS RESTRICTED TO ONE THROUGH LANE, A LANE RENTAL WILL BE CHARGED.
 8. FOR EACH PARTIAL OR FULL DAY ANY TURN LANE IS CLOSED, AN INTERSECTION RENTAL DAY WILL BE CHARGED.

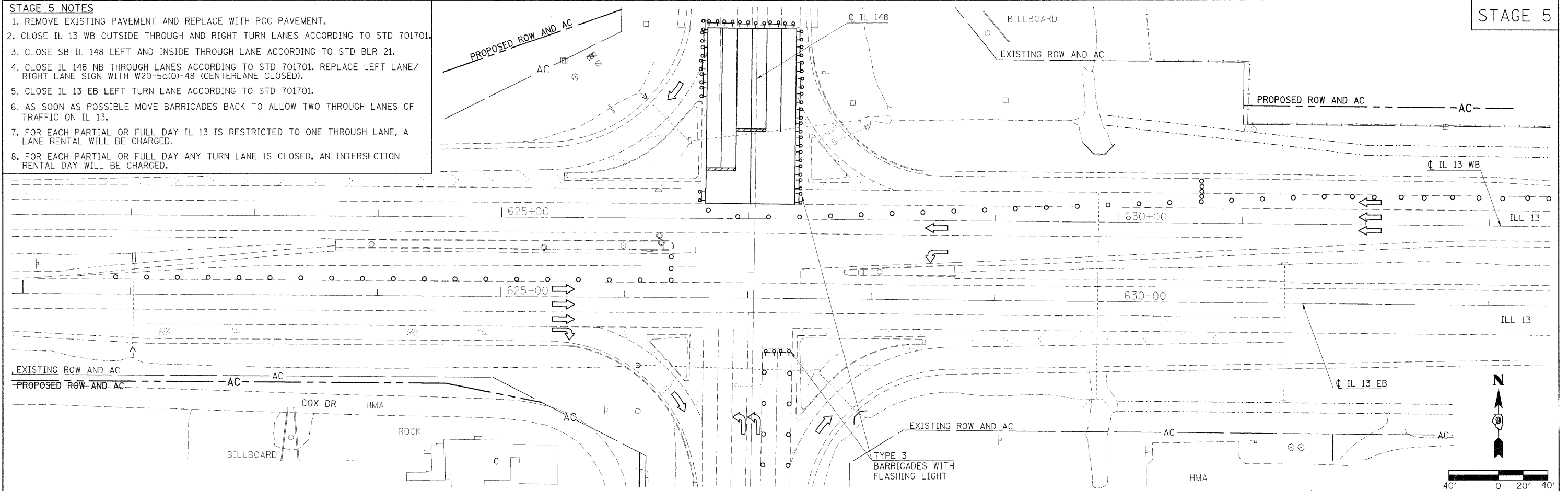

FILE NAME =
 c:\paw\work\knight\m\8135592\78133\stg-4\stg4.dgn

USER NAME = knightm	DESIGNED -	REVISED -
PLOT SCALE = 40,0000' / IN.	DRAWN -	REVISED -
PLOT DATE = 1/3/2011	CHECKED -	REVISED -
	DATE -	REVISED -

**STATE OF ILLINOIS
 DEPARTMENT OF TRANSPORTATION**

**STAGING SHEET
 STAGES 4 AND 5**

SCALE: 1"=40' SHEET NO. OF SHEETS STA. TO STA.

F.A.P. RTE.	SECTION	COUNTY	TOTAL SHEETS	SHEET NO.
331	(I-3,I-2)N-LTS-2	WILLIAMSON	251	75
CONTRACT NO. 78133				
ILLINOIS FED. AID PROJECT				