

- STAGE 8 NOTES**
1. REMOVE EXISTING PAVEMENT. PLACE PCC PAVEMENT.
 2. CLOSE IL 13 EB LEFT TURN LANES AND IL 13 WB OUTSIDE LEFT TURN LANE ACCORDING TO STD 701701.
 3. CLOSE SB IL 148 AND NB IL 148 LEFT AND THROUGH LANES ACCORDING TO STD BLR 21.
 4. FOR EACH PARTIAL OR FULL DAY ANY TURN LANE IS CLOSED, AN INTERSECTION RENTAL DAY WILL BE CHARGED.

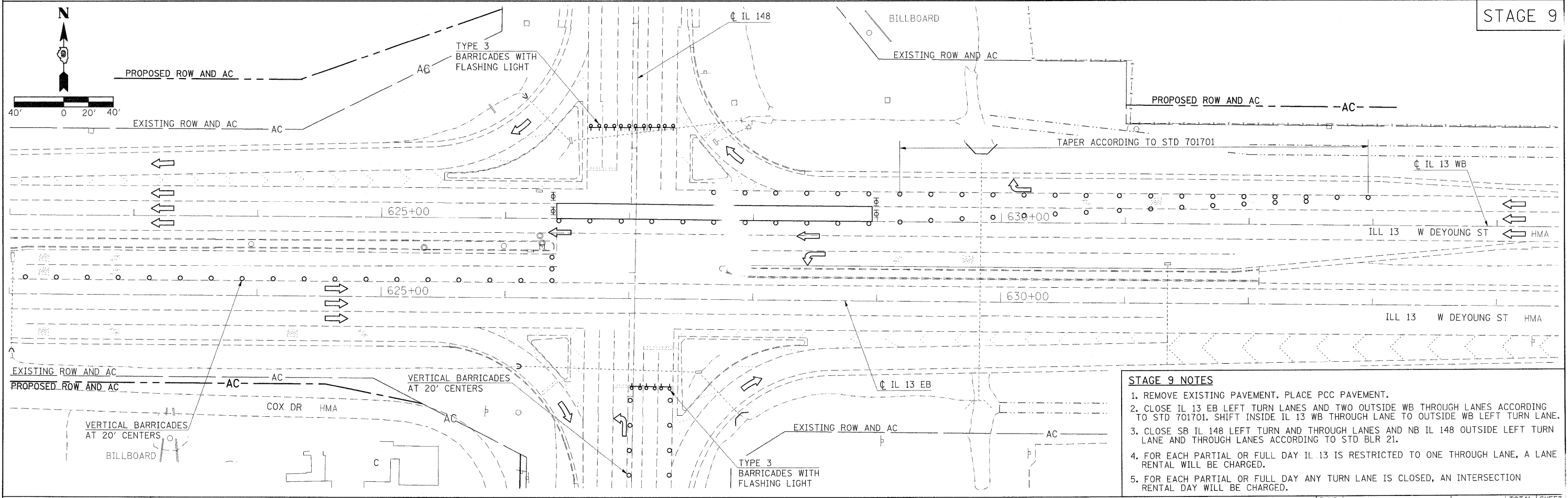

- STAGE 9 NOTES**
1. REMOVE EXISTING PAVEMENT. PLACE PCC PAVEMENT.
 2. CLOSE IL 13 EB LEFT TURN LANES AND TWO OUTSIDE WB THROUGH LANES ACCORDING TO STD 701701. SHIFT INSIDE IL 13 WB THROUGH LANE TO OUTSIDE WB LEFT TURN LANE.
 3. CLOSE SB IL 148 LEFT TURN AND THROUGH LANES AND NB IL 148 OUTSIDE LEFT TURN LANE AND THROUGH LANES ACCORDING TO STD BLR 21.
 4. FOR EACH PARTIAL OR FULL DAY IL 13 IS RESTRICTED TO ONE THROUGH LANE, A LANE RENTAL WILL BE CHARGED.
 5. FOR EACH PARTIAL OR FULL DAY ANY TURN LANE IS CLOSED, AN INTERSECTION RENTAL DAY WILL BE CHARGED.

STATE OF ILLINOIS
DEPARTMENT OF TRANSPORTATION

STAGING SHEET
STAGES 8 AND 9

USER NAME = knightam	DESIGNED -	REVISED -
PLOT SCALE = 40,0000 "/>		

SCALE: 1"=40' SHEET NO. OF SHEETS STA. TO STA.

F.A.P. RTE.	SECTION	COUNTY	TOTAL SHEETS	SHEET NO.
331	(1-3,1-2)N-1,TS-2	WILLIAMSON	251	78
CONTRACT NO. 78133				

ILLINOIS FED. AID PROJECT

FILE NAME = c:\pwwork\pwwork\m\rightsm\13133-1\stg8.dgn