

LEGEND

- EXISTING CONDUIT
- ⊠ EXISTING TRAFFIC SIGNAL CONTROLLER
- ⊕ EXISTING SIGNAL HEAD
- ⊙ EXISTING SIGNAL POST
- ⊗ EXISTING LIGHT POLE AND LUMINAIRE
- T CONDUIT IN TRENCH
- P CONDUIT, PUSHED
- 1/2" PVC SIZE OF CONDUIT
- ⊠ PROPOSED TYPE IV CABINET, TRAFFIC SIGNAL CONTROLLER, HIGHWAY LIGHTING CONTROLLER, AND SERVICE INSTALLATION
- ⊕ PROPOSED STEEL COMBINATION MAST ARM ASSEMBLY AND POLE
- ⊙ PROPOSED TRAFFIC SIGNAL POST AND SIGNAL HEAD
- ⊕ PROPOSED SIGNAL HEAD WITH BACKPLATE, MAST ARM MOUNTED
- ⊙ PROPOSED GULFBOX JUNCTION
- ⊠ PROPOSED CONCRETE HANDHOLE
- PROPOSED PVC CONDUIT

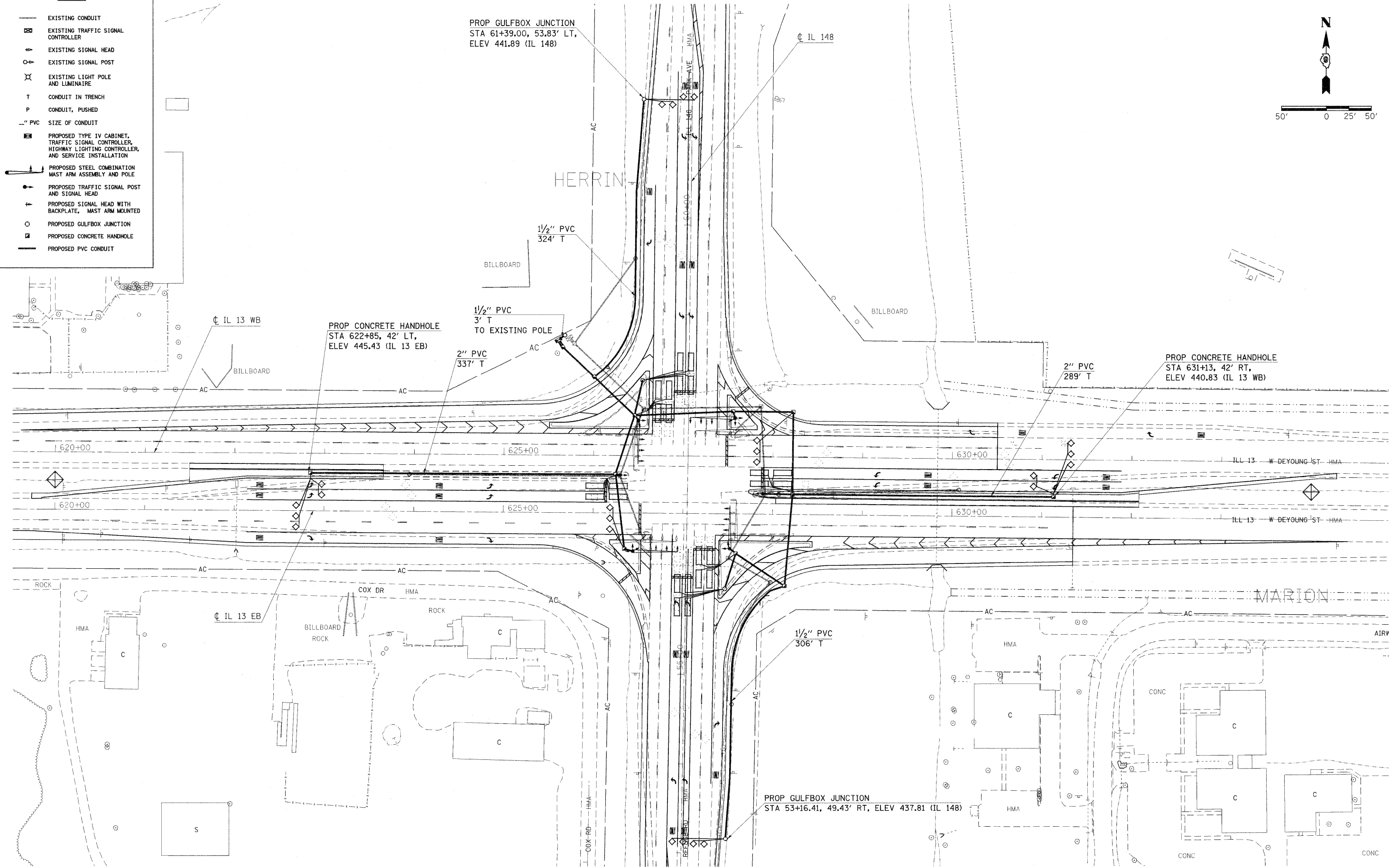
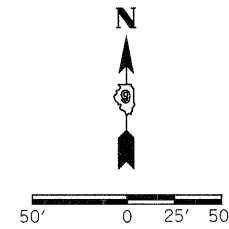

FILE NAME =
 c:\p\work\p\dot\knightm\d0135592\78133-sh1-ts.dgn
 USER NAME = knightm
 PLOT SCALE = 50.0000 "/>

DESIGNED -	REVISED -
DRAWN -	REVISED -
CHECKED -	REVISED -
DATE -	REVISED -

**STATE OF ILLINOIS
 DEPARTMENT OF TRANSPORTATION**

**PROPOSED TRAFFIC SIGNALS
 AND LIGHTING**

SCALE: 1"=50' SHEET NO. OF SHEETS STA. TO STA.

F.A.P. RTE.	SECTION	COUNTY	TOTAL SHEETS	SHEET NO.
331	(I-3,I-2IN-1,TS-1	WILLIAMSON	251	104
CONTRACT NO. 78133			ILLINOIS FED. AID PROJECT	