

DATE	
BY	
FINAL SURVEY	SURVEYED
NOTE BOOK	PLOTTED
NO.	TEMPLATE
	AREAS CHECKED

DATE	
BY	
ORIGINAL SURVEY	SURVEYED
NOTE BOOK	PLOTTED
NO.	TEMPLATE
	AREAS CHECKED

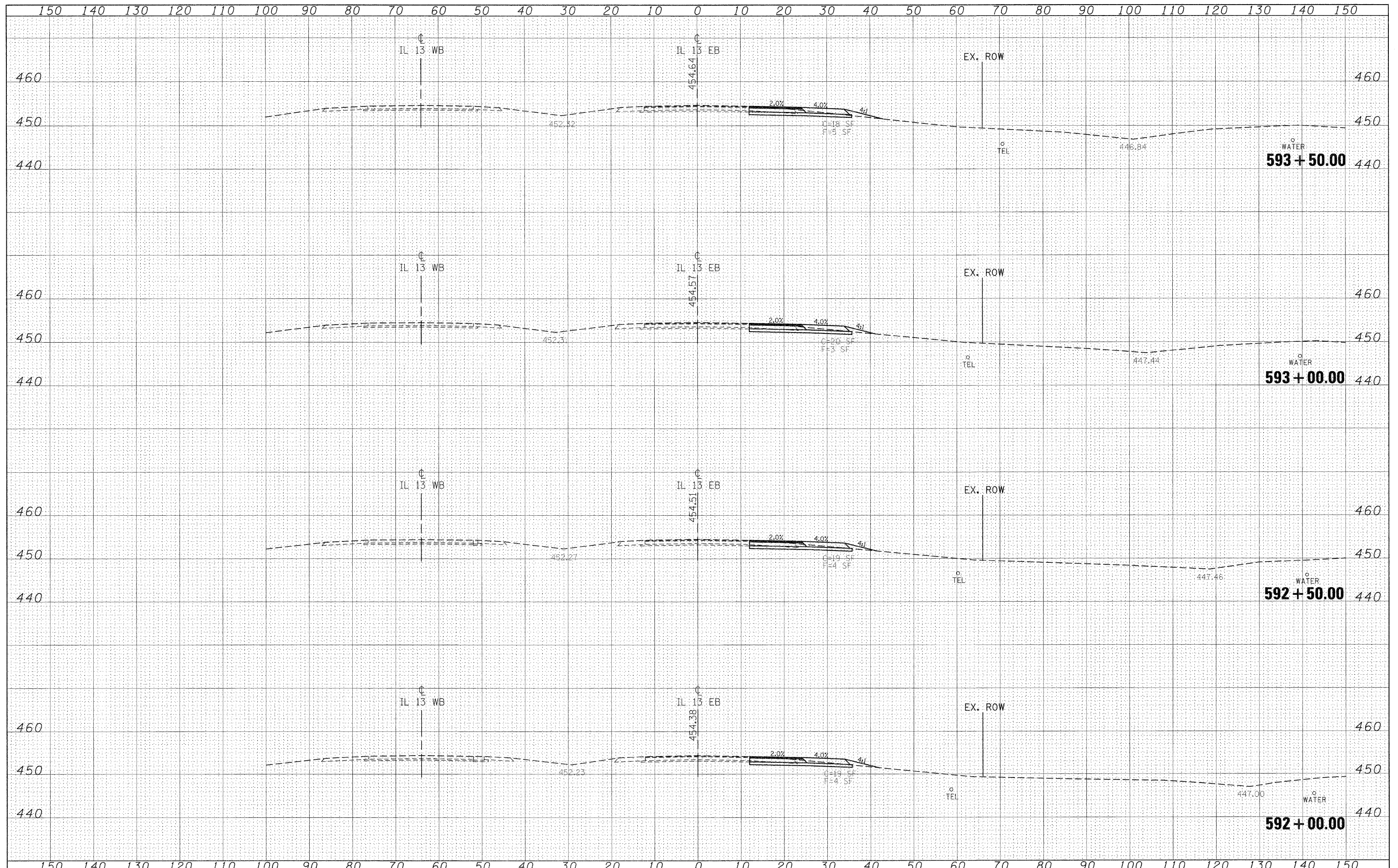

FILE NAME =	USER NAME = knightsr	DESIGNED -	REVISED -	STATE OF ILLINOIS DEPARTMENT OF TRANSPORTATION	IL 13 EASTBOUND CROSS SECTIONS		F.A.P. RTE.	SECTION	COUNTY	TOTAL SHEETS	SHEET NO.
c:\pwork\pwork\knightsr\0135592\78133-sht-331.rtl3eb.dgn		DRAWN -	REVISED -		331	(I-3,I-2IN-1,TS-1)	WILLIAMSON	251	117		
PLOT SCALE = 10.0000' / IN.		CHECKED -	REVISED -		CONTRACT NO. 78133						
PLOT DATE = 1/3/2011		DATE -	REVISED -		ILLINOIS FED. AID PROJECT						
					SCALE: 1"=10'	SHEET NO. OF SHEETS	STA. 592+00.00 TO STA. 593+50.00				