

DATE	
BY	
REVISIONS	
SURVEY	
PLOTTED	
TEMPLATE	
NOTE BOOK	
AREAS CHECKED	
NO.	

DATE	
BY	
REVISIONS	
SURVEY	
PLOTTED	
TEMPLATE	
NOTE BOOK	
AREAS CHECKED	
NO.	

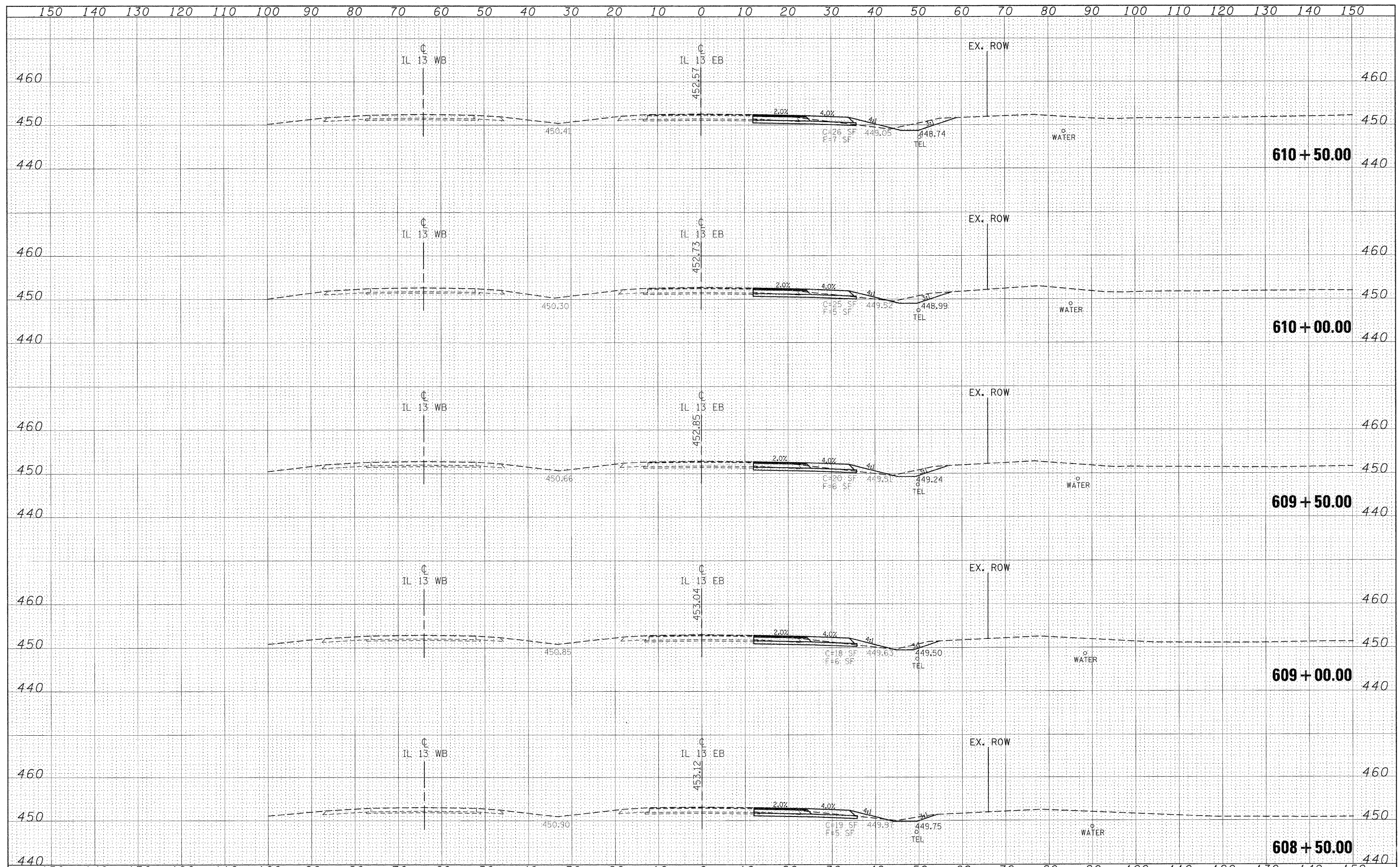

FILE NAME =	USER NAME = knightsm	DESIGNED -	REVISED -	STATE OF ILLINOIS DEPARTMENT OF TRANSPORTATION	IL 13 EASTBOUND CROSS SECTIONS		F.A.P. RTE.	SECTION	COUNTY	TOTAL SHEETS	SHEET NO.
c:\pw\work\p\dot\knightsm\vd8135592\78133-ahf-rc_r13eb.dgn		DRAWN -	REVISED -		331	(I-3,I-2N-I,TS-1)	WILLIAMSON	151	126		
PLOT SCALE = 10,0000' / 1"		CHECKED -	REVISED -		CONTRACT NO. 78133						
PLOT DATE 1/3/2011		DATE -	REVISED -		ILLINOIS FED. AID PROJECT						
					SCALE: 1"=10'	SHEET NO. OF SHEETS	STA. 608+50.00 TO STA. 610+50.00				