

|              |          |         |
|--------------|----------|---------|
| FINAL SURVEY | SURVEYED | DATE    |
| NOTE BOOK    | PLOTTED  | BY      |
| NO.          | TEMPLATE |         |
|              | AREAS    | CHECKED |
|              | AREAS    | CHECKED |

|                 |          |         |
|-----------------|----------|---------|
| ORIGINAL SURVEY | SURVEYED | DATE    |
| NOTE BOOK       | PLOTTED  | BY      |
| NO.             | TEMPLATE |         |
|                 | AREAS    | CHECKED |
|                 | AREAS    | CHECKED |

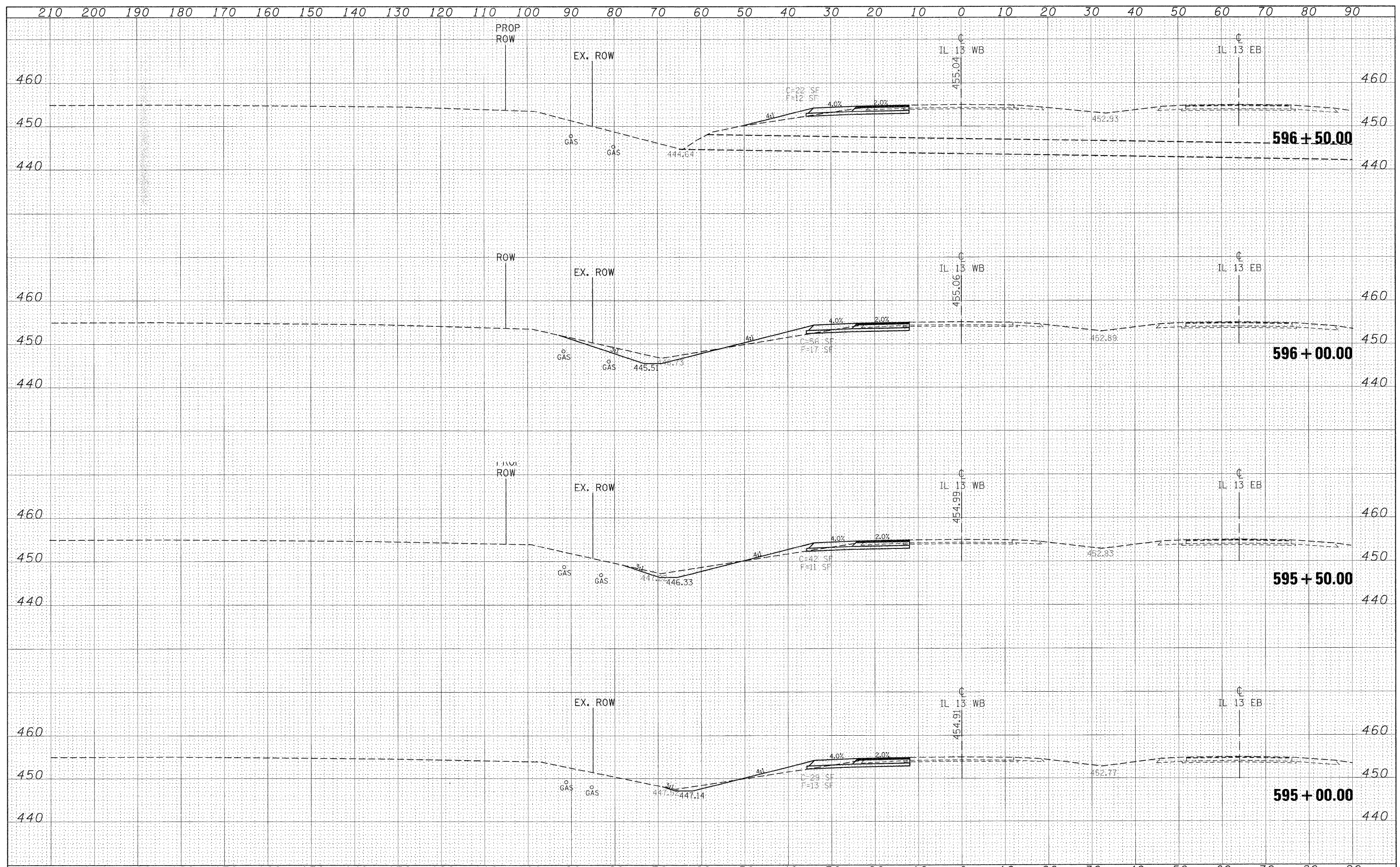

|   |                      |            |           |   |   |                     |            |  |         |                    |              |           |
|---|----------------------|------------|-----------|---|---|---------------------|------------|--|---------|--------------------|--------------|-----------|
| FILE NAME =   | USER NAME = knighthm | DESIGNED - | REVISED - | <b>STATE OF ILLINOIS<br/>DEPARTMENT OF TRANSPORTATION</b> | <b>IL 13 WESTBOUND<br/>CROSS SECTIONS</b> |                     |            | F.A.P. RTE.  | SECTION | COUNTY             | TOTAL SHEETS | SHEET NO. |
| c:\pw_work\pwwork\knighthm\08135592\78133-sh1-r13wb.dgn | pc.r13wb.dgn         | DRAWN -    | REVISED - |   | 331                                       | (I-3, I-2)N-1, TS-1 | WILLIAMSON | 251  | 140     |                    |              |           |
|   |                      | CHECKED -  | REVISED - |   | SCALE: 1"=10'                             |                     |            | SHEET NO. OF SHEETS STA. 595+00.00 TO STA. 596+50.00 |         | CONTRACT NO. 78133 |              |           |
| 78133/CADsheets/78133-sh1-xsc_r13wb.dgn                 |                      | DATE -     | REVISED - |   | ILLINOIS FED. AID PROJECT                 |                     |            |  |         |                    |              |           |