

DATE	
BY	
DESIGNED	
DRAWN	
CHECKED	
REVISIONS	
NO.	

DATE	
BY	
DESIGNED	
DRAWN	
CHECKED	
REVISIONS	
NO.	

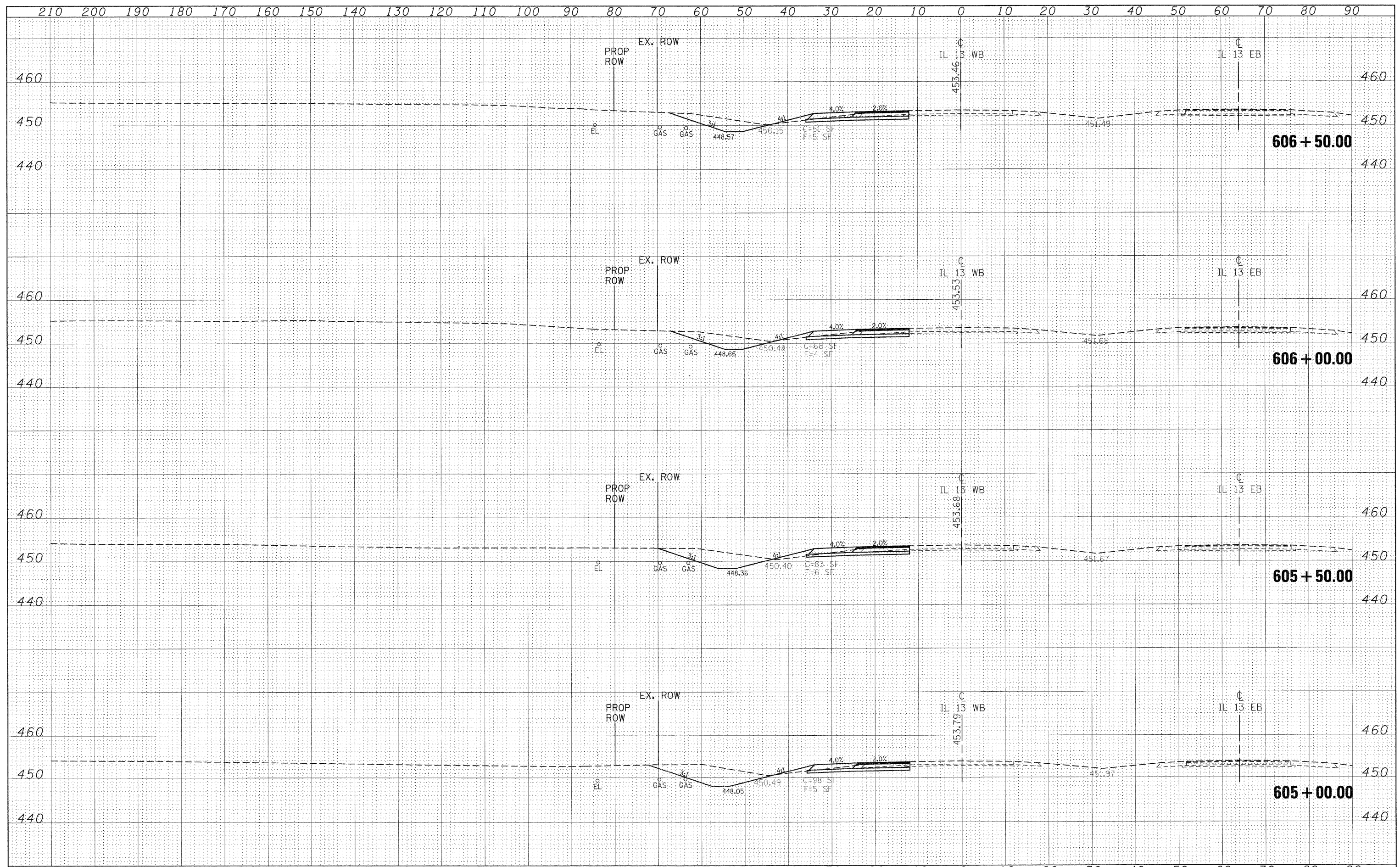

FILE NAME =	USER NAME = knightm	DESIGNED -	REVISED -	STATE OF ILLINOIS DEPARTMENT OF TRANSPORTATION	IL 13 WESTBOUND CROSS SECTIONS		F.A.P. RTE.	SECTION	COUNTY	TOTAL SHEETS	SHEET NO.
c:\pw_work\p\dot\knightm\0135592\78133-sht-xsc-r13wb.dgn		DRAWN -	REVISED -		331	(I-3,I-2IN-1,TS-1)	WILLIAMSON	251	145		
78133/CADsheets/78133-sht-xsc-r13wb.dgn		CHECKED -	REVISED -		CONTRACT NO. 78133			ILLINOIS FED. AID PROJECT			
		DATE -	REVISED -		SCALE: 1"=10'	SHEET NO.	OF SHEETS	STA. 605+00.00	TO STA. 606+50.00		