

DATE	
BY	
ORIGINAL SURVEY	
SURVEYED	
PLOTTED	
TEMPLATE	
NOTE BOOK	
AREAS	
CHECKED	
NO.	

DATE	
BY	
ORIGINAL SURVEY	
SURVEYED	
PLOTTED	
TEMPLATE	
NOTE BOOK	
AREAS	
CHECKED	
NO.	

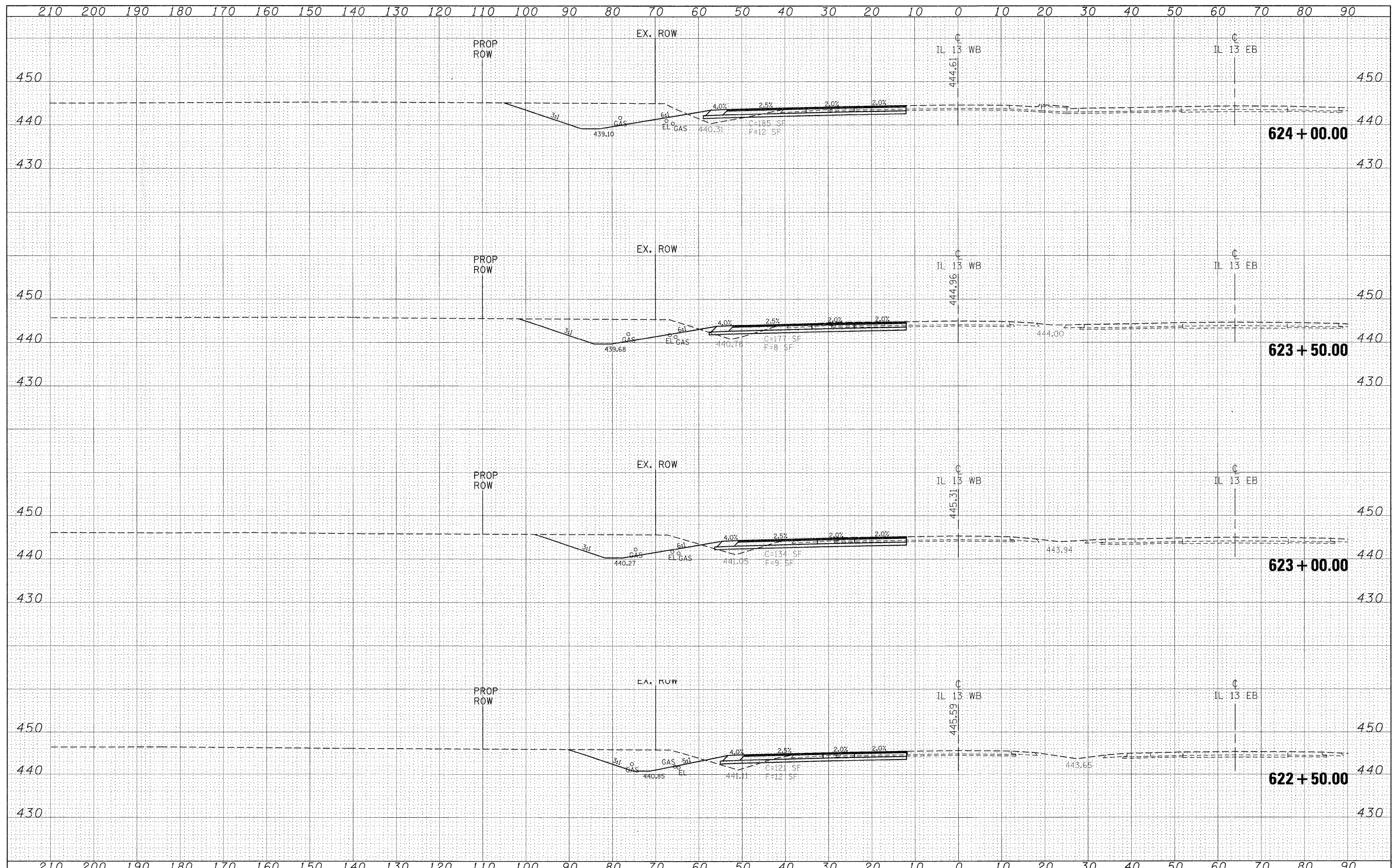

FILE NAME =	USER NAME = knightsn	DESIGNED -	REVISED -	STATE OF ILLINOIS DEPARTMENT OF TRANSPORTATION	IL 13 WESTBOUND CROSS SECTIONS			F.A.P. RTE. 331	SECTION (I-3, I-2)N-1, TS-1	COUNTY WILLIAMSON	TOTAL SHEETS 151	SHEET NO. 153
c:\pwork\pwork\knightsn\d81355\2\78133-sh-t-xsc_r113wb.dgn	PLOT SCALE = 10.0000' / IN.	DRAWN -	REVISED -		SCALE: 1"=10'	SHEET NO.	OF	SHEETS	STA. 622+50.00	TO STA. 624+00.00	ILLINOIS FED. AID PROJECT	
78133\CAD\sheets\78133-sh-t-xsc_r113wb.dgn	PLOT DATE = 1/3/2011	CHECKED -	REVISED -								CONTRACT NO. 78133	
		DATE -	REVISED -									