

F.A.U. RTE.	SECTION	COUNTY	TOTAL SHEETS	SHEET NO.
	09-00559-00-BR	Winnebago	21	1
FED. ROAD DIST. NO. 2	ILLINOIS	CONTRACT NO.	85528	

INDEX OF SHEETS	
SHEET NO.	DESCRIPTION
1	COVER SHEET
2	GENERAL NOTES & LIST OF STANDARD ABBREVIATIONS
3	SUMMARY OF QUANTITIES
4	TYPICAL SECTIONS
5	TEMPORARY DETOUR PLAN
6	PLAN AND PROFILE
7	STRIPING, EROSION CONTROL & RESTORATION PLAN
8-19	BRIDGE PLANS
20-21	CROSS SECTIONS

STATE STANDARDS	
000001-06	STANDARD SYMBOLS, ABBREVIATIONS AND PATTERNS
280001-05	TEMPORARY EROSION CONTROL SYSTEM
515001-03	NAME PLATE FOR BRIDGES
542301-03	PRECAST REINFORCED CONCRETE FLARED, END SECTION
601101-01	CONCRETE HEADWALL FOR PIPE DRAIN
602001-02	CATCH BASIN TYPE A
602301-03	INLET - TYPE A
602401-03	MANHOLE TYPE A
604001-03	FRAME AND LIDS TYPE 1
604006-04	FRAME AND GRATE TYPE 3
606001-04	CONCRETE CURB TYPE B AND COMBINATION CONCRETE CURB AND GUTTER
630001-09	STEEL PLATE BEAM GUARDRAIL
635006-03	REFLECTOR AND TERMINAL MARKER PLACEMENT
635011-02	REFLECTOR MARKER AND MOUNTING DETAILS
701006-03	OFF-RD OPERATIONS, 2L, 2W, 15' (4.5M) TO 24" (600mm) FROM PAVEMENT EDGE
701301-04	LANE CLOSURE, 2L, 2W, SHORT TIME OPERATIONS
701901-01	TRAFFIC CONTROL DEVICES
720011-01	METAL POST FOR SIGNS, MARKERS & DELINEATORS
728001-01	TELESCOPING STEEL SIGN SUPPORT
729001-01	APPLICATIONS OF TYPES A & B METAL POSTS
BLR 21-8	TYPICAL APPLICATION OF TRAFFIC CONTROL DEVICES FOR CONSTRUCTION ON RURAL LOCAL HIGHWAYS
BLR 22-6	TYPICAL APPLICATION OF TRAFFIC CONTROL DEVICES FOR CONSTRUCTION ON RURAL LOCAL HIGHWAYS
BLR 23-3	TRAFFIC BARRIER TERMINAL TYPE 1
BLR 27-1	TRAFFIC BARRIER TERMINAL TYPE 5A

# CITY OF ROCKFORD PLANS FOR PROPOSED FEDERAL AID HIGHWAY

**MUNICIPAL STREET 7674  
STONERIDGE DRIVE  
OVER SPRING CREEK  
SECTION 09-00559-00-BR  
BRIDGE REPLACEMENT  
PROJECT NO. BHM-5099 (083)  
EXIST. S.N. 101-6021  
PROP. S.N. 101-6011  
WINNEBAGO COUNTY  
C-92-099-09**

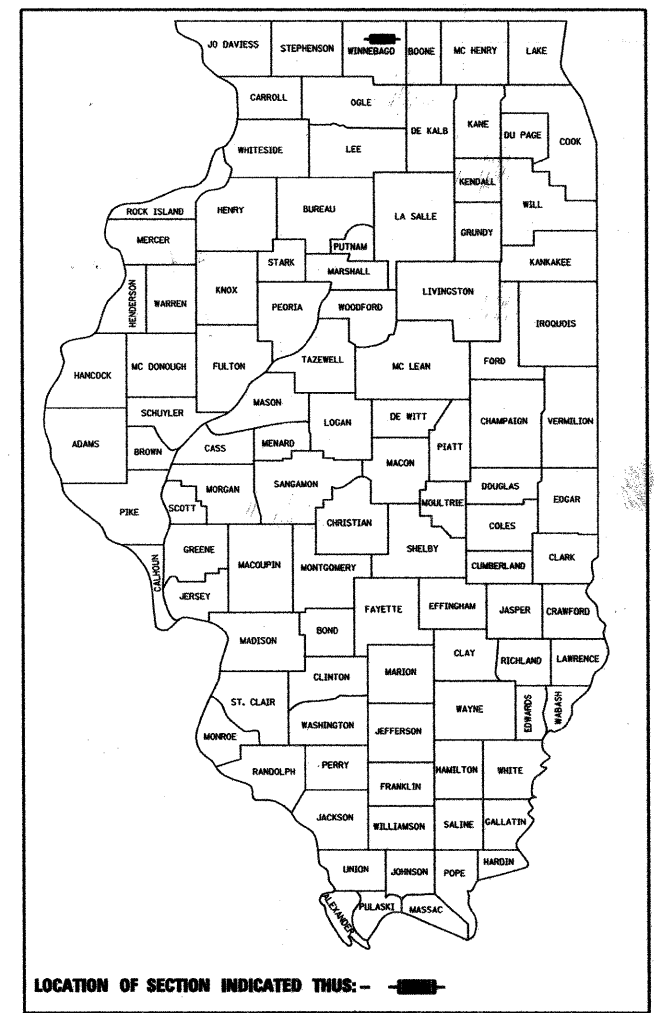

**STRUCTURE INFORMATION:**

EXISTING SN: 101-6021:  
EXISTING SINGLE SPAN STRUCTURE CONSISTS OF AN ARCHED REINFORCED CONCRETE SLAB WITH AN OUT-TO-OUT WIDTH OF 21'-0" AND A TOTAL LENGTH OF 34'-0" BK. TO BK. ABUTMENTS WITH A 0 DEGREE SKEW. THE SUBSTRUCTURE CONSISTS OF CLOSED CONCRETE ABUTMENTS. STRUCTURE TO BE REMOVED AS SHOWN.

PROPOSED SN: 101-6011:  
SINGLE SPAN STRUCTURE CONSISTS OF 27" DEEP PRECAST, PRESTRESSED CONCRETE DECK BEAMS AND A 5" THICK REINFORCED CONCRETE WEARING SURFACE WITH AN OUT-TO-OUT WIDTH OF 24'-0" AND A TOTAL LENGTH OF 57'-9" BK. TO BK. ABUTMENTS. THE PROPOSED STRUCTURE HAS A 20 DEGREE AHEAD RIGHT SKEW. THE SUBSTRUCTURE CONSISTS OF OPEN PILE BENT ABUTMENTS.

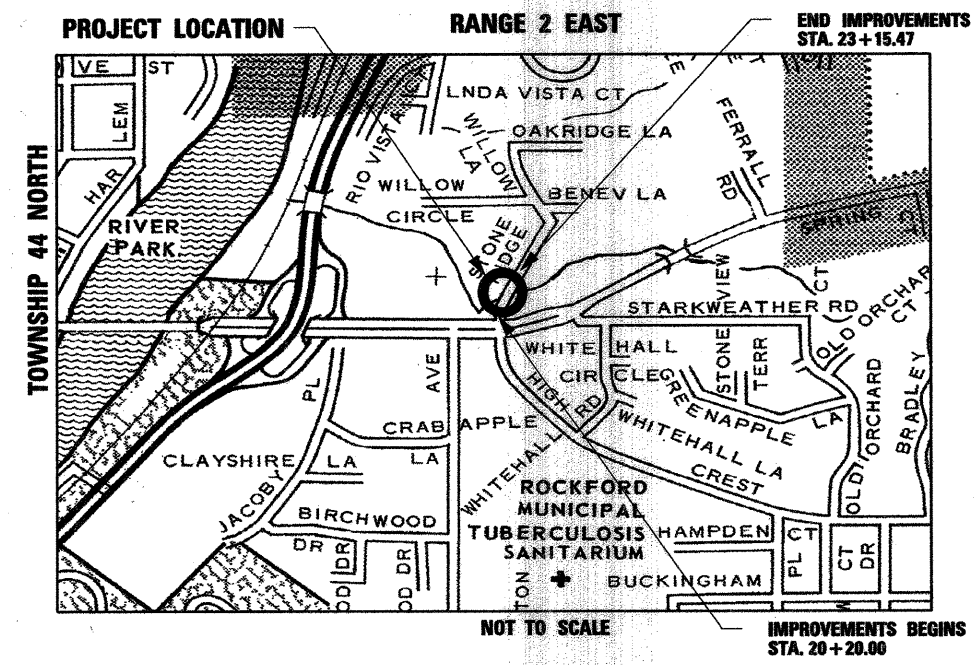

**FUNCTIONAL CLASSIFICATION**  
LOCAL STREET (URBAN)

**DESIGN SPEED**  
STONERIDGE DRIVE: 25 MPH

**TRAFFIC DATA:**  
STONERIDGE DRIVE: ADT=173 (2010)  
ADT=200 (2030)  
1% TRUCKS

**ROCKFORD TOWNSHIP**  
GROSS LENGTH OF IMPROVEMENT = 295 FT. = 0.06 MILES  
NET LENGTH OF IMPROVEMENT = 295 FT. = 0.06 MILES

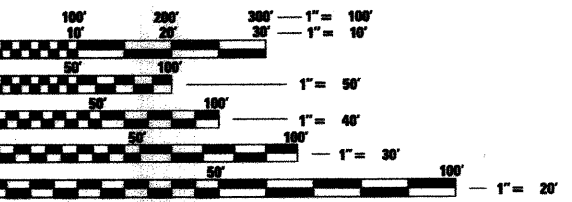

FULL SIZE PLANS HAVE BEEN PREPARED USING STANDARD ENGINEERING SCALES. REDUCED SIZED PLANS WILL NOT CONFORM TO STANDARD SCALES. IN MAKING MEASUREMENTS ON REDUCED PLANS, THE ABOVE SCALES MAY BE USED.

**J.U.L.I.E.**  
JOINT UTILITY LOCATION INFORMATION FOR EXCAVATION  
1-800-892-0123

**CONTRACT NO. 85528**

**ENGINEER AND SURVEYOR:**  
SEC GROUP INC.  
AN HR GREEN COMPANY  
420 NORTH FRONT STREET  
MCHENRY, ILLINOIS 60050-2136  
(815) 385-1778  
CONTACT:  
BOB DAVIES, S.E., P.E. - STRUCTURAL ENGINEER  
KEVIN M. ARFT, P.E. - PROJECT ENGINEER

**STRUCTURAL ENGINEER'S SIGN & SEAL**

ROBERT G. DAVIES, S.E., P.E.  
DATE: Dec. 16, 2010  
NOV. 30, 2012  
EXPIRES

**PROFESSIONAL ENGINEER'S SIGN & SEAL**

KEVIN M. ARFT, P.E.  
DATE: 12/16/10  
EXPIRES: 11/30/11

**PRINTED BY THE AUTHORITY  
OF THE STATE OF ILLINOIS**

**CITY OF ROCKFORD**

APPROVED: *[Signature]* 12-17-10 (DATE)  
CITY OF ROCKFORD, CITY ENGINEER

PASSED: *[Signature]* January 7, 2011 (DATE)  
DISTRICT 2 ENGINEER OF LOCAL ROADS & STREETS

RELEASING FOR BID  
BASED ON LIMITED  
REVIEW: *[Signature]* JAN 7, 2011 (DATE)  
DEPUTY DIRECTOR OF HIGHWAYS, REGION 2 ENGINEER

FEDERAL AID DESIGN ENGINEER: LAURA CONNOLLY (615) 284-2271