

INDEX OF SHEETS

SHEET #	DESCRIPTION
1	COVER SHEET
2-3	GENERAL NOTES, STANDARDS & COMMITMENTS
4-6	CONSTRUCTION SCHEDULE
7-10	SUMMARY OF QUANTITIES
11-15	TYPICAL SECTIONS
16-20	SCHEDULE OF QUANTITIES
21	SITE PLAN
22-25	ALIGNMENT, TIES, AND BENCHMARKS
26-35	ROADWAY PLAN & PROFILE
36-41	CONSTRUCTION STAGING / DETOUR PLAN
42-52	DRAINAGE PLAN & PROFILE
53-63	WATERMAIN PLAN & PROFILE
64-66	GRADING PLANS
67-76	EROSION CONTROL PLANS
77-81	JOINTING PLANS
82-85	ROUNDBOUT INTERSECTION DETAILS
86-91	REMOVAL PLANS
92-98	PAVEMENT MARKING / SIGNING / LANDSCAPING PLANS
99-102	SIGN DETAILS
103-109	CONSTRUCTION DETAILS
110-114	SANITARY SEWER RELOCATION PLANS
115-126	ROADWAY LIGHTING PLANS
127-205	STRUCTURAL PLANS - MORGAN STREET BRIDGE S.N. 101-6108
206-231	CROSS SECTIONS - MORGAN STREET / COLLEGE AVENUE
232-238	CROSS SECTIONS - SEMINARY STREET
239-253	IDOT D2 / CITY STANDARD DRAWINGS

191 OMITTED

INDEX OF HIGHWAY STANDARDS

LIST OF HIGHWAY STANDARDS ON SHEET 2

DESIGN DESIGNATION

DESIGN DESIGNATION
URBAN MINOR ARTERIAL

DESIGN TRAFFIC
MORGAN STREET: 13,700 (YEAR 2031)
COLLEGE AVENUE: 16,000 (YEAR 2031)

DESIGN FUNCTIONAL CLASSIFICATION

MORGAN STREET: MINOR ARTERIAL
COLLEGE AVENUE: MINOR ARTERIAL

DESIGN SPEED
MORGAN STREET: 30 MPH
COLLEGE AVENUE: 30 MPH

J.U.L.I.E.

JOINT UTILITY LOCATION INFORMATION FOR EXCAVATION
1-800-892-0123
OR 811

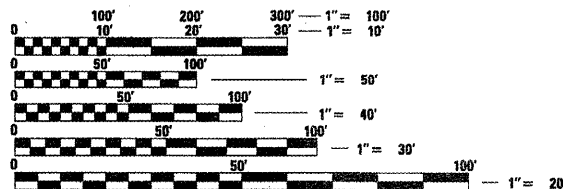

FULL SIZE PLANS HAVE BEEN PREPARED USING STANDARD ENGINEERING SCALES. REDUCED SIZED PLANS WILL NOT CONFORM TO STANDARD SCALES. IN MAKING MEASUREMENTS ON REDUCED PLANS, THE ABOVE SCALES MAY BE USED.

CONTRACT NO. 85529

PRINTED BY THE AUTHORITY OF THE STATE OF ILLINOIS

STATE OF ILLINOIS
CITY OF ROCKFORD

**PROPOSED FEDERAL AID
HIGHWAY PLANS**

**FAU ROUTE 5077 (MORGAN STREET/COLLEGE AVENUE)
ROADWAY AND BRIDGE RECONSTRUCTION
WITH INTERSECTION IMPROVEMENTS**

SECTION 99-00493-00-BR
PROJECT NUMBER: BRM-5099(65)
JOB NUMBER: C-92-073-06
WINNEBAGO COUNTY

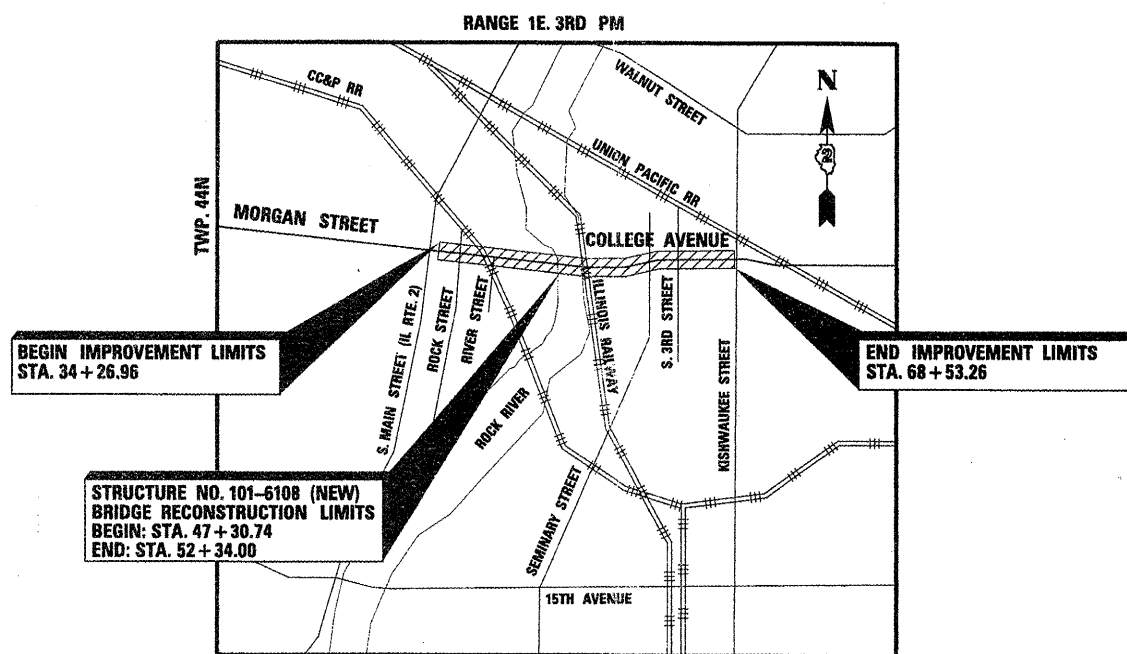

LOCATION MAP

NOT TO SCALE

MORGAN STREET: 1,394.67 L.F. = 0.26 MILES
COLLEGE AVENUE: 1,563.34 L.F. = 0.30 MILES
SEMINARY STREET: 768.30 L.F. = 0.15 MILES
MORGAN STREET BRIDGE: 591.50 L.F. = 0.11 MILES
TOTAL PROJECT LENGTH: 4,317.81 L.F. = 0.82 MILES

"FINAL PLANS"
FEBRUARY 4, 2011

F.A. RTE. 5077	SECTION 99-00493-00-BR	COUNTY WINNEBAGO	TOTAL SHEETS 293	SHEET NO. 1
FED. ROAD DIST. NO. ?	ILLINOIS	CONTRACT NO. 85529		

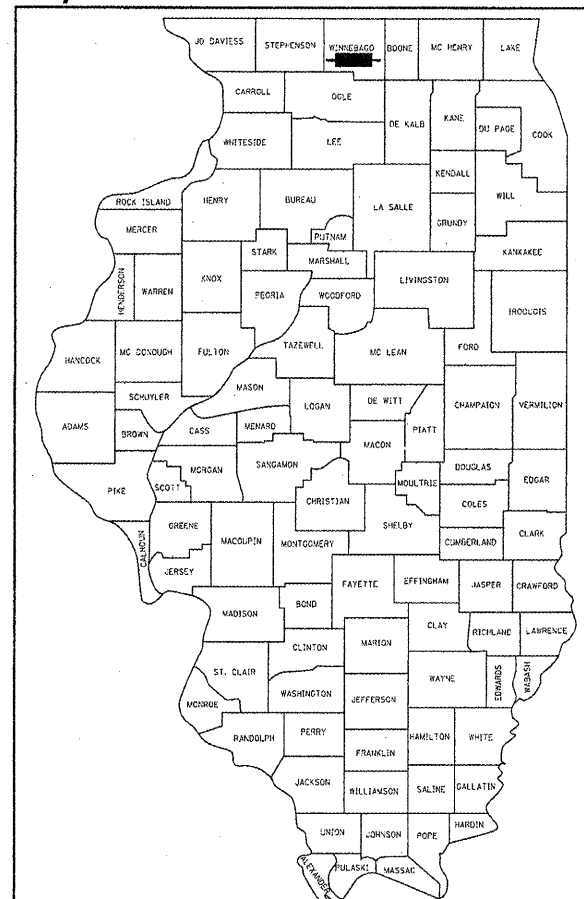

STATE OF ILLINOIS
DEPARTMENT OF TRANSPORTATION
DIVISION OF HIGHWAYS

APPROVED FEB 1, 20 11
John W. Flander
CITY OF ROCKFORD ENGINEER

PASSED March 11, 20 11
John L. Johnson
DISTRICT 2 ENGINEER OF LOCAL ROADS AND STREETS

RELEASING FOR BID BASED ON LIMITED REVIEW
March 11, 20 11
Steve J. Prange
DEPUTY DIRECTOR OF HIGHWAYS, REGION TWO ENGINEER

SIGNATURE: *Steve J. Prange*
DATE SIGNED: JAN. 28, 2011
LICENSE EXPIRATION DATE: Nov. 30, 2011
FOR SHEETS 1-114, 206-253
CMT CRAWFORD, MURPHY & TILLY, INC. CONSULTING ENGINEERS License No. 184-000613

SIGNATURE: *Richard J. Rerhlikar*
DATE SIGNED: Feb. 4, 2011
LICENSE EXPIRATION DATE: Nov. 30, 2012
CMT CRAWFORD, MURPHY & TILLY, INC. CONSULTING ENGINEERS License No. 184-000613

SIGNATURE: *Asad M. Bajwa*
DATE SIGNED: Jan. 28, 2011
LICENSE EXPIRATION DATE: Nov. 30, 2011
FOR SHEETS 115-126
CMT CRAWFORD, MURPHY & TILLY, INC. CONSULTING ENGINEERS License No. 184-000613