

DATE	
BY	
REVISION	
NO.	
PLAN	
NO.	
DATE	
BY	
REVISION	
NO.	

DATE	
BY	
REVISION	
NO.	
PROFILE	
NO.	
DATE	
BY	
REVISION	
NO.	

PROP. CURVE ROCKBOLT1
 PI STA. = 200+25.39
 $\Delta = 20^\circ 08' 10''$ (RT)
 $D = 40^\circ 04' 01''$
 $R = 143.00'$
 $T = 25.39'$
 $L = 50.26'$
 $E = 2.24'$
 $\theta = \dots$
 T.R. = \dots
 S.E. RUN = \dots
 P.C. STA = 200+00.00
 P.T. STA = 200+50.26

PROP. CURVE ROCKBOLT2
 PI STA. = 202+32.84
 $\Delta = 46^\circ 22' 35''$ (RT)
 $D = 179^\circ 02' 58''$
 $R = 32.00'$
 $T = 13.71'$
 $L = 25.90'$
 $E = 2.81'$
 $\theta = \dots$
 T.R. = \dots
 S.E. RUN = \dots
 P.C. STA = 202+19.13
 P.T. STA = 202+45.03

LEGEND:

- 708— PROPOSED GRADING
- EXISTING CONTOURS
- P- PROPERTY LINE
- ||||| EXISTING BUILDING

- NOTES:**
- ROCKFORD BOLT DRIVEWAY TO CONSIST OF:
 PORTLAND CEMENT CONCRETE DRIVEWAY PAVEMENT 8"
 AGGREGATE BASE COURSE, TYPE B, 6"
 - REFER TO SHEET 81 OF THE JOINTING PLANS FOR
 DRIVEWAY JOINT LAYOUT
 - REFER TO TYPICAL SECTIONS FOR DRIVEWAY DETAILS

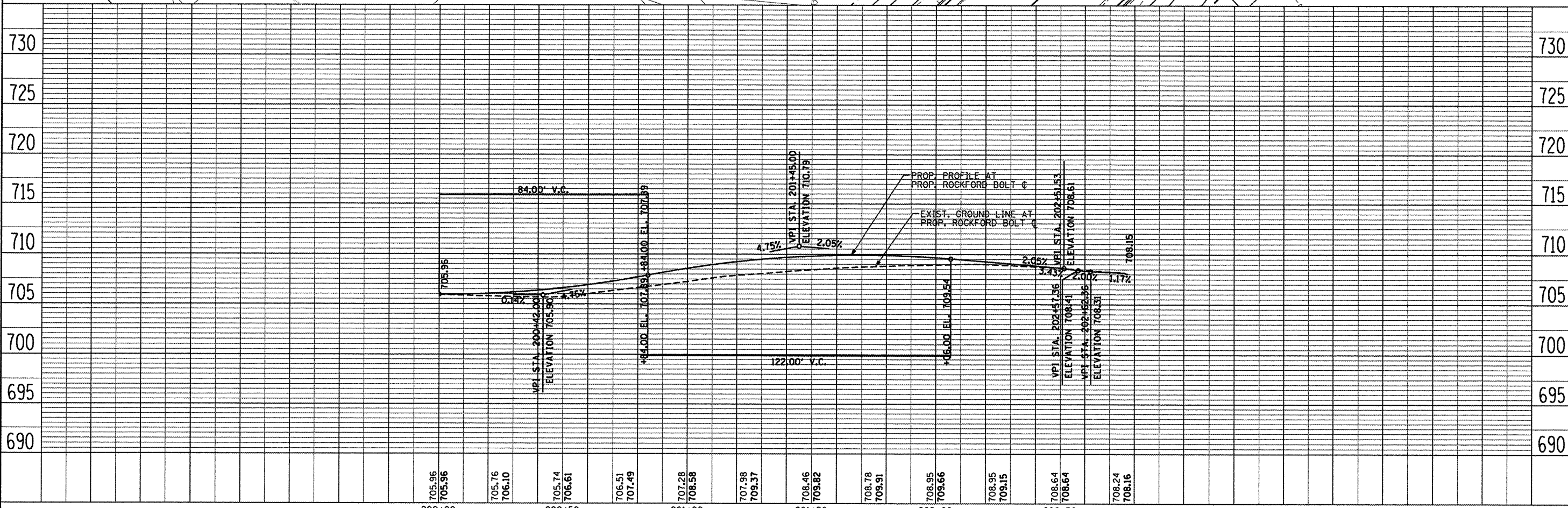
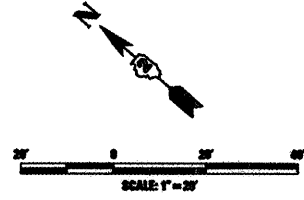

L:\PROJECTS\2008\02\04\000_Sheets\A.PWP_28.ROCK_BOLT.dgn



USER NAME = Steve Prange	DESIGNED SJP / MNB	REVISED -
DRAWN ERD	CHECKED SJP	REVISED -
PLOT SCALE = 40,0000' / IN.	DATE 02/04/2011	REVISED -
PLOT DATE = 02/04/11		

**CITY OF ROCKFORD
 MORGAN STREET BRIDGE**

PROPOSED ROADWAY PLAN & PROFILE ROCKFORD BOLT ACCESS ROAD	
SCALE: 1" = 20'	SHEET NO. 1 OF 1 SHEETS STA. TO STA.

F.A. RTE. 5077	SECTION 99-00493-00-BR	COUNTY WINNEBAGO	TOTAL SHEETS 253	SHEET NO. 35
FED. ROAD DIST. NO. 2 ILLINOIS			CONTRACT NO. 85529	
			FED. AID PROJECT BRN-50991651	