

DATE	
BY	
REVISIONS	
NO.	
DESCRIPTION	
DATE	
BY	
NO.	
DESCRIPTION	
DATE	
BY	
NO.	
DESCRIPTION	
DATE	
BY	
NO.	
DESCRIPTION	

DATE	
BY	
REVISIONS	
NO.	
DESCRIPTION	
DATE	
BY	
NO.	
DESCRIPTION	
DATE	
BY	
NO.	
DESCRIPTION	

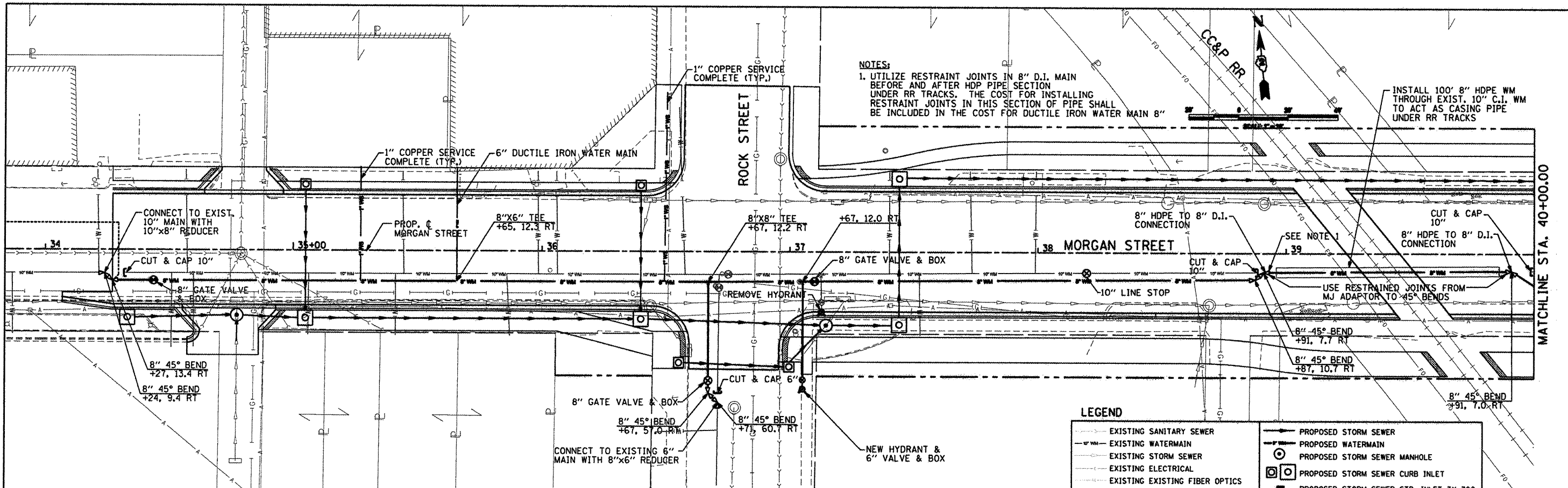

**NOTES:**  
 1. UTILIZE RESTRAINT JOINTS IN 8" D.I. MAIN BEFORE AND AFTER HDP PIPE SECTION UNDER RR TRACKS. THE COST FOR INSTALLING RESTRAINT JOINTS IN THIS SECTION OF PIPE SHALL BE INCLUDED IN THE COST FOR DUCTILE IRON WATER MAIN 8"  
 INSTALL 100' 8" HDPE WM THROUGH EXIST. 10" C.I. WM TO ACT AS CASING PIPE UNDER RR TRACKS

**LEGEND**

	EXISTING SANITARY SEWER		PROPOSED STORM SEWER
	EXISTING WATERMAIN		PROPOSED WATERMAIN
	EXISTING STORM SEWER		PROPOSED STORM SEWER MANHOLE
	EXISTING ELECTRICAL		PROPOSED STORM SEWER CURB INLET
	EXISTING EXISTING FIBER OPTICS		PROPOSED STORM SEWER STD. INLET TY 700
	EXISTING GAS LINE		CUT & CAP
	EXISTING AERIAL ELECTRICAL		CONNECTION
	EXISTING STORM SEWER INLET		FIRE HYDRANT
	EXISTING EXISTING MANHOLE		

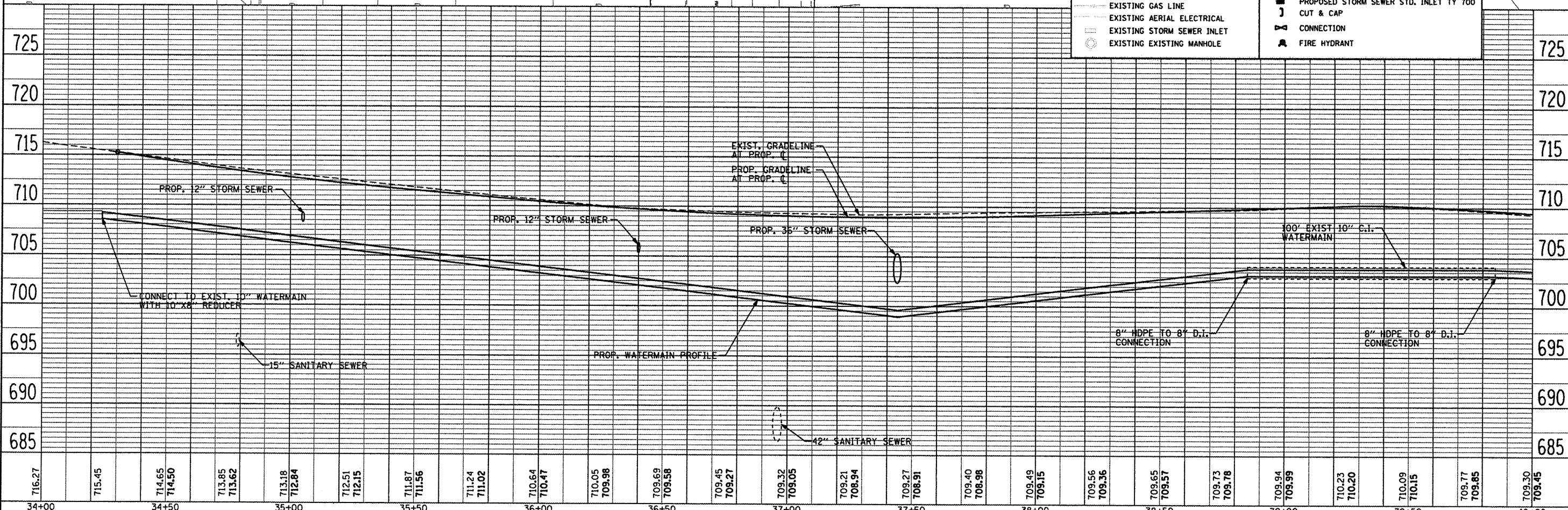

L:\ROCKFORD\0826002\0-00\CORD\_Sheets\A-WATER\_20.Ldg



USER NAME = Steve Prange	DESIGNED SJP / MNB	REVISED -
DRAWN ERD	REVISIONS	
CHECKED SJP	REVISIONS	
DATE 02/04/2011	REVISIONS	

**CITY OF ROCKFORD  
MORGAN STREET BRIDGE**

**PROPOSED WATERMAIN PLAN & PROFILE  
MORGAN STREET / COLLEGE AVENUE**

SCALE: 1" = 20' SHEET NO. 1 OF 11 SHEETS STA. 34+00 TO STA. 40+00

F.A. RTE.	SECTION	COUNTY	TOTAL SHEETS	SHEET NO.
5077	99-00493-00-BR	WINNEBAGO	253	53
FED. ROAD DIST. NO. 2 [ILLINOIS]			CONTRACT NO. 85529	
FED. AID PROJECT BRN-5099651				