

TREE LEGEND	
(A)	REDMOND LINDEN, TILIA AMERICANA, REDMOND
(B)	PRINCETON ELM, ULMUS AMERICANA, PRINCETON
(C)	PATRIOT ELM, ULMUS WILSONIANA, PATRIOT
(D)	SWAMP WHITE OAK, QUERCUS BICOLOR
(E)	CHINKAPIN OAK, QUERCUS MUEHLENBERGII

- NOTES:**
1. ALL PAVEMENT MARKINGS SHALL BE EPOXY UNLESS OTHERWISE NOTED.
 2. PAVEMENT MARKING, INCLUDING LETTERS AND SYMBOLS, SHALL BE PLACED IN ACCORDANCE WITH IDOT DISTRICT 2 STD. 41.1
 3. RAISED REFLECTIVE PAVEMENT MARKERS SHOULD BE PLACED IN ACCORDANCE WITH STD. 781001-03
 4. ALL SIGNS SHOULD BE PLACED BASED ON 2009 MUTCD AND SIZED FOR A MULTI-LANE CONVENTIONAL ROAD.

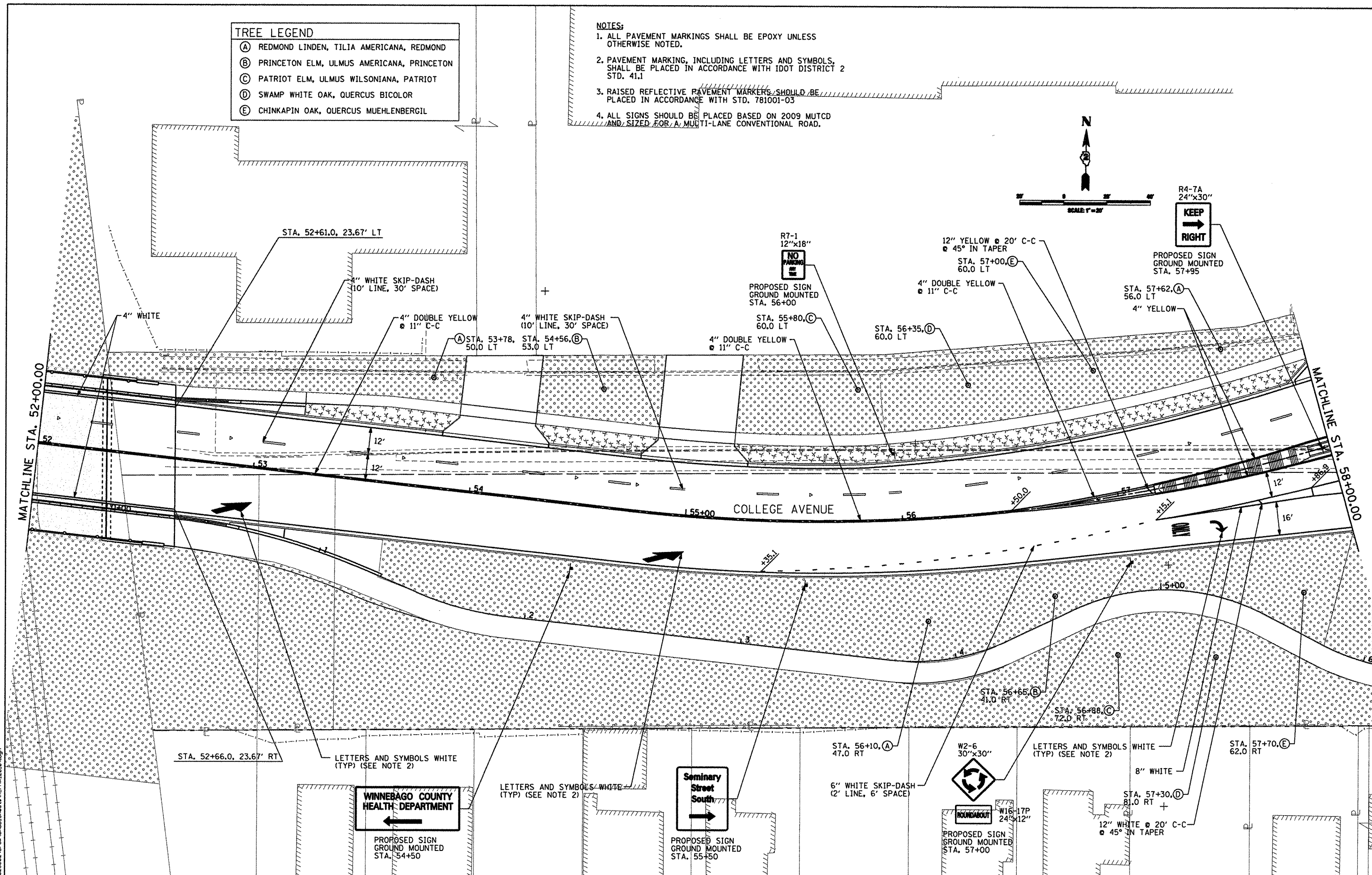
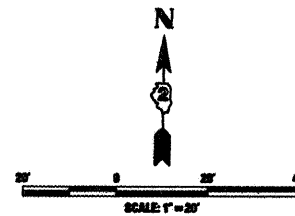

L:\PROJECTS\0822882\Drawings\CADD_Sheets\A1_Plan_20_04.dgn

CMT
 CRAWFORD, MURPHY & TULLY, INC.
 CONSULTING ENGINEERS
 License No. 184-00063

USER NAME = Steve Prange	DESIGNED - SJP / MNB	REVISED -
PLOT SCALE = 40.0000' / IN.	DRAWN - ERD	REVISED -
PLOT DATE = 02/04/11	CHECKED - SJP	REVISED -
	DATE - 02/04/2011	REVISED -

**CITY OF ROCKFORD
 MORGAN STREET BRIDGE**

PAVEMENT MARKING, LANDSCAPING, AND SIGNING PLAN

SCALE:	SHEET NO.	OF	SHEETS	STA.	TO	STA.
--------	-----------	----	--------	------	----	------

F.A. RTE.	SECTION	COUNTY	TOTAL SHEETS	SHEET NO.
5077	99-00493-00-BR	WINNEBAGO	253	95
FED. ROAD DIST. NO. 2 ILLINOIS FED. AID PROJECT BRM-509965			CONTRACT NO. 85529	