

- NOTES:**
1. PROPOSED UTILITY POLE SHALL BE INSTALLED BY COMED. CONTRACTOR SHALL INSTALL CONDUIT, GROUNDING, DISCONNECT ANY SECONDARY CONDUCTORS TO THE UTILITY POLE. COORDINATE ALL WORK WITH COMMONWEALTH EDISON. REFER TO LIGHTING CONTROLLER DETAIL.
  2. PROPOSED ROUTING OF CONDUIT AS SHOWN FOR INFORMATION ONLY. CONTRACTOR SHALL VERIFY EXACT ROUTING IN THE FIELD.
  3. ALL SPLICES SHALL BE HEAT SHRINK AND WATERPROOF, INSTALLED INSIDE POLE BASE OR HANDHOLES. NO DIRECT BURIED SPLICES SHALL BE ALLOWED.
  4. REFER TO IDOT STANDARD 814001-02 FOR HANDHOLE DETAILS.
  5. REFER TO JUNCTION BOX AND PARAPET WALL CONDUIT TRANSITION DETAILS.

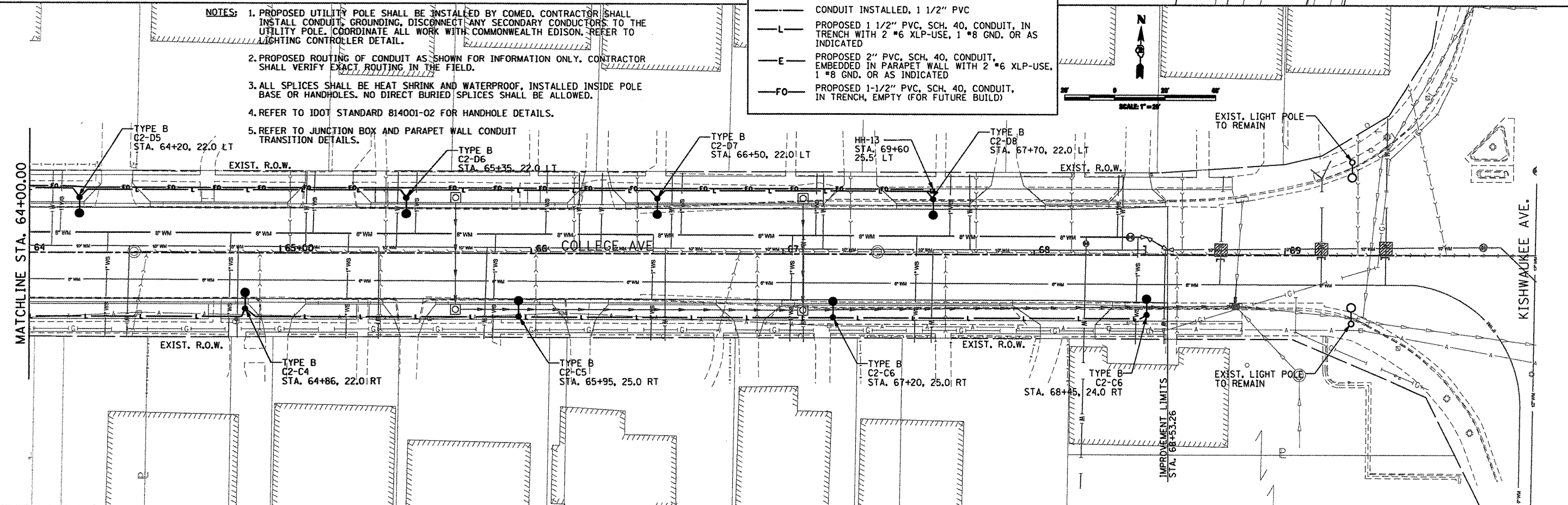

L:\ROCKFORD\982682\0-aa\CAD\Sheet\Lighting\_28.dwg

<p><b>CMT</b> CRANFORD, MURPHY &amp; TILLY, INC. CONSULTING ENGINEERS License No. 054-00065</p>	USER NAME = Steve Prange	DESIGNED - SJP / MMB	REVISED -	<b>CITY OF ROCKFORD</b> <b>MORGAN STREET BRIDGE</b>	<b>ROADWAY LIGHTING PLAN</b> <b>MORGAN STREET / COLLEGE AVENUE</b>		F.A. RTE. 5077	SECTION 99-00493-00-BR	COUNTY WINNEBAGO	TOTAL SHEETS 253	SHEET NO. 117
	PLOT SCALE = 48,0000 / IN.	DRAWN - ERD	REVISED -		SCALE: 1"=20'	SHEET NO. 3 OF 4 SHEETS	STA. 58+00 TO STA.	CONTRACT NO. 85529		FED. ROAD DIST. NO. 2 [ILLINOIS] FED. AID PROJECT BRW-5099651	
	PLOT DATE = 02/04/11	CHECKED - SJP	REVISED -								
		DATE - 02/04/2011	REVISED -								