

**NORTH EDGE OF SLAB**

| Location           | Station  | Offset | Theoretical Grade Elevations |
|--------------------|----------|--------|------------------------------|
| W. End of E. Appr. | 52+30.02 | -33.08 | 735.73                       |
| B1                 | 52+40.02 | -33.08 | 736.00                       |
| B2                 | 52+50.02 | -33.08 | 736.28                       |
| E. End of E. Appr. | 52+60.02 | -33.08 | 736.55                       |

**SOUTH EDGE OF NORTH LANE**

| Location           | Station  | Offset | Theoretical Grade Elevations |
|--------------------|----------|--------|------------------------------|
| W. End of E. Appr. | 52+32.24 | -12.00 | 736.23                       |
| B1                 | 52+42.24 | -12.00 | 736.51                       |
| B2                 | 52+52.24 | -12.00 | 736.78                       |
| E. End of E. Appr. | 52+62.24 | -12.00 | 737.06                       |

**☉ MORGAN ST. & PGL**

| Location           | Station  | Offset | Theoretical Grade Elevations |
|--------------------|----------|--------|------------------------------|
| W. End of E. Appr. | 52+33.50 | 0.00   | 736.46                       |
| B1                 | 52+43.50 | 0.00   | 736.73                       |
| B2                 | 52+53.50 | 0.00   | 737.01                       |
| E. End of E. Appr. | 52+63.50 | 0.00   | 737.28                       |

**NORTH EDGE OF SOUTH LANE**

| Location           | Station  | Offset | Theoretical Grade Elevations |
|--------------------|----------|--------|------------------------------|
| W. End of E. Appr. | 52+34.76 | 12.00  | 736.30                       |
| B1                 | 52+44.76 | 12.00  | 736.58                       |
| B2                 | 52+54.76 | 12.00  | 736.85                       |
| E. End of E. Appr. | 52+64.76 | 12.00  | 737.13                       |

**SOUTH EDGE OF SLAB**

| Location           | Station  | Offset | Theoretical Grade Elevations |
|--------------------|----------|--------|------------------------------|
| W. End of E. Appr. | 52+37.71 | 40.08  | 735.80                       |
| B1                 | 52+47.71 | 40.08  | 736.07                       |
| B2                 | 52+57.71 | 40.08  | 736.35                       |
| E. End of E. Appr. | 52+67.71 | 40.08  | 736.62                       |

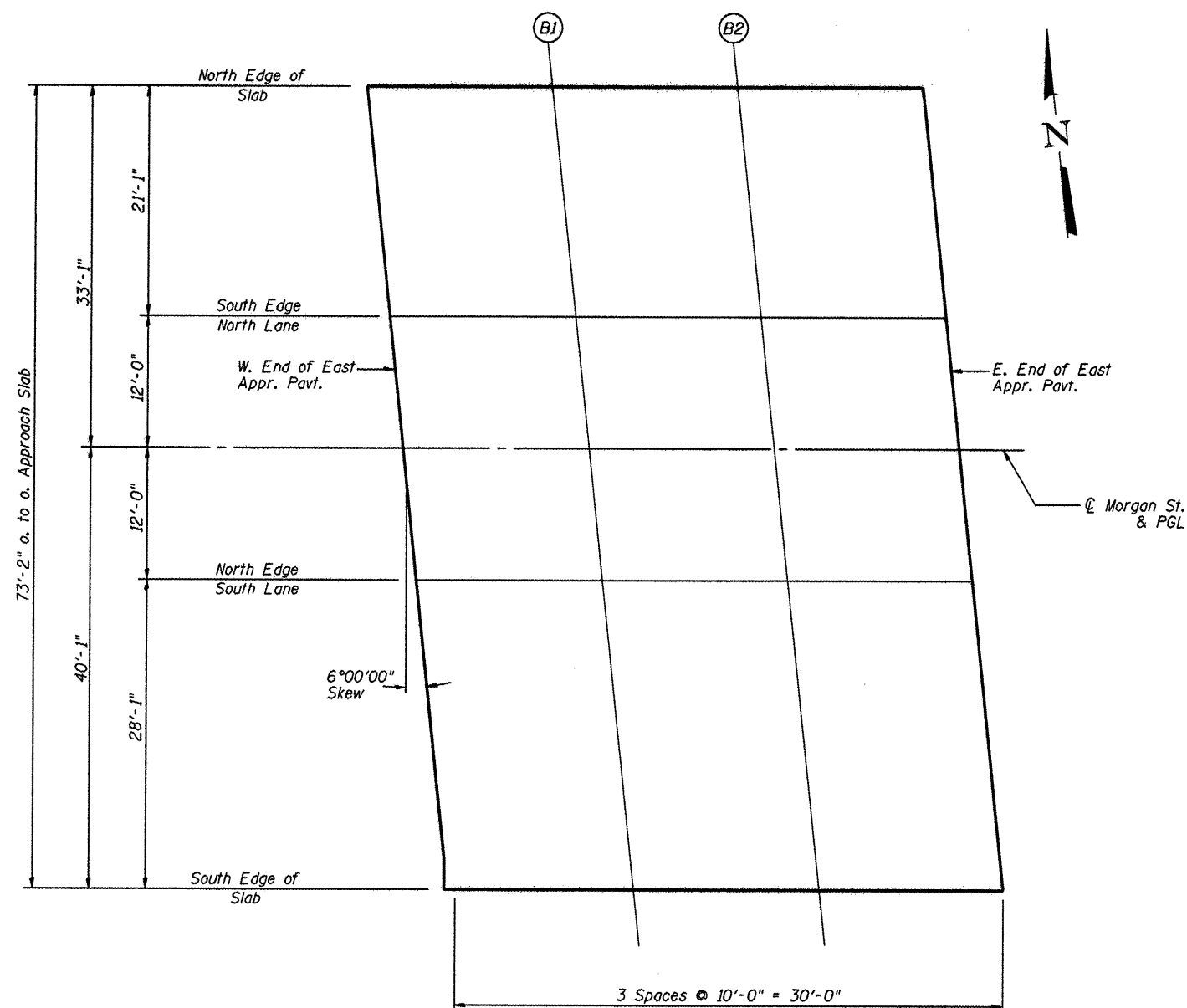

**PLAN - EAST APPROACH**

L:\PROJECTS\101-6108\Drawings\CADD\Sheets\101-6108-APP-SLAB ELEV.dgn



**HNTB**

|                              |           |
|------------------------------|-----------|
| DESIGNED - PA, JDJ, BPD, CJW | REVISED - |
| DRAWN - GLD                  | REVISED - |
| CHECKED - RJK                | REVISED - |
| DATE - 02/04/2011            | REVISED - |

**CITY OF ROCKFORD  
MORGAN STREET BRIDGE**

**EAST BRIDGE APPROACH SLAB ELEVATIONS  
STRUCTURE NO. 101-6108**

SCALE: SHEET NO. 10 OF 79 SHEETS STA. 47+00.74 TO STA. 52+63.50

| F.A.U. RTE.                    | SECTION        | COUNTY    | TOTAL SHEETS       | SHEET NO. |
|--------------------------------|----------------|-----------|--------------------|-----------|
| 5077                           | 99-00493-00-BR | WINNEBAGO | 253                | 136       |
| FED. ROAD DIST. NO. 2 ILLINOIS |                |           | CONTRACT NO. 85529 |           |
| FED. AID PROJECT BRW-5091651   |                |           |                    |           |