

**MIN. BAR LAPS**

#4	=	2'-7"
#5	=	3'-3"
#6	=	3'-10"
#8	=	6'-9"

**PILE DATA**  
 Type: HP 12x53, with Pile Shoes  
 Nominal Required Bearing: 360k  
 Allowable Resistance Available: 120k  
 Est. Length: 55'  
 No. Production Piles: 17  
 No. Test Piles: 1

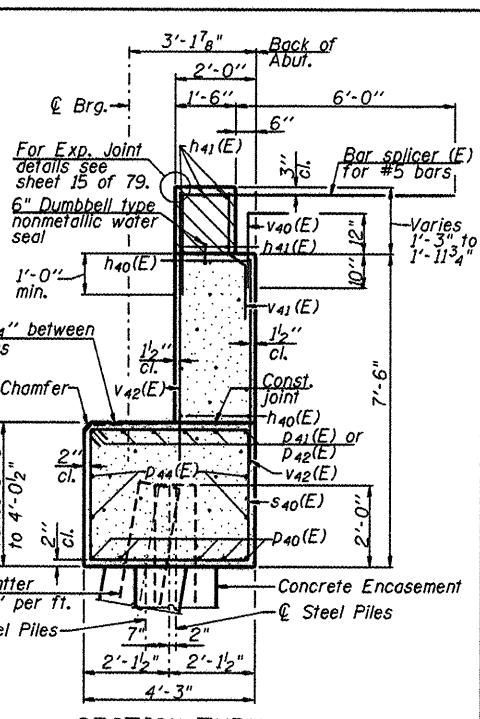
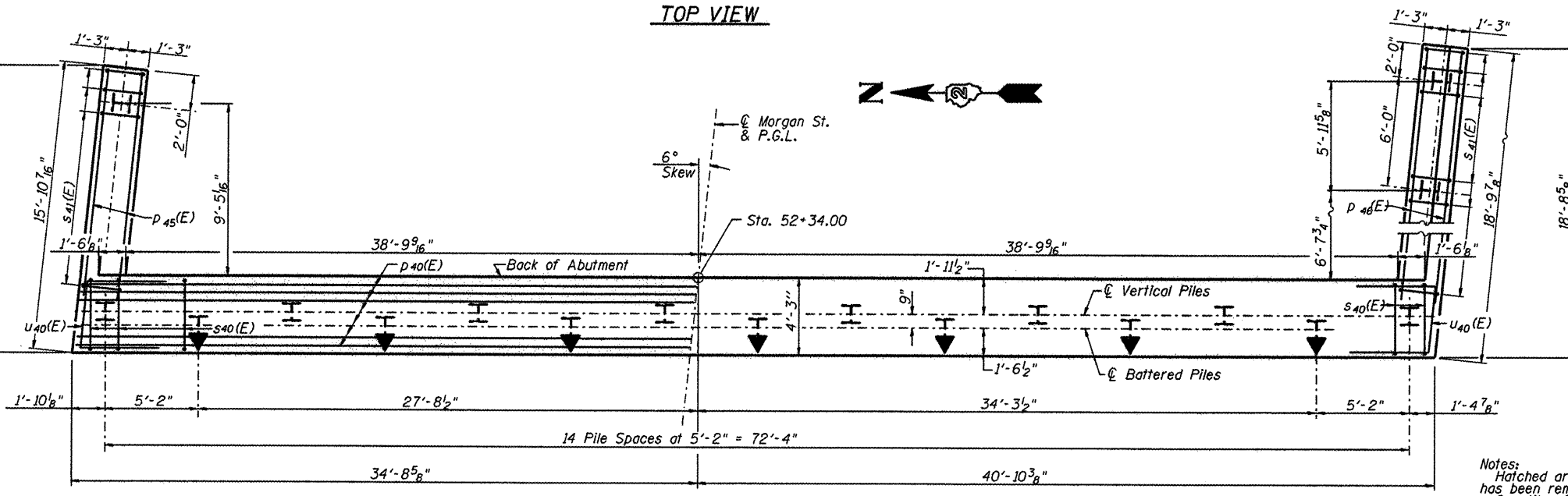
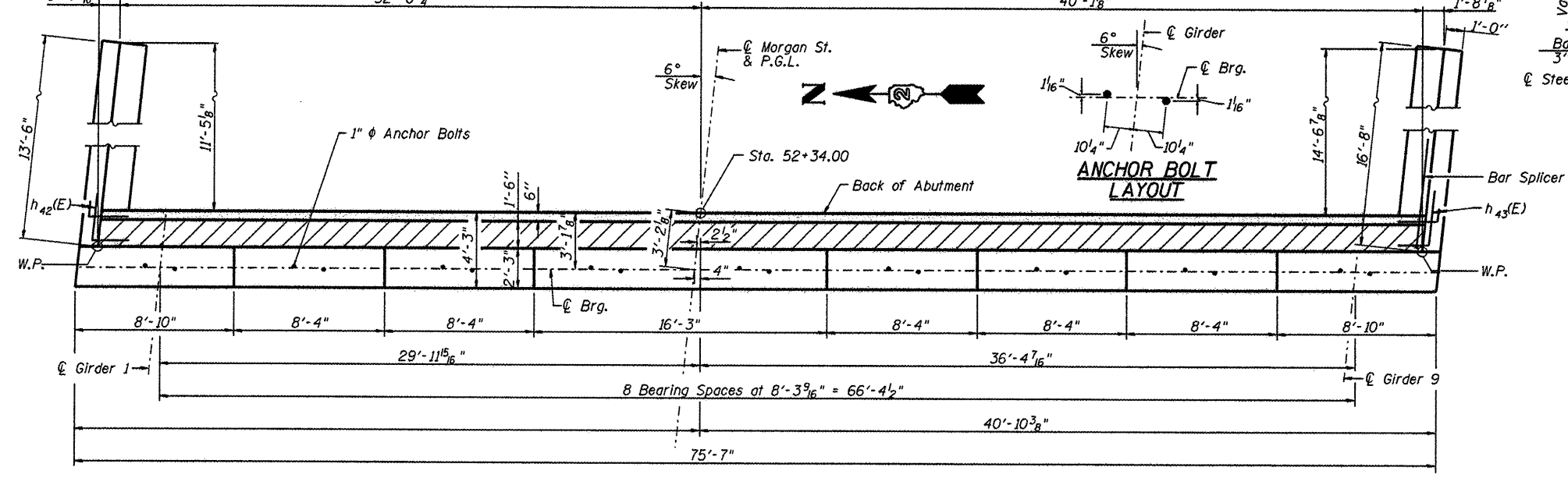

**EAST ABUTMENT BILL OF MATERIAL**

Bar	No.	Size	Length	Shape
h40(E)	20	#5	38'-4"	—
h41(E)	10	#6	38'-7"	—
h42(E)	12	#5	6'-0"	—
h43(E)	12	#5	6'-0"	—
h44(E)	12	#4	13'-2"	—
h45(E)	28	#4	16'-4"	—
n40(E)	31	#6	13'-7"	—
D40(E)	12	#8	42'-0"	—
D41(E)	6	#8	44'-0"	—
D42(E)	6	#8	37'-11"	—
D43(E)	6	#5	32'-7"	—
D44(E)	8	#4	38'-11"	—
D45(E)	6	#7	13'-0"	—
D46(E)	6	#7	16'-2"	—
s40(E)	88	#4	14'-11"	—
s41(E)	29	#4	9'-5"	—
s42(E)	33	#4	7'-11"	—
u40(E)	8	#6	9'-10"	—
v40(E)	74	#5	3'-9"	—
v41(E)	74	#4	3'-7"	—
v42(E)	148	#6	6'-9"	—
v43(E)	62	#6	5'-3"	—
Bar Splicers	Each		74	
Concrete Structures	Cu. Yd.		78.6	
Reinforcement Bars, Epoxy Coated	Pound		9,640	
Furnishing Steel Piles HP 12x53	Foot		935	
Driving Piles	Foot		935	
Test Pile Steel HP 12x53	Each		1	
Concrete Encasement	Cu. Yd.		6.3	
Concrete Sealer	Sq. Ft.		888	
Pile Shoes	Each		18	
Protective Coat	Sq. Yd.		34	

For details of Bar Splicers, see sheet 76 of 79.  
 For details of piles and Concrete Encasement, see sheet 75 of 79.

Notes:  
 Hatched area to be poured after superstructure false work has been removed.  
 Quantity of concrete included with Concrete Superstructure.  
 Space reinforcement in cap to miss anchor bolts.  
 Four steps monolithically with cap.  
 Quantity of concrete in end post included with Concrete Superstructure.

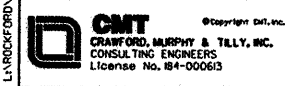

**HNTB**

DESIGNED - PA, JJJ, BPD, CJW	REVISED -
DRAWN - GLD	REVISED -
CHECKED - RJK	REVISED -
DATE - 02/04/2011	REVISED -

**CITY OF ROCKFORD  
 MORGAN STREET BRIDGE**

**EAST ABUTMENT  
 STRUCTURE NO. 101-6108**

SCALE: SHEET NO. 67 OF 79 SHEETS STA. 47+00.74 TO STA. 52+63.50

F.A.U. RTE.	SECTION	COUNTY	TOTAL SHEETS	SHEET NO.
5077	99-00493-00-BR	WINNEBAGO	253	193

CONTRACT NO. 85529  
 FED. ROAD DIST. NO. 2 ILLINOIS FED. AID PROJECT BRM-5099651