

DATE	
BY	
SURVEYED	
PLOTTED	
TEMPLATE	
AREAS	
CHECKED	
NO.	

DATE	
BY	
SURVEYED	
PLOTTED	
TEMPLATE	
AREAS	
CHECKED	
NO.	

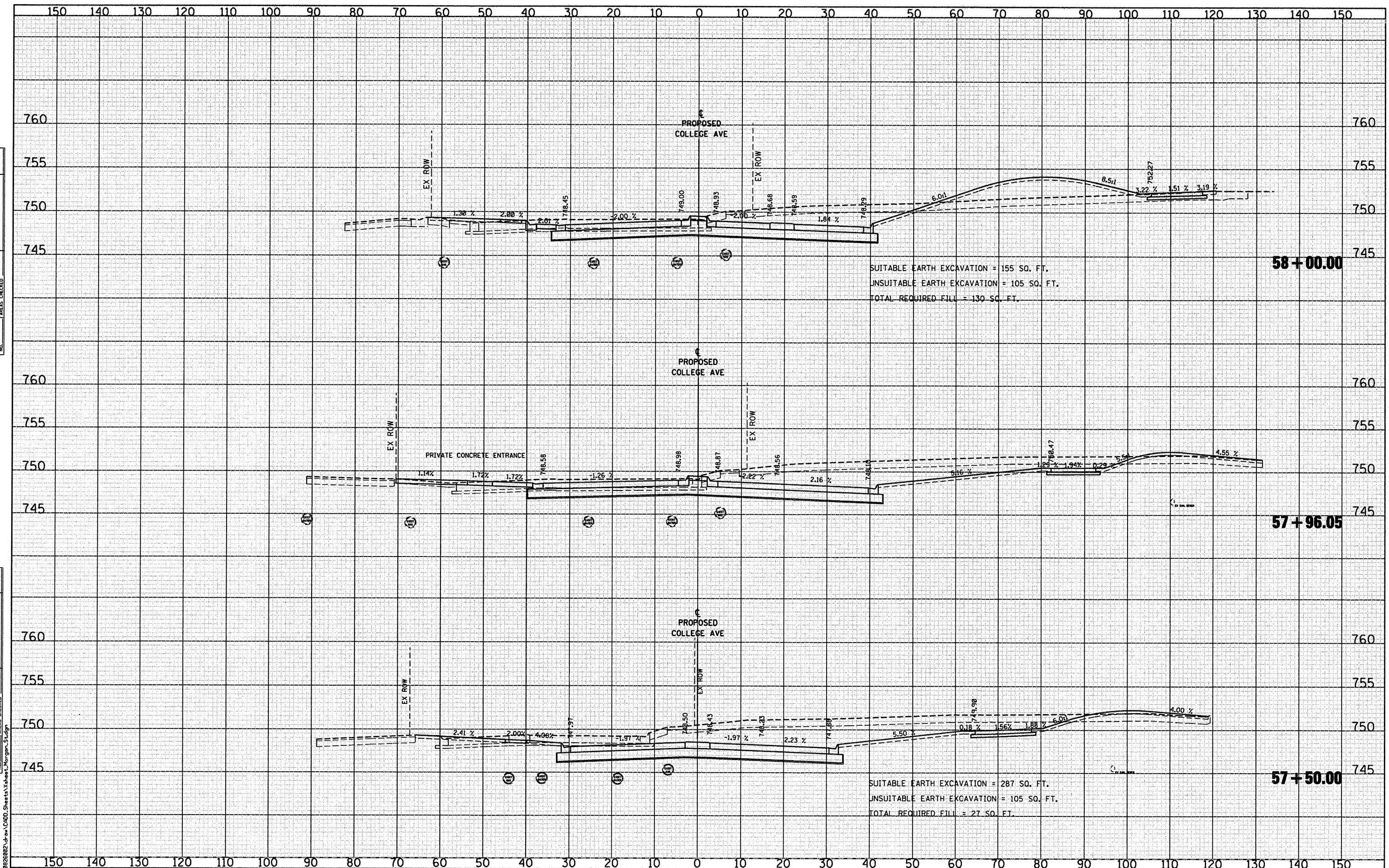

SUITABLE EARTH EXCAVATION = 155 SQ. FT.  
 UNSUITABLE EARTH EXCAVATION = 105 SQ. FT.  
 TOTAL REQUIRED FILL = 130 SQ. FT.

SUITABLE EARTH EXCAVATION = 287 SQ. FT.  
 UNSUITABLE EARTH EXCAVATION = 105 SQ. FT.  
 TOTAL REQUIRED FILL = 27 SQ. FT.



USER NAME = Steve Prange	DESIGNED - SJP / MNB	REVISED -
PLOT SCALE = 20,0000' / IN.	DRAWN - ERD	REVISED -
PLOT DATE = 02/04/11	CHECKED - SJP	REVISED -
	DATE - 02/04/2011	REVISED -

**CITY OF ROCKFORD  
 MORGAN STREET BRIDGE**

<b>PROPOSED CROSS SECTIONS - COLLEGE AVENUE</b>			
SCALE:	SHEET NO. OF SHEETS	STA. 57+50.00 TO STA. 58+00.00	

F.A. RTE.	SECTION	COUNTY	TOTAL SHEETS	SHEET NO.
5077	99-00493-00-BR	WINNEBAGO	253	221
FED. ROAD DIST. NO. 2 [ILLINOIS] FED. AID PROJECT BRM-5099651			CONTRACT NO. 85529	