

INDEX OF SHEETS

- 1 = COVER SHEET
- 2 = SUMMARY OF QUANTITIES
- 3 = GENERAL NOTES & SCHEDULES
- 4 = TYPICAL SECTIONS
- 5-7 = PLAN AND PROFILE
- 8-9 = EROSION CONTROL PLAN
- 10 = GENERAL PLAN & ELEVATION
- 11 = RIPRAP & PILE LAYOUT
- 12 = TOP OF SLAB ELEVATIONS
- 13-14 = TOP OF SOUTH & NORTH BRIDGE APPROACH SLAB ELEVATIONS
- 15 = FRAMING PLAN
- 16 = SUPERSTRUCTURE DETAILS
- 17 = INTEGRAL ABUTMENT DIAPHRAGM DETAILS
- 18 = BRIDGE APPROACH SLAB DETAILS
- 19 = SOUTH ABUTMENT DETAILS
- 20 = SOUTH ABUTMENT SHEET PILE LAYOUT
- 21 = NORTH ABUTMENT DETAILS
- 22 = NORTH ABUTMENT SHEET PILE LAYOUT
- 23 = STEEL RAILING, TYPE SM DETAILS
- 24 = BAR SPLICER ASSEMBLY AND MECHANICAL SPLICER DETAILS
- 25 = METAL SHELL PILE DETAILS
- 26 = BORING LOGS
- 27-31 = CROSS SECTIONS

STANDARDS

- 000001-06 STANDARD SYMBOLS, ABBREVIATIONS, AND PATTERNS
- 280001-05 TEMPORARY EROSION CONTROL SYSTEMS
- 420401-08 BRIDGE APPROACH PAVEMENT CONNECTOR
- 515001-03 NAME PLATE FOR BRIDGES
- 542401-01 METAL END SECTION FOR PIPE CULVERTS
- 601001-04 SUB-SURFACE DRAINS
- 601101-01 CONCRETE HEADWALL FOR PIPE DRAIN
- 630001-09 STEEL PLATE BEAM GUARDRAIL
- 630301-05 SHOULDER WIDENING FOR TYPE 1 (SPECIAL) GUARDRAIL TERMINALS
- 631032-06 TRAFFIC BARRIER TERMINAL, TYPE 6A
- 635006-03 REFLECTOR AND TERMINAL MARKER PLACEMENT
- 635011-02 REFLECTOR MARKER AND MOUNTING DETAILS
- 701901-01 TRAFFIC CONTROL DEVICES
- 720011-01 METAL POSTS FOR SIGNS, MARKERS & DELINEATORS
- 728001-01 TELESCOPING STEEL SIGN SUPPORT
- 729001-01 APPLICATIONS OF TYPE A & B METAL POSTS (FOR SIGNS & MARKERS)
- BLR21-8 TYPICAL APPLICATION OF TRAFFIC CONTROL DEVICES FOR CONSTRUCTION ON RURAL LOCAL HIGHWAYS
- BLR22-6 TYPICAL APPLICATION OF TRAFFIC CONTROL DEVICES FOR CONSTRUCTION ON RURAL LOCAL HIGHWAYS
- BLR24-2 MAILBOX TURNOUT FOR LOCAL ROADS

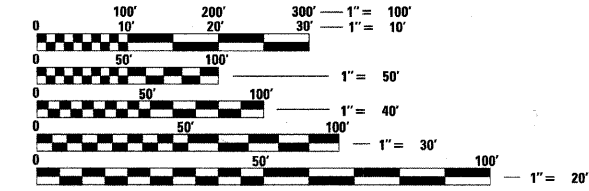

FULL SIZE PLANS HAVE BEEN PREPARED USING STANDARD ENGINEERING SCALES. REDUCED SIZED PLANS WILL NOT CONFORM TO STANDARD SCALES. IN MAKING MEASUREMENTS ON REDUCED PLANS, THE ABOVE SCALES MAY BE USED.

J.U.L.I.E.
JOINT UTILITY LOCATION INFORMATION FOR EXCAVATION
 1-800-892-0123
 OR 811

PROJECT ENGINEER - MCW
PROJECT MANAGER - BKC
CONTRACT NO. 87462

PROPOSED STRUCTURE: S.N. 006-3032
 A SINGLE SPAN (1@98'-6") STEEL PLATE GIRDER BRIDGE ON CLOSED STEEL SHEET PILE ABUTMENTS @ STA. 59+75. SKEWED 30° RT. AHEAD.

UTILITIES:
 VERIZON (FRONTIER COM.)
 Attn: Garrett Burt
 112 Elm Street
 Sycamore, IL 60178
 815-895-1538
 AMEREN IP
 Attn: Martin Fuller
 1050 W. Blvd.
 Belleville, IL 62222
 618-236-6281

FUNCTIONAL CLASSIFICATION
MAJOR COLLECTOR (NON-URBAN)
DESIGN SPEED 50 MPH
2011 ADT - 850
3R GUIDELINES

STATE OF ILLINOIS
DEPARTMENT OF TRANSPORTATION
DIVISION OF HIGHWAYS

PLANS FOR PROPOSED
FEDERAL AID PROJECT
HIGHWAY BRIDGE PROGRAM

FAS ROUTE 184 (COUNTY HIGHWAY 11)
SECTION 08-00211-00-BR
PROJECT BRS-0184(107)
STRUCTURE REPLACEMENT
BUREAU COUNTY

C-93-096-10

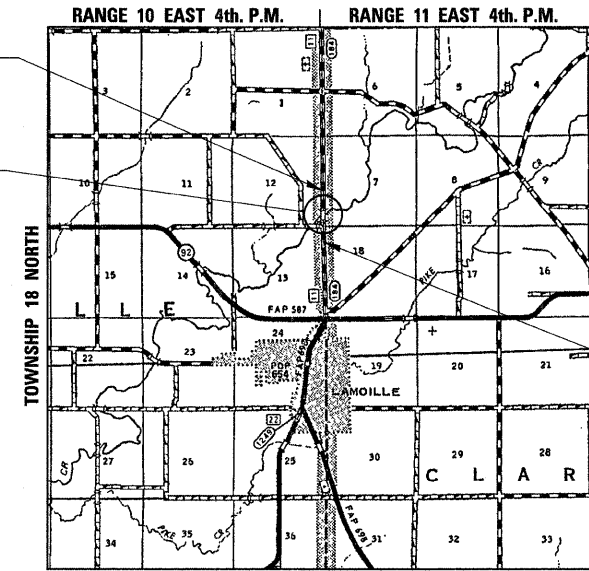

GROSS LENGTH = 1,100 FT. = 0.208 MILE
 NET LENGTH = 1,100 FT. = 0.208 MILE

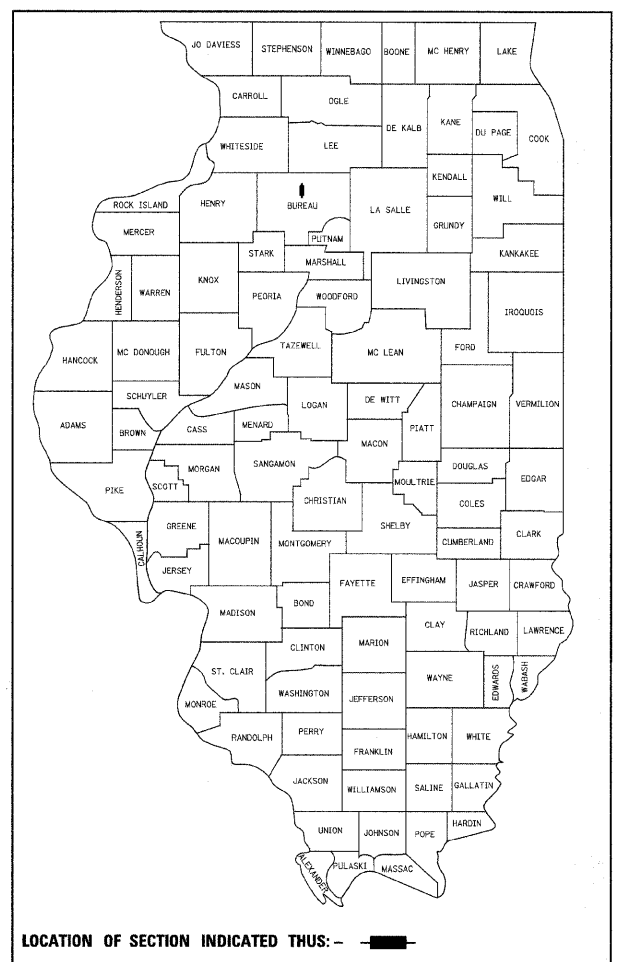

LOCATION OF SECTION INDICATED THUS: - ■ -

BUREAU COUNTY HIGHWAY DEPARTMENT	
APPROVED	2011
<i>John E. Hagan</i> BUREAU COUNTY ENGINEER	
PASSED	2011
<i>James R. Threlkeld</i> DISTRICT 3 PROJECT IMPLEMENTATION ENGINEER	
RELEASING FOR BID BASED ON LIMITED REVIEW	2011
<i>Eric S. Threlkeld</i> DEPUTY DIRECTOR OF HIGHWAYS, REGION 2 ENGINEER	

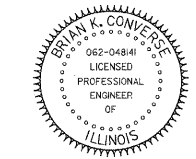

Brian K. Convent
 DATE: 2/15/2011
 EXPIRES 11/30/11

WILLETT, HOFMANN & ASSOCIATES, INC.
CONSULTING ENGINEERS
 Land Surveying - Transportation - Structural
 Environmental - Architecture
 809 East Second Street Dixon, Illinois 61021
 Phone 815.284.3381 Fax 815.284.3385
 Design Firm #184-000918
 www.willetthofmann.com

FILE NAME = SANPROJECTS\2010\08\01\010_Bureau.CH11\DESIGN\STRUCTURE\Drawings\10510102Cover.dgn