

Bench Mark 402: Railroad Spike in 3rd Power Pole North of Structure
 36' Lt. of Sta. 65+36
 El. 786.16

PROP. CURVE CH11CURVE2
 PI STA. = 65+70.62
 $\Delta = 2^\circ 03' 33''$ (LT)
 $D = 0^\circ 21' 29''$
 $R = 16,000.00'$
 $T = 287.54'$
 $L = 575.03'$
 $E = 2.58'$
 $e = NC$
 $T.R. = N/A$
 $S.E. RUN = N/A$
 $P.C. STA = 62+83.08$
 $P.T. STA = 68+58.10$

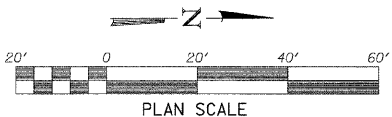

FILE NAME = S:\PROJECTS\2010\081010_Bureau.CH11\051PPCH11.dgn

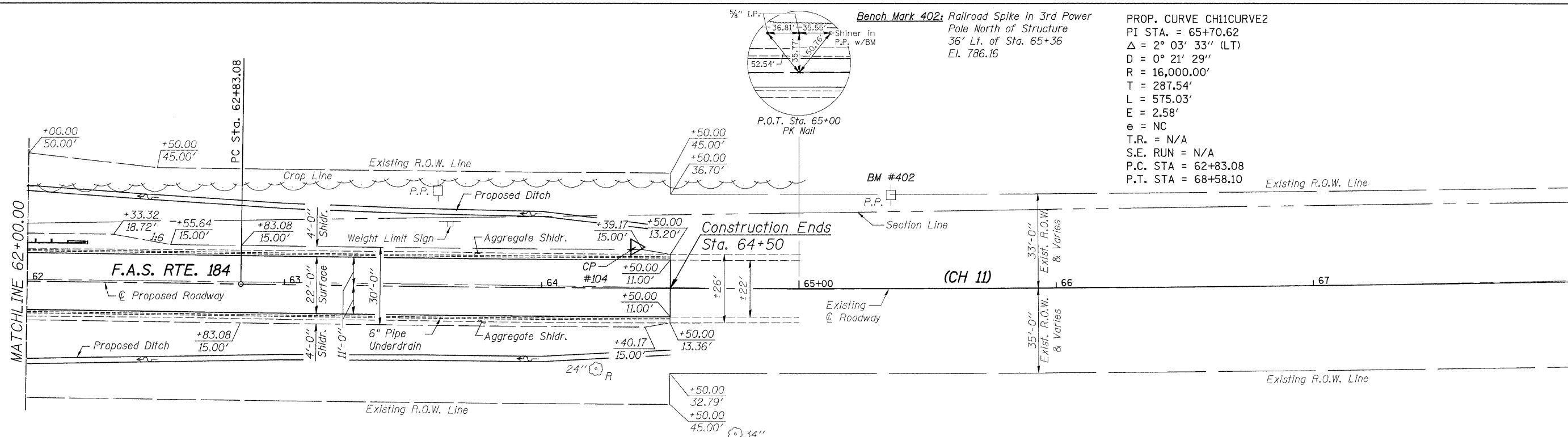
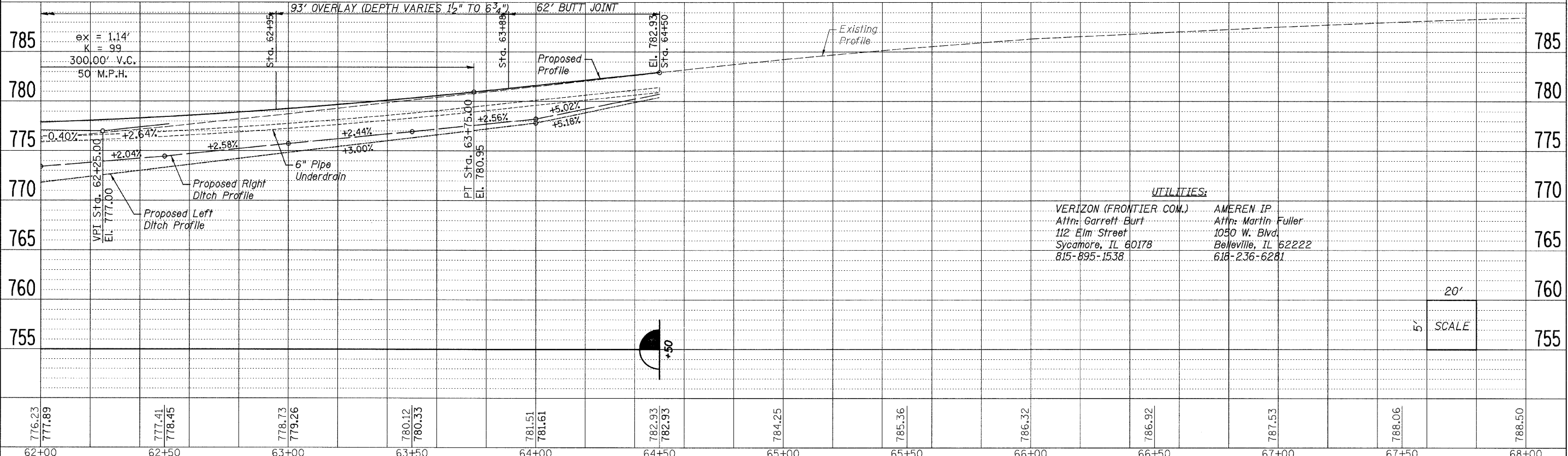

UTILITIES:
 VERIZON (FRONTIER COM.) Attn: Garrett Burt
 112 Elm Street
 Sycamore, IL 60178
 815-895-1538
 AMEREN IP Attn: Martin Fuller
 1050 W. Blvd
 Belleville, IL 62222
 618-236-6281

USER NAME =	DESIGNED - M. A. CACKLEY	REVISED -
PLDT SCALE =	CHECKED - B. K. CONVERSE	REVISED -
PLDT DATE =	DRAWN - F. D. LACHAT	REVISED -
	CHECKED - M. C. WAGNER	REVISED -

BUREAU COUNTY
F.A.S. 184 (C.H. 11) OVER BIG BUREAU CREEK
STATION 59 + 75

PLAN & PROFILE
STRUCTURE NO. 006-3032
 STA. 62+00 TO STA. 68+00

F.A.S. RTE. 184	SECTION 08-00211-00-BR	COUNTY BUREAU	TOTAL SHEETS 31	SHEET NO. 7
WHA# 1051D10		CONTRACT NO. 87462		
ILLINOIS FED. AID PROJECT BRS-0184107				