

DATE	
BY	
SURVEYED	
TEMPLATE	
AREAS CHECKED	
FINAL SURVEY	
NOTE BOOK	
NO.	

DATE	
BY	
SURVEYED	
TEMPLATE	
AREAS CHECKED	
ORIGINAL SURVEY	
NOTE BOOK	
NO.	

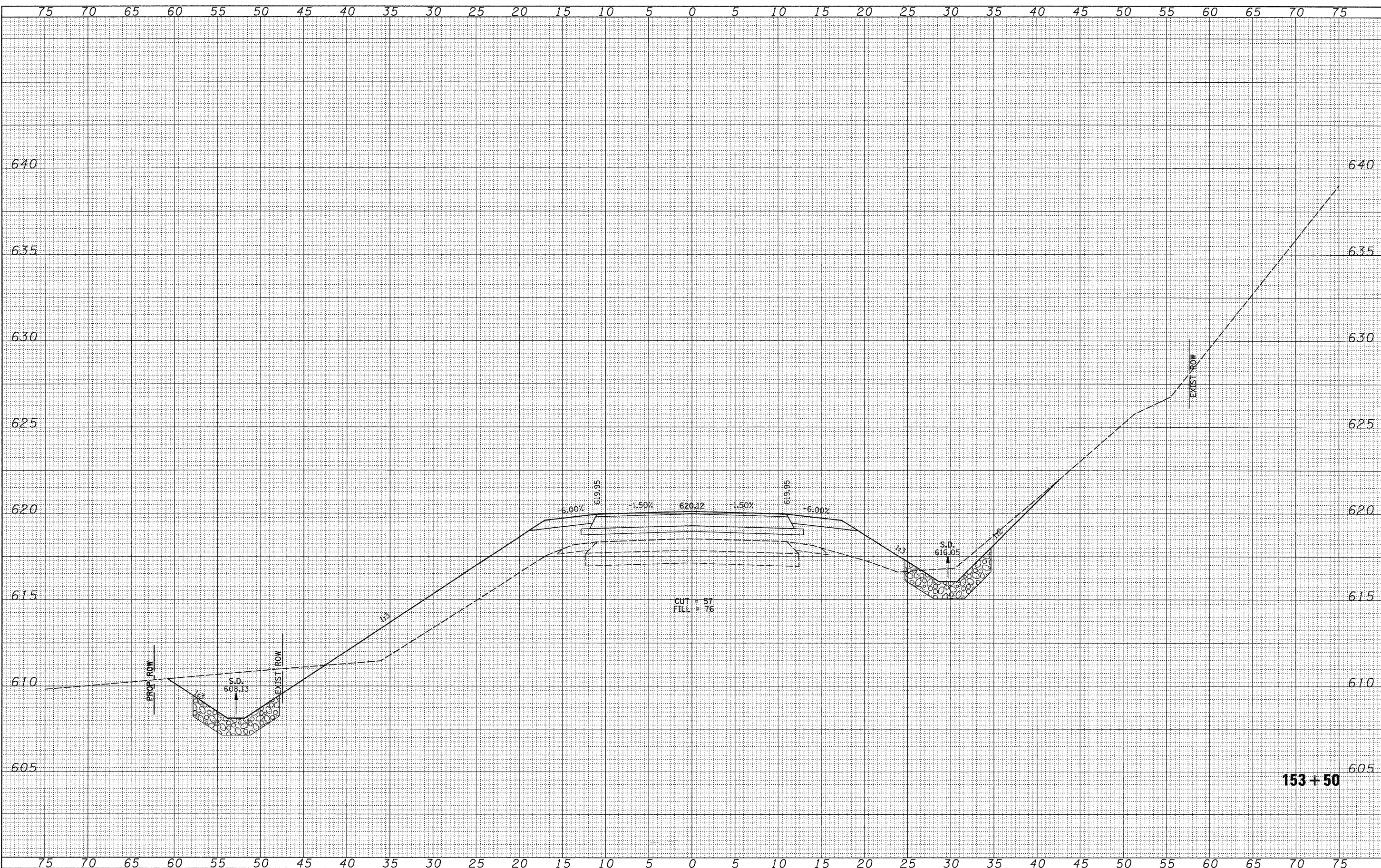

FILE NAME =  
 V:\Bridge\2484-Morgan\2484xhta2.dgn

USER NAME = othomes	DESIGNED -	REVISED -
	DRAWN -	REVISED -
PLOT SCALE = 5.0000' / IN.	CHECKED -	REVISED -
PLOT DATE = 1/6/2011	DATE -	REVISED -

**MORGAN COUNTY  
 COUNTY HIGHWAY 28  
 OVER HENRY CREEK**

**CROSS SECTIONS**

SCALE: HORIZ: 1"=50'  
 VERT: 1"=2.5'  
 SHEET NO. 8 OF 28 SHEETS  
 STA. 153+50 TO STA. 153+50

F.A.S. R.T.E.	SECTION	COUNTY	TOTAL SHEETS	SHEET NO.
609	07-00099-00-BR	MORGAN	48	28
CONTRACT NO. 93545				
FED. ROAD DIST. NO. 7 ILLINOIS FED. AID PROJECT BRS-06091091				