

DATE	
BY	
SURVEYED	
PLANNED	
NOTE BOOK	
AREAS CHECKED	
NO.	

DATE	
BY	
SURVEYED	
PLANNED	
NOTE BOOK	
AREAS CHECKED	
NO.	

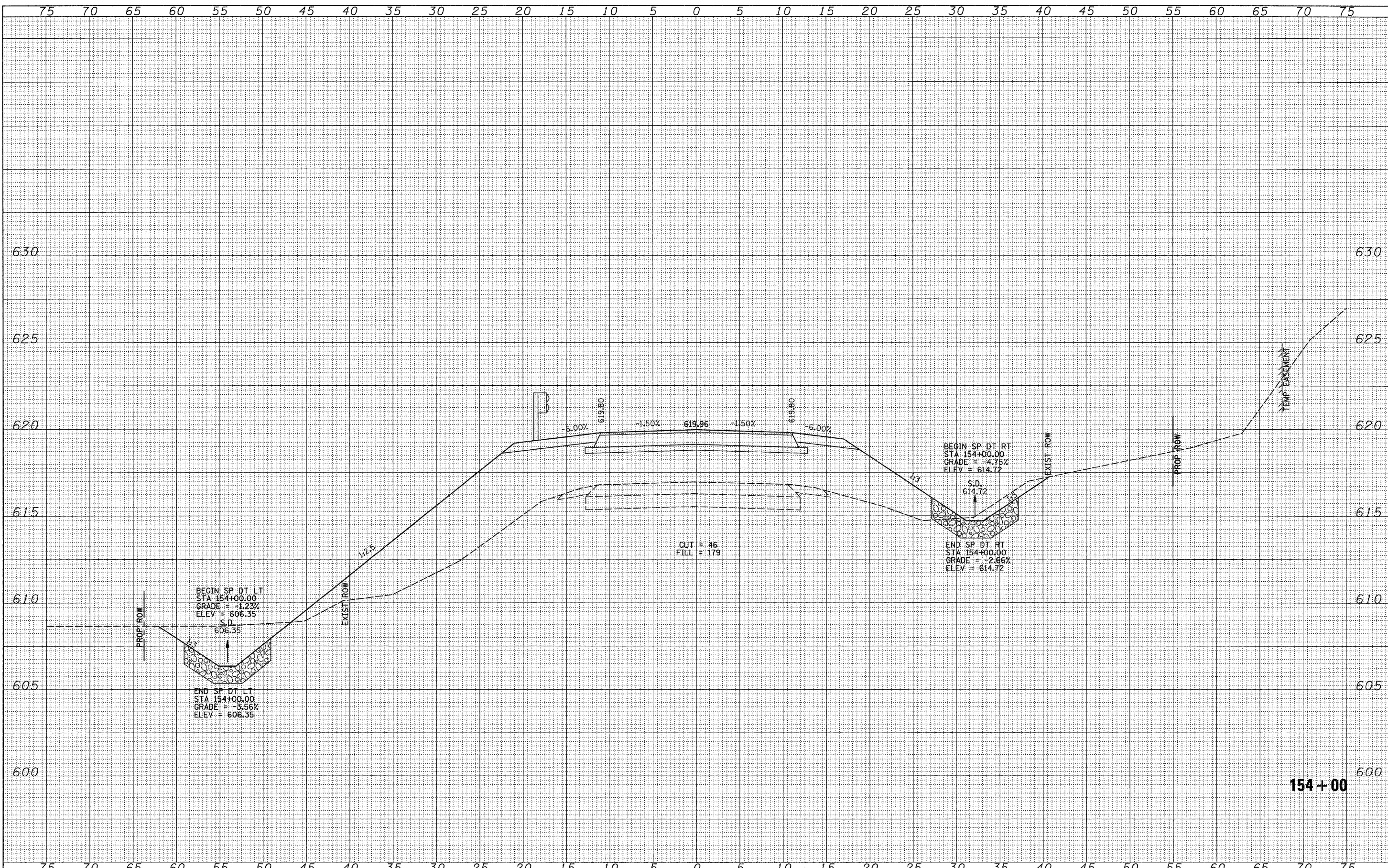

FILE NAME =	USER NAME = cthomas	DESIGNED -	REVISED -	MORGAN COUNTY COUNTY HIGHWAY 28 OVER HENRY CREEK	CROSS SECTIONS		F.A.S. RTE.	SECTION	COUNTY	TOTAL SHEETS	SHEET NO.	
V:\Bridges\2484-Morgan\2484\aha2a2.dgn		DRAWN -	REVISED -		609	07-00099-00-BR	MORGAN	48	29			
		CHECKED -	REVISED -		SCALE: HORIZ: 1"=50', VERT: 1"=5.0'		SHEET NO. 9 OF 28 SHEETS		STA. 154+00 TO STA. 154+00		CONTRACT NO. 09545	
		DATE -	REVISED -		FED. ROAD DIST. NO. 7 ILLINOIS		FED. AID PROJECT BRS-06091091					