

DATE	
BY	
SURVEYED	
PLOTTED	
DATE	
NOTE BOOK	
NO.	
AREAS CHECKED	

DATE	
BY	
SURVEYED	
PLOTTED	
DATE	
NOTE BOOK	
NO.	
AREAS CHECKED	

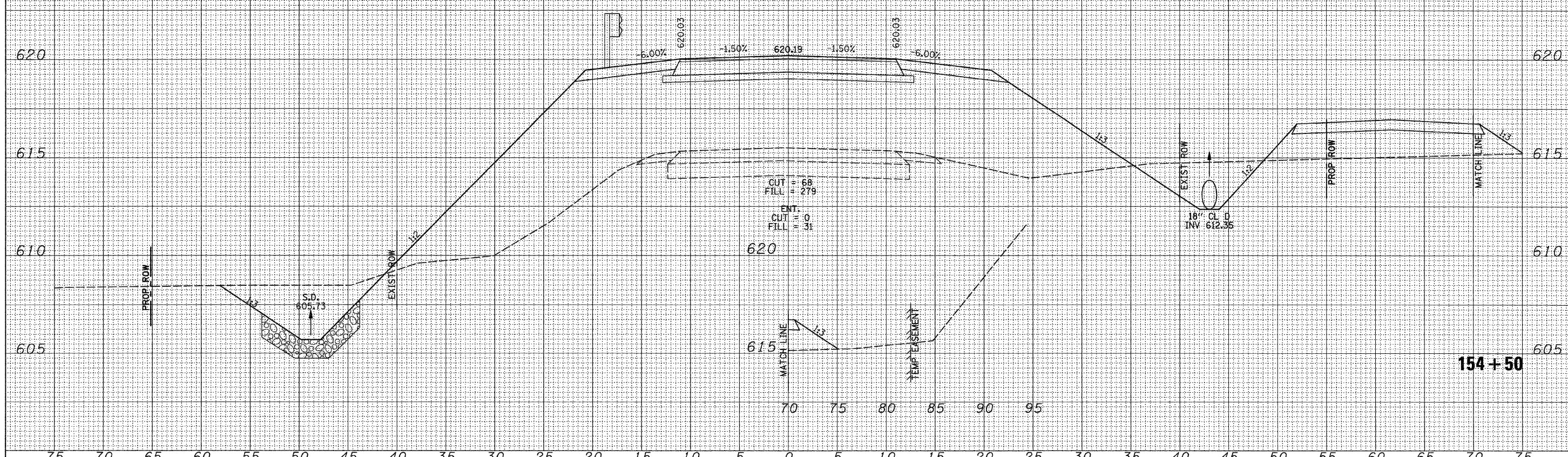
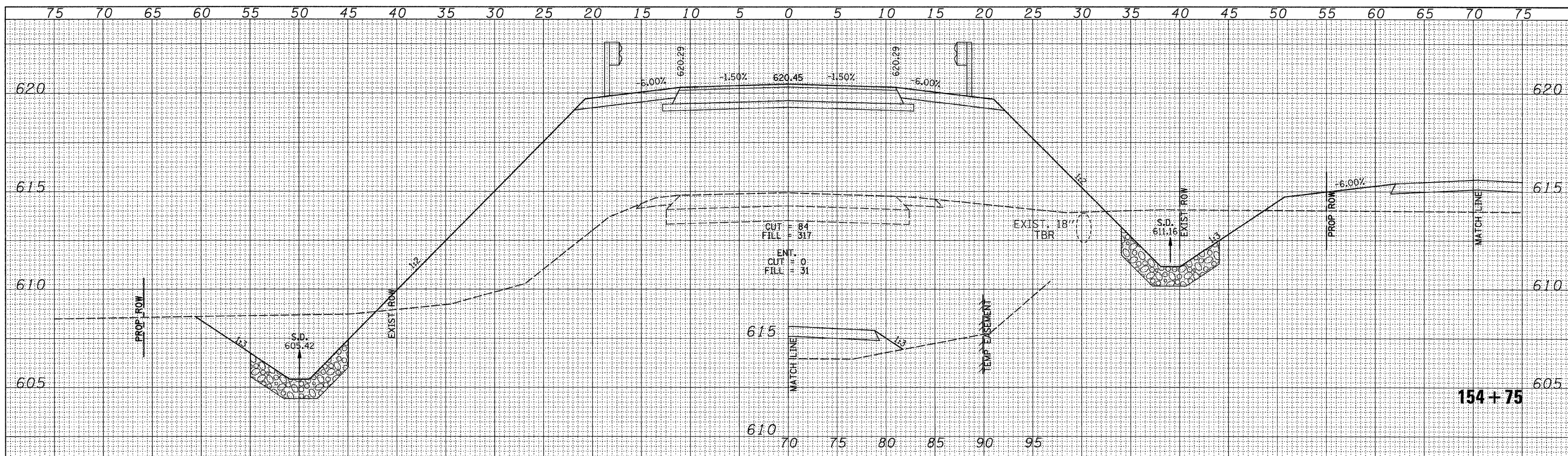

FILE NAME = V:\Brdge\2484-Morgan\2484xahs2.dgn	USER NAME = othomes	DESIGNED -	REVISED -	MORGAN COUNTY COUNTY HIGHWAY 28 OVER HENRY CREEK	CROSS SECTIONS		F.A.S. RTE. 609	SECTION 07-00099-00-BR	COUNTY MORGAN	TOTAL SHEETS 48	SHEET NO. 31
	PLOT SCALE = 5.0000' / IN.	CHECKED -	REVISED -		SCALE: HORIZ: 1"=50'	SHEET NO. 11 OF 28 SHEETS	STA. 154+50 TO STA. 154+75	CONTRACT NO. 93545		FED. ROAD DIST. NO. 7 ILLINOIS	FED. AID PROJECT BRS-0609109
	PLOT DATE = 1/6/2011	DATE -	REVISED -								