

DATE	
BY	
SURVEYED	
PLOTTED	
NOTE BOOK	
AREAS CHECKED	
NO.	

DATE	
BY	
SURVEYED	
PLOTTED	
NOTE BOOK	
AREAS CHECKED	
NO.	

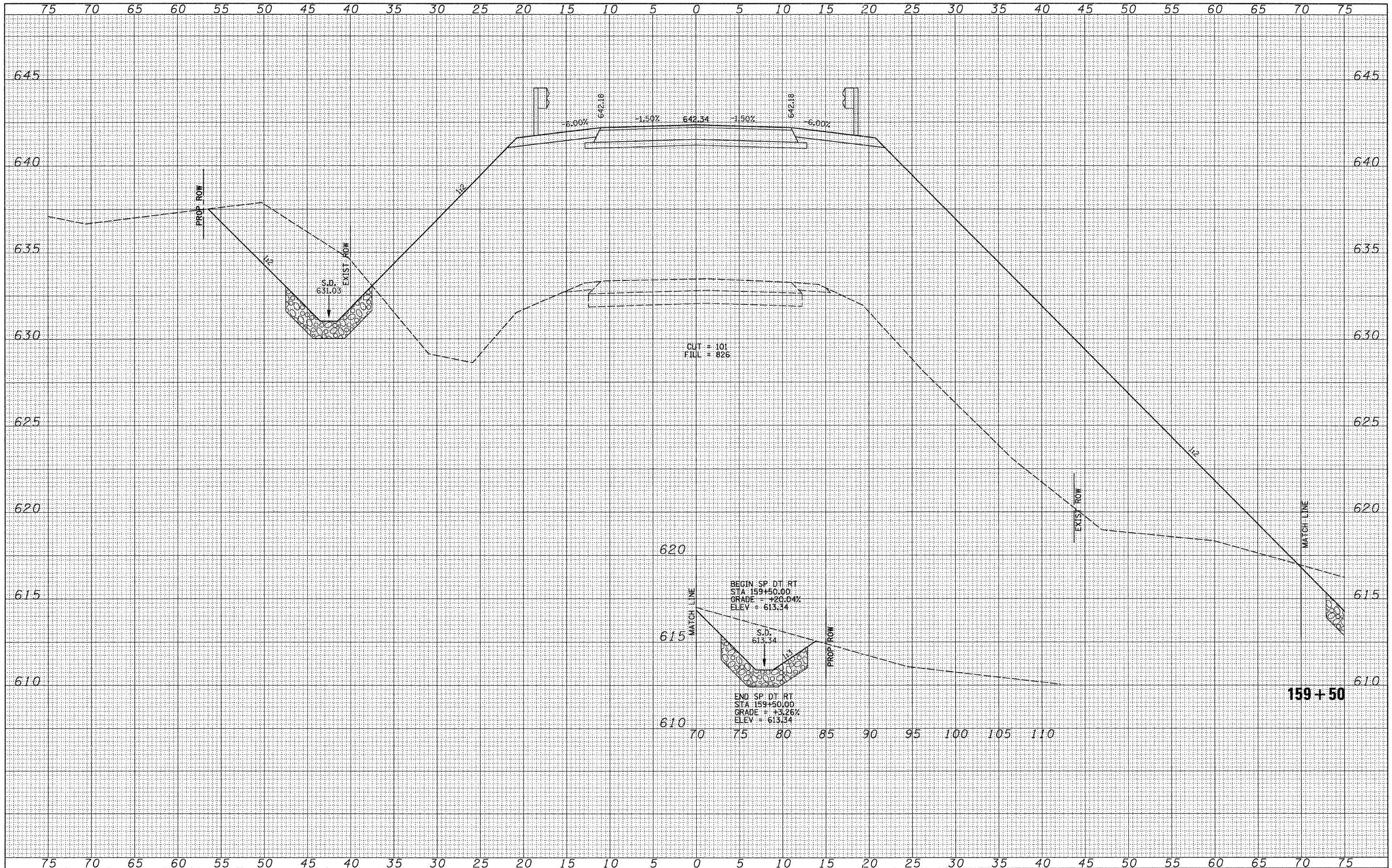

FILE NAME = V:\Bridges\2484-Morgan\2484xahs2.dgn

USER NAME = othomas	DESIGNED -	REVISED -
PLT SCALE = 5.2800' / IN.	DRAWN -	REVISED -
PLT DATE = 1/6/2011	CHECKED -	REVISED -
	DATE -	REVISED -

**MORGAN COUNTY
COUNTY HIGHWAY 28
OVER HENRY CREEK**

CROSS SECTIONS
SCALE: HORIZ: 1"=50'
VERT: 1"=5'
SHEET NO. 21 OF 28 SHEETS
STA. 159+50 TO STA. 159+50

F.A.S. RTE.	SECTION	COUNTY	TOTAL SHEETS	SHEET NO.
609	07-00099-00-BR	MORGAN	48	41
CONTRACT NO. 93545				
FED. ROAD DIST. NO. 7 ILLINOIS FED. AID PROJECT BRS-0609099				