

STATE OF ILLINOIS
DEPARTMENT OF TRANSPORTATION
DIVISION OF HIGHWAYS
PLANS FOR PROPOSED
FEDERAL-AID HIGHWAY BRIDGE PROGRAM
CRAWFORD COUNTY
SECTION 08-00091-00-BR
STRUCTURE NO. 017-3058
PROJECT NO. BRS-1698(100)
JOB NO. C-97-048-11
FAS 1698 (CH 12)

INDEX OF SHEETS

- 1 COVER SHEET
- 2 PLAN & PROFILE
- 3-4 CROSS SECTIONS
- 5-16 BRIDGE PLANS

- STANDARDS:
(SEE PROPOSAL)
- 280001-05 - EROSION CONTROL
 - 515001-03 - NAME PLATES
 - 630301-05 - SHOULDER WIDENING TYPE 1 TERMINALS
 - 635006-03 - REFLECTOR AND TERM. MARKER PLACEMENT
 - 701901-01 - TRAFFIC
 - BLR 21-8 - TRAFFIC
 - BLR 22-6 - TRAFFIC
 - BLR 27-1 - TRAFFIC BARR. TERM. TYPE 5A

SUMMARY OF QUANTITIES

QUANTITY	UNIT	ITEMS	CODE NO.
135	CU YD	EARTH EXCAVATION	20200100
180	CU YD	CHANNEL EXCAVATION	20300100
668	CU YD	FURNISHED EXCAVATION	20400800
58	TON	POROUS GRANULAR EMBANKMENT	20700110
36	FEET	TEMPORARY DITCH CHECKS	28000305
60	FOOT	PERIMETER EROSION BARRIER	28000400
140	TON	STONE DUMPED RIPRAP, CLASS A4	28100807
973	TON	AGGREGATE BASE COURSE, TYPE B	35101400
600	GALLON	BITUMINOUS MATERIALS (PRIME COAT)	40600100
225	TON	HOT-MIX ASPHALT SURFACE COURSE, MIX "C", N70	40603315
1	EACH	REMOVAL OF EXISTING STRUCTURES	50100100
50.2	CU YD	CONCRETE STRUCTURES	50300225
13.6	CU YD	CONCRETE ENCASEMENT	50300280
1960	SQ FT	PRECAST PRESTRESSED CONCRETE DECK BEAMS (17" DEPTH)	50400305
4990	POUND	REINFORCEMENT BARS	50800105
151	FOOT	STEEL RAILING, TYPE S1	50900205 *
560	FOOT	FURNISHING STEEL PILES HP 10X42	51201400
560	FOOT	DRIVING PILES	51202305
2	EACH	TEST PILE STEEL HP 10X42	51203400
1	EACH	NAME PLATES	51500100
32	FOOT	PIPE CULVERTS, CLASS D, TYPE 1 15"	542D0220
2	EACH	TRAFFIC BARRIER TERMINAL, TYPE 5A	63100075 *
2	EACH	TRAFFIC BARRIER TERMINAL, TYPE 1 (SPECIAL) TANGENT	63100167 *
1	L SUM	MOBILIZATION	67100100
2	EACH	TERMINAL MARKER - DIRECT APPLIED	78201000 *
15	TON	AGGREGATE DITCH (SPECIAL)	X2830495
1	L SUM	TRAFFIC CONTROL AND PROTECTION, (SPECIAL)	X7010216
0.8	ACRE	SEEDING, CLASS 2 SPECIAL	X2501000

* SPECIALTY ITEMS

FUNCTIONAL CLASS: RURAL MAJOR COLLECTOR
ADT = 600
DESIGN SPEED = 50 MPH

TOLL FREE JOINT UTILITY LOCATING
INFORMATION FOR EXCAVATORS (J.U.L.I.E.)
TELEPHONE NO. 1-800-892-0123

PROFESSIONAL DESIGN FIRM #184-000832

SCALES
PLAN 1 INCH = 50 FEET
PROFILE HORZ. 1 INCH = 50 FEET
PROFILE VERT. 1 INCH = 10 FEET

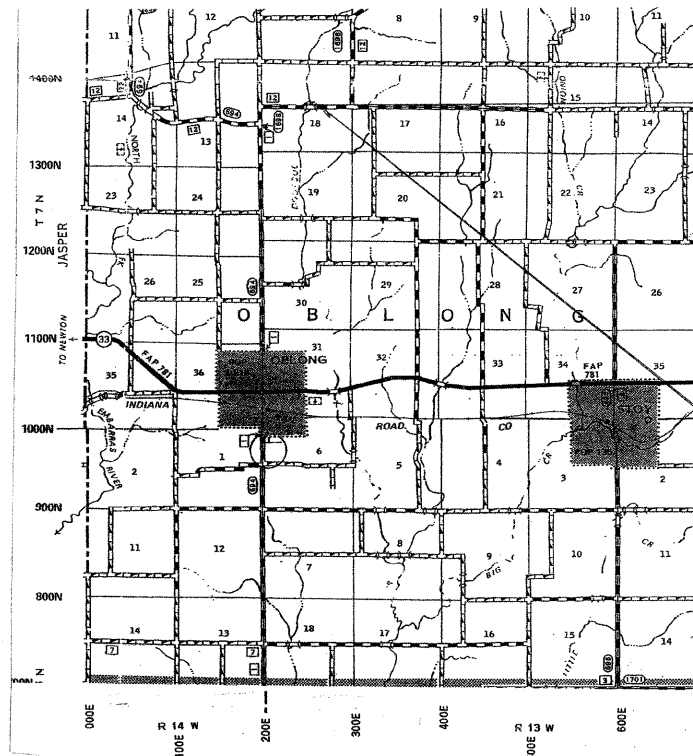

LOCATION MAP
APPROXIMATE SCALE: 1 INCH = 1 MILE
NET LENGTH = 700 FT. = 0.133 MILES

SECTION 08-00091-00-BR
BEGINS STA. 0+50

STA. 4+07- SPECIAL BRIDGE DESIGN
PROPOSED PRECAST PRESTRESSED CONC.
DECK BEAM BRIDGE, 3 SPANS @ 25', 20', 25'
28' RDWY, SKEW= 15' L.F.
PROPOSED STR. NO. 017-3058
EXISTING STR. NO. 017-3033

SECTION 08-00091-00-BR
ENDS STA. 7+50



James A. Stone
ILLINOIS REGISTERED PROFESSIONAL ENGINEER # 55012
LICENSE EXPIRES NOVEMBER 30, 2011

ILLINOIS DEPARTMENT OF TRANSPORTATION	
APPROVED: <u>February 10</u> , 2011 <i>John R. Hill</i> LOCAL AGENCY, COUNTY ENGINEER	
PASSED: <u>2-18</u> , 2011 <i>Maureen Cassel</i> DISTRICT SEVEN ENGINEER OF LOCAL ROADS & STREETS	
RELEASING FOR BID BASED ON LIMITED REVIEW: <u>2-18</u> , 2011 <i>Roger S. Drabell</i> DEPUTY DIRECTOR OF HIGHWAYS, REGION FOUR ENGINEER	