





**LEGEND**

-  BASE CSE WIDENING, 10"
-  AGG SURF CSE, TYPE A
-  HMA SHOULDER 8"
-  PCC PAVEMENT 10"

**SEC. 5, T11S, R7E, 3RD P.M.**

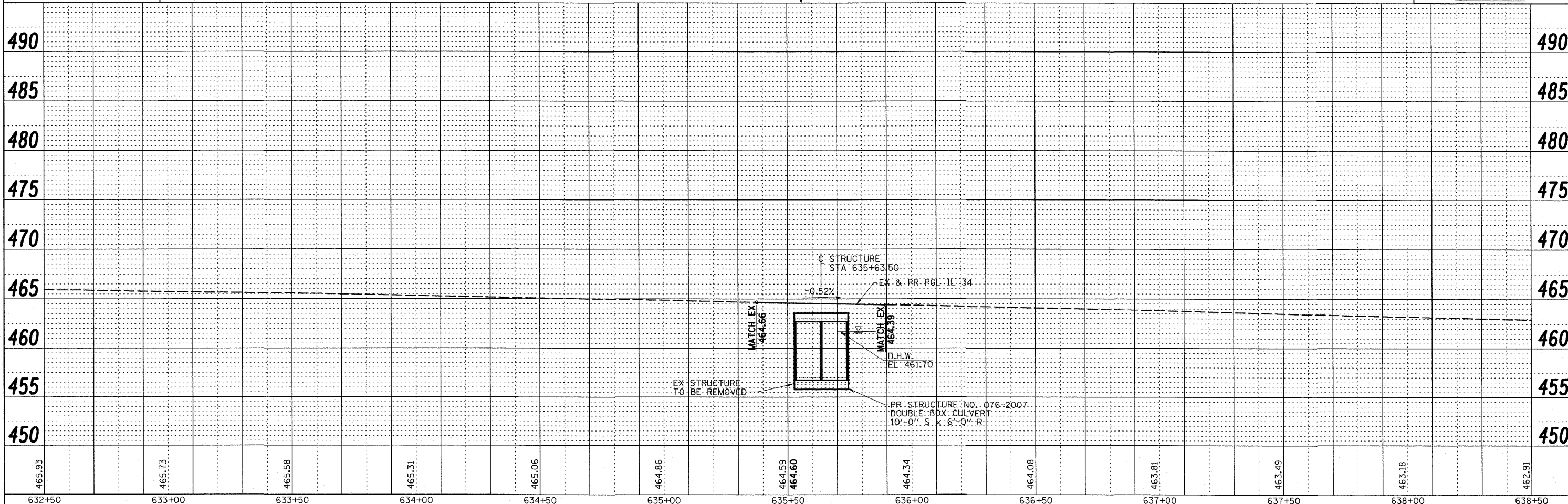
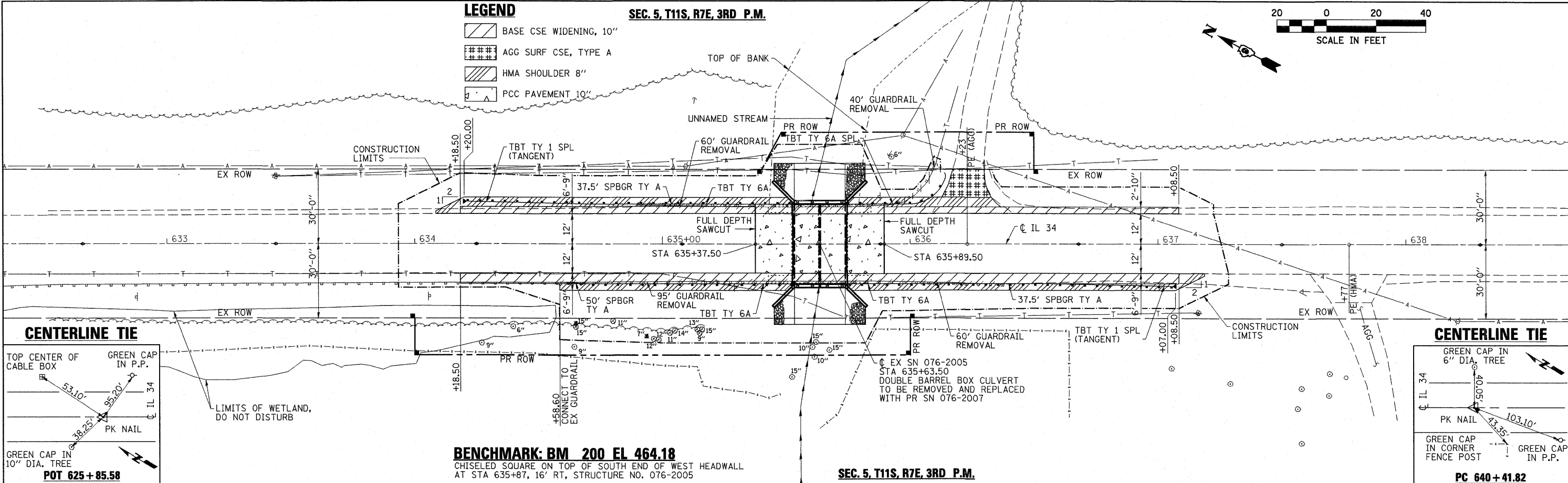
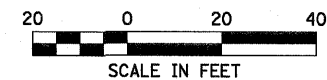

465.93	465.73	465.58	465.31	465.06	464.86	464.59	464.60	464.34	464.08	463.81	463.49	463.18	462.91
632+50	633+00	633+50	634+00	634+50	635+00	635+50	636+00	636+50	637+00	637+50	638+00	638+50	639+00

FILE NAME = D:\998854-sht-ppf51.dgn  
 PLOT SCALE = 20.0000' / IN.  
 PLOT DATE = 1/4/2011 1:04:52 PM

USER NAME = HAS  
 DESIGNED - MTD  
 DRAWN - JPC/HAS  
 CHECKED - RDP  
 DATE - 12/10

REVISED -  
 REVISED -  
 REVISED -  
 REVISED -

**STATE OF ILLINOIS  
 DEPARTMENT OF TRANSPORTATION**

**IL RTE 34 PLAN AND PROFILE  
 STRUCTURE NO. 076-2007**  
 SCALE: 1" = 20'-0" SHEET NO. 1 OF 2 SHEETS STA. 632+50 TO STA. 638+50

F.A.P. RTE. 778	SECTION 3B-2	COUNTY POPE	TOTAL SHEETS 50	SHEET NO. 7
CONTRACT NO. 98854			ILLINOIS FED. AID PROJECT	