

- LEGEND**
- BASE CSE WIDENING, 10"
 - AGG SURF CSE, TYPE A
 - HMA SHOULDER 8"
 - PCC PAVEMENT 10"
 - INCIDENTAL HMA SURFACING

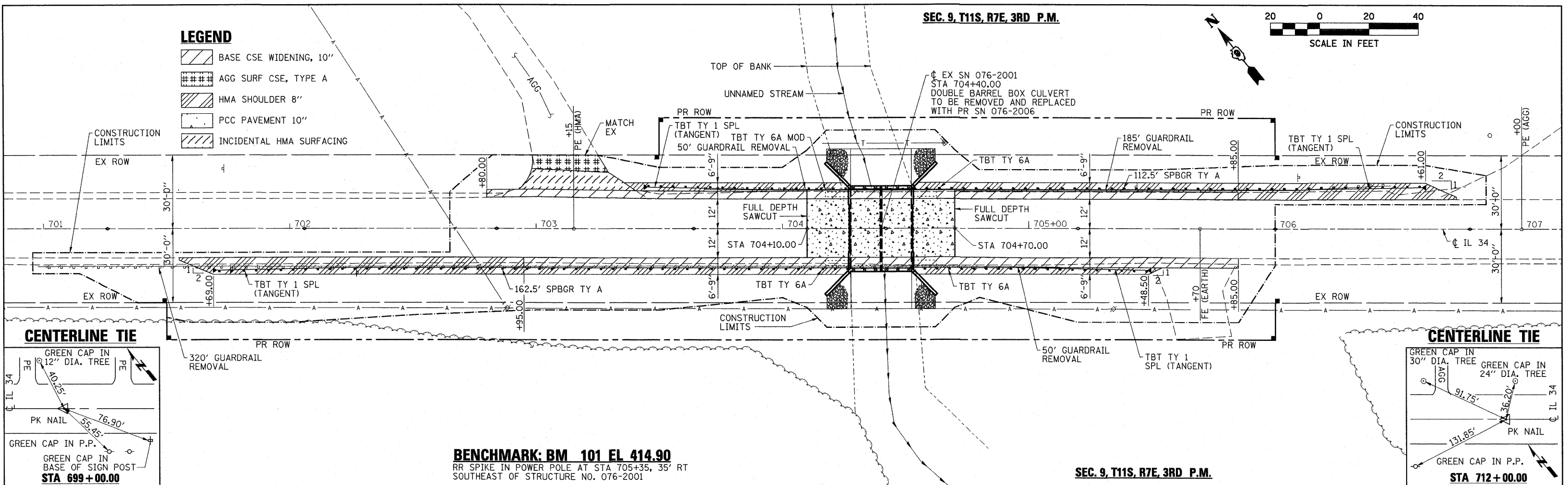

BENCHMARK: BM 101 EL 414.90
 RR SPIKE IN POWER POLE AT STA 705+35, 35' RT
 SOUTHEAST OF STRUCTURE NO. 076-2001

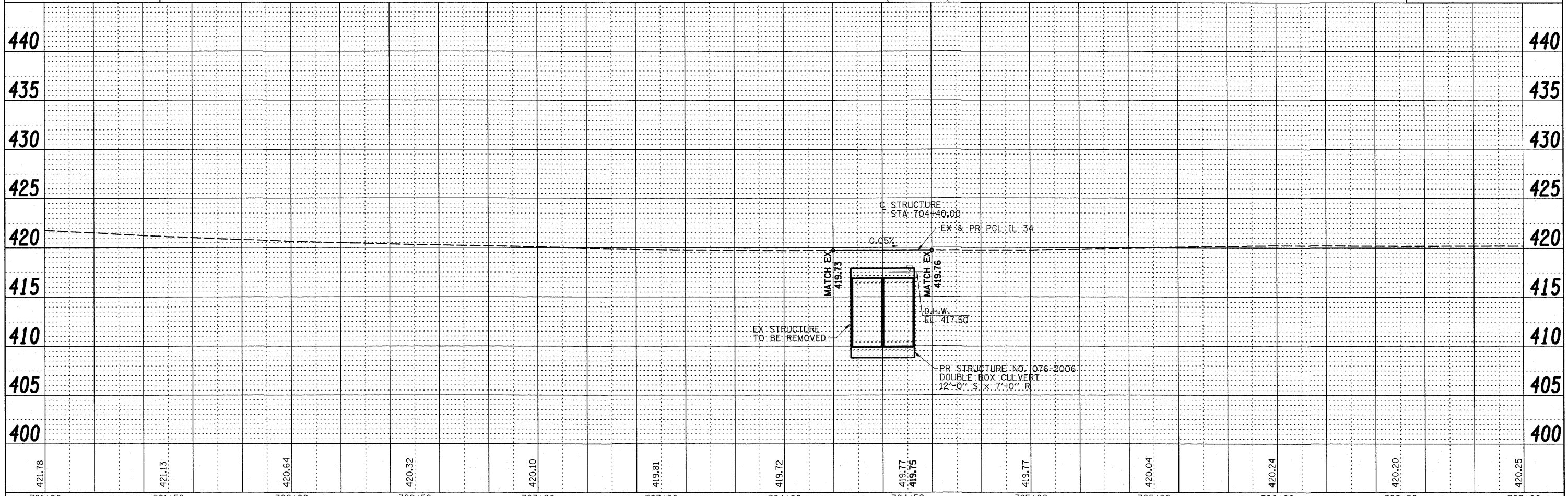

| | | | | | | | | | | | | | |
|--------|--------|--------|--------|--------|--------|--------|--------|--------|--------|--------|--------|--------|--------|
| 421.78 | 421.13 | 420.64 | 420.32 | 420.10 | 419.81 | 419.72 | 419.77 | 419.75 | 419.77 | 420.04 | 420.24 | 420.20 | 420.25 |
| 701+00 | 701+50 | 702+00 | 702+50 | 703+00 | 703+50 | 704+00 | 704+50 | 705+00 | 705+50 | 706+00 | 706+50 | 707+00 | |

| | | | |
|-----------------------------|-----------------|-----------------|-----------|
| FILE NAME = | USER NAME = HAS | DESIGNED - MTD | REVISED - |
| D998854-shr-ppf01.dgn | | DRAWN - JPC/HAS | REVISED - |
| PLOT SCALE = 20.0000' / IN. | | CHECKED - RDP | REVISED - |
| PLOT DATE = 1/4/2011 | | DATE - 12/10 | REVISED - |

| | | | |
|-------------------------------------|---------|-----------------------------------|--------------|
| STATE OF ILLINOIS | | IL RTE 34 PLAN AND PROFILE | |
| DEPARTMENT OF TRANSPORTATION | | STRUCTURE NO. 076-2006 | |
| SCALE: 1" = 20'-0" | | SHEET NO. 2 OF 2 SHEETS | |
| STA. 701+00 | | TO STA. 707+00 | |
| F.A.P. RTE. | SECTION | COUNTY | TOTAL SHEETS |
| 778 | 3B-1 | POPE | 50 |
| CONTRACT NO. 98854 | | SHEET NO. B | |